

30-025-26340

NO. OF COPIES RECEIVED	
DISTRIBUTION	
SANTA FE	
FILE	
U.S.G.S.	
LAND OFFICE	
OPERATOR	

NEW MEXICO OIL CONSERVATION COMMISSION

Form C-101
Revised 1-1-65

5A. Indicate Type of Lease	
STATE <input type="checkbox"/>	FEE <input checked="" type="checkbox"/>
5. State Oil & Gas Lease No.	

APPLICATION FOR PERMIT TO DRILL, DEEPEN, OR PLUG BACK

1a. Type of Work		7. Unit Agreement Name	
b. Type of Well DRILL <input checked="" type="checkbox"/> DEEPEN <input type="checkbox"/> PLUG BACK <input type="checkbox"/> OIL WELL <input checked="" type="checkbox"/> GAS WELL <input type="checkbox"/> OTHER <input type="checkbox"/> SINGLE ZONE <input checked="" type="checkbox"/> MULTIPLE ZONE <input type="checkbox"/>		8. Form or Lease Name McQuatters	
c. Name of Operator Amoco Production Company		9. Well No. 3	
d. Address of Operator P. O. Box 68, Hobbs, NM 88240		10. Field and Pool, or Well Unit Wildcat Drinkard	
e. Location of Well UNIT LETTER <u>B</u> LOCATED <u>660 700</u> FEET FROM THE <u>North</u> LINE <u>2230</u> AND <u>2130</u> FEET FROM THE <u>East</u> LINE OF SEC. <u>11</u> TWP. <u>21-S</u> RGL. <u>36-E</u> NMPM		11. County Lea	
12. Proposed Depth 6,900'		13a. Formation Drinkard	
12b. Kind & Status Plug Bond Blanket-On File		13b. Rotary or C.R.	
14. Approx. Volume (show whether DP, RI, etc.) 3538.0 GL		21B. Drilling Contractor Verna Rig #12	
21A. Kind & Status Plug Bond		22. Approx. Date Work will start 6-14-79	

23.

PROPOSED CASING AND CEMENT PROGRAM

SIZE OF HOLE	SIZE OF CASING	WEIGHT PER FOOT	SETTING DEPTH	SACKS OF CEMENT	EST. TOP
17-1/2"	13-3/8"	48#	1,300'	Circ to Surf	Surface
12-1/4" or 11"	* 8-5/8"	24#	5,100'	Tie back to 13-3/8" csg	Btm of 13-3/8"
7-7/8"	5-1/2" (Liner)	14#	4,900'-6,900'	Tie back to 8-5/8" csg	Btm of 8-5/8"

- * 8-5/8" Intermediate String will be run only if lost circulation occurs above top of Glorieta Gas Zone. If no lost circulation is encountered by top of Glorieta, reduce hole to 7-7/8" and run 5-1/2" string from surface to TD.

After reaching TD, logs will be run and evaluation made. Perforate and/or stimulate as necessary in attempting commercial production.

Mud Program: 0-1,300' Native mud and fresh water
1,300'-6,900' Brine water, native mud and sufficient commercial mud to maintain good hole conditions.

BOP Program is attached.

Gas is not dedicated.

IN ABOVE SPACE DESCRIBE PROPOSED PROGRAM; IF PROPOSAL IS TO DEEPEN OR PLUG BACK, GIVE DATA ON PRESENT PRODUCTIVE ZONE AND PROPOSED NEW PRODUCTIVE ZONE. GIVE REMOVED PREVENTER PROGRAM, IF ANY.

I hereby certify that the information above is true and complete to the best of my knowledge and belief.

Signed Larry Cox Title Administrative Supervisor Date 5/31/79

(This space for State Use)

APPROVED BY Larry Cox TITLE SUPERVISOR DISTRICT 1 DATE JUN 6 1979

CONDITIONS OF APPROVAL, IF ANY:
0-5 - AMOCD, H 1 - Hou
1 - BD 1 - Susp

NEW MEXICO OIL CONSERVATION COMMISSION
WELL LOCATION AND ACREAGE DEDICATION PLAT

Form
Supersedes O-128
Effective 1-1-75

All distances must be from the outer boundaries of the Section

Amoco Production Co.

McQuatters

3

B

11

21 South

36 East

Lea

700

North

2230

East

3528.0

Drinkard

Wildcat Drinkard

40

- Outline the acreage dedicated to the subject well by colored pencil or by other marks on the plat here.
- If more than one lease is dedicated to the well, outline each and identify the ownership of each both as to working interest and royalty.
- If more than one lease of different ownership is dedicated to the well, have the interests of all owners been consolidated by communitization, unitization, force pooling, etc.?

Yes ☐ No ☐ If answer is "yes" type of consolidation _____

If answer is "no" list the owners and tract descriptions which have a majority been consolidated on reverse side of this form if necessary: _____

No acreage will be assigned to the well until all interests have been consolidated by communitization, unitization, force pooling, or otherwise or until a non-standard unit, eliminating such interests has been approved by the Commission.

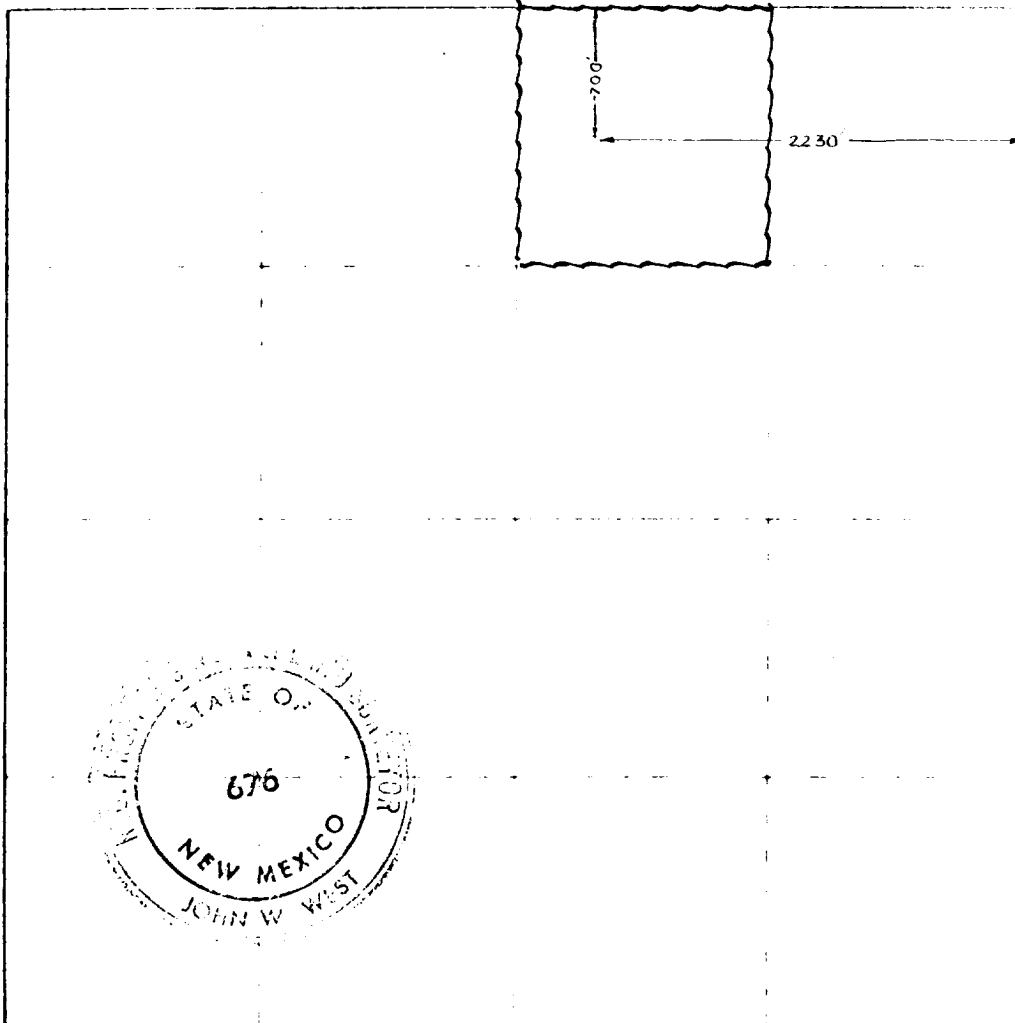

WELL LOCATION

I hereby certify that the information contained herein is true and complete to the best of my knowledge and belief.

Bob Davis

Asst. Admin. Analyst

Amoco Production Company

June 1, 1979

I hereby certify that the well location shown on this plat was plotted from field notes of a licensed surveyor made in compliance with surveys on, and that the same is true and correct to the best of my knowledge and belief.

May 9, 1979

John W. West

John W. West 676

Ronald J. Edison 3239

ATTACHMENT "B"
NOTES

1. Blow-out preventers and master valve to be fluid operated and oil fittings must be in good condition, 3,000# W.P. (6,000 p.s.i. test), minimum.
2. Equipment through which bit must pass shall be as large as the inside diameter of the casing that is being drilled through.
3. Nipple above blow-out preventer shall be same size as casing being drilled through.
4. Kelly cock required, 3,000# W.P. (6,000 p.s.i. test) minimum.
5. OMSCO or comparable safety valve must be available on rig floor at all times with proper connection or sub, 3,000# W.P. (6,000 p.s.i. test), minimum.
6. Blow-out preventers and master valve while drilling intermediate hole to 6000' may be 2,000# W.P. (4,000 p.s.i. test), minimum.
7. Choke assembly, beyond second valve from cross, may be positioned (Optional) outside of derrick foundation.
8. Spool or cross may be eliminated if connections are available in the lower part of the blow-out preventer body.
9. Plug valves - gate valves are optional. Valves shown as 2" are minimum size.
10. Casing head and casing head spool, including attached valves, to be furnished by Amoco.
11. Rams in preventers will be installed as follows:

When drilling, use:	When running casing, use:
Top Preventer - Drill pipe rams	Top Preventer - Casing rams
Bottom Preventer - Blind rams or master valve	Bottom Preventer - Blind rams or master valve

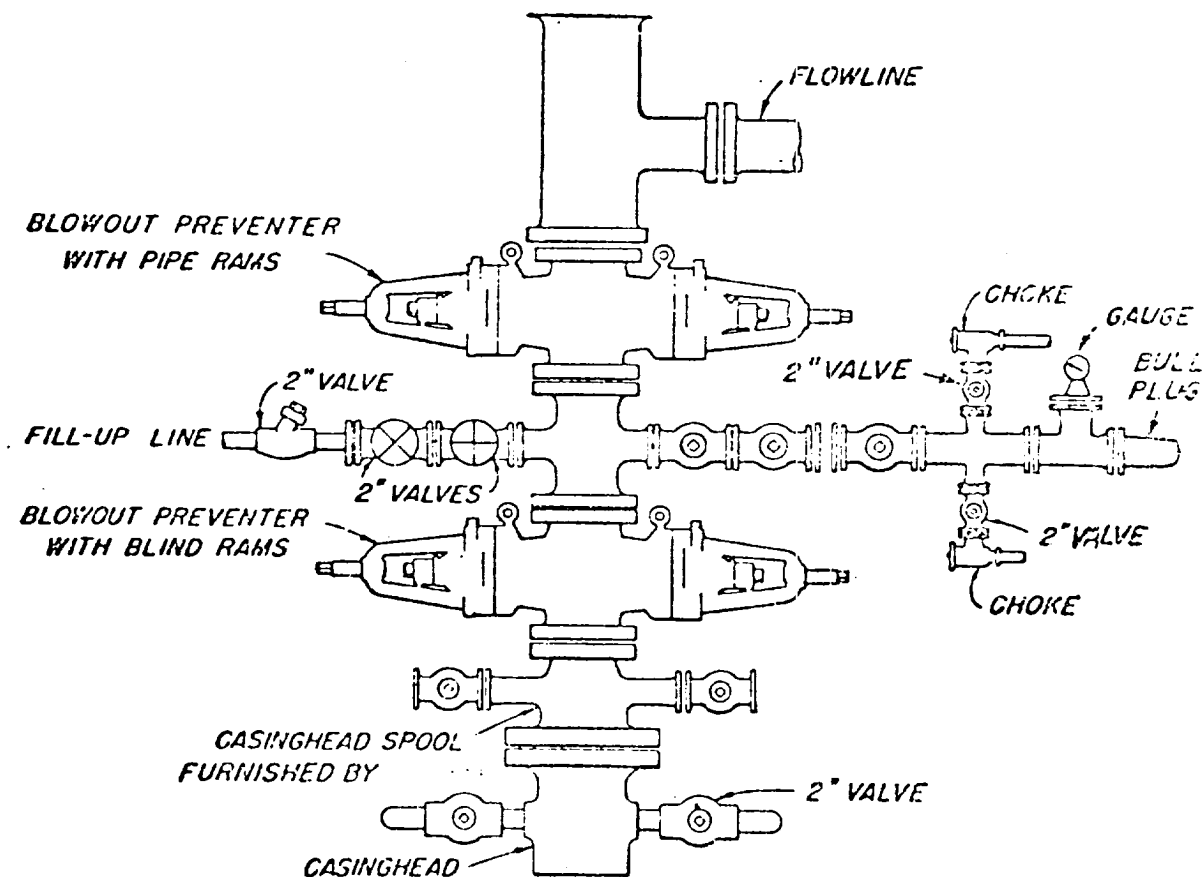

BLOWOUT PREVENTER HOOK-UP

AMOCO PRODUCTION COMPANY

EXHIBIT D-1 MODIFIED

JUNE 1, 1962

RECEIVED

JUN 11 1979

U.S. DEPARTMENT OF COMMERCE
BUREAU OF ECONOMIC ANALYSIS

112