

NO. OF COPIES RECEIVED		
DISTRIBUTION		
SANTA FE		
FILE		
U.S.G.S.		
LAND OFFICE		
OPERATOR		

NE EXICO OIL CONSERVATION COMMISSION

30-025-26453

Form C-101
Revised 1-1-65

5A. Indicate Type of Lease	
STATE <input type="checkbox"/>	FEE <input checked="" type="checkbox"/>

5. State Oil & Gas Lease No.

APPLICATION FOR PERMIT TO DRILL, DEEPEN, OR PLUG BACK

1a. Type of Work		7. Unit Agreement Name	
b. Type of Well OIL WELL <input checked="" type="checkbox"/> GAS WELL <input checked="" type="checkbox"/> OTHER <input type="checkbox"/>		8. Farm or Lease Name Mittie Weatherly	
2. Name of Operator N. B. Hunt		9. Well No. 8	
3. Address of Operator 406 North Big Spring St., Midland, Texas 79701		10. Field and Pool, or Wildcat Wildcat (ND)	
4. Location of Well UNIT LETTER G LOCATED 1980 FEET FROM THE North LINE AND 2190 FEET FROM THE East LINE OF SEC. 21 TWP. 21S RGE. 37 E NMPM		12. County Lea	
19. Proposed Depth 8500		19A. Formation Pre-Combrian Granite Rotary	
21. Elevations (Show whether DF, RT, etc.) 3444 GR		22. Approx. Date Work will start Aug. 30, 1979	

PROPOSED CASING AND CEMENT PROGRAM

SIZE OF HOLE	SIZE OF CASING	WEIGHT PER FOOT	SETTING DEPTH	SACKS OF CEMENT	EST. TOP
17-1/2	13-3/8	54.5# & 48#	300' 400'	400	Surface
12-1/4	9-5/8	36# & 40#	5000'	1250	Surface
	Cmt. Stage Co	lar at Top of Salt (± 1200')			

8-1/2 5-1/2 15.5# 8500' 600 5000'

BOP: 10" - 3000# Double Shaffer

NOV 28 1979

IN ABOVE SPACE DESCRIBE PROPOSED PROGRAM; IF PROPOSAL IS TO DEEPEN OR PLUG BACK, GIVE DATA ON PRESENT PRODUCTIVE ZONE AND PROPOSED NEW PRODUCTIVE ZONE. GIVE BLOWOUT PREVENTER PROGRAM, IF ANY.

I hereby certify that the information above is true and complete to the best of my knowledge and belief.

Signed John W. Ryan Title District Superintendent Date Aug. 24, 1979

APPROVED BY John W. Ryan TITLE Geologist 1 DATE AUG 28 1979
CONDITIONS OF APPROVAL, IF ANY:

WELL LOCATION AND ACREAGE DEDICATION PLAT

Form C-102
Supersedes C-128
Effective 1-1-65

All distances must be from the outer boundaries of the Section.

Operator N. B. Hunt			Lease Mittie Weatherly			Well No. 8		
Unit Letter G	Section 21	Township 21 S		Range 37 E	County Lea			
Actual Footage Location of Well:								
2190 feet from the		East line and		1980 feet from the		North line		
Ground Level Elev. 3444	Producing Formation Fusselman		Pool Wildcat		Dedicated Acreage; 40 Acres			

1. Outline the acreage dedicated to the subject well by colored pencil or hachure marks on the plat below.
2. If more than one lease is dedicated to the well, outline each and identify the ownership thereof (both as to working interest and royalty).
3. If more than one lease of different ownership is dedicated to the well, have the interests of all owners been consolidated by communitization, unitization, force-pooling, etc?

☐ Yes ☐ No If answer is "yes," type of consolidation _____

If answer is "no," list the owners and tract descriptions which have actually been consolidated. (Use reverse side of this form if necessary.) _____

No allowable will be assigned to the well until all interests have been consolidated (by communitization, unitization, forced-pooling, or otherwise) or until a non-standard unit, eliminating such interests, has been approved by the Commission.

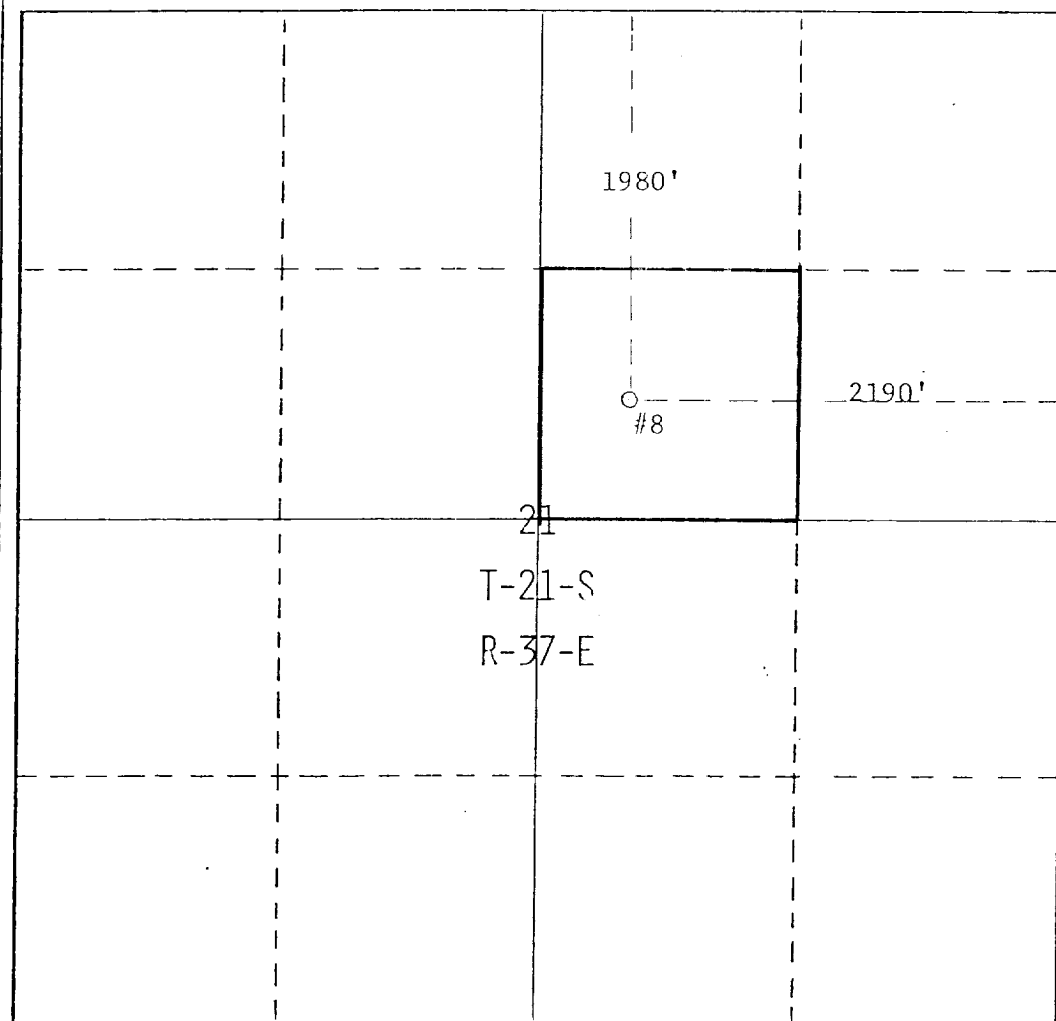

CERTIFICATION

I hereby certify that the information contained herein is true and complete to the best of my knowledge and belief.

Name N. B. Hunt
Position District Superintendent
Company N. B. Hunt
Date August 24, 1979

I hereby certify that the well location shown on this plat was obtained from field notes of location made by me or under my supervision, and that the same is true and correct to the best of my knowledge and belief.

Date Surveyed August 24, 1979
Surveyor W. D. Watson, Jr.

Registered Professional Engineer and/or Land Surveyor
Certificate No. 3959

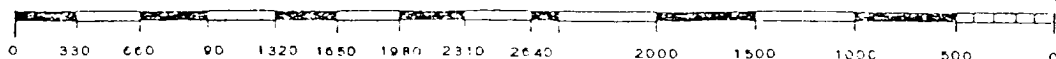

173

RECEIVED
AUG 27 1964
O.C.D. HOBBS, OFFICE