

**NEW MEXICO OIL CONSERVATION COMMISSION
WELL LOCATION AND ACREAGE DEDICATION PLAT**

Form C-102
Supersedes C-128
Effective 1-1-65

All distances must be from the outer boundaries of the Section.

Operator Amerada Hess Corporation			Lease State WE "B"		Well No. 6
Init Letter C	Section 1	Township 21S	Range 35E	County Lea	
Actual Postage Location of Well:					
780	feet from the North	line and	1980	feet from the West	line
Ground Level Elev. 3553'	Producing Formation Eumont Yates 7R Queen		Pool Eumont		Dedicated Acreage: 118 Acres

1. Outline the acreage dedicated to the subject well by colored pencil or hachure marks on the plat below.
2. If more than one lease is dedicated to the well, outline each and identify the ownership thereof (both as to working interest and royalty).
3. If more than one lease of different ownership is dedicated to the well, have the interests of all owners been consolidated by communitization, unitization, force-pooling, etc?

☐ Yes ☐ No If answer is "yes," type of consolidation _____

If answer is "no," list the owners and tract descriptions which have actually been consolidated. (Use reverse side of this form if necessary.) _____

No allowable will be assigned to the well until all interests have been consolidated (by communitization, unitization, forced-pooling, or otherwise) or until a non-standard unit, eliminating such interests, has been approved by the Commission.

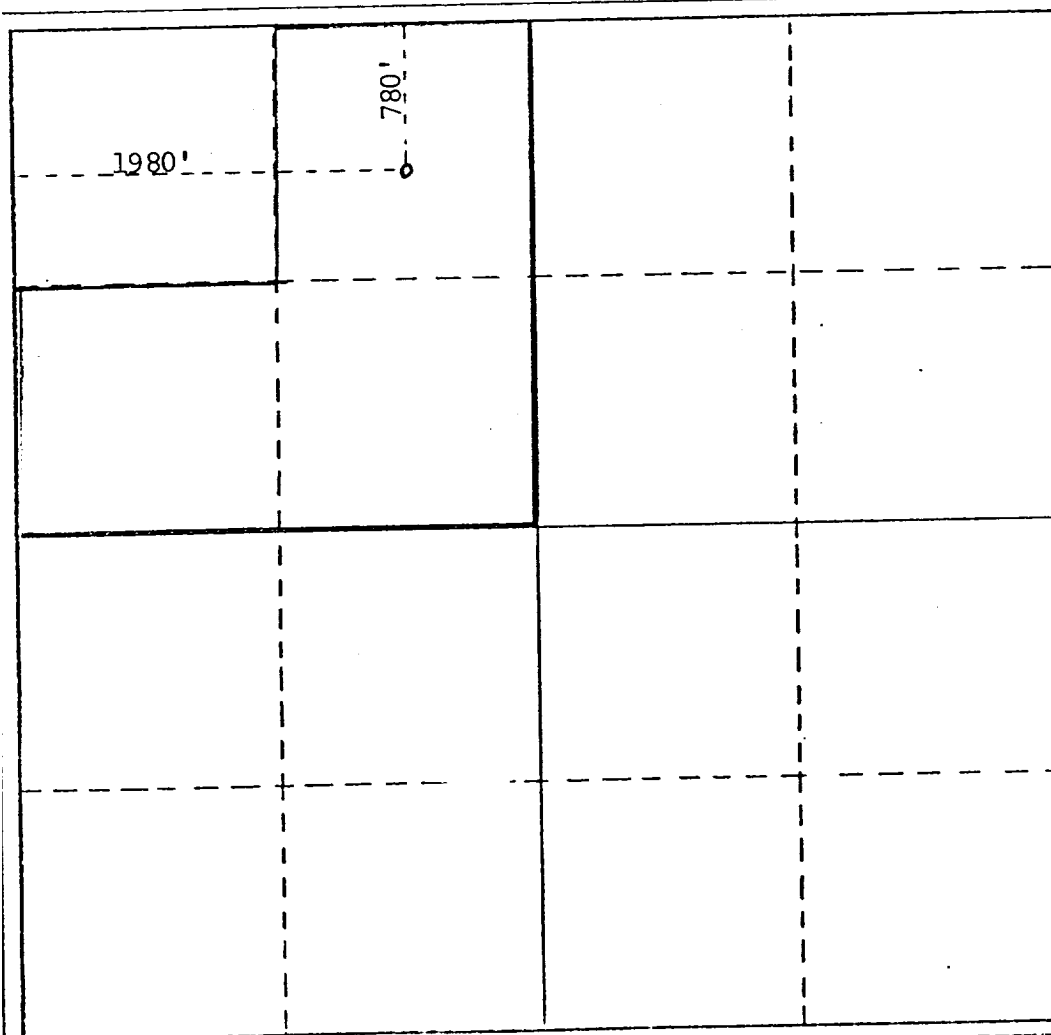

CERTIFICATION

I hereby certify that the information contained herein is true and complete to the best of my knowledge and belief.

Name _____

Position _____

Supv. Adm. Ser.

Company _____

Amerada Hess Corporation

Date _____

3-4-80

I hereby certify that the well location shown on this plat was plotted from field notes of actual surveys made by me or under my supervision, and that the same is true and correct to the best of my knowledge and belief.

Date Surveyed _____

Registered Professional Engineer
and/or Land Surveyor

Certificate No. _____

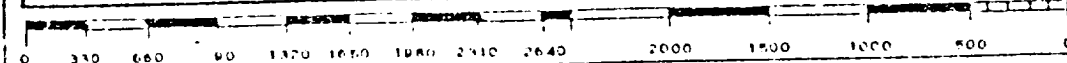

COUNTY LEA FIELD Eumont STATE NM
 OPR AMERADA HESS CORP. API 30-025-26548
 NO 6 LEASE State WE "B" MAP
 Sec 1, T21S, R35E CO-ORD
 780' FNL, 1980' FWL of Sec 3-4-18 NM
 11 mi NW/Eunice SPD 1-13-80 CMP 2-19-80

8 5/8" at 328' w/250 sx
 4 1/2" at 3160' w/800 sx
 2 1/16" at 3318'

WELL CLASS: INIT D FIN DG ELEV L & S			
FORMATION	DATUM	FORMATION	DATUM
ID 3360' (SVRV)	PBD	3326'	

IP (Queen) OH 3160-3326' F 255 MCFGPD. Pot based
 on 24 hr test thru 32/64" chk. GOR (NR); gty (NR); CP
 130#; TP 130#

CUSTER Cactus OPR 3553' GL, 3564' KB PD 3400' RT

F.R. 11-19-79
 (Seven Rivers)
 1-14-80 TD 328'; WOC
 1-22-80 TD 3160'; WOCT
 2-13-80 TD 3160'; WOCT
 2-19-80 TD 3360'; PBD 3326'; Tstg OH
 PB in open hole to 3326'
 OH 3160-3326'
 Natural
 2-25-80 TD 3360'; PBD 3326'; SI
 3-3-80 TD 3360'; PBD 3326'; Rng 4 pt test
 3-17-80 TD 3360'; PBD 3326'; Complete
 LOG TOPS: Rustler Anhydrite 1400', Salt
 1512', Yates 2958'
 BHT 85 deg
 3-22-80 COMPLETION ISSUED

3-4-18 NM
 IC 30-025-70453-79