

**NEW MEXICO OIL CONSERVATION COMMISSION
WELL LOCATION AND ACREAGE DEDICATION PLAT**

Form O-102
Supersedes O-128
Effective 1-1-65

All distances must be from the outer boundaries of the Section

Operator Amerada Hess Corporation			Lease State WE "F"		Well No. 4
Unit Letter K	Section 1	Township 21S	Range 35E	County Lea	
Actual Footage Location of Well: <div style="display: flex; justify-content: space-between;"> 3420 feet from the North line and 1980 feet from the West line </div>					
Ground Level Elev. 3551'	Producing Formation Eumont Yates 7R Queen		Pool Eumont	Dedicated Acreage 160 Acres	

1. Outline the acreage dedicated to the subject well by colored pencil or hachure marks on the plat below.
2. If more than one lease is dedicated to the well, outline each and identify the ownership thereof (both as to working interest and royalty).
3. If more than one lease of different ownership is dedicated to the well, have the interests of all owners been consolidated by communitization, unitization, force-pooling, etc?

☐ Yes ☐ No If answer is "yes," type of consolidation _____

If answer is "no," list the owners and tract descriptions which have actually been consolidated. (Use reverse side of this form if necessary.) _____

No allowable will be assigned to the well until all interests have been consolidated (by communitization, unitization, forced-pooling, or otherwise) or until a non-standard unit, eliminating such interests, has been approved by the Commission.

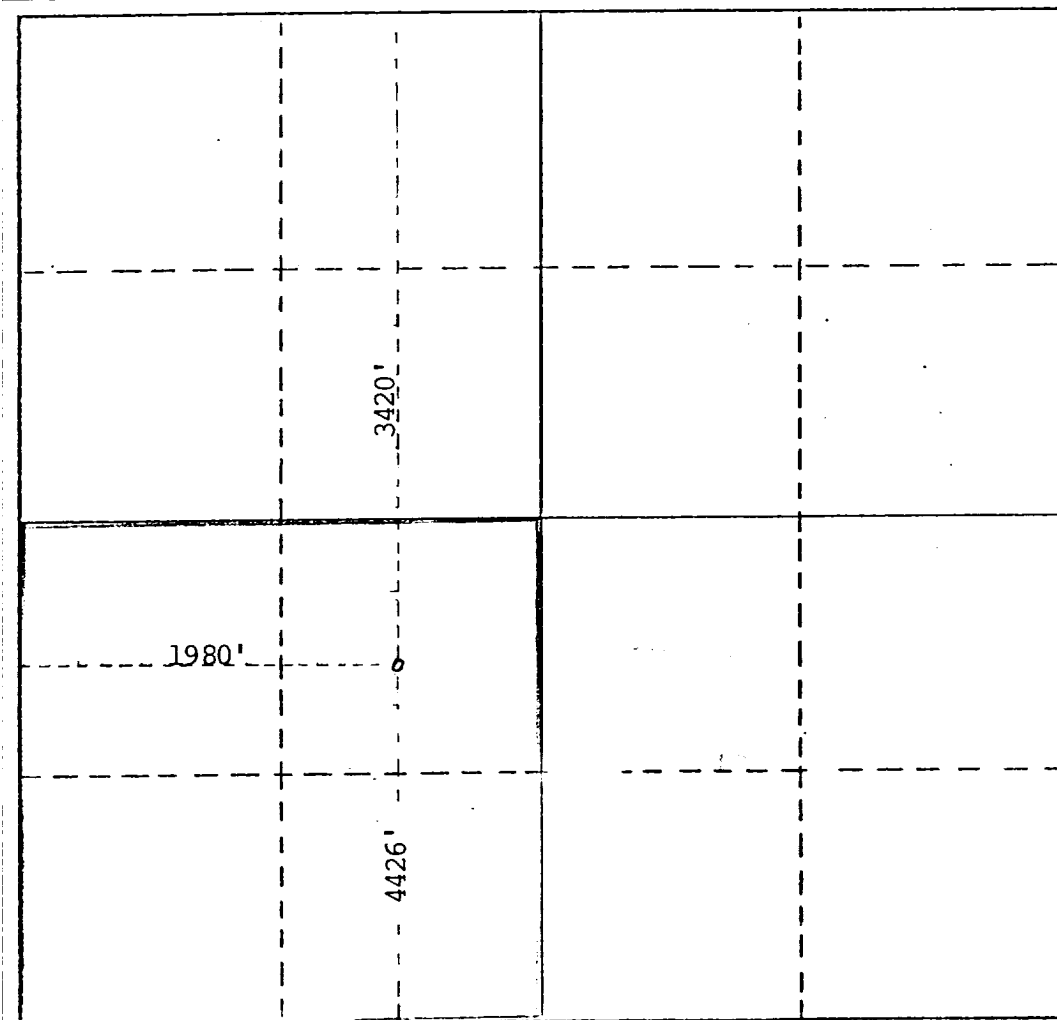

CERTIFICATION

I hereby certify that the information contained herein is true and complete to the best of my knowledge and belief.

Name **EB Fisher**
 Position **Supv. Adm. Ser.**
 Company **Amerada Hess Corporation**
 Date **2-13-80**

I hereby certify that the well location shown on this plat was plotted from field notes of actual surveys made by me or under my supervision, and that the same is true and correct to the best of my knowledge and belief.

Date Surveyed _____
 Registered Professional Engineer and/or Land Surveyor _____
 Certificate No. _____

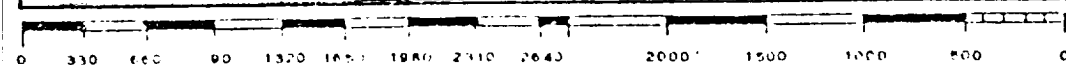

OIL CONSERVATION DIV.

FEB 18 '80

RECEIVED

LEASE LEA FIELD Eumont STATE NM
 AMERADA HESS CORP. API 30-025-26549
 LEASE State WE "F" MAP
 Sec 1, T21S, R35E COORD
 3420' FNL, 1980' FWL of Sec 3-3-12 NM
 11 mi NW/Eunice SPD 1-5-80 CMP 2-11-80

2 5/8" at 331' w/250 sx
 2 1/2" at 3330' w/800 sx
 2 1/16" at 3446'

WELL CLASS: INIT DEPT DGE			
FORMATION	DATUM	FORMATION	DATUM
TD 3470' (SVRV)		PUD	

OH (Seven Rivers) OH 3330-3470' F 1032 MCFGPD. Pot
 based on 24 hr test thru 2" chk. GOR (NR); gty (NR);
 PP Pkr; TP 150#

PLATE El Paso

CACHE OPRS LLEV 3551' GL PG 3600' RT

F.R. 11-19-79
 (Seven Rivers)
 1-14-80 TD 3330'; Rng Csg
 1-22-80 TD 3330'; WOCT
 2-13-80 TD 3470'; POP
 OH 3330-3470'
 Natural (3330-3470')
 1-19-80 TD 3470'; Prep TOP
 4-25-80 TD 3470'; WOPL Conn.
 1-10-80 TD 3470'; Complete
 LOG TOPS: Rustler Anhydrite 1452', Salt 1565',
 Yates 3027'
 BHT 90 deg
 1-15-80 COMPLETION ISSUED

3-3-12 NM
 IC 30-025-70454-79