

NO. OF COPIES RECEIVED	
DISTRIBUTION	
SANTA FE	
FILE	
U.S.G.S.	
LAND OFFICE	
OPERATOR	

NEW MEXICO OIL CONSERVATION COMMISSION

Form C-101
Revised 1-1-65

5-NMOCC-HOBBS
1-R. J. STARRAK-TULSA
1-A. B. CARY-MIDLAND
1-PJB, ENGR.

1-FILE

5A. Indicate Type of Lease	
STATE <input checked="" type="checkbox"/>	FEE <input type="checkbox"/>
5. State Oil & Gas Lease No.	
LG-1487	
7. Unit Agreement Name	
8. Farm or Lease Name	
Getty "35" State Com.	
9. Well No.	
2	
10. Field and Pool, or Wildcat	
Grama Ridge East Morrow	
12. County	
Lea	
19. Proposed Depth	19A. Formation
13,500	Morrow
20. Rotary or C.T.	21. Elevations (Show whether DF, RT, etc.)
Rotary	3658 G.L.
22. Approx. Date Work will start	21A. Kind & Status Plug. Bond
Immediately	Blanket Bond
21B. Drilling Contractor	
Sharp Drilling	

APPLICATION FOR PERMIT TO DRILL, DEEPEN, OR PLUG BACK

1a. Type of Work	
DRILL <input checked="" type="checkbox"/> DEEPEN <input type="checkbox"/> PLUG BACK <input type="checkbox"/>	
b. Type of Well	
OIL WELL <input type="checkbox"/>	GAS WELL <input checked="" type="checkbox"/>
OTHER <input type="checkbox"/>	
2. Name of Operator	
Getty Oil Company	
3. Address of Operator	
P. O. Box 730, Hobbs, New Mexico 88240	
4. Location of Well	
UNIT LETTER	H
LOCATED	1980
FEET FROM THE	North
LINE	
AND	660
FEET FROM THE	East
LINE OF SEC.	35
TWP.	21S
RGE.	34E
NMPM	
19. Proposed Depth	
13,500	
19A. Formation	
Morrow	
20. Rotary or C.T.	
Rotary	
21. Elevations (Show whether DF, RT, etc.)	
3658 G.L.	
21A. Kind & Status Plug. Bond	
Blanket Bond	
21B. Drilling Contractor	
Sharp Drilling	
22. Approx. Date Work will start	
Immediately	

PROPOSED CASING AND CEMENT PROGRAM

SIZE OF HOLE	SIZE OF CASING	WEIGHT PER FOOT	SETTING DEPTH	SACKS OF CEMENT	EST. TOP
26"	20"	94#	40'	Ready Mix	Surface
17 1/2"	13 3/8"	48#	1100'	1200	Surface
12 1/4"	9 5/8"	36 & 40#	5700'	2980	Surface
8 1/2"	7"	26#	11100	2000	Surface
6 1/8"	5"	18#	13500	280	Liner Top

- The above casing prgram will be used to drill to the Morrow formation and any other productive formations. Our mud system will be inverted oil base from 11,100' to 13,500' and brine and brackish water from surface to 11,100'. The Morrow and possibly the Bone Springs will be perforated selectively according to Electric logs.
- See attachment for BOP's and choke manifold.

IN ABOVE SPACE DESCRIBE PROPOSED PROGRAM: IF PROPOSAL IS TO DEEPEN OR PLUG BACK, GIVE DATA ON PRESENT PRODUCTIVE ZONE AND PROPOSED NEW PRODUCTIVE ZONE. GIVE BLOWOUT PREVENTER PROGRAM, IF ANY.

I hereby certify that the information above is true and complete to the best of my knowledge and belief.

Signed Dale R. Crockett Title Area Superintendent Date 2-21-80

(This space for State Use)

APPROVED BY [Signature] TITLE SUPERVISOR DATE [Signature]

CONDITIONS OF APPROVAL, IF ANY:

Rotating Head, If Necessary,
Furnished By Getty

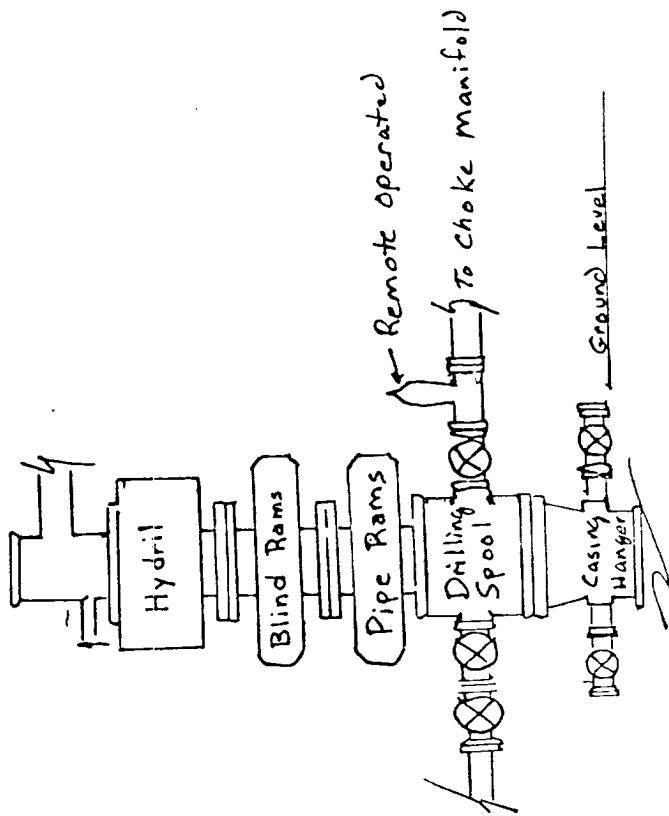

All 5000 psi W.P.

The above stack and manifold system will be used after setting 13 3/8" casing on all other strings.

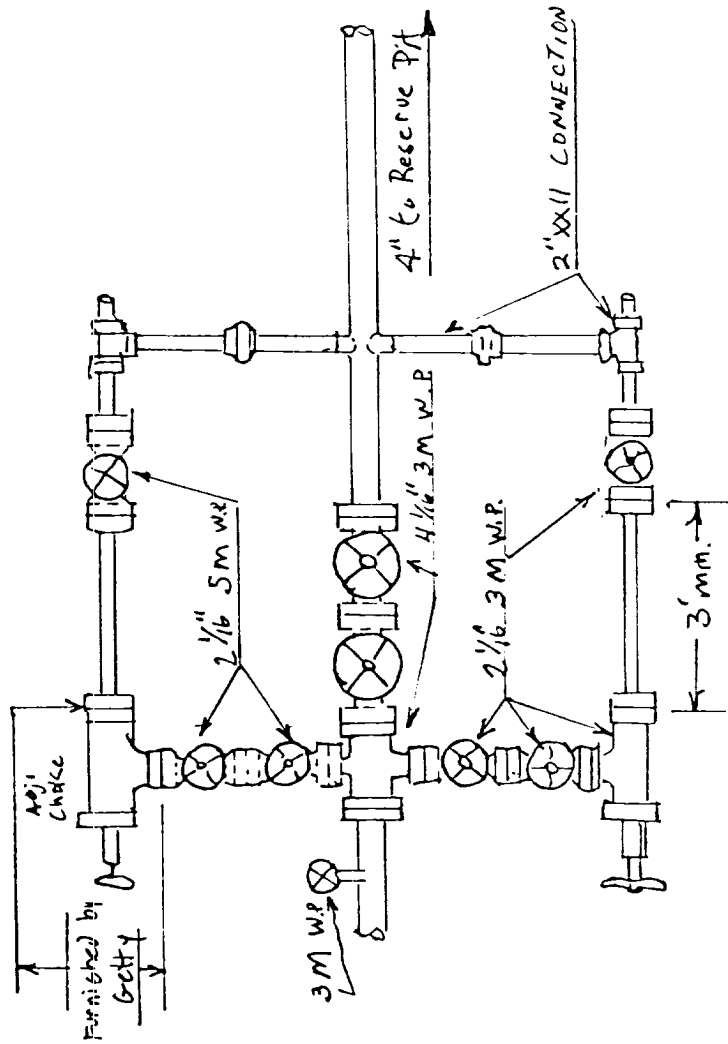

MANIFOLD SHOWN IS MINIMUM THAT IS ACCEPTABLE

GETTY "35" STATE COM. WELL NO. 2
1980' FNL & 660' FEL
SECTION 35, T21S, R34E
LEA COUNTY, NEW MEXICO

1

OIL CONSERVATION DIV.

APR 22 1980

RECEIVED

NEW MEXICO OIL CONSERVATION COMMISSION
WELL LOCATION AND ACREAGE DEDICATION PLAT

Form C-102
Supersedes C-128
Effective 1-1-65

All distances must be from the outer boundaries of the Section

Owner GETTY OIL COMPANY			Lease Getty 35 State Com			Well No. 2
Section 35	Township 21 South	Range 34 East	County Lea			

Actual True Location of Well:
 1980 feet from the North line and 660 feet from the East line
 Elevation 3655 Producing Formation Morrow Pool Grama Ridge East Dedicated Acreage 320 Acres

- Outline the acreage dedicated to the subject well by colored pencil or hachure marks on the plat below.
- If more than one lease is dedicated to the well, outline each and identify the ownership thereof (both as to working interest and royalty)
- If more than one lease of different ownership is dedicated to the well, have the interests of all owners been consolidated by communitization, unitization, force-pooling, etc?

☒ Yes ☐ No If answer is "yes," type of consolidation Communitization

If answer is "no," list the owners and tract descriptions which have actually been consolidated. (Use reverse side of this form if necessary.)

No allowable will be assigned to the well until all interests have been consolidated (by communitization, unitization, forced-pooling, or otherwise) or until a non-standard unit, eliminating such interests, has been approved by the Commission.

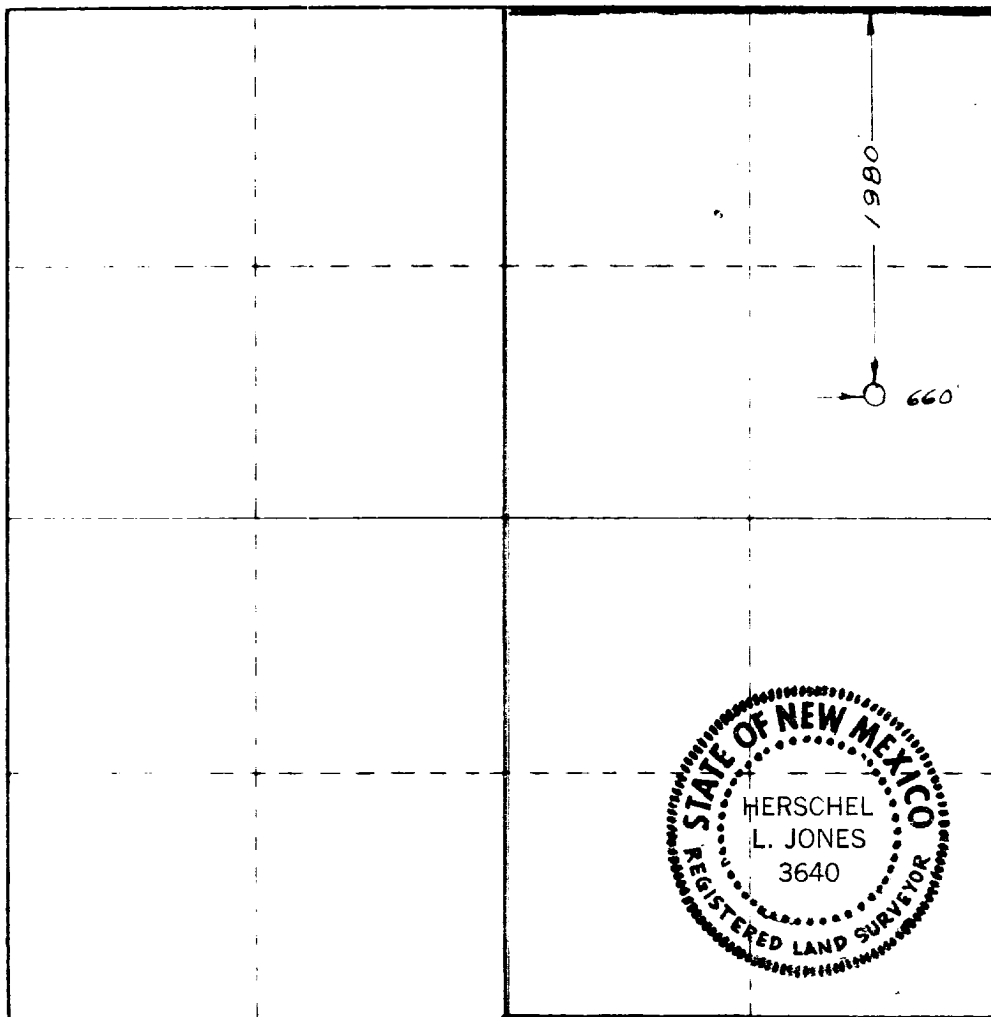

CERTIFICATION

I hereby certify that the information contained herein is true and complete to the best of my knowledge and belief

Dale R. Crockett
Name

Dale R. Crockett

Position

Area Superintendent

Company

Getty Oil Company

Date

February 21, 1980

I hereby certify that the well location shown on this plat was plotted from field notes of actual surveys made by me or under my supervision, and that the same is true and correct to the best of my knowledge and belief

Date Surveyed

January 21, 1980

Registered Professional Engineer and/or Land Surveyor

Herschel L. Jones
Certificate No. 3640

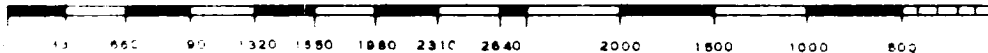

11

OIL CONSERVATION DIV.

FEB 22 1980

RECEIVED

