

**NEW MEXICO OIL CONSERVATION COMMISSION
WELL LOCATION AND ACREAGE DEDICATION PLAT**

Form C-162
Supersedes C-128
Effective 1-1-85

All distances must be from the outer boundaries of the Section

Operator Doyle Hartman			Lease Gutman		Well No. 1
Unit Letter B	Section 13	Township 21 South	Range 36 East	County Lea	
Actual Footage Location of Well: 330 feet from the North line and 1980 feet from the East line					
Ground Level Elev. 3526.9	Producing Formation Grayburg		Pool Eumont	Dedicated Acreage: 40 Acres	

1. Outline the acreage dedicated to the subject well by colored pencil or hachure marks on the plat below.
 2. If more than one lease is dedicated to the well, outline each and identify the ownership thereof (both as to working interest and royalty).
 3. If more than one lease of different ownership is dedicated to the well, have the interests of all owners been consolidated by communitization, unitization, force-pooling, etc? Under NMOCD Order No. R-6333, all unconsolidated interests were force-pooled, and

☒ Yes ☐ No If answer is "yes," type of consolidation Gutman No. 1 ordered to share 160-acre-proration unit and allowable with Gutman No. 2
- If answer is "no," list the owners and tract descriptions which have actually been consolidated. (Use reverse side of this form if necessary.) _____
- No allowable will be assigned to the well until all interests have been consolidated (by communitization, unitization, forced-pooling, or otherwise) or until a non-standard unit, eliminating such interests, has been approved by the Commission.

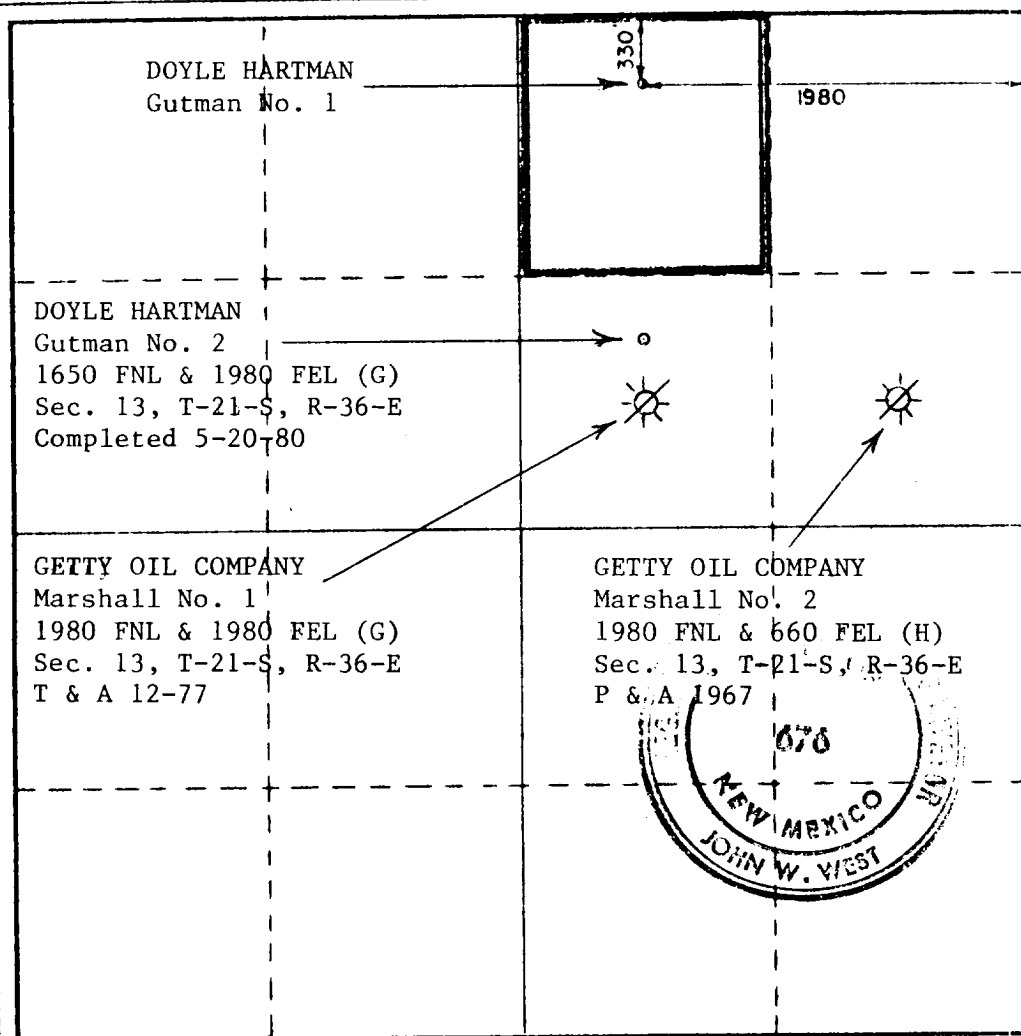

CERTIFICATION

I hereby certify that the information contained herein is true and complete to the best of my knowledge and belief.

Name
Larry A. Romero
Engineer
Doyle Hartman
November 3, 1981

I hereby certify that the well location shown on this plat was plotted from field notes of actual surveys made by me or under my supervision, and that the same is true and correct to the best of my knowledge and belief.

Date Surveyed
4-3-1980

Registered Professional Engineer
and/or Land Surveyor

John W. West
Certificate No. **JOHN W. WEST 677**
PATRICK A. ROMERO 68
Ronald J. Eidson 3

NEW MEXICO OIL CONSERVATION COMMISSION
WELL LOCATION AND ACREAGE DEDICATION PLAT

Form C-10
Supersedes C-128
Effective 1-1-65

All distances must be from the outer boundaries of the Section

Operator Doyle Hartman			Lease Gutman		Well No. 1
Unit Letter B	Section 13	Township 21 South	Range 36 East	County Lea	
Actual Well Location of Well: 330 feet from the North line and 1980 feet from the East line					
Ground Level Elev. 3526.9	Producing Formation Grayburg <i>Queen</i>		Foot Eumont	Dedicated Acreage 160 Acres	

1. Outline the acreage dedicated to the subject well by colored pencil or hatchure marks on the plat below.
2. If more than one lease is dedicated to the well, outline each and identify the ownership thereof (both as to working interest and royalty).
3. If more than one lease of different ownership is dedicated to the well, have the interests of all owners been consolidated by communitization, unitization, force-pooling, etc? Under NMOCD Order No. R-6333, all unconsolidated interests were force-pooled, and

☒ Yes ☐ No If answer is "yes," type of consolidation Gutman No. 1 ordered to share 160-acre proration unit and allowable with Gutman No. 2

If answer is "no," list the owners and tract descriptions which have actually been consolidated. (Use reverse side of this form if necessary.)

No allowable will be assigned to the well until all interests have been consolidated (by communitization, unitization, forced-pooling, or otherwise) or until a non-standard unit, eliminating such interests, has been approved by the Commission.

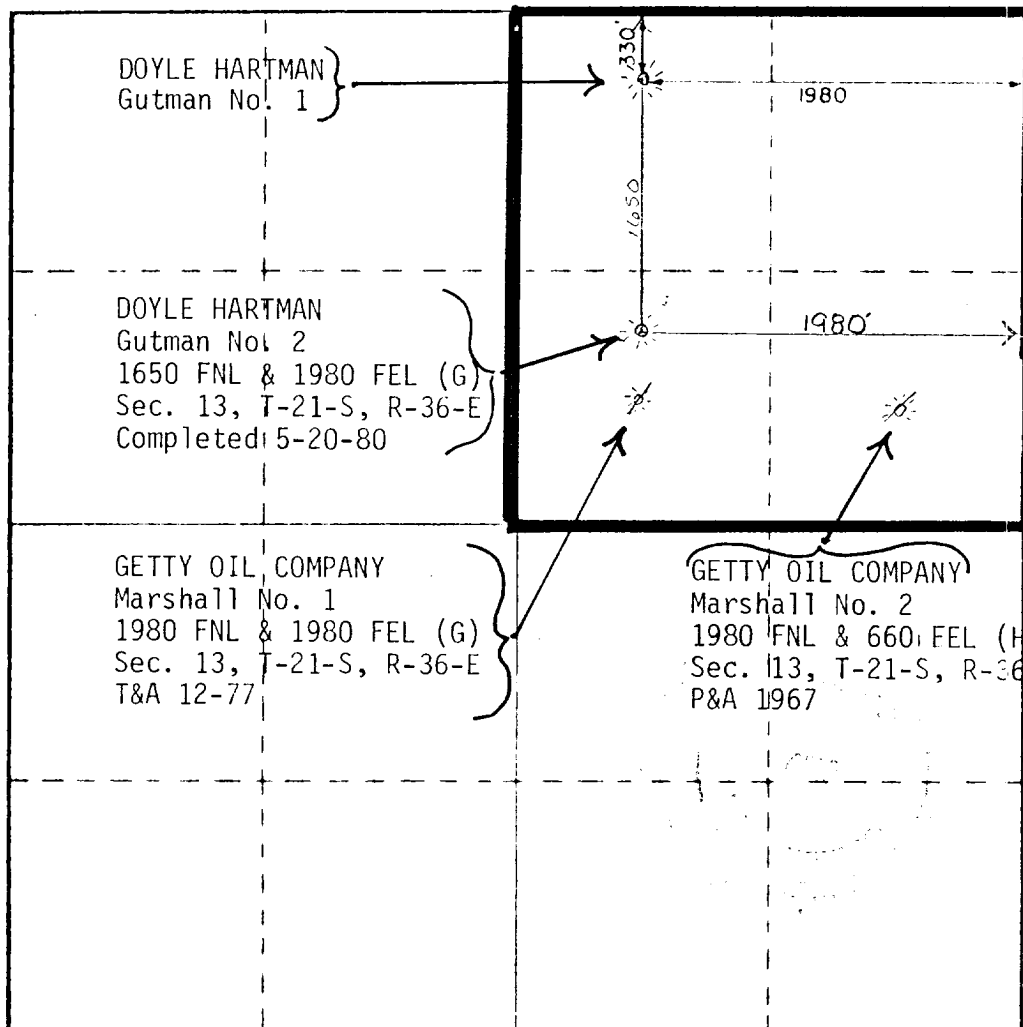

CERTIFICATION

I hereby certify that the information contained herein is true and complete to the best of my knowledge and belief.

Michelle Hembree
Name

Michelle Hembree
Title
Administrative Assistant

Doyle Hartman
Name

October 20, 1980
Date

I hereby certify that the well location shown on this plat was plotted from field notes of actual surveys made by me or under my supervision, and that the same is true and correct to the best of my knowledge and belief.

Date surveyed

4-3-1980

Registered Professional Engineer
and/or Land Surveyor

John W. West
Certificate No. **JOHN W. WEST 67**
PATRICK A. ROMERO 81
Ronald J. Eidson 31

0 330 660 990 1320 1650 1980 2310 2640 2970 3300 3630 3960 4290 4620 4950 5280 5610 5940 6270 6600 6930 7260 7590 7920 8250 8580 8910 9240 9570 9900