

NO. OF COPIES RECEIVED	
DISTRIBUTION	
SANTA FE	
FILE	
U.S.G.S.	
LAND OFFICE	
OPERATOR	

NEW MEXICO OIL CONSERVATION COMMISSION

Form C-101
Revised 1-1-65

5A. Indicate Type of Lease	
STATE <input checked="" type="checkbox"/>	FEE <input type="checkbox"/>
5. State Oil & Gas Lease No.	
L-1640	

APPLICATION FOR PERMIT TO DRILL, DEEPEN, OR PLUG BACK

1a. Type of Work		7. Unit Agreement Name	
b. Type of Well DRILL <input checked="" type="checkbox"/> DEEPEN <input type="checkbox"/> PLUG BACK <input type="checkbox"/> OIL WELL <input type="checkbox"/> GAS WELL <input checked="" type="checkbox"/> OTHER <input type="checkbox"/> SINGLE ZONE <input checked="" type="checkbox"/> MULTIPLE ZONE <input type="checkbox"/>		8. Farm or Lease Name	
2. Name of Operator		South Wilson St.	
Texas Oil & Gas Corp.		9. Well No.	
3. Address of Operator		2	
900 Wilco Bldg. Midland, Texas 79701		10. Field and Pool, or Wildcat	
4. Location of Well		Grama Ridge	
UNIT LETTER "G" LOCATED 1980 FEET FROM THE N LINE			
AND 1980 FEET FROM THE E LINE OF SEC. 26 TWP. 21-S RGE. 34-E NMPM			
		12. County	
		Lea	
		19. Proposed Depth	
		13,200	
		19A. Formation	
		Morrow	
		20. Rotary or C.T.	
		Rotary	
21. Elevations (Show whether DF, RT, etc.)		21B. Drilling Contractor	
21A. Kind & Status Plug. Bond		Not yet determined	
Blanket renewed & updated to \$50,000		22. Approx. Date Work will start	
		4-8-80	

PROPOSED CASING AND CEMENT PROGRAM

SIZE OF HOLE	SIZE OF CASING	WEIGHT PER FOOT	SETTING DEPTH	SACKS OF CEMENT	EST. TOP
17½"	13-3/8	48#	500'	500	Surface
12½"	8-5/8	32#	5700'	2 Stage 230Gsx	Surface
7-7/8"	4½"	11.6# & 13.5#	12,600'	As determined by caliper	Cover pay zone

- (1) Drill 17½" hole to 500' w/FW spud mud. Set 13-3/8 48# H-40 ST&C csg. Cmt to surface.
- (2) Drill out w/12½" drill to approximately 5700' w/Brine Water through salt section.
- (3) Drill out w/7-7/8 w/fresh water to 10,600' (Wolfcamp) & pressure up on hole to test integrity to 11.7 PPG. If hole stands up, drill to TD & adjust weight as necessary for gas control w/gel & barite. Set 5" csg from TD back to surface & cement in place. If hole will not tolerate 11.7 PPG mud, set 7" 26# N-80 FJ Liner 5500'-10,600' & drill to TD w/6" bit. For completion through a 4½" Production Liner set 10,400-13,200'.

IN ABOVE SPACE DESCRIBE PROPOSED PROGRAM: IF PROPOSAL IS TO DEEPEN OR PLUG BACK, GIVE DATA ON PRESENT PRODUCTIVE ZONE AND PROPOSED NEW PRODUCTIVE ZONE. GIVE BLOWOUT PREVENTER PROGRAM, IF ANY.

I hereby certify that the information above is true and complete to the best of my knowledge and belief.

Signed Tommy L. Knowles (Tommy L. Knowles) Dist. Dir. & Prod. Manager Date March 28, 1980

(This space for State Use)

APPROVED BY [Signature] TITLE DIRECTOR DATE MAR 28 1980

CONDITIONS OF APPROVAL, IF ANY:

Approved with understanding that the 7" pipe will be set as per telephone conversation with Mr. Knowles.

NEW MEXICO OIL CONSERVATION COMMISSION
WELL LOCATION AND ACREAGE DEDICATION PLAT

Form C-10,
Supersedes C-128
Effective 1-1-65

All distances must be from the outer boundaries of the Section

Operator TEXAS OIL & GAS CORPORATION			Lease SOUTH WILSON STATE		Well No. 2
Unit Letter "G"	Section 26	Township 21 SOUTH	Range 34 EAST	County LEA	
Actual Footage Location of Well: 1980 feet from the NORTH line and 1980 feet from the EAST line					
Ground Level Elev.	Producing Formation MORROW		Pool GRAMA RIDGE (MORROW)	Dedicated Acreage: 320	

1. Outline the acreage dedicated to the subject well by colored pencil or hachure marks on the plat below.
2. If more than one lease is dedicated to the well, outline each and identify the ownership thereof (both as to working interest and royalty).
3. If more than one lease of different ownership is dedicated to the well, have the interests of all owners been consolidated by communitization, unitization, force-pooling, etc?

☒ Yes ☐ No If answer is "yes," type of consolidation Communitization & Unitization

If answer is "no," list the owners and tract descriptions which have actually been consolidated. (Use reverse side of this form if necessary.)

No allowable will be assigned to the well until all interests have been consolidated (by communitization, unitization, forced-pooling, or otherwise) or until a non-standard unit, eliminating such interests, has been approved by the Commission.

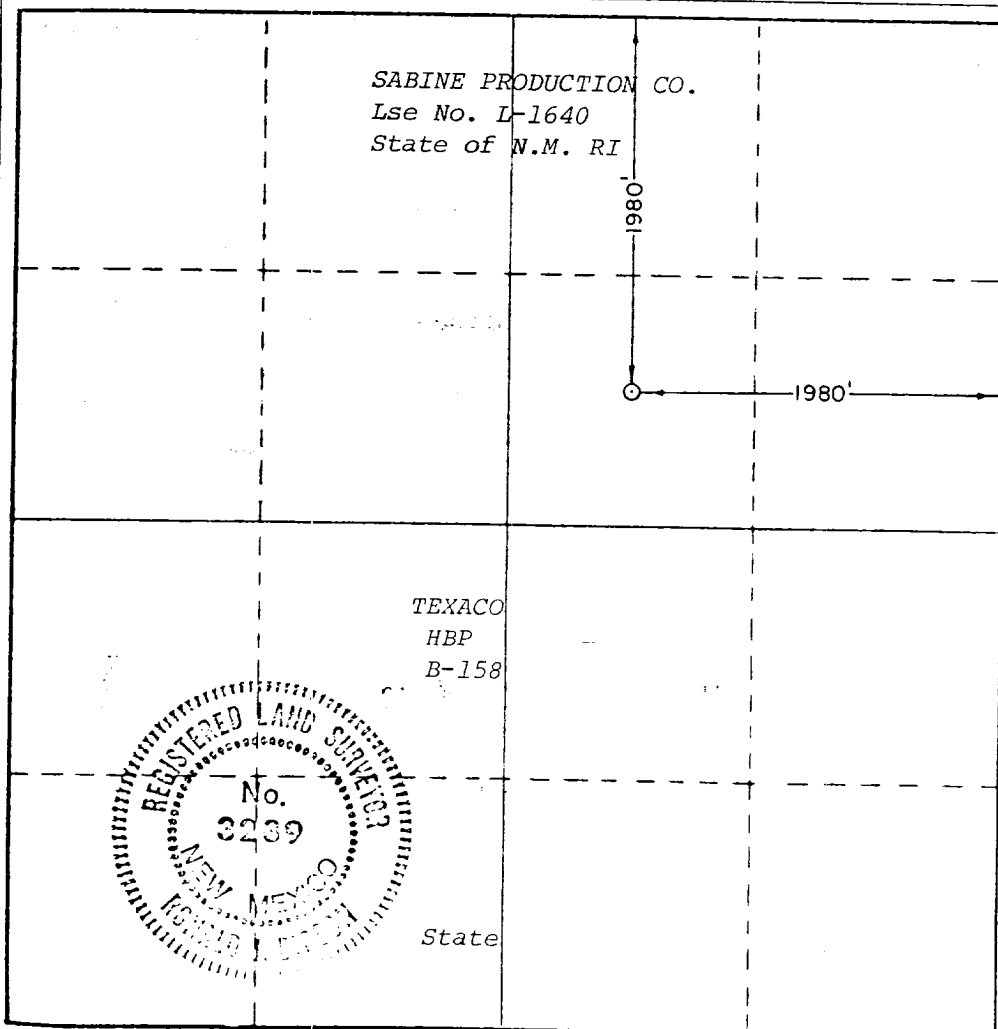

CERTIFICATION

I hereby certify that the information contained herein is true and complete to the best of my knowledge and belief.

Signature: *[Signature]*
Position: (Tommy L. Knowles)
Dist. Drlg. & Prod. Manager

Company
Texas Oil & Gas Corp.

Date
March 28, 1980

I hereby certify that the well location shown on this plat was plotted from field notes of actual surveys made by me or under my supervision, and that the same is true and correct to the best of my knowledge and belief.

Date Surveyed
MARCH 28TH, 1980

Registered Professional Engineer
and Land Surveyor

Signature: *[Signature]*
Certificate No. **John W. West 676**
Ronald J. Eidson 3239

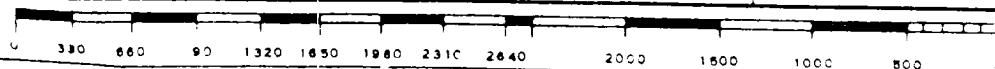

South Wilson St. #2
Lea County, N.M. #1

FLOWLINE EQUIPMENT SKETCH

- 1 - QRC Cameron; 10"; 1500 series; 5,000 lbs. W.P.; double B.O.P.
- Choke Manifold; 4 1/2"; 1500 series; 5,000 lbs. W.P.; w/Cameron hydraulic valve.
- 1 - Positive; 1 - Adjustable choke
- 1 - Koomey Accumulator; 7 Station w/remote control stand; 3,000 lbs. P.S.I.
- 11 - 12"; 900 series; 3,000 lbs. P.S.I.; double Shaffer B.O.P.; to be used for drilling intermediate hole

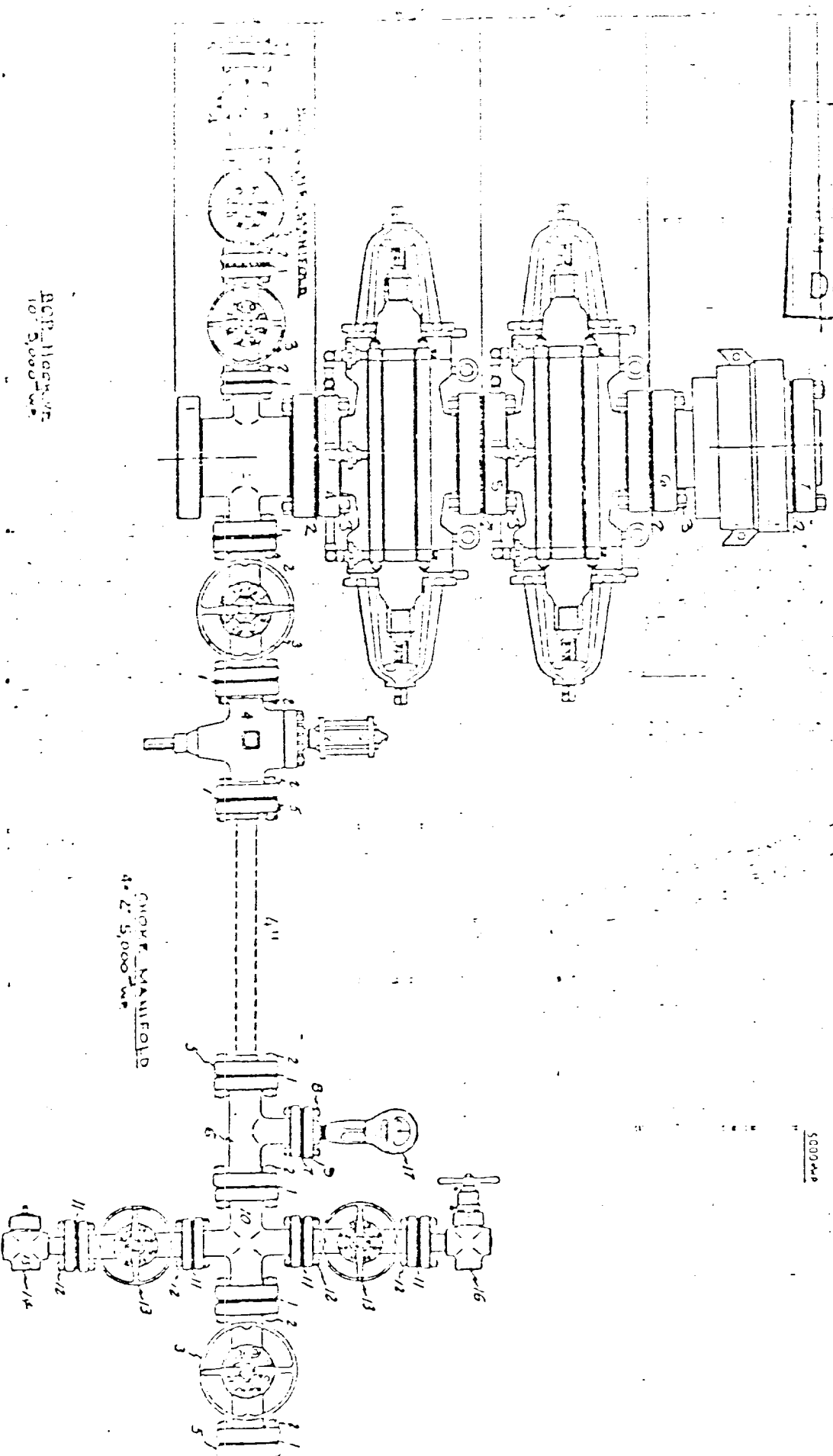

CHOKER MANIFOLD
4" 2" 5,000 W.P.

ACF-111000-01
10" 5,000 W.P.