

30-025-26804

NO. OF COPIES RECEIVED	
DISTRIBUTION	
SANTA FE	
FILE	
U.S.G.S.	
LAND OFFICE	
OPERATOR	

NEW MEXICO OIL CONSERVATION COMMISSION

Form C-101
Revised 1-1-65

5A. Indicate Type of Lease	
STATE <input type="checkbox"/>	FEE <input checked="" type="checkbox"/>
5. State Oil & Gas Lease No.	
7. Unit Agreement Name	
8. Farm or Lease Name	
McQuatters	
9. Well No.	
4	
10. Field and Pool, or Wildcat	
Hardy Drinkard	
12. County	
Lea	
19. Proposed Depth	19A. Formation
6900'	Drinkard
20. Rotary or C.T.	
Rotary	
21. Elevations (Show whether DF, RT, etc.)	22. Approx. Date Work will start
3549.1 Ground	6-30-80

APPLICATION FOR PERMIT TO DRILL, DEEPEN, OR PLUG BACK			
1a. Type of Work			
b. Type of Well			
DRILL <input checked="" type="checkbox"/>	DEEPEN <input type="checkbox"/>	PLUG BACK <input type="checkbox"/>	
OIL WELL <input checked="" type="checkbox"/>	GAS WELL <input type="checkbox"/>	OTHER	SINGLE ZONE <input checked="" type="checkbox"/> MULTIPLE ZONE <input type="checkbox"/>
2. Name of Operator			
The Wiser Oil Company			
3. Address of Operator			
P.O. Box 2467 Hobbs, New Mexico 88240			
4. Location of Well			
UNIT LETTER	G	LOCATED	1650
FEET FROM THE		North	
LINE			
AND	2310	FEET FROM THE	East
LINE OF SEC.		11	
TWP.		21 S	
RGE.		36 E	
NMPM			
21. Elevations (Show whether DF, RT, etc.)			
3549.1 Ground			
21A. Kind & Status Plug. Bond			
Blanket			
21B. Drilling Contractor			
Not Established			
22. Approx. Date Work will start			
6-30-80			

23. PROPOSED CASING AND CEMENT PROGRAM

SIZE OF HOLE	SIZE OF CASING	WEIGHT PER FOOT	SETTING DEPTH	SACKS OF CEMENT	EST. TOP
17-1/2"	13-3/8"	48#	1300'	850 sx	Circ to surf.
11"	8-5/8"	24# & 32#	5000'	2500 sx	Circ to surf
7-7/8"	5-1/2"	15.50#	6900'	550 sx	Tie to 8-5/8"

We plan as soon as a rig is available to drill a Drinkard well to the depth of 6900'. We plan to use the pipe and cement program as described above. We will use sufficient mud program to keep the hole in safe condition at all times. A good BOP will be tested and used while the drilling is in progress. We might run a DST in the Glorietta section and possibly in the Blinbry and Drinkard sections if this is necessary for proper evaluation. After the TD is reached we will run a set of Electric Open Hole Logs to evaluate all possible productive zones. If pipe is run we will perforate and treat as necessary to try for a commercial completion. If after proper evaluation we elect not to run casing the well bore will be plugged in accordance with the Oil Commission rules for plugging.

APPROVAL FOR 90 DAYS UNLESS
DRILLING COMMENCED,

EXPIRES Aug 15, 1980

IN ABOVE SPACE DESCRIBE PROPOSED PROGRAM: IF PROPOSAL IS TO DEEPEN OR PLUG BACK, GIVE BOP OR PRESENT PRODUCTIVE ZONE AND PROPOSED NEW PRODUCTIVE ZONE. GIVE BLOWOUT PREVENTER PROGRAM, IF ANY.

I hereby certify that the information above is true and complete to the best of my knowledge and belief.

Signed B. D. Singleton District Supt. Date 5-14-80

(This space for State Use)

APPROVED BY John W. Ryan TITLE _____ DATE MAY 16 1980

CONDITIONS OF APPROVAL, IF ANY:

NEW MEXICO OIL CONSERVATION COMMISSION
WELL LOCATION AND ACREAGE DEDICATION PLAT

Form C-102
Supersedes C-128
Effective 1-1-65

All distances must be from the outer boundaries of the Section

Operator Wiser Oil Co.		Lease McQuatters		Well No. 4
Unit Letter G	Section 11	Township 21 South	Range 36 East	County Lea
Actual Footage Location of Well: 1650 feet from the North line and 2310 feet from the East line				
Ground Level Elev. 3549.1	Producing Formation Drinkard	Pool Hardy Drinkard	Dedicated Acreage: 40 Acres	

- Outline the acreage dedicated to the subject well by colored pencil or hachure marks on the plat below.
- If more than one lease is dedicated to the well, outline each and identify the ownership thereof (both as to working interest and royalty).
- If more than one lease of different ownership is dedicated to the well, have the interests of all owners been consolidated by communitization, unitization, force-pooling, etc?

☐ Yes ☐ No If answer is "yes," type of consolidation _____

If answer is "no," list the owners and tract descriptions which have actually been consolidated. (Use reverse side of this form if necessary.) _____

No allowable will be assigned to the well until all interests have been consolidated (by communitization, unitization, forced-pooling, or otherwise) or until a non-standard unit, eliminating such interests, has been approved by the Commission.

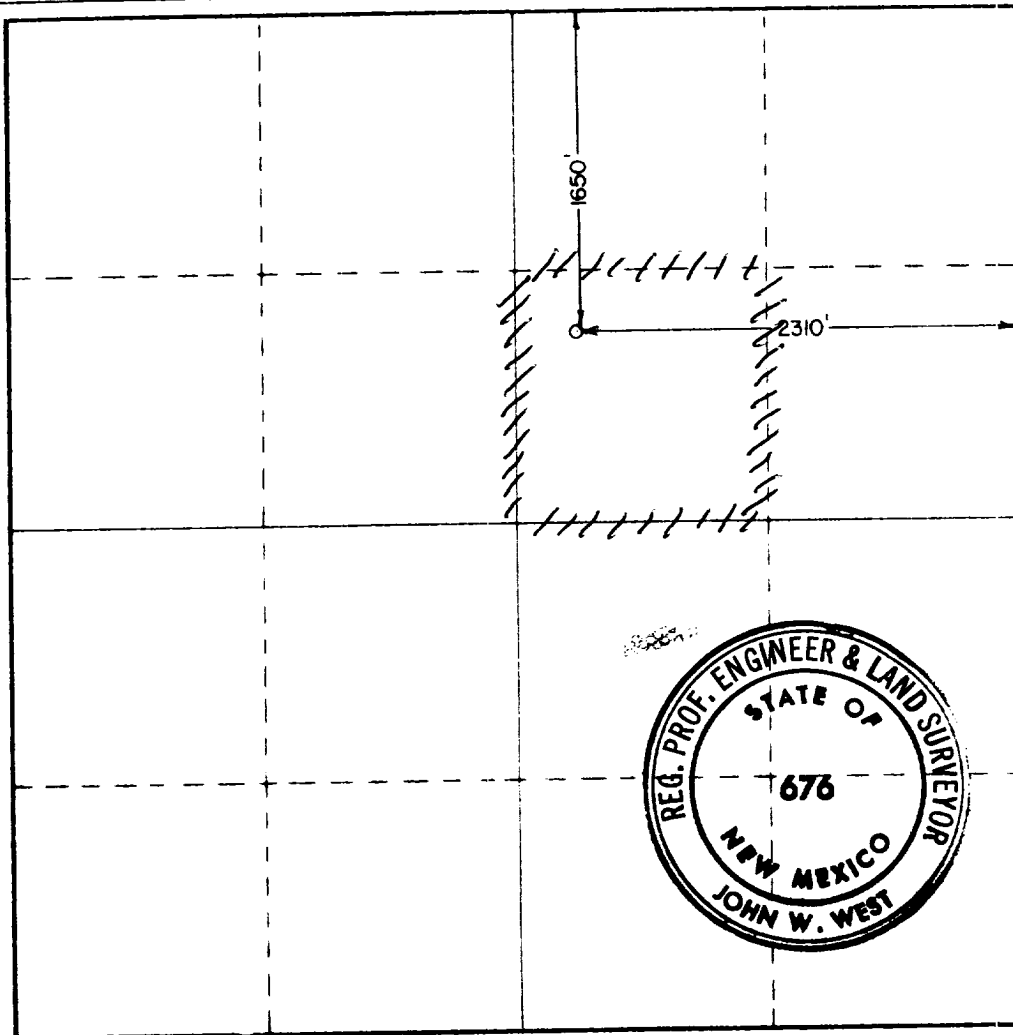

CERTIFICATION

I hereby certify that the information contained herein is true and complete to the best of my knowledge and belief.

Name
B. D. Singletary
Position
District Supt.

Company
The Wiser Oil Company

Date
5-14-80

I hereby certify that the well location shown on this plat was plotted from field notes of actual surveys made by me or under my supervision, and that the same is true and correct to the best of my knowledge and belief.

Date Surveyed
May 9, 1980

Registered Professional Engineer and/or Land Surveyor

John W. West
Certificate No. **JOHN W. WEST 676**
PATRICK A. ROMERO 6863
Ronald J. Eidson 3239

0 330 660 990 1320 1650 1980 2310 2640 2970 3300 3630 3960 4290 4620 4950 5280 5610 5940 6270 6600

RECEIVED

MAY 14 1980

OIL CONSERVATION DIV.

COUNTY **LEA** FIELD **Hardy** STATE **NM**
 OPR **WISER OIL CO., THE** API **30-025-26804**
 NO **4** LEASE **McQuatters** MAP
Sec 11, T21S, R36E CO-ORD
1650 FNL, 2310 FEL of Sec **9-3-25 NM**
1 mi SE/Oil Center SPD **7-2-80** CMP **8-20-80**

	WELL CLASS: INIT D FINDO LSE CODE			
	FORMATION	DATUM	FORMATION	DATUM
13 3/8-1225-800 SX				
9 5/8-4850-3000 SX				
7-6940-475 SX				
2 3/8-6500				
	TD 6940 (DRKD)		PBD 6900	

IP (Drinkard) Perfs 6563-6767 F 48 BOPD + 50 BW. Pot based on
 24 hr test thru 18/64 chk. GOR 6417; gty 40.1; CP Pkr; TP 300

CONTR OPRSELEV **3549 GL** PD **6900 RT**

9-15-80 F.R. 5-26-80
 (Drinkard)
 TD 6940; PBD 6900; Complete
 Perf (Drinkard) 6563-6767 (overall)
 Acid (6563-6767) 6000 gals (15% NE)
 LOG TOPS: Rustler Anhydrite 1245,
 Yates 2625, Queen 3460, Grayburg 3750,
 Glorieta 5190, Blinbry 5720, Tubb 6360,
 Drinkard 6525
 9-20-80 COMPLETION ISSUED

9-3-25 NM
 IC 30-025-70219-80