

NEW MEXICO OIL CONSERVATION COMMISSION
WELL LOCATION AND ACREAGE DEDICATION PLAT

Form C-1
Supersedes C-128
Effective 1-1-65

All distances must be from the outer boundaries of the Section.

| | | | | | |
|---|---------------------------------------|------------------------|-----------------------------|----------------------|--|
| Operator Alpha Twenty-One Production Company | | | Lease Lansford | | Well No. 4 |
| Unit Letter 0 | Section 21 | Township 21S | Range 37E | County Lea | |
| Actual Footage Location of Well: 1880 feet from the East line and 810 feet from the South line | | | | | |
| Ground Level Elev. 3447 | Producing Formation Penrose | | Pool Eumont (Gas) | | Dedicated Acreage: 120 Acres |

1. Outline the acreage dedicated to the subject well by colored pencil or hachure marks on the plat below.
2. If more than one lease is dedicated to the well, outline each and identify the ownership thereof (both as to working interest and royalty).
3. If more than one lease of different ownership is dedicated to the well, have the interests of all owners been consolidated by communitization, unitization, force-pooling, etc?

☐ Yes ☐ No If answer is "yes," type of consolidation _____

If answer is "no," list the owners and tract descriptions which have actually been consolidated. (Use reverse side of this form if necessary.) _____

No allowable will be assigned to the well until all interests have been consolidated (by communitization, unitization, forced-pooling, or otherwise) or until a non-standard unit, eliminating such interests, has been approved by the Commission.

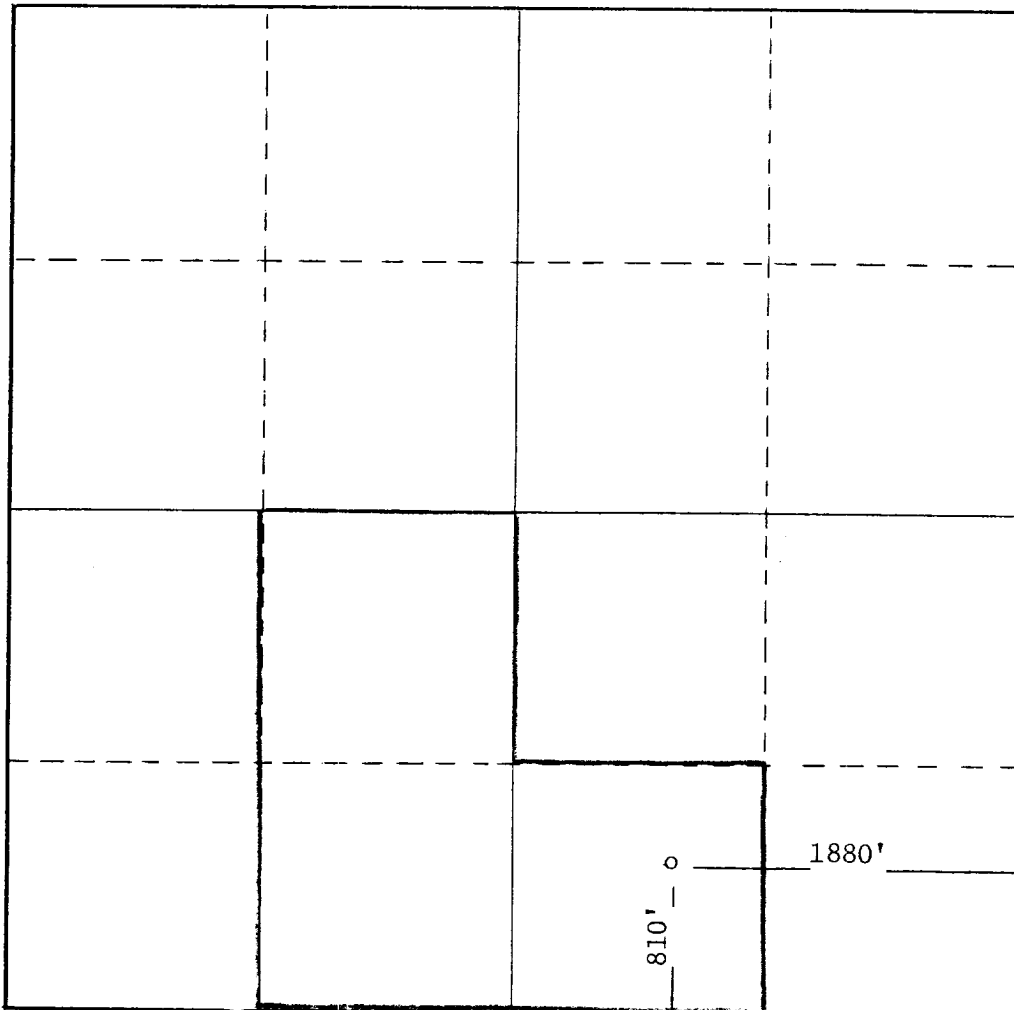

CERTIFICATION

I hereby certify that the information contained herein is true and complete to the best of my knowledge and belief.

Name
Tommy Phipps
Position
Executive Vice President
Company
Alpha Twenty-One Production Co.
Date
May 6, 1981

I hereby certify that the well location shown on this plat was plotted from field notes of actual surveys made by me or under my supervision, and that the same is true and correct to the best of my knowledge and belief.

Date Surveyed

Registered Professional Engineer and/or Land Surveyor

Certificate No.