

District I
PO Box 1980, Hobbs, NM 88241-1980
District II
PO Drawer DD, Artesia, NM 88211-0719
District III
1000 Rio Brazos Rd., Aztec, NM 87410
District IV
PO Box 2088, Santa Fe, NM 87504-2088

State of New Mexico
Energy, Minerals & Natural Resources Department

OIL CONSERVATION DIVISION
PO Box 2088
Santa Fe, NM 87504-2088

Form C-101
Revised February 10, 1994
Instructions on back
Submit to Appropriate District Office
State Lease - 6 Copies
Fee Lease - 5 Copies

☐ AMENDED REPORT

APPLICATION FOR PERMIT TO DRILL, RE-ENTER, DEEPEN, PLUGBACK, OR ADD A ZONE

¹ Operator Name and Address. YATES PETROLEUM CORPORATION 105 South Fourth Street Artesia, NM 88210		² OGRID Number 025575
⁴ Property Code 17550	⁵ Property Name Hunt APO State	³ API Number 30 - 025-27135
		⁶ Well No. 1

⁷ Surface Location

UL or lot no.	Section	Township	Range	Lot Idn	Feet from the	North/South line	Feet from the	East/West line	County
T 17	4	21S	34E		2310	South	660	West	Lea

⁸ Proposed Bottom Hole Location If Different From Surface

UL or lot no.	Section	Township	Range	Lot Idn	Feet from the	North/South line	Feet from the	East/West line	County
⁹ Proposed Pool 1 Grame Ridge Berry Bone Spring, North					¹⁰ Proposed Pool 2				

¹¹ Work Type Code E	¹² Well Type Code O	¹³ Cable/Rotary R	¹⁴ Lease Type Code S	¹⁵ Ground Level Elevation 3730
¹⁶ Multiple No	¹⁷ Proposed Depth 10900'	¹⁸ Formation Bone Spring	¹⁹ Contractor Undesignated	²⁰ Spud Date 10-01-95

²¹ Proposed Casing and Cement Program

Hole Size	Casing Size	Casing weight/foot	Setting Depth	Sacks of Cement	Estimated TOC
17 1/2"	13 3/8"	54.5#	1113' -in place	900 sx	Circulated
12 1/4"	9 5/8"	36# & 40# & 43.5#	5757' -in place	2460 sx	Circulated
8 1/2"	7"	23# & 26#	11430' -in place	825 sx	4400'
6 1/4"	5" liner	18#	11154' -14315' -in place	400 sx	Top of liner

²² Describe the proposed program. If this application is to DEEPEN or PLUG BACK give the data on the present productive zone and proposed new productive zone. Describe the blowout prevention program, if any. Use additional sheets if necessary.

Propose to re-enter this well drilling and cleaning out the cement plugs to approximately a TD of 10,900', squeeze off Delaware perms 5805 - 5929' and test select Bone Spring sand intervals to establish commercial oil production.

BOPE PROGRAM: See Exhibit B

Permit Expires 6 Months From Approval Date Unless Drilling Underway.

²³ I hereby certify that the information given above is true and complete to the best of my knowledge and belief.

Signature:

Clifton R. May

Printed name:

Clifton R. May

Title:

Regulatory Agent

Date:

9-14-95

Phone:

505-748-1471

OIL CONSERVATION DIVISION

Approved by:

Orig. Signed by

Title:

Paul Kautz
Geologist

Approval Date:

SEP 15 1995

Expiration Date:

Conditions of Approval:

Attached ☐

District I
PO Box 1980, Hobbs, NM 88241-1980
District II
PO Drawer DD, Artesia, NM 88211-0719
District III
1000 Rio Brazos Rd., Aztec, NM 87410
District IV
PO Box 2088, Santa Fe, NM 87504-2088

State of New Mexico
Energy, Minerals & Natural Resources Department

OIL CONSERVATION DIVISION
PO Box 2088
Santa Fe, NM 87504-2088

Form C-102
Revised February 10, 1994
Instructions on back
Submit to Appropriate District Office
State Lease - 4 Copies
Fee Lease - 3 Copies

☐ AMENDED REPORT

WELL LOCATION AND ACREAGE DEDICATION PLAT

API Number 30-025-27135		Pool Code 28434 5535		Pool Name Grane Ridge Berry Bone Spring, North	
Property Code 17550	Property Name Hunt APO State			Well Number 1	
OGRID No. 025575	Operator Name YATES PETROLEUM CORPORATION			Elevation 3730	

¹⁰ Surface Location

UL or lot no.	Section	Township	Range	Lot Idn	Feet from the	North/South line	Feet from the	East/West line	County
T	4	21S	34E		2310	South	660	West	Lea

¹¹ Bottom Hole Location If Different From Surface

UL or lot no.	Section	Township	Range	Lot Idn	Feet from the	North/South line	Feet from the	East/West line	County
¹² Dedicated Acres 40		¹³ Joint or Infill		¹⁴ Consolidation Code		¹⁵ Order No.			

NO ALLOWABLE WILL BE ASSIGNED TO THIS COMPLETION UNTIL ALL INTERESTS HAVE BEEN CONSOLIDATED
OR A NON-STANDARD UNIT HAS BEEN APPROVED BY THE DIVISION

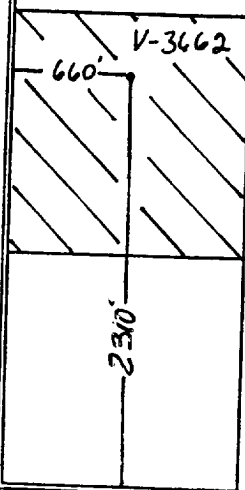
<div>16</div> 				<div>17 OPERATOR CERTIFICATION</div> <p>I hereby certify that the information contained herein is true and complete to the best of my knowledge and belief.</p> <p><i>Clifton R. May</i> Signature Clifton R. May Printed Name Regulatory Agent Title 9-14-95 Date</p>	
				<div>18 SURVEYOR CERTIFICATION</div> <p>I hereby certify that the well location shown on this plat was plotted from field notes of actual surveys made by me or under my supervision, and that the same is true and correct to the best of my belief.</p> <p>Refer to original plat Date of Survey Signature and Seal of Professional Surveyor: Certificate Number</p>	

NEW MEXICO OIL CONSERVATION COMMISSION
WELL LOCATION AND ACREAGE DEDICATION PLAT

Form C-102
Supersedes C-128
Effective 1-1-65

All distances must be from the outer boundaries of the Section.

Operator HUNT OIL COMPANY			Lease STATE 4		Well No. 1
Unit Letter T	Section 4	Township 21-S	Range 34-E	County Lea County, New Mexico	
Actual Footage Location of Well: 2310 feet from the South line and 660' feet from the West line					
Ground Level Elev: 3730'	Producing Formation Morrow	Pool Wildcat		Dedicated Acreage: 320 Acres	

1. Outline the acreage dedicated to the subject well by colored pencil or hachure marks on the plat below.
2. If more than one lease is dedicated to the well, outline each and identify the ownership thereof (both as to working interest and royalty).
3. If more than one lease of different ownership is dedicated to the well, have the interests of all owners been consolidated by communitization, unitization, force-pooling, etc?

☐ Yes ☐ No If answer is "yes," type of consolidation _____

If answer is "no," list the owners and tract descriptions which have actually been consolidated. (Use reverse side of this form if necessary.) _____

No allowable will be assigned to the well until all interests have been consolidated (by communitization, unitization, forced-pooling, or otherwise) or until a non-standard unit, eliminating such interests, has been approved by the Commission.

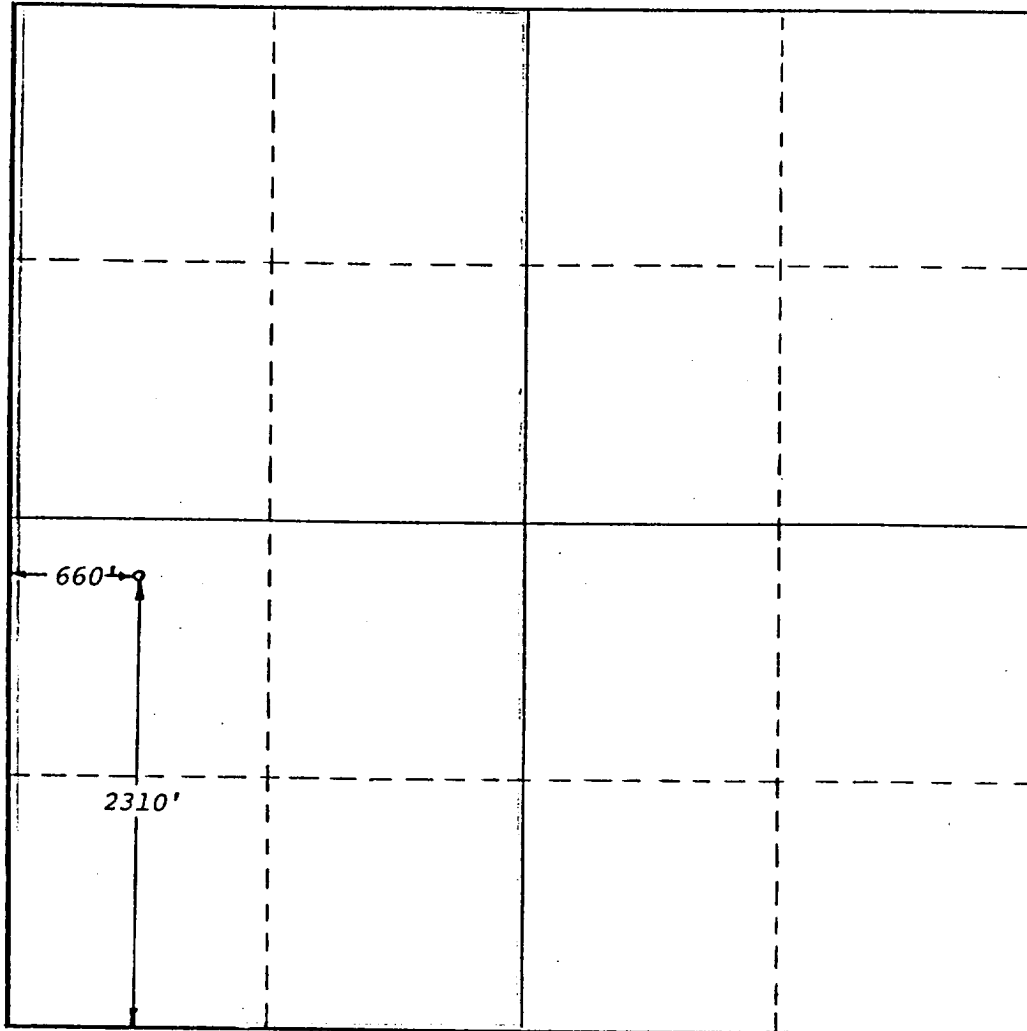

CERTIFICATION

I hereby certify that the information contained herein is true and complete to the best of my knowledge and belief.

Eugene Davenport
Name

District Engineer

Position

Hunt Oil Company

Company

11-4-80

Date

I hereby certify that the well location shown on this plat was plotted from field notes, actual surveys made by me or under my supervision, and that the same is true and correct to the best of my knowledge and belief.

NO. 6689
November 3, 1980

Date Surveyed
Gary D. Boswell
Registered Professional Engineer
and/or Land Surveyor

Gary D. Boswell
Certificate No. _____

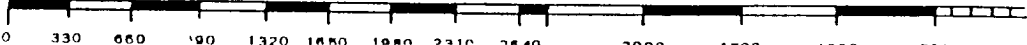

YATES PETROLEUM CORPORATION

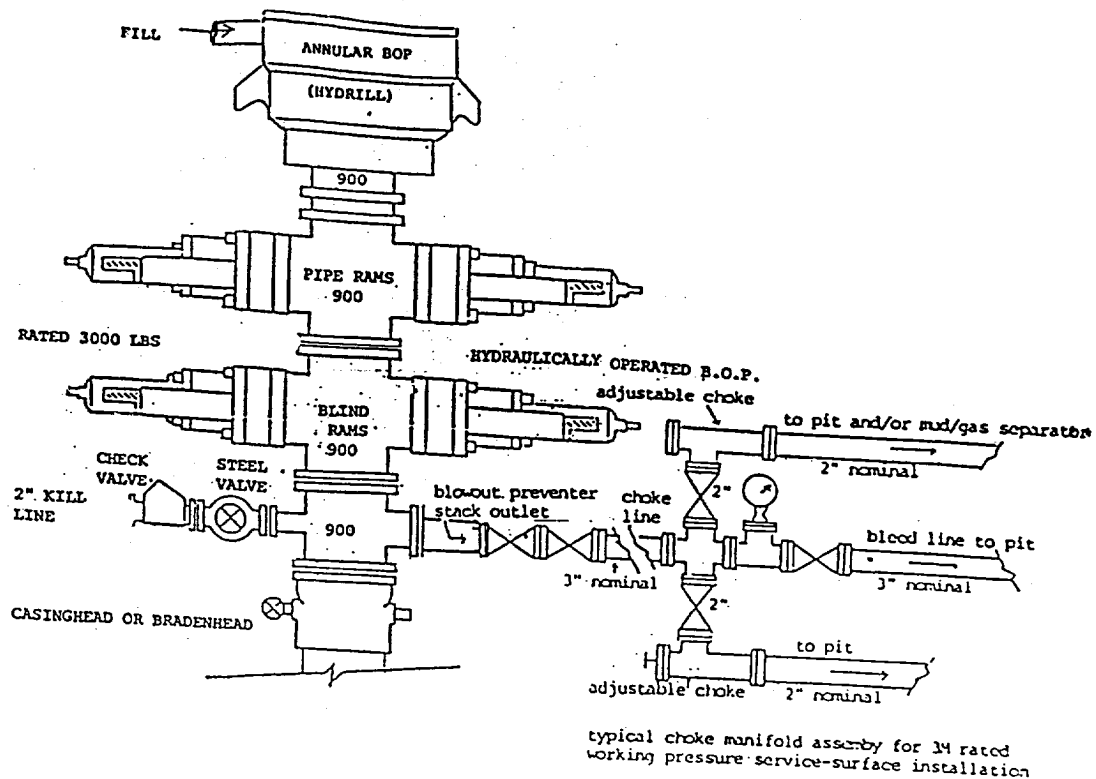

EXHIBIT B

THE FOLLOWING CONSTITUTES THE MINIMUM BLOWOUT PREVENTER REQUIREMENTS FOR 3000 PSI WP SYSTEMS

1. All preventers to be hydraulically operated with secondary manual controls installed prior to drilling out from under casing.
2. Choke outlet to be a minimum of 3" diameter.
3. Kill line to be of all steel construction of 3" minimum diameter.
4. All connections from operating manifolds to preventers to be all steel. Hole or tube to be a minimum of one inch in diameter.
5. The available closing pressure shall be at least 15% in excess of that required with sufficient volume to operate the B.O.P.'s.
6. All connections to and from preventer to have a pressure rating equivalent to that of the B.O.P.'s.
7. Inside blowout preventer to be available on rig floor.
8. Operating controls to be located a safe distance from the rig floor.
9. Hole must be kept filled on trips below intermediate casing.