

MEXICO OIL CONSERVATION COMMISSION
WELL LOCATION AND ACREAGE DEDICATION PLAT

Form C-102
Supersedes C-128
Effective 1-1-65

All distances must be from the outer boundaries of the Section.

Operator Phillips Petroleum Co.			Lease San Simon 32 "A" State (Com)		Well No. 1
Init Letter N	Section 32	Township 21 South	Range 35 East	County Lea	
Actual Footage Location of Well: 660 feet from the South line and 1980 feet from the West line					
Ground Level Elev. 3641.5 (Unprepared)	Producing Formation Morrow	Pool Undesignated	East Hamak Ridge Morrow		Dedicated Acreage: 320 Acres

1. Outline the acreage dedicated to the subject well by colored pencil or hatchure marks on the plat below.
2. If more than one lease is dedicated to the well, outline each and identify the ownership thereof (both as to working interest and royalty).
3. If more than one lease of different ownership is dedicated to the well, have the interests of all owners been consolidated by communitization, unitization, force-pooling, etc?

☒ Yes ☐ No If answer is "yes," type of consolidation Communitization Previously filed
(See reverse for tract identification)

If answer is "no," list the owners and tract descriptions which have actually been consolidated. (Use reverse side of this form if necessary.)

No allowable will be assigned to the well until all interests have been consolidated (by communitization, unitization, forced-pooling, or otherwise) or until a non-standard unit, eliminating such interests, has been approved by the Commission.

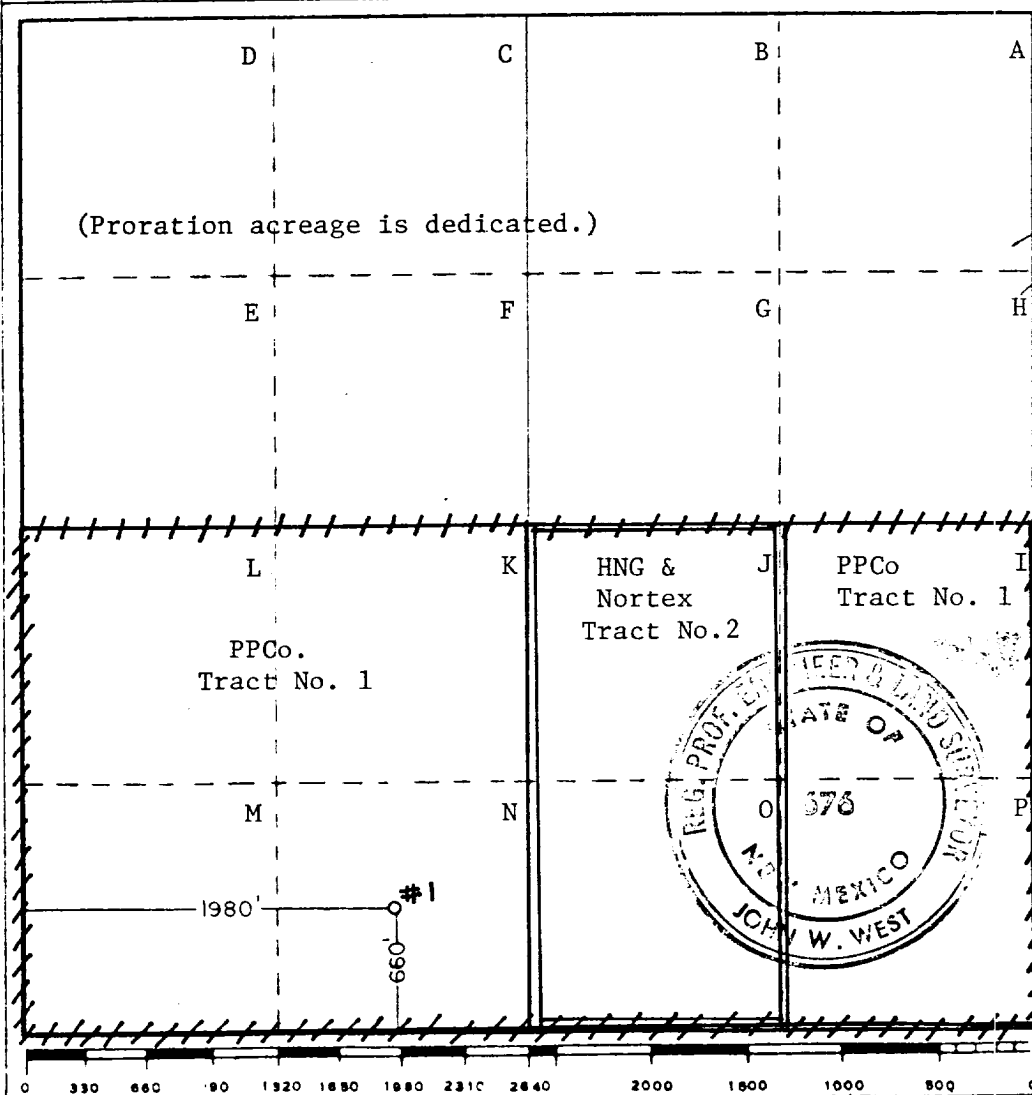

CERTIFICATION

I hereby certify that the information contained herein is true and complete to the best of my knowledge and belief.

W. J. Mueller

Position

Sr. Engineering Specialist

Company

Phillips Petroleum Company

Date

February 27, 1981

I hereby certify that the well location shown on this plat was plotted from field notes of actual surveys made by me or under my supervision, and that the same is true and correct to the best of my knowledge and belief.

Date Surveyed

2-11-81

Registered Professional Engineer and/or Land Surveyor

Certificate No. JOHN W. WEST 878
PATRICK A. ROMERO 8863
Ronald J. Eidson 3239

Phillips Petroleum Company
Tract No. 1

Working - Interest Ownership = 100%
Royalty - Interest Ownership = State of New Mexico, Lease No. E-1924

HNG Oil Company
Tract No. 2

Working - Interest Ownership = 50%
Royalty - Interest Ownership = State of New Mexico, Lease No. L-6943

Nortex Gas & Oil Company
Tract No. 2

Working - Interest Ownership = 50%
Royalty - Interest Ownership = State of New Mexico, Lease No. L-6943

1961 4 MAR

Oil Company