

30-025-27453

| | |
|------------------------|--|
| NO. OF COPIES RECEIVED | |
| DISTRIBUTION | |
| SANTA FE | |
| FILE | |
| U.S.G.S. | |
| LAND OFFICE | |
| OPERATOR | |

NEW MEXICO OIL CONSERVATION COMMISSION

Form C-101
Revised 1-1-65

| | |
|---|------------------------------|
| 5A. Indicate Type of Lease | |
| STATE <input checked="" type="checkbox"/> | FEE <input type="checkbox"/> |

5. State Oil & Gas Lease No.

APPLICATION FOR PERMIT TO DRILL, DEEPEN, OR PLUG BACK

| | | | |
|--|--|--|---|
| 1a. Type of Work | | 7. Unit Agreement Name | |
| b. Type of Well OIL WELL <input type="checkbox"/> GAS WELL <input checked="" type="checkbox"/> OTHER <input type="checkbox"/> | | 8. Farm or Lease Name State LT | |
| 2. Name of Operator Amoco Production Company | | 9. Well No. 1 | |
| 3. Address of Operator P. O. Box 68 Hobbs, NM 88240 | | 10. Field and Pool, or Wildcat Wildcat Morrow | |
| 4. Location of Well UNIT LETTER K LOCATED 1980 FEET FROM THE South LINE AND 1980 FEET FROM THE West LINE OF SEC. 32 TWP. 21-S RGE. 33-E NMPM | | 12. County Lea | |
| 19. Proposed Depth 15000' | | 19A. Formation Morrow | 20. Rotary or C.T. Rotary |
| 21. Elevations (Show whether DF, RT, etc.) 3720.9' | 21A. Kind & Status Plug. Bond Blanket-on-file | 21B. Drilling Contractor NA | 22. Approx. Date Work will start 6-15-81 |

PROPOSED CASING AND CEMENT PROGRAM

| SIZE OF HOLE | SIZE OF CASING | WEIGHT PER FOOT | SETTING DEPTH | SACKS OF CEMENT | EST. TOP |
|--------------|----------------|-----------------|---------------|---------------------|----------|
| 20" | 16" | 65# | 500' | Circ. | Surface |
| 14-3/4" | 10-3/4" | 51# | 5200' | Tie back to 16" | 500' |
| 9-1/2" | 7-5/8" | 39, 33.7# | 11900' | Tie back to 10-3/4" | 5200' |
| 6-1/2" | 4-1/2" | 15.1# | 15000' | Tie back to 7-5/8" | 11900' |

Propose to drill and equip well in the Morrow formation. After reaching TD, logs will be run and evaluated. Will perforate and stimulate as necessary in attempting commercial production.

MUD PROGRAM: 0'-5000' Native mud and fresh water
500'-5200' Native mud and brine
5200'-TD Commercial mud and brine with minimum properties for safe hole conditions. Raise viscosity and reduce water loss prior to Morrow penetration.

BOP Program attached.
Gas is not dedicated.

APPROVAL VALID FOR 180 DAYS
PERMIT EXPIRES 12/15/81
UNLESS DRILLING UNDERWAY

IN ABOVE SPACE DESCRIBE PROPOSED PROGRAM: IF PROPOSAL IS TO DEEPEN OR PLUG BACK, GIVE DATA ON PRESENT PRODUCTIVE ZONE AND PROPOSED NEW PRODUCTIVE ZONE. GIVE BLOWOUT PREVENTER PROGRAM, IF ANY.

I hereby certify that the information above is true and complete to the best of my knowledge and belief.

Signed Greg Mitchell Title Admin. Analyst Date 6-11-81

(This space for State Use)

APPROVED BY [Signature] TITLE SUPERVISOR DISTRICT 1 DATE JUN 15 1981

CONDITIONS OF APPROVAL, IF ANY:

0+6-NMOCD, H 1-Hou 1-W. Stafford, Hou 1-Susp 1-GPM

NEW MEXICO OIL CONSERVATION COMMISSION
WELL LOCATION AND ACREAGE DEDICATION PLAT

Form C-102
Supersedes C-128
Effective 1-4-65

All distances must be from the outer boundaries of the Section

| | | | | | | | | |
|--|--------------------------------------|-----------------------------|-------------------------------|-------------------------|----------------------|--|--|--|
| Operator AMOCO PRODUCTION CO. | | | Lease STATE IT | | | Well No. 1 | | |
| Post Letter K | Section 32 | Township 21 South | | Range 33 East | County Lea | | | |
| Actual Footage Location of Well: 1980 feet from the south line and 1980 feet from the west line | | | | | | | | |
| Ground Level Elev. 3720.9 | Producing Formation Morrow | | Pool Wildcat Morrow | | | Dedicated Acreage: 320 Acres | | |

1. Outline the acreage dedicated to the subject well by colored pencil or hachure marks on the plat below.
2. If more than one lease is dedicated to the well, outline each and identify the ownership thereof (both as to working interest and royalty).
3. If more than one lease of different ownership is dedicated to the well, have the interests of all owners been consolidated by communitization, unitization, force-pooling, etc?

☐ Yes ☐ No If answer is "yes," type of consolidation _____

If answer is "no," list the owners and tract descriptions which have actually been consolidated. (Use reverse side of this form if necessary.) _____

No allowable will be assigned to the well until all interests have been consolidated (by communitization, unitization, forced-pooling, or otherwise) or until a non-standard unit, eliminating such interests, has been approved by the Commission.

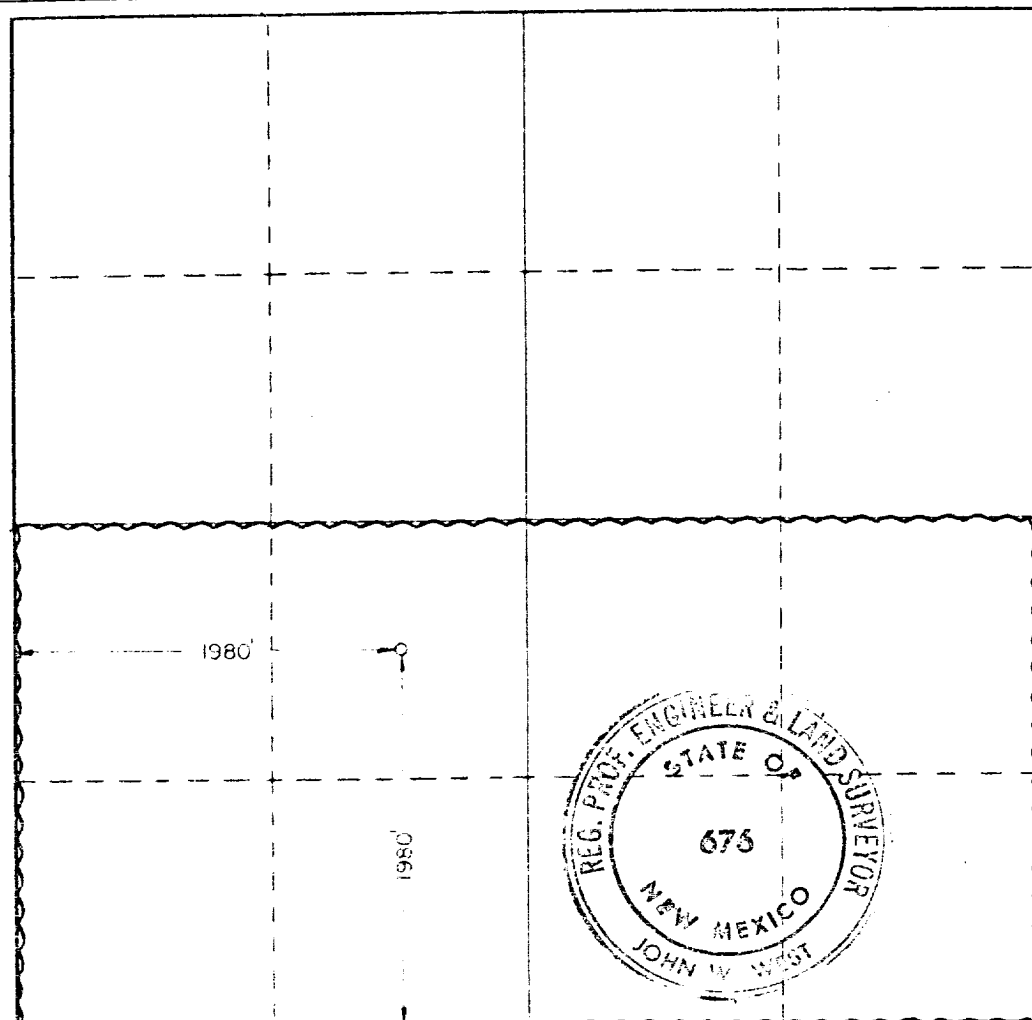

CERTIFICATION

I hereby certify that the information contained herein is true and complete to the best of my knowledge and belief

Greg Mitchell
Name
Admin. Analyst

Position
Amoco Production Company
Company

6-4-81

Date

I hereby certify that the well location shown on this plat was plotted from field notes of actual surveys made by me or under my supervision, and that the same is true and correct to the best of my knowledge and belief.

Date Surveyed
5/28/81

Registered Professional Engineer and/or Land Surveyor

John W. West
Certificate No. **JOHN W. WEST 576**
PATRICK A. ROMERO 6668
Ronald J. Eldon 3232

0 330 660 990 1320 1650 1980 2310 2640 2970 3300 3630 3960 4290 4620 4950 5280 5610 5940 6270 6600

3000# W.P. TWO-RAM BOP

1. BOP'S TO BE FLUID OPERATED.
2. BOP'S AND ALL FITTINGS MUST BE IN GOOD CONDITION AND RATED AT 3000 PSI W.P. MINIMUM.
3. EQUIPMENT THROUGH WHICH BIT MUST PASS SHALL BE AT LEAST AS LARGE AS CASING SIZE BEING DRILLED THROUGH.
4. NIPPLE ABOVE BOP'S SHALL BE SAME SIZE AS LAST CASING SET.
5. UPPER KELLY COCK IS REQUIRED AND SHALL BE 3000# W.P. MINIMUM.
6. T. I. W. OR COMPARABLE SAFETY VALVE SHALL BE AVAILABLE ON RIG FLOOR WITH CONNECTION OR SUBS TO FIT ANY TOOL JOINT IN THE STRING. VALVE TO BE FULL BORE 5000# MIN.
7. VALVE NEXT TO SPOOL SHALL BE 4". OTHER EQUIPMENT MAY BE 3" OR 4". ALL CHOKE MANIFOLD EQUIPMENT SHALL BE FLANGED. FLOW LINE FROM MANIFOLD TO BE MINIMUM OF 3" AND STRAIGHT AS POSSIBLE WITH MINIMUM BENDS.
8. FLUID LINES FROM ACCUMULATOR TO BOP'S AND ALL REMOTE CONTROL FLUID LINES SHALL BE STEEL, AND RATED AT OR ABOVE MAXIMUM ACCUMULATOR PRESSURE. LINES SHALL BE ROUTED IN BUNDLES AND ADEQUATELY PROTECTED FROM DAMAGE.
9. USE RAMS IN FOLLOWING POSITIONS:*

| | <u>DRILLING</u> | <u>RUNNING CASING</u> |
|-----------|-----------------|-----------------------|
| UPPER RAM | DRILL PIPE | CASING |
| LOWER RAM | BLIND | BLIND |

*AMOCO AREA SUPT. MAY REVERSE LOCATION OF RAMS.

10. CHOKE MANIFOLD, BEYOND SECOND VALVE FROM CROSS MAY BE OPTIONALLY POSITIONED OUTSIDE OF SUBSTRUCTURE.
11. EXTENSIONS AND HAND WHEELS TO BE INSTALLED AND BRACED AT ALL TIMES.
12. TWO INCH (2") LINES AND VALVES ARE PERMITTED ON THE KILL LINE.

NOTE: ALL UNMARKED VALVES MAY BE PLUG OR GATE VALVE, METAL TO METAL SEAL.

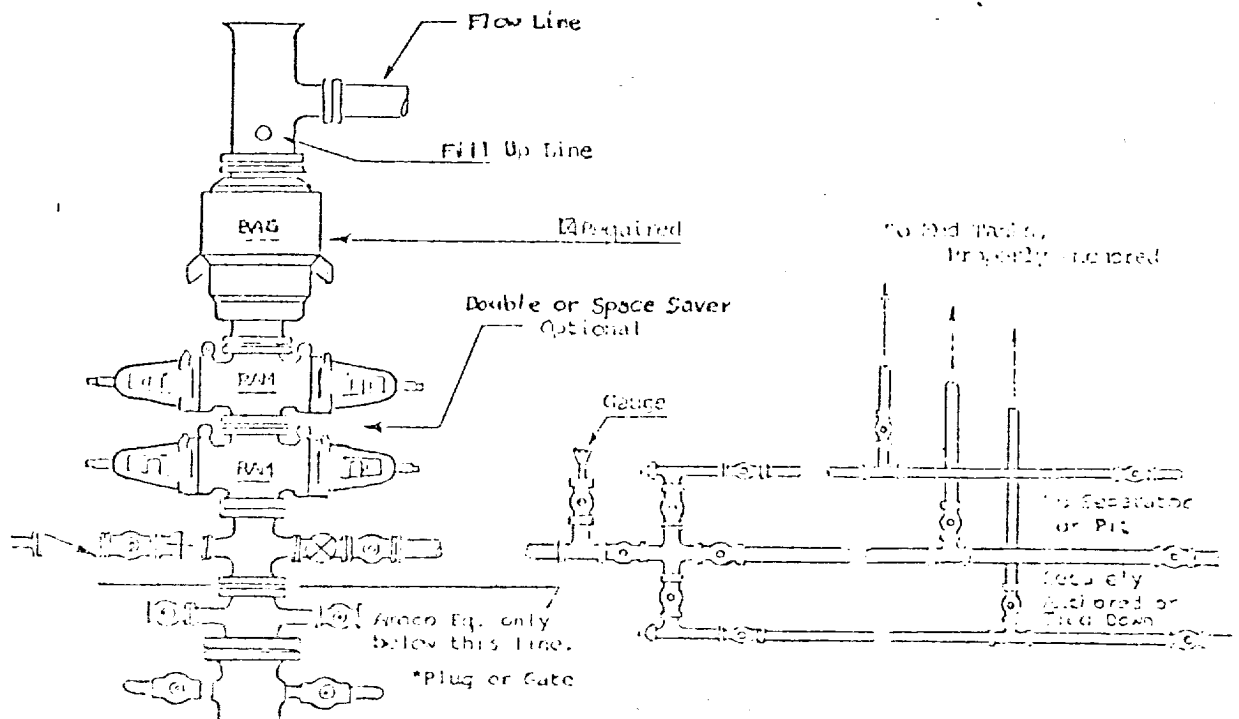

47

RECEIVED
JUN 12 1987
CIVIL SERVICE