

AMENDED TO CORRECT OWNERSHIP RECORD OF COMMUNITIZED TRACTS

NEW MEXICO OIL CONSERVATION COMMISSION
WELL LOCATION AND ACREAGE DEDICATION PLAT

P-T531
Form C-132
Supersedes C-128
Effective 1-4-65

API #30-025-27746

All distances must be from the outer boundaries of the Section

Operator PHILLIPS PETROLEUM CO.		Lease SAN SIMON 32 B-State "COM"		Well No. 1
Unit Letter F	Section 32	Township 21 SOUTH	Range 35 EAST	County LEA
Actual Footage Location of Well: 1980 feet from the NORTH line and 1980 feet from the WEST line				
Ground Level Elev. 3611.7 (unprepared)	Producing Formation Morrow	Pool E, Gramma Ridge Morrow Gas-Ext	Dedicated Acreage: 320 Acres	

1. Outline the acreage dedicated to the subject well by colored pencil or hatchure marks on the plat below.
2. If more than one lease is dedicated to the well, outline each and identify the ownership thereof (both as to working interest and royalty).
3. If more than one lease of different ownership is dedicated to the well, have the interests of all owners been consolidated by communitization, unitization, force-pooling, etc?

* ☒ Yes ☐ No If answer is "yes," type of consolidation Communitization

If answer is "no," list the owners and tract descriptions which have actually been consolidated. (Use reverse side of this form if necessary.)

No allowable will be assigned to the well until all interests have been consolidated (by communitization, unitization, forced-pooling, or otherwise) or until a non-standard unit, eliminating such interests, has been approved by the Commission.

Note acreage is dedicated

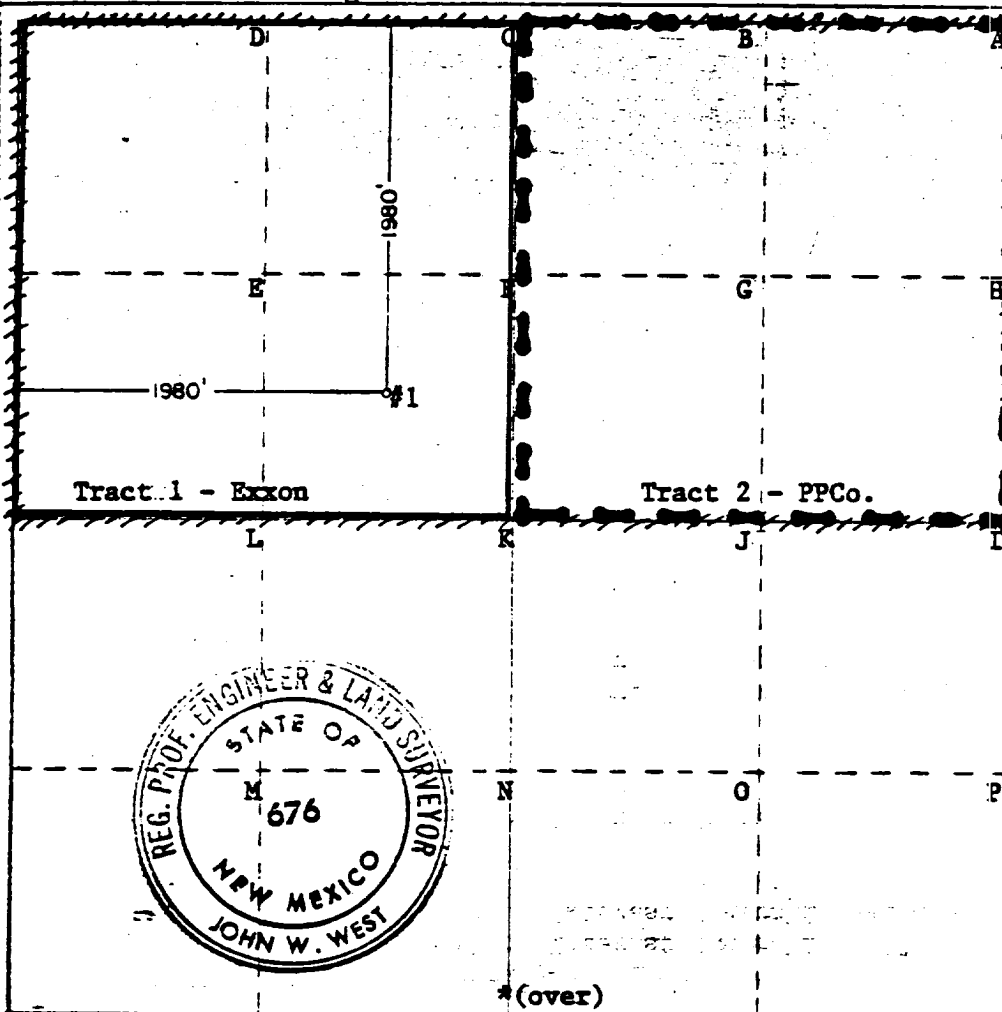

*(over)

CERTIFICATION

I hereby certify that the information contained herein is true and complete to the best of my knowledge and belief.

W. J. Mueller

W. J. Mueller

Position

Sr. Engineering Specialist

Company

Phillips Petroleum Company

Date

February 12, 1982

I hereby certify that the well location shown on this plat was plotted from field notes of actual surveys made by me or under my supervision, and that the same is true and correct to the best of my knowledge and belief.

Date Surveyed

2-8-82

Registered Professional Engineer and/or Land Surveyor

John W. West

Certificate No. JOHN W. WEST

PATRICK A. ROMERO

*

Exxon, USA -
Tract 1 - Working Interest Ownership - 100%
Royalty Interest Ownership - State of New Mexico, Lease B-935
Phillips Petroleum Company -

Tract 2 - Working Interest Ownership - 100%
Royalty Interest Ownership - State of New Mexico, Lease E-1924