

N. M. OIL CONS. COMMISSION
P. O. BOX 1980
HOBBS, NEW MEXICO 88240
UNITED STATES DEPARTMENT OF THE INTERIOR
GEOLOGICAL SURVEY

Form approved.
Budget Bureau No. 42-R1424.

5. LEASE DESIGNATION AND SERIAL NO.

NM-17814

6. IF INDIAN, ALLOTTEE OR TRIBE NAME

7. UNIT AGREEMENT NAME

8. FARM OR LEASE NAME

HODGES FEDERAL

9. WELL NO.

1

10. FIELD AND POOL, OR WILDCAT
Sandhills/Grayburg
San Andres

11. SEC., T., R., M., OR BLK. AND
SURVEY OR AREA

12. COUNTY OR PARISH

Lea

13. STATE

NM

SUNDRY NOTICES AND REPORTS ON WELLS

(Do not use this form for proposals to drill or to deepen or plug back to a different reservoir.
Use "APPLICATION FOR PERMIT—" for such proposals.)

1. OIL WELL ☒ GAS WELL ☐ OTHER ☐

2. NAME OF OPERATOR

MINERALS, INC.

3. ADDRESS OF OPERATOR

P. O. Box 1320, Hobbs, New Mexico, 88240

4. LOCATION OF WELL (Report location clearly and in accordance with any State requirements.
See also space 17 below.)
At surface

330' FSL 330' FEL, Sec. 31, T-20-S, R-39-E

14. PERMIT NO.

15. ELEVATIONS (Show whether DF, RT, GR, etc.)

3561.65 GR

16.

Check Appropriate Box To Indicate Nature of Notice, Report, or Other Data

NOTICE OF INTENTION TO:

TEST WATER SHUT-OFF

FRACTURE TREAT

SHOOT OR ACIDIZE

REPAIR WELL

(Other)

PULL OR ALTER CASING

MULTIPLE COMPLETE

ABANDON*

CHANGE PLANS

SUBSEQUENT REPORT OF:

WATER SHUT-OFF

FRACTURE TREATMENT

SHOOTING OR ACIDIZING

(Other)

REPAIRING WELL

ALTERING CASING

ABANDONMENT*

Subsequent Report

(NOTE: Report results of multiple completion on Well
Completion or Recompletion Report and Log form.)

17. DESCRIBE PROPOSED OR COMPLETED OPERATIONS (Clearly state all pertinent details, and give pertinent dates, including estimated date of starting any proposed work. If well is directionally drilled, give subsurface locations and measured and true vertical depths for all markers and zones pertinent to this work.) *

5-6-82

Set production casing as follows:

Set @ 4385', 109 jts. 5-1/2" 15.5# J-55 csg.

Cement w/450 sx Class "C" with .2% D46. Bumped plug 2:30 P.M.

Est. Top of Cement-2500'. Float held ok. Rig released 5-6-82 @ 6:00 P.M.

5-7-82

W.O. Completion Unit.

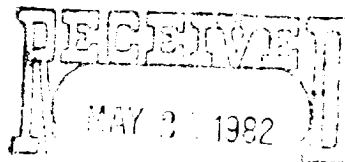

OIL & GAS
U.S. GEOLOGICAL SURVEY
ROSWELL, NEW MEXICO

18. I hereby certify that the foregoing is true and correct

SIGNED

TITLE: President and CEO

(This space for Federal or State office use)

APPROVED BY

CONDITIONS OF APPROVAL, IF ANY:

TITLE:

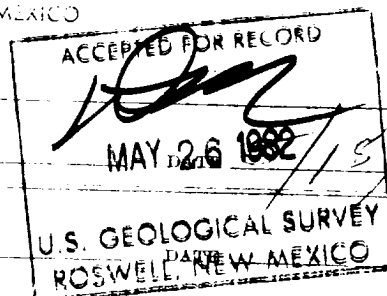

RECEIVED

MAY 26 1982

O.C.D.
HOBBS OFFICE

N. M. OIL CONS. COMMISSION
P. O. BOX 1080
HOBBS, NEW MEXICO 88240
DEPARTMENT OF THE INTERIOR
GEOLOGICAL SURVEY

SUBMIT IN TRIPPLICATE*
(Other instructions on re-
verse side)

Form approved.
Budget Bureau No. 42-R1424.

5. LEASE DESIGNATION AND SERIAL NO.

NM 17814

6. IF INDIAN, ALLOTTEE OR TRIBE NAME

SUNDRY NOTICES AND REPORTS ON WELLS

(Do not use this form for proposals to drill or to deepen or plug back to a different reservoir.
Use "APPLICATION FOR PERMIT—" for such proposals.)

1.

OIL WELL ☒ GAS WELL ☐ OTHER ☐

2. NAME OF OPERATOR

MINERALS, INC.

3. ADDRESS OF OPERATOR

P. O. Box 1320, Hobbs, NM

4. LOCATION OF WELL (Report location clearly and in accordance with any State requirements.*
See also space 17 below.)
At surface

330' FSL, 330' FEL, Sec. 31, T-20-S, R-39-E

7. UNIT AGREEMENT NAME

8. FARM OR LEASE NAME

Hodges Federal

9. WELL NO.

1

10. FIELD AND POOL, OR WILDCAT
Sandhills/Grayburg
San Andres

11. SEC., T., R., M., OR BLK. AND
SURVEY OR AREA

Sec. 31, T20S, R39E

14. PERMIT NO.

15. ELEVATIONS (Show whether DF, RT, GR, etc.)

3561.65 G.R.

12. COUNTY OR PARISH

Lea

13. STATE

NM

16.

Check Appropriate Box To Indicate Nature of Notice, Report, or Other Data

NOTICE OF INTENTION TO:

TEST WATER SHUT-OFF

FRACTURE TREAT

SHOOT OR ACIDIZE

REPAIR WELL

(Other)

PULL OR ALTER CASING

MULTIPLE COMPLETE

ABANDON*

CHANGE PLANS

SUBSEQUENT REPORT OF:

WATER SHUT-OFF

FRACTURE TREATMENT

SHOOTING OR ACIDIZING

(Other)

REPAIRING WELL

ALTERING CASING

ABANDONMENT*

Subsequent Report

(NOTE: Report results of multiple completion on Well
Completion or Recompletion Report and Log form.)

17. DESCRIBE PROPOSED OR COMPLETED OPERATIONS (Clearly state all pertinent details, and give pertinent dates, including estimated date of starting any proposed work. If well is directionally drilled, give subsurface locations and measured and true vertical depths for all markers and zones pertinent to this work.)*

4-29-82 Spudded 12-1/4" hole @ 4:30 P.M. USGS notified 4-29-82

5-1-82 Set surface csg. as follows:
8-5/8" 24# J-55 csg. set @ 1647' and cemented w/756 sx Dowell
65/35 lite poz followed by 100 sx C1 "C" neat tail in. Bumped
plug @ 11:15 P.M. 5-1-82. Circulated 250 sx to surface. USGS
notified 4-30-82. Tested B.O.P. and choke to 500 psi. Drilling
ahead.

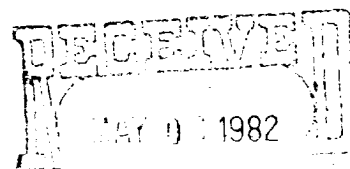

OF A GAS
U.S. GEOLOGICAL SURVEY
HOSWELL, NEW MEXICO

18. I hereby certify that the foregoing is true and correct

SIGNED

(This space for Federal or State office use)

TITLE

President and CEO

DATE

5/4/82

APPROVED BY

CONDITIONS OF APPROVAL, IF ANY:

TITLE

DATE

N. M. OIL CONS. COMMISSION
P. 6 X 1980
HOBBS, NEW MEXICO 88240
UNITED STATES
DEPARTMENT OF THE INTERIOR
GEOLOGICAL SURVEY

SUBMIT IN Llicate*
(Other instructions on
reverse side)

Form approved.
Budget Bureau No. 42-R1425.

30-025-27810

APPLICATION FOR PERMIT TO DRILL, DEEPEN, OR PLUG BACK

1a. TYPE OF WORK

DRILL ☒

DEEPEN ☐

PLUG BACK ☐

b. TYPE OF WELL

OIL WELL ☒

GAS WELL ☐

OTHER ☐

SINGLE ZONE ☐

MULTIPLE ZONE ☐

2. NAME OF OPERATOR

MINERALS, INC.

3. ADDRESS OF OPERATOR

P. O. Box 1320, Hobbs, New Mexico 88240

4. LOCATION OF WELL (Report location clearly and in accordance with any State requirements.)*

At surface

330 FSL, 330' FEL Sec. 31, T20S, R39E

At proposed prod. zone

San Andres

14. DISTANCE IN MILES AND DIRECTION FROM NEAREST TOWN OR POST OFFICE*

1 1/2 miles NE of Eunice, New Mexico

15. DISTANCE FROM PROPOSED*

LOCATION TO NEAREST
PROPERTY OR LEASE LINE, FT.
(Also to nearest drlg. line, if any)

330'

16. NO. OF ACRES IN LEASE

40

17. NO. OF ACRES ASSIGNED
TO THIS WELL

40

18. DISTANCE FROM PROPOSED LOCATION*

TO NEAREST WELL, DRILLING, COMPLETED,
OR APPLIED FOR, ON THIS LEASE, FT.

19. PROPOSED DEPTH

4,450

20. ROTARY OR CABLE TOOLS

Rotary

21. ELEVATIONS (Show whether DF, RT, GR, etc.)

3561.65 GR

22. APPROX. DATE WORK WILL START*

April 1, 1982

23.

PROPOSED CASING AND CEMENTING PROGRAM

SIZE OF HOLE	SIZE OF CASING	WEIGHT PER FOOT	SETTING DEPTH	QUANTITY OF CEMENT
12 1/2	8-5/8"	24#	1,650	850 sx CIRCULATE
7-7/8	5 1/2	15 1/2#	4,450	300 sx

See attachments for blowout preventor, mud program and
complete details of operations

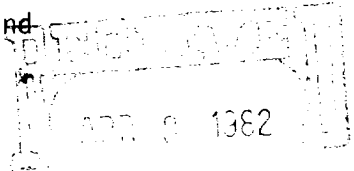

OIL & GAS
U.S. GEOLOGICAL SURVEY
HOBBS, NEW MEXICO

IN ABOVE SPACE DESCRIBE PROPOSED PROGRAM: If proposal is to deepen or plug back, give data on present productive zone and proposed new productive zone. If proposal is to drill or deepen directionally, give pertinent data on subsurface locations and measured and true vertical depths. Give blowout preventer program if any.

24.

SIGNED

President and CEO

DATE

4-6-82

(This space for Federal or State office use)

PERMIT NO.

APPROVED

APPROVAL DATE

APPROVED BY

CONDITIONS OF APPROVAL, IF ANY:

APR 21 1982

DATE

FOR

JAMES A. GILLHAM
DISTRICT SUPERVISOR

See Instructions On Reverse Side

NEW MEXICO OIL CONSERVATION COMMISSION
WELL LOCATION AND ACREAGE DEDICATION PLAT

Form C-102
Supersedes C-128
Effective 1-1-65

All distances must be from the outer boundaries of the Section

Operator Minerals, Inc.			Lease Hodges Federal		Well No. #1
Unit Letter P	Section 31	Township 20 South	Range 39 East	County Lea	
Actual Footage Location of Well: 330 feet from the South line and 330 feet from the East line					
Ground Level Elev. 3561.65	Producing Formation SAN ANDRES		Soil SANDHILLS (GSA)		Dedicated Acreage: 40 Acres

1. Outline the acreage dedicated to the subject well by colored pencil or hachure marks on the plat below.
2. If more than one lease is dedicated to the well, outline each and identify the ownership thereof (both as to working interest and royalty).
3. If more than one lease of different ownership is dedicated to the well, have the interests of all owners been consolidated by communitization, unitization, force-pooling, etc?

☐ Yes ☐ No If answer is "yes," type of consolidation _____

If answer is "no," list the owners and tract descriptions which have actually been consolidated. (Use reverse side of this form if necessary.) _____

No allowable will be assigned to the well until all interests have been consolidated (by communitization, unitization, forced-pooling, or otherwise) or until a non-standard unit, eliminating such interests, has been approved by the Commission.

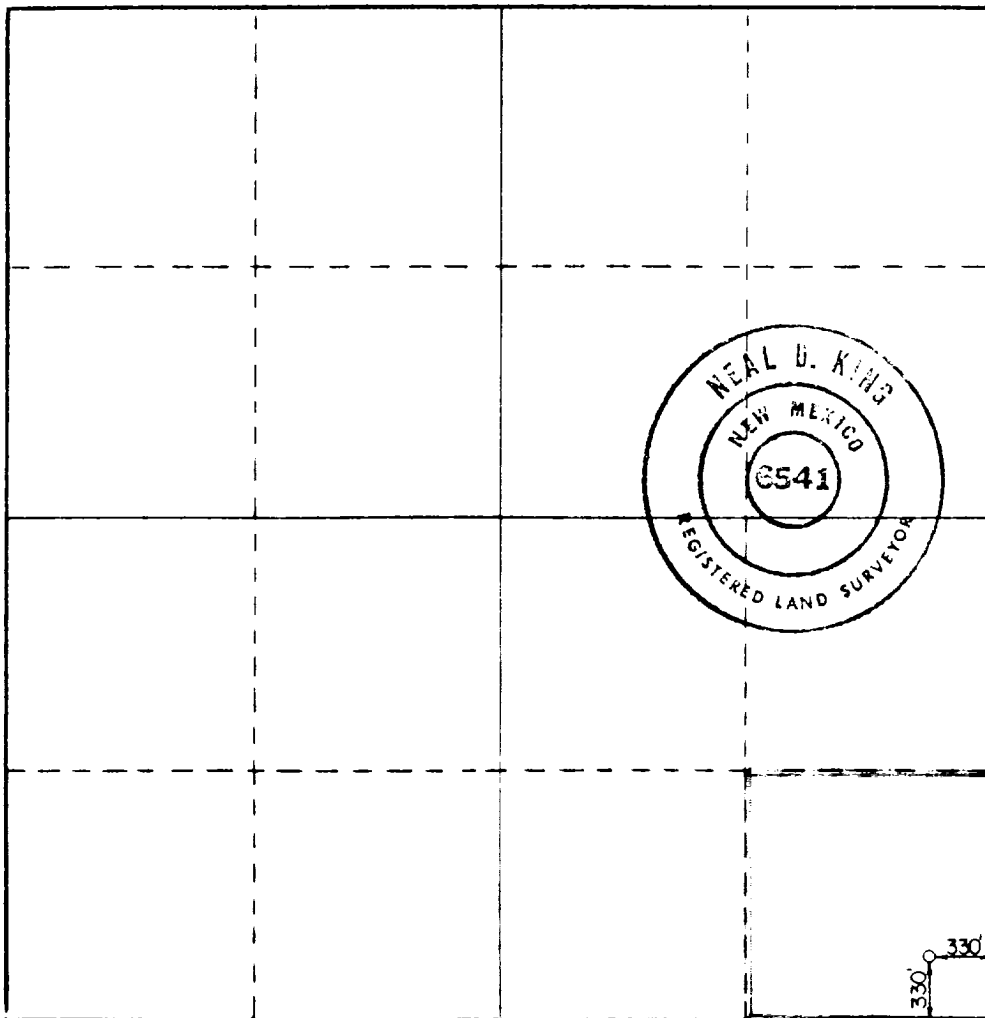

CERTIFICATION

I hereby certify that the information contained herein is true and complete to the best of my knowledge and belief.

Name Neal G. King
Position President and CEO
Company MINERALS, INC.
Date 4-6-82

I hereby certify that the well location shown on this plat was plotted from field notes of actual surveys made by me or under my supervision, and that the same is true and correct to the best of my knowledge and belief.

Date Surveyed February 16, 1982
Registered Professional Engineer and/or Land Surveyor
Neal G. King R.L.S.
Certificate No. 6541

0 330 660 990 1320 1650 1980 2310 2640 2970 3300 0

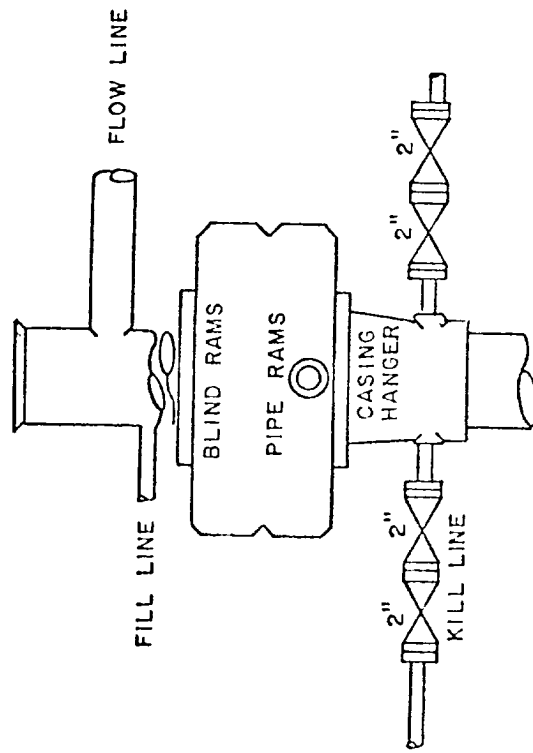

EXHIBIT "C"



ENCLOSURE

FOR (1000)

2002
HOURS OFFICE