

NO. OF COPIES RECEIVED	
DISTRIBUTION	
SANTA FE	
FILE	
U.S.G.S.	
LAND OFFICE	
OPERATOR	

5A. Indicate Type of Lease	
STATE <input type="checkbox"/>	FEE <input checked="" type="checkbox"/>
5. State Oil & Gas Lease No.	

APPLICATION FOR PERMIT TO DRILL, DEEPEN, OR PLUG BACK

1a. Type of Work		7. Unit Agreement Name	
b. Type of Well DRILL <input checked="" type="checkbox"/> DEEPEN <input type="checkbox"/> PLUG BACK <input type="checkbox"/> OIL WELL <input checked="" type="checkbox"/> GAS WELL <input type="checkbox"/> OTHER <input type="checkbox"/> SINGLE ZONE <input checked="" type="checkbox"/> MULTIPLE ZONE <input type="checkbox"/>		D. A. WILLIAMSON	
2. Name of Operator MOBIL PRODUCING TX. & N.M. INC.		8. Farm or Lease Name	
3. Address of Operator NINE GREENWAY PLAZA, SUITE 2700, HOUSTON, TX 77046		9. Well No. 2	
4. Location of Well UNIT LETTER <u>D</u> LOCATED <u>660</u> FEET FROM THE <u>NORTH</u> LINE AND <u>660</u> FEET FROM THE <u>EAST</u> LINE OF SEC. <u>23</u> TWP. <u>21-S</u> RGE. <u>37E</u> NMPM		10. Field and Pool, or Wildcat WANTZ ABO	
		12. County LEA	
		19. Proposed Depth 7500'	
		19A. Formation ABO	
		20. Rotary or C.T. ROTARY	
21. Elevations (show whether DF, RT, etc.) 3407' GROUND		21A. Kind & Status Plug. Bond ON FILE	
		21B. Drilling Contractor UNKNOWN	
		22. Approx. Date Work will start AS SOON AS POSSIBLE	

23.

PROPOSED CASING AND CEMENT PROGRAM

SIZE OF HOLE	SIZE OF CASING	WEIGHT PER FOOT	SETTING DEPTH	SACKS OF CEMENT	EST. TOP
17 1/2"	13 3/8"	54.5#	0-350'	400 Circ	Surface
12 1/4"	8 5/8"	32#	0-5000'	300 Circ	Surface
7 7/8"	5 1/2" liner	15.5#	4700'-TD	300 Circ	4700'-Tie in w/8 5/8"

BLOWOUT PREVENTER PROGRAM:

CASING STRING	EQUIP. SIZE & SERIES	NO. & TYPE	TEST PRESSURE PSI
Surface	13 5/8" X 3000	1 Pipe Ram & 1-MG	3000
Intermediate	9-11" X 5000	1 Pipe Ram & 1-MG	5000

APPROVAL VALID FOR 180 DAYS
PERMIT EXPIRES 3/7/82
UNLESS DRILLING UNDERWAY

IN ABOVE SPACE DESCRIBE PROPOSED PROGRAM: IF PROPOSAL IS TO DEEPEN OR PLUG BACK, GIVE DATA ON PRESENT PRODUCTIVE ZONE AND PROPOSED NEW PRODUCTIVE ZONE. GIVE BLOWOUT PREVENTER PROGRAM, IF ANY.

I hereby certify that the information above is true and complete to the best of my knowledge and belief.

Signed A. D. Bond A. D. BOND Title REGULATORY TECHNICIAN SUPERVISOR Date AUGUST 30, 1984

(This space for State Use)

Eddie W. Seay

APPROVED BY Oil & Gas Inspector TITLE _____ DATE SEP 7 1984

CONDITIONS OF APPROVAL, IF ANY:

All distances must be from the outer boundaries of the Section.

Operator MOBIL PRODUCING TX. & N.M. INC.		Lease D. A. WILLIAMSON		Well No. 2
Unit Letter B/A	Section 23	Township 21-S	Range 37-E	County LEA
Actual Footage Location of Well: 660 feet from the NORTH line and 660 feet from the EAST line				
Ground Level Elev. 3407'	Producing Formation ABO	Pool WANTZ ABO	Dedicated Acreage: 40 Acres	

1. Outline the acreage dedicated to the subject well by colored pencil or hatchure marks on the plat below.
2. If more than one lease is dedicated to the well, outline each and identify the ownership thereof (both as to working interest and royalty).
3. If more than one lease of different ownership is dedicated to the well, have the interests of all owners been consolidated by communitization, unitization, force-pooling, etc?

☐ Yes ☐ No If answer is "yes," type of consolidation _____

If answer is "no," list the owners and tract descriptions which have actually been consolidated. (Use reverse side of this form if necessary.) _____

No allowable will be assigned to the well until all interests have been consolidated (by communitization, unitization, forced-pooling, or otherwise) or until a non-standard unit, eliminating such interests, has been approved by the Division.

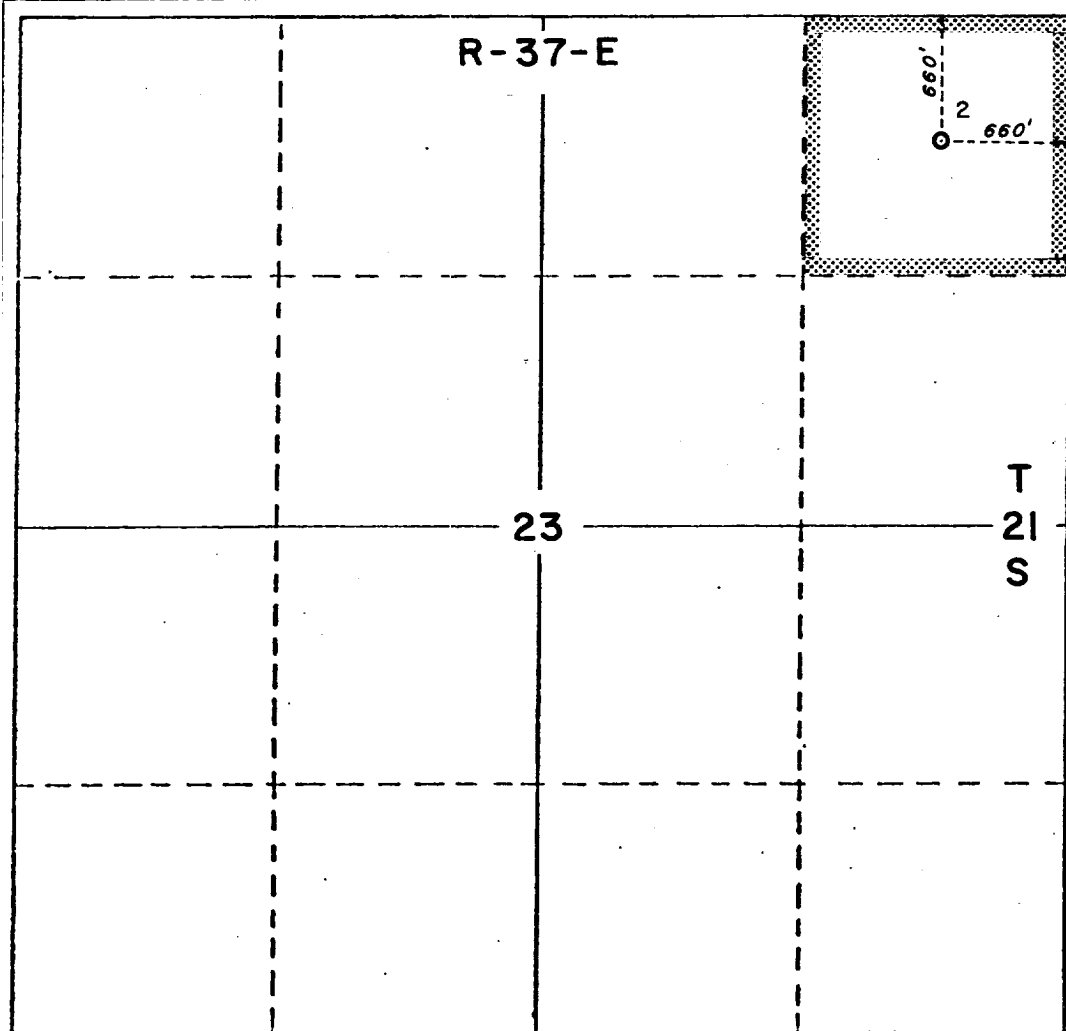

CERTIFICATION

I hereby certify that the information contained herein is true and complete to the best of my knowledge and belief.

A. D. Bond

Name

A. D. BOND

Position

REGULATORY TECHNICIAN SUPV.

Company

MOBIL PRODUCING TX. & N.M. INC.

Date

AUGUST 30, 1984

I hereby certify that the well location shown on this plat was plotted from field notes of actual surveys made by me or under my supervision, and that the same is true and correct to the best of my knowledge and belief.

H. A. Carson

Date Surveyed

7-13-84

Registered Professional Engineer and/or Land Surveyor

H. A. CARSON

Certificate No.

5063

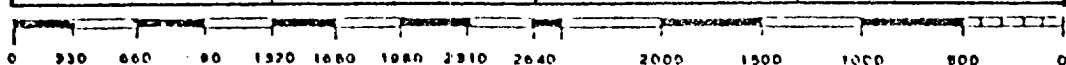

RECEIVED

SEP 6 1984

O.C.D.
HOBBS OFFICE