

All distances must be from the outer boundaries of the Section.

Operator TEMPO ENERGY INC.		Lease M. Deck ESTATE		Well No. 1
Unit Letter "E"	Section 33	Township 21	Range 35	County Lea
Actual Postage Location of Well:				
1650 feet from the North		line and 660		feet from the West line
Ground Level Elev. 3619.5	Producing Formation Yates	Pool No San Simon Yates	Dedicated Acres 40 Acres	

1. Outline the acreage dedicated to the subject well by colored pencil or hatchure marks on the plat below.
2. If more than one lease is dedicated to the well, outline each and identify the ownership thereof (both as to working interest and royalty).
3. If more than one lease of different ownership is dedicated to the well, have the interests of all owners been consolidated by communitization, unitization, force-pooling, etc?

☐ Yes ☐ No If answer is "yes," type of consolidation _____

If answer is "no," list the owners and tract descriptions which have actually been consolidated. (Use reverse side of this form if necessary.) _____

No allowable will be assigned to the well until all interests have been consolidated (by communitization, unitization, forced-pooling, or otherwise) or until a non-standard unit, eliminating such interests, has been approved by the Division

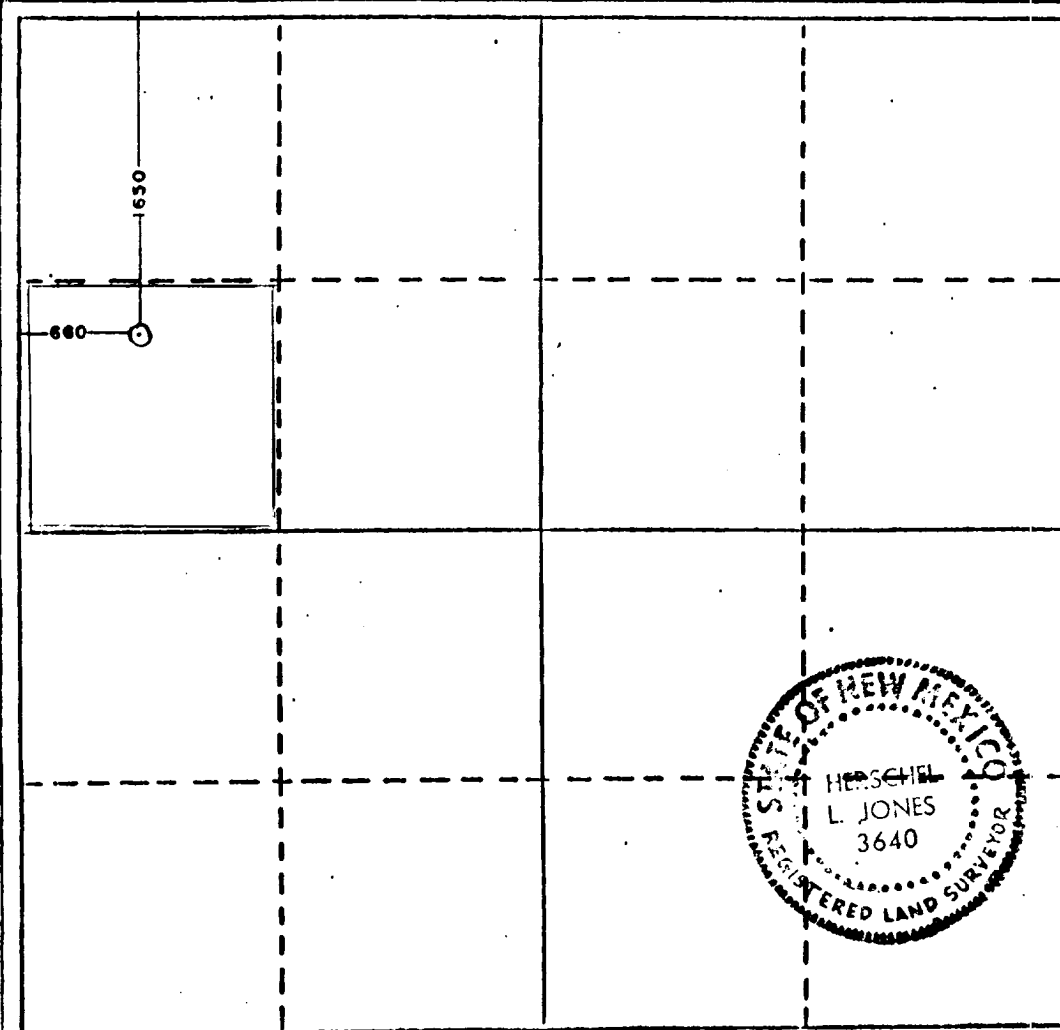

CERTIFICATION

I hereby certify that the information contained herein is true and complete to the best of my knowledge and belief.

Name
Joe D. Peterson Consulting Ag
Position
Tempo Energy
Company
2-7-86
Date

I hereby certify that the well location shown on this plat was plotted from field notes of actual surveys made by me or under my supervision, and that the same is true and correct to the best of my knowledge and belief.

Date Surveyed
1/31/86
Registered Professional Engineer and/or Land Surveyor

Herschel L. Jones
Certificate No.
#3640

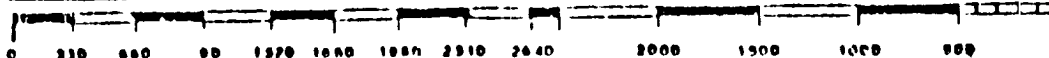

RECEIVED
FEB 10 1986
C-22
HOBBS OFFICE

111