

MEXICO OIL CONSERVATION COMMI.
WELL LOCATION AND ACREAGE DEDICATION PLAT

Form C-102
 Supersedes C-128
 Effective 1-1-65

All distances must be from the outer boundaries of the Section

| | | | | | |
|--|---|-----------------------------|------------------------------------|----------------------|---------------------------------------|
| Operator CHEVRON USA, INC. | | | Lease E.M.S.U. | | Well No. 425 |
| Plot Letter M | Section 15 | Township 21 South | Range 36 East | County Lea | |
| Actual Footage Location of Well: 860 feet from the South line and 675 feet from the West line | | | | | |
| Ground Level Elev. 3600.4 | Producing Formation Grayburg San Andres | | Pool Grayburg San Andres | | Dedicated Acreage: 40 Acres |

1. Outline the acreage dedicated to the subject well by colored pencil or hachure marks on the plat below.
2. If more than one lease is dedicated to the well, outline each and identify the ownership thereof (both as to working interest and royalty).
3. If more than one lease of different ownership is dedicated to the well, have the interests of all owners been consolidated by communitization, unitization, force-pooling, etc?

☒ Yes ☐ No If answer is "yes," type of consolidation unitization

If answer is "no," list the owners and tract descriptions which have actually been consolidated. (Use reverse side of this form if necessary.) _____

No allowable will be assigned to the well until all interests have been consolidated (by communitization, unitization, forced-pooling, or otherwise) or until a non-standard unit, eliminating such interests, has been approved by the Commission.

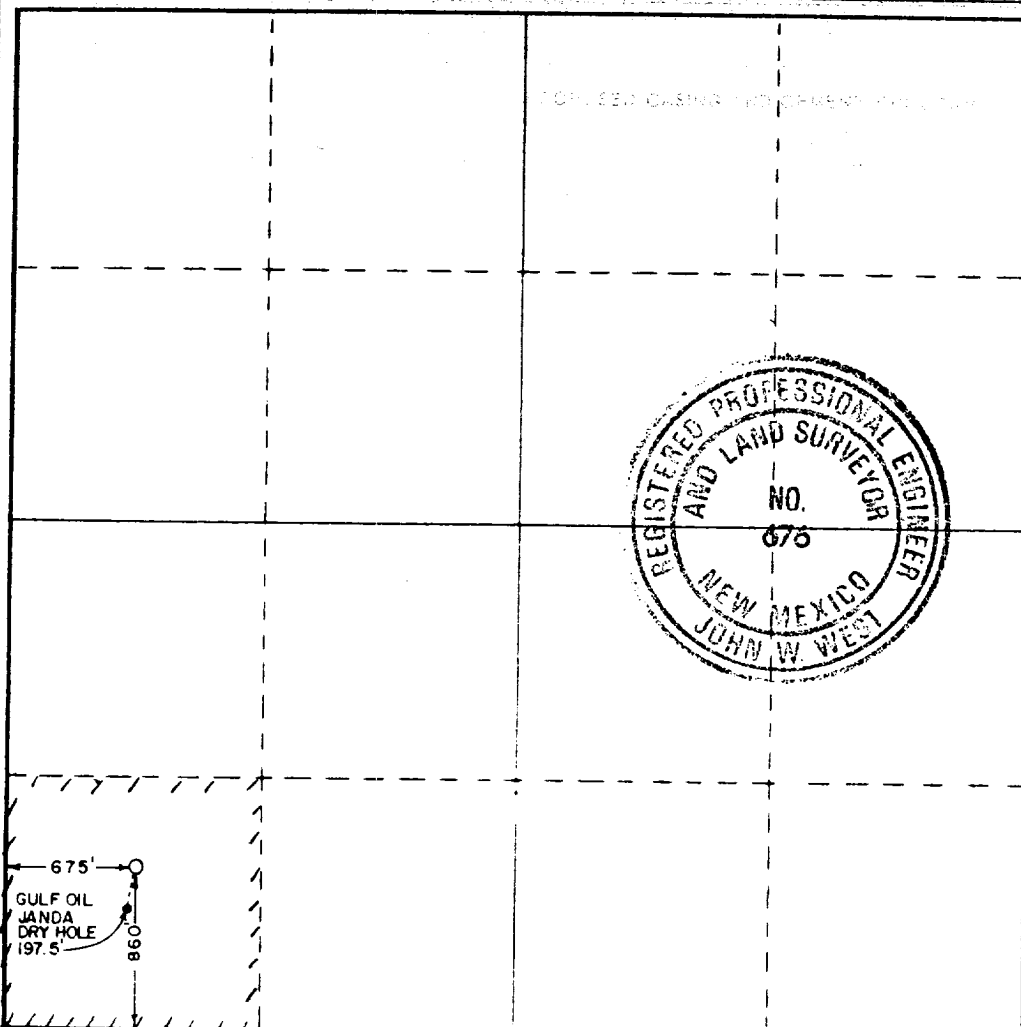

CERTIFICATION

I hereby certify that the information contained herein is true and complete to the best of my knowledge and belief.

L.K. Elmore

Name

L.K. Elmore

Position

Dirg. Tech. Asst.

Company

Chevron U.S.A. Inc.

Date

August 25, 1988

I hereby certify that the well location shown on this plat was plotted from field notes of actual surveys made by me or under my supervision, and that the same is true and correct to the best of my knowledge and belief.

Date Surveyed

August 24, 1988

Registered Professional Engineer and/or Land Surveyor

John W. West

Certificate No **JOHN W. WEST, 676**
RONALD J. EIDSON, 3239

1
AUG 26 1998
FBI
HONOLULU OFFICE