

Submit to Appropriate
District Office
State Lease - 4 copies
Fee Lease - 3 copies

State of New Mexico
Energy, Minerals and Natural Resources Department

Form C-102
Revised 1-1-89

OIL CONSERVATION DIVISION

P.O. Box 2088
Santa Fe, New Mexico 87504-2088

DISTRICT I
P.O. Box 1980, Hobbs, NM 88240

DISTRICT II
P.O. Drawer DD, Artesia, NM 88210

DISTRICT III
1000 Rio Brazos Rd., Aztec, NM 87410

WELL LOCATION AND ACREAGE DEDICATION PLAT

All Distances must be from the outer boundaries of the section

Operator CHEVRON U S A , INC.			Lease Meyers- Bell Ramsey		Well No. 5
Unit Letter N	Section 9	Township 21 South	Range 36 East	County Lea	
Actual Footage Location of Well: 990 feet from the South line and 1980 feet from the West line					
Ground level Elev. 3596.4	Producing Formation Eumont		Pool Yates/Seven Rivers/Queen	Dedicated Acreage: 240 Acres	

1. Outline the acreage dedicated to the subject well by colored pencil or hatchure marks on the plat below.
2. If more than one lease is dedicated to the well, outline each and identify the ownership thereof (both as to working interest and royalty).
3. If more than one lease of different ownership is dedicated to the well, have the interest of all owners been consolidated by communitization, unitization, force-pooling, etc.?
☒ Yes ☐ No If answer is "yes" type of consolidation Communitization
If answer is "no" list the owners and tract descriptions which have actually been consolidated. (Use reverse side of this form if necessary.)
No allowable will be assigned to the well until all interests have been consolidated (by communitization, unitization, forced-pooling, or otherwise) or until a non-standard unit, eliminating such interest, has been approved by the Division.

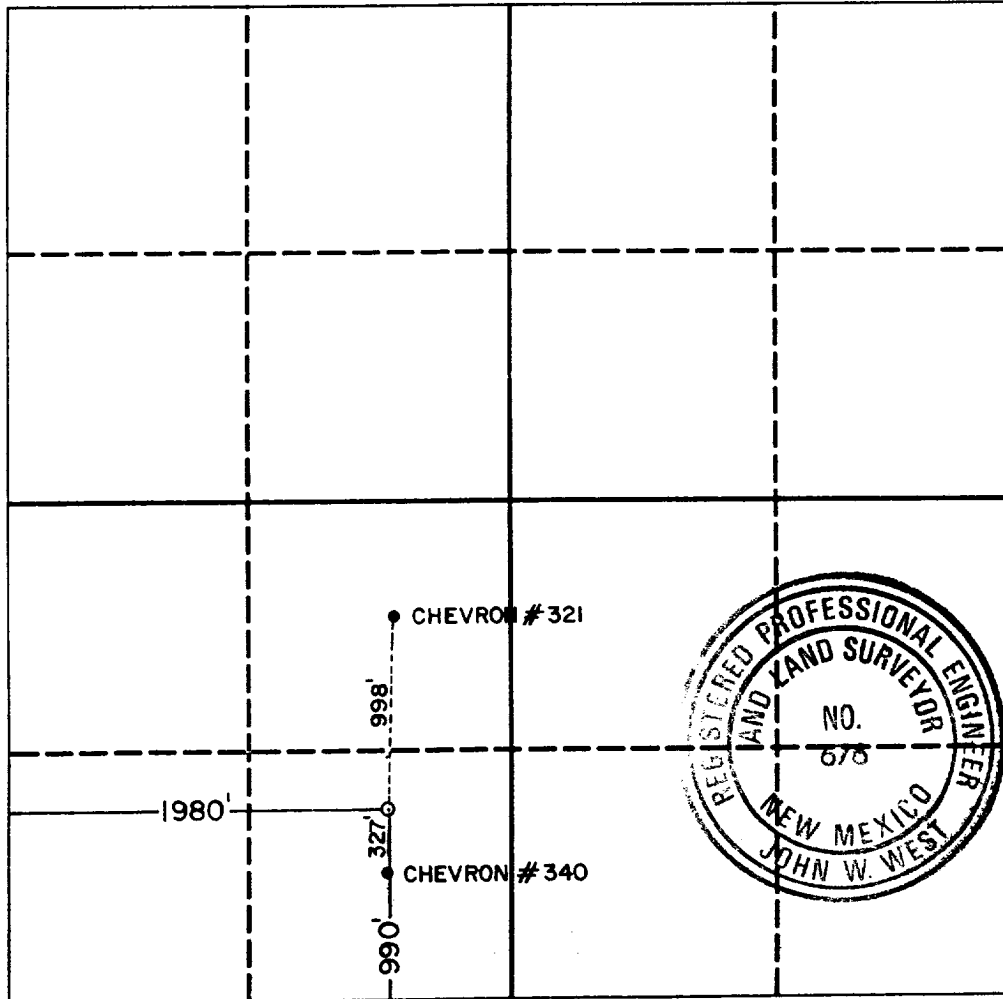

OPERATOR CERTIFICATION

I hereby certify that the information contained herein is true and complete to the best of my knowledge and belief.

Signature
M. E. Akins
Printed Name
M. E. Akins
Position
Staff Drlg. Engr.
Company
Chevron U.S.A. Inc.
Date
6-12-90

SURVEYOR CERTIFICATION

I hereby certify that the well location shown on this plat was plotted from field notes of actual surveys made by me or under my supervision, and that the same is true and correct to the best of my knowledge and belief.

Date Surveyed
June 5, 1990

Signature & Seal of
Professional Surveyor

[Signature]
Certificate No. JOHN W. WEST, 676
RONALD J. EIDSON, 3239

FEB 12 1991

CCO
HOBBS OFFICE

RECEIVED

JUN 08 1990

CCO
HOBBS OFFICE