

DISTRICT I  
P.O. Box 1880, Hobbs, NM 88240

DISTRICT II  
P.O. Drawer DD, Artesia, NM 88210

State of New Mexico  
Energy, Minerals and Natural Resources Department

Form 1-102  
Revised February 10, 1994  
Instruction on back  
Submit to Appropriate District Office  
State Lease - 4 Copies  
Fee Lease - 3 Copies

DISTRICT III  
1000 Rio Brazos Rd., Aztec, NM 87410

OIL CONSERVATION DIVISION

P.O. Box 2088  
Santa Fe, New Mexico 87504-2088

☐ AMENDED REPORT

SIMULTANEOUS DEDICATION

WELL LOCATION AND ACREAGE DEDICATION PLAT

API Number 30-025-3042	Pool Code 76480	Pool Name EUMONT ( Y/SR/QN)
Property Code 2642	Property Name MEYER BELL RAMSAY	Well Number 5
OGRID No. 4323	Operator Name CHEVRON U.S.A. INC.	Elevation

Surface Location

UL or lot No.	Section	Township	Range	Lot Idn	Feet from the	North/South line	Feet from the	East/West line	County
N	9	21S	36E		990	SOUTH	1980	WEST	LEA

Bottom Hole Location If Different From Surface

UL or lot No.	Section	Township	Range	Lot Idn	Feet from the	North/South line	Feet from the	East/West line	County

Dedicated Acres 240	Joint or Infill	Consolidation Code	Order No.
------------------------	-----------------	--------------------	-----------

NO ALLOWABLE WILL BE ASSIGNED TO THIS COMPLETION UNTIL ALL INTERESTS HAVE BEEN CONSOLIDATED  
OR A NON-STANDARD UNIT HAS BEEN APPROVED BY THE DIVISION

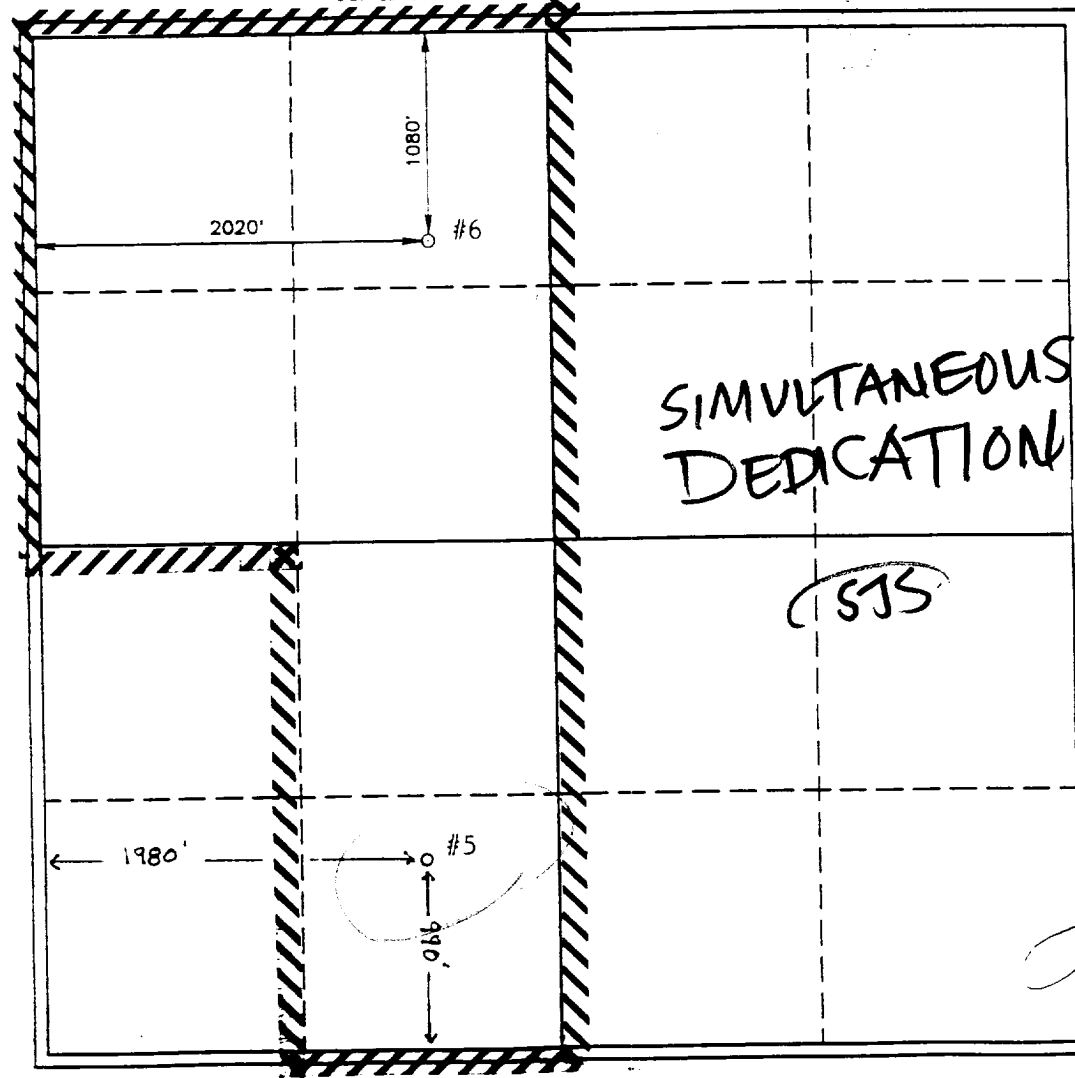
	<p><b>OPERATOR CERTIFICATION</b></p> <p>I hereby certify the the information contained herein is true and complete to the best of my knowledge and belief.</p> <p><u>Rory Matthews</u> Signature</p> <p>RORY MATTHEWS Printed Name</p> <p>DRILLING TECHNICAL ASST. Title</p> <p>12-15-94 Date</p> <p><b>SURVEYOR CERTIFICATION</b></p> <p>I hereby certify that the well location shown on this plat was plotted from field notes of actual surveys made by me or under my supervision, and that the same is true and correct to the best of my knowledge and belief.</p> <p>Date Surveyed</p> <p>Signature &amp; Seal of Professional Surveyor</p> <p>Certificate No.</p>
---	--

Submit to Appropriate  
District Office  
Lease - 4 copies  
Lease - 3 copies

State of New Mexico  
Energy, Minerals and Natural Resources Department

Form 1-1992  
Rev. 1-1-79

OIL CONSERVATION DIVISION

P.O. Box 2088

Santa Fe, New Mexico 87504-2088

DISTRICT I

P.O. Box 1980, Hobbs, NM 88240

DISTRICT II

P.O. Drawer DD, Artesia, NM 88210

DISTRICT III

1000 Rio Brazos Rd., Aztec, NM 87410

WELL LOCATION AND ACREAGE DEDICATION PLAT

All Distances must be from the outer boundaries of the section

Operator CHEVRON U S A , INC.			Lease Meyers- Bell Ramsey		Well No. 5
Unit Letter N	Section 9	Township 21 South	Range 36 East	County Lea	
Actual Footage Location of Well: 990 feet from the South line and 1980 feet from the West line					
Ground level Elev. 3596.4	Producing Formation Eumont		Pool Yates/Seven Rivers/Queen		Dedicated Acreage: 240 Acres

1. Outline the acreage dedicated to the subject well by colored pencil or hatchure marks on the plat below.

2. If more than one lease is dedicated to the well, outline each and identify the ownership thereof (both as to working interest and royalty).

3. If more than one lease of different ownership is dedicated to the well, have the interest of all owners been consolidated by communitization, unitization, force-pooling, etc.?

☒ Yes

☐ No

If answer is "yes" type of consolidation Communitization

If answer is "no" list the owners and tract descriptions which have actually been consolidated. (Use reverse side of this form if necessary.)

No allowable will be assigned to the well until all interests have been consolidated (by communitization, unitization, forced-pooling, or otherwise) or until a non-standard unit, eliminating such interest, has been approved by the Division.

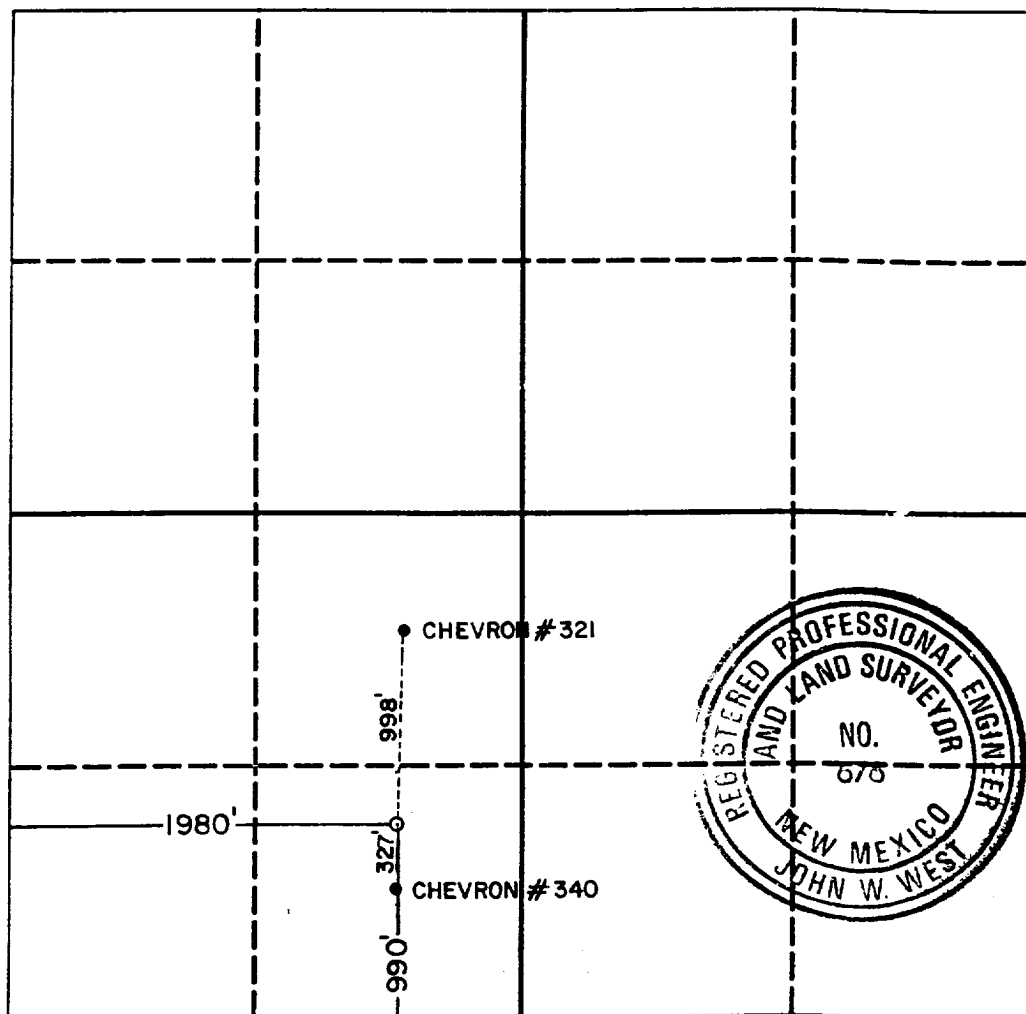

OPERATOR CERTIFICATION

I hereby certify that the information contained herein is true and complete to the best of my knowledge and belief.

Signature

*M. E. Akins*

Printed Name

M. E. Akins

Position

Staff Drlg. Engr.

Company

Chevron U.S.A. Inc.

Date

6-12-90

SURVEYOR CERTIFICATION

I hereby certify that the well location shown on this plat was plotted from field notes of actual surveys made by me or under my supervision, and that the same is true and correct to the best of my knowledge and belief.

Date Surveyed

June 5, 1990

Signature & Seal of  
Professional Surveyor

*John W. West*

Certificate No. JOHN W. WEST, 676

RONALD J. EIDSON, 3239