

Submit to Appropriate
District Office
State Lease - 6 copies
Fee Lease - 5 copies

State of New Mexico
Energy, Minerals and Natural Resources Department

Form C-101
Revised 1-1-89

DISTRICT I
P.O. Box 1980, Hobbs, NM 88240

DISTRICT II
P.O. Drawer DD, Artesia, NM 88210

DISTRICT III
1000 Rio Brazos Rd., Aztec, NM 87410

OIL CONSERVATION DIVISION

P.O. Box 2088
Santa Fe, New Mexico 87504-2088

API NO. (assigned by OCD on New Wells)
30-025-30950

5. Indicate Type of Lease

STATE ☒ FEE ☐

6. State Oil & Gas Lease No.

APPLICATION FOR PERMIT TO DRILL, DEEPEN, OR PLUG BACK

1a. Type of Work:

b. Type of Well: DRILL ☒ RE-ENTER ☐ DEEPEN ☐ PLUG BACK ☐
OIL WELL ☒ GAS WELL ☐ OTHER ☐
SINGLE ZONE ☒ MULTIPLE ZONE ☐

7. Lease Name or Unit Agreement Name

J.F. Janda (NCT-D)

2. Name of Operator

Chevron U.S.A. Inc.

8. Well No.

6

3. Address of Operator

P.O. Box 670, Hobbs, NM 88240

9. Pool name or Wildcat

Oil Center/Glorieta

4. Well Location

Unit Letter T : 1660 Feet From The South Line and 530 Feet From The West Line

Section 2 Township 21S Range 36E NMPM Lea County

10. Proposed Depth
5500'

11. Formation
Glorieta

12. Rotary or C.T.
Rotary

13. Elevations (Show whether DF, RT, GR, etc.)
3531.8'

14. Kind & Status Plug. Bond
Blanket

15. Drilling Contractor
Unknown

16. Approx. Date Work will start
8-1-90

17.

PROPOSED CASING AND CEMENT PROGRAM

SIZE OF HOLE	SIZE OF CASING	WEIGHT PER FOOT	SETTING DEPTH	SACKS OF CEMENT	EST. TOP
14 3/4"	11 3/4"	42#	400'	250 sx	Circ.
11"	8 5/8"	24#	2700'	475 sx	Circ.
7 7/8"	5 1/2"	15.50#	5350'	600 sx	Circ.

MUD PROGRAM

0 - 400 FW SPUD MUD 8.4 TO 9.0
400 - 2700 BW 10#
2700 - TD CBW/STARCH 9.0 TO 10.0

BOP EQUIPMENT 3000 PSI CHEVRON CLASS III (DRAWING ATTACHED)

IN ABOVE SPACE DESCRIBE PROPOSED PROGRAM: IF PROPOSAL IS TO DEEPEN OR PLUG BACK, GIVE DATA ON PRESENT PRODUCTIVE ZONE AND PROPOSED NEW PRODUCTIVE ZONE. GIVE BLOWOUT PREVENTER PROGRAM, IF ANY.

I hereby certify that the information above is true and complete to the best of my knowledge and belief.

SIGNATURE M. E. Akins 7/12/90 TITLE Staff Dir. Engr. DATE 7-12-90

TYPE OR PRINT NAME M. E. Akins TELEPHONE NO. 393-4121

(This space for State Use)

ORIGINAL SIGNED BY STATE
DISTRICT I SUPERVISOR

APPROVED BY _____ TITLE _____ DATE JUL 20 1990

CONDITIONS OF APPROVAL, IF ANY:

Permit Expires 6 Months From Approval

RECEIVED

JUL 19 1990

MOBES OFFICE

**MEXICO OIL CONSERVATION COMMS
WELL LOCATION AND ACREAGE DEDICATION PLAT**

Form C-102
Supersedes C-128
Effective 1-1-85

All distances must be from the outer boundaries of the Section.

Operator CHEVRON USA, INC		Lease J.F. JANDA NCT-D		Well No. 6
Unit Letter T	Section 2	Township 21 SOUTH	Range 36 EAST	County LEA
Actual Footage Location of Well: 1660 feet from the SOUTH line and 530 feet from the WEST line				
Ground Level Elev. 3531.8'	Producing Formation Glorieta	Pool Oil Center	Dedicated Acreage: 40 Acres	

1. Outline the acreage dedicated to the subject well by colored pencil or hachure marks on the plat below.
2. If more than one lease is dedicated to the well, outline each and identify the ownership thereof (both as to working interest and royalty).
3. If more than one lease of different ownership is dedicated to the well, have the interests of all owners been consolidated by communitization, unitization, force-pooling, etc?

☐ Yes ☐ No If answer is "yes," type of consolidation _____

If answer is "no," list the owners and tract descriptions which have actually been consolidated. (Use reverse side of this form if necessary.) _____

No allowable will be assigned to the well until all interests have been consolidated (by communitization, unitization, forced-pooling, or otherwise) or until a non-standard unit, eliminating such interests, has been approved by the Commission.

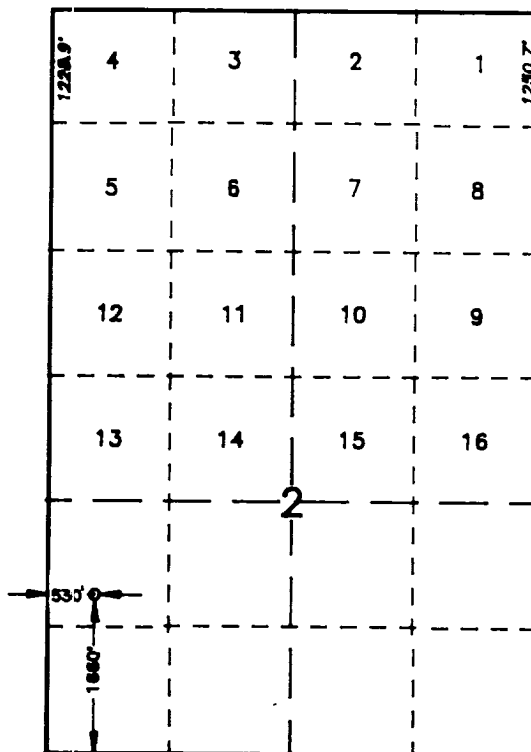

SCALE
1" = 2000'

CERTIFICATION

I hereby certify that the information contained herein is true and complete to the best of my knowledge and belief.

M. E. Akins 7/18/90

Name
M. E. Akins

Position
Staff Drlg. Engr.

Company
Chevron U.S.A. Inc.

Date
7-18-90

I hereby certify that the well location shown on this plat was plotted from field notes, actual surveys made by me or under my supervision, and that the same is true and correct to the best of my knowledge and belief.

JOHN W. WEST

Date Surveyed **JULY 17, 1990**

Registered Professional Engineer
and/or Land Surveyor

Ronald J. Eidsen

Certificates No. **JOHN W. WEST 676**

Ronald J. Eidsen 3239



 WOODEN
 STABLE
 STEEL
 STEEL
 STEEL
 STEEL
 STEEL
 STEEL
 STEEL
 STEEL
 STEEL
 STEEL
 STEEL
 STEEL
 STEEL
 STEEL
 STEEL
 STEEL
 STEEL