

Form 3160-3
(July 1989)
(formerly 9-331C)

UNITED STATES
DEPARTMENT OF THE INTERIOR
BUREAU OF LAND MANAGEMENT

RECEIVED

CONTACT RECEIVING
OFFICE FOR NUMBER
OF COPIES REQUIRED
(Other instructions on
reverse side)

BLM Roswell District
Modified Form No.
NM060-3160-2

APPLICATION FOR PERMIT TO DRILL, DEEPEN, OR PLUG BACK

1a. TYPE OF WORK
DRILL ☒ DEEPEN ☐ PLUG BACK ☐

b. TYPE OF WELL
OIL WELL ☒ GAS WELL ☐ OTHER ☐ SINGLE ZONE ☐ MULTIPLE ZONE ☐

2. NAME OF OPERATOR
Strata Production Company

3a. Area Code & Phone No.
(505) 622-1127

3. ADDRESS OF OPERATOR
648 Petroleum Building, Roswell, New Mexico 88201

4. LOCATION OF WELL (Report location clearly and in accordance with any State requirements.)
At surface 1980' FNL & 660' FEL
4 Miles South East of Halfway Store (62-180)
At proposed prod. zone

5. LEASE DESIGNATION AND SERIAL NO.
NM-14791

6. IF INDIAN, ALLOTTEE OR TRIBE NAME

7. UNIT AGREEMENT NAME

8. FARM OR LEASE NAME
New Mexico Federal

9. WELL NO.
#4

10. FIELD AND POOL, OR WILDCAT
Hat Mesa Delaware

11. SEC., T., R., M., OR BLK. AND SURVEY OR AREA
Section 4, T-21-S R-32-E

12. COUNTY OR PARISH
Lea

13. STATE
NM

14. DISTANCE IN MILES AND DIRECTION FROM NEAREST TOWN OR POST OFFICE*
30 Miles West of Hobbs New Mexico

15. DISTANCE FROM PROPOSED*
LOCATION TO NEAREST PROPERTY OR LEASE LINE, FT. (Also to nearest drilg. unit line, if any)
1980' FNL & 660' FEL

16. NO. OF ACRES IN LEASE
320

17. NO. OF ACRES ASSIGNED TO THIS WELL
40

18. DISTANCE FROM PROPOSED LOCATION*
TO NEAREST WELL, DRILLING, COMPLETED, OR APPLIED FOR, ON THIS LEASE, FT.
660' FEL

19. PROPOSED DEPTH
7150'

20. ROTARY OR CABLE TOOLS
Rotary

21. ELEVATIONS (Show whether DF, RT, GR, etc.)
3,681' GR

22. APPROX. DATE WORK WILL START*
8/30/90

PROPOSED CASING AND CEMENTING PROGRAM

HOLE SIZE	CASING SIZE	WEIGHT/FOOT	GRADE	THREAD TYPE	SETTING DEPTH	QUANTITY OF CEMENT
12 1/4"	8 5/8"	24#	J-55	LT&C	1300'	600 sx lite & 200 sx Cl C. Circ.
7 7/8"	5 1/2"	15.5 & 17.0#	J-55	STC	7150'	300 sx lite, 100 sx Cl. "C" CIRCULATE

A.) Will drill to a depth sufficient to test Delaware Formation.

B.) Mud Program: 0-1300': Native mud. (base of salt)
1300-T.D.: Cut Brine with starch for W.L. control and caustic for Ph control (10.0-11.0). Before drilling into Delaware, lower W.L. to \pm 10 cc's and raise vis to 35-40 with salt-gel and flocele. Raise chlorides above 125,000 ppm. Mud program may be altered as conditions dictate.

C.) BOP will be installed. (Exhibit)

D.) Logs to be run: CNL, GR, DLL and VOLAN.

ALL INFORMATION TO
GENERAL REQUIREMENTS AND
SPECIAL stipulations
ATTACHED

IN ABOVE SPACE DESCRIBE PROPOSED PROGRAM: If proposal is to deepen or plug back, give data on present productive zone and proposed new productive zone. If proposal is to drill or deepen directionally, give pertinent data on subsurface locations and measured and true vertical depths. Give blowout preventer program, if any.

24. SIGNED James E. McMillan TITLE Vice-President DATE 7/31/90
(This space for Federal or State office use)

PERMIT NO. 0019 APPROVAL DATE 8/20/90
APPROVED BY Carlson TITLE CARLSON RESOURCE AREA DATE 8/20/90
CONDITIONS OF APPROVAL, IF ANY:

OIL CONSERVATION DIVISION

P.O. Box 2088
Santa Fe, New Mexico 87504-2088

DISTRICT I
P.O. Box 1980, Hobbs, NM 88240

DISTRICT II
P.O. Drawer DD, Artesia, NM 88210

DISTRICT III
1000 Rio Brazos Rd., Aztec, NM 87410

WELL LOCATION AND ACREAGE DEDICATION PLAT

All Distances must be from the outer boundaries of the section

Operator Strata Production Company			Lease N.M. Federal		Well No. 4
Unit Letter H	Section 4	Township 21 South	Range 32 East	County Lea	
Actual Footage Location of Well: 1980 feet from the North line and 660 feet from the East line					
Ground level Elev. 3681	Producing Formation		Pool	Dedicated Acreage: Acres	

1. Outline the acreage dedicated to the subject well by colored pencil or hatchure marks on the plat below.
2. If more than one lease is dedicated to the well, outline each and identify the ownership thereof (both as to working interest and royalty).
3. If more than one lease of different ownership is dedicated to the well, have the interest of all owners been consolidated by communitization, unitization, force-pooling, etc.?
☐ Yes ☐ No If answer is "yes" type of consolidation _____
If answer is "no" list the owners and tract descriptions which have actually been consolidated. (Use reverse side of this form if necessary.) _____
No allowable will be assigned to the well until all interests have been consolidated (by communitization, unitization, forced-pooling, or otherwise) or until a non-standard unit, eliminating such interest, has been approved by the Division.

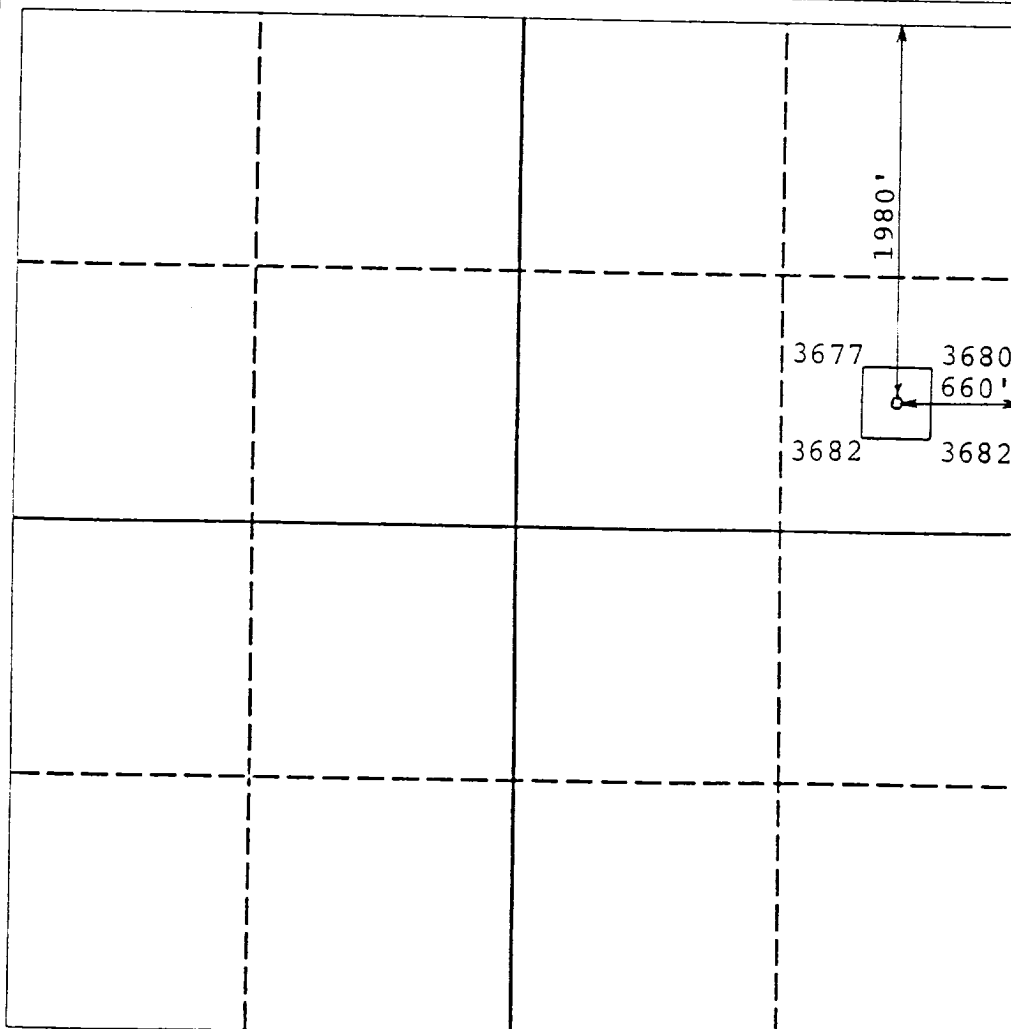

OPERATOR CERTIFICATION

I hereby certify that the information contained herein is true and complete to the best of my knowledge and belief.

Signature
James G. Mc Clelland
Printed Name
JAMES G. M. CLELLAND
Position
VICE PRESIDENT
Company
STRATA PRODUCTION CO.
Date
8-1-90

SURVEYOR CERTIFICATION

I hereby certify that the well location shown on this plat was plotted from field notes of actual surveys made by me or under my supervision, and that the same is true and correct to the best of my knowledge and belief.

Date Surveyed
August 1, 1990
Signature & Seal of Professional Surveyor
P. B. PATTERSON
8112
Certificate No.
8112

TOT Drilling Corp.
BOP. manifold

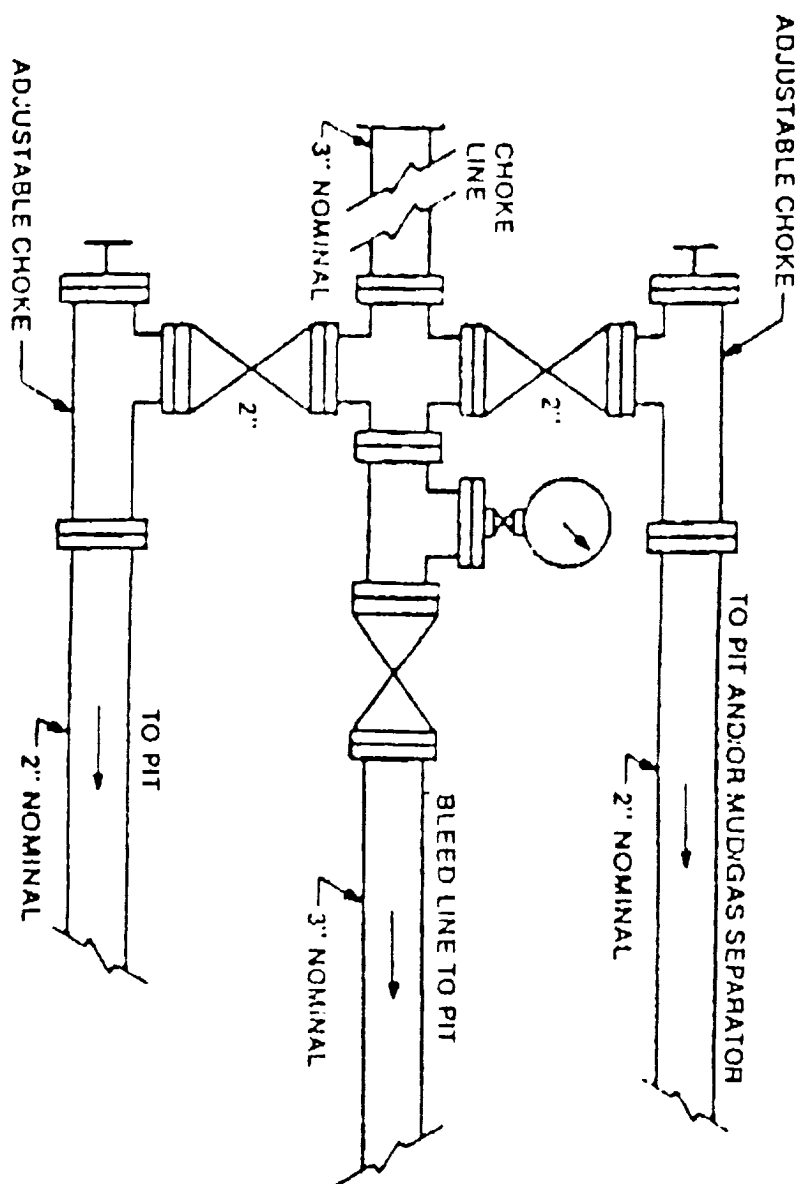
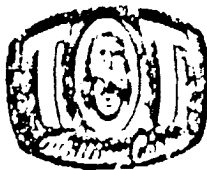

EXHIBIT "E"



TOT DRILLING CORPORATION
11 " 5000# Blow Out Equipment

DRILLING NIPPLE

ANNULAR

BLIND RAMS

4 1/2" PIPE RAMS

4" MUD CROSS

Excess Equipment:

- 2 - 2" 5000# Manual Valves H2S Trim
- 1 - 2" 5000# Check Valve
- 1 - 4" 5000# Manual Valve H2S Trim
- 1 - 4" Hydraulic Valve H2S Trim
- Complete Choke Manifold w/ 1- Positive and 1 Manual Choke
- Complete Package H2S Trim

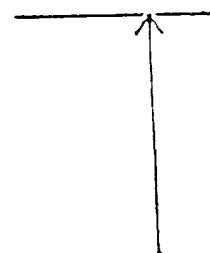
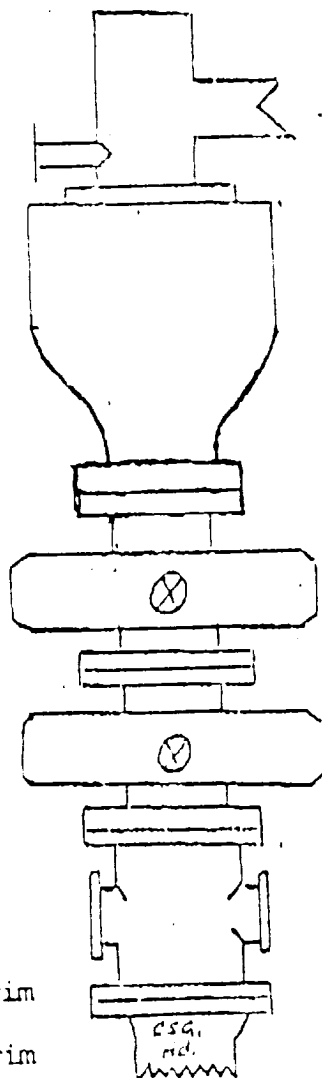

TOT
Equipment

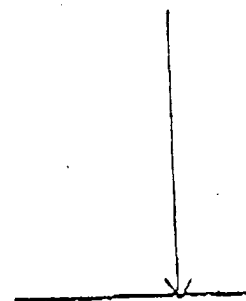

EXHIBIT "E"