

State Lease 4 copies  
P. O. Box 1980  
Hobbs, NM 88240

NEW MEXICO OIL CONSERVATION COMMISSION  
WELL LOCATION AND ACREAGE DEDICATION PLAT

Form C-102  
Supersedes C-128  
Effective 1-1-85

All distances must be from the outer boundaries of the Section.

Operator MERIDIAN OIL INC.		Lease SHELL STATE (E) COM.		Well No. 3
Unit Letter L	Section 6	Township 21 SOUTH	Range 36 EAST	County LEA COUNTY
Actual Footage Location of Wells 3500 feet from the NORTH line and 690 feet from the WEST line				
Ground Level Elev. - 3553.2	Producing Formation Yates-7Rvrs	Pool Eumont (Yates-7Rvs-Queen)	Dedicated Acreage: 230.32 Acres	

1. Outline the acreage dedicated to the subject well by colored pencil or hachure marks on the plat below.
2. If more than one lease is dedicated to the well, outline each and identify the ownership thereof (both as to working interest and royalty).
3. If more than one lease of different ownership is dedicated to the well, have the interests of all owners been consolidated by communitization, unitization, force-pooling, etc?

☐ Yes ☐ No If answer is "yes," type of consolidation \_\_\_\_\_

If answer is "no," list the owners and tract descriptions which have actually been consolidated. (Use reverse side of this form if necessary.) \_\_\_\_\_

No allowable will be assigned to the well until all interests have been consolidated (by communitization, unitization, forced-pooling, or otherwise) or until a non-standard unit, eliminating such interests, has been approved by the Commission.

Simultaneous Dedication

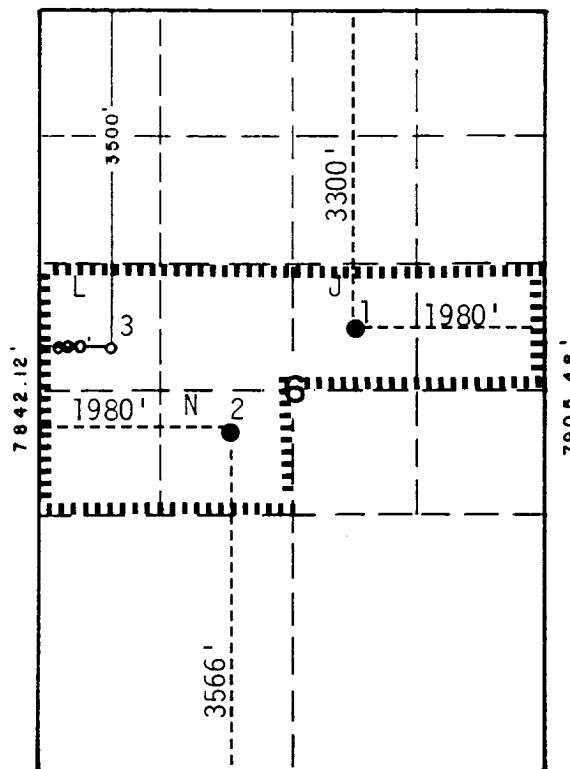

SCALE: 1" = 2000'

CERTIFICATION

I hereby certify that the information contained herein is true and complete to the best of my knowledge and belief.

Name  
Maria L. Perez  
Position  
Proration Asst.  
Company  
Meridian Oil Inc.  
Date  
7-23-91

I hereby certify that the well location shown on this plat was plotted from field notes of actual surveys made by me or under my supervision, and that the same is true and correct to the best of my knowledge and belief.

Date Surveyed  
Registered Professional Engineer  
and/or Land Surveyor  
Certification No. 30418 E. WEST 878  
NEW MEXICO  
Ronald J. Eldson 3239

26.8-4-8.92

ELF

JUL 24 1991

~~COPIES~~  
HOBBS OFFICE