

Submit to Appropriate  
District Office  
State Lease — 6 copies  
Fee Lease — 5 copies

State of New Mexico  
Energy, Minerals and Natural Resources Department

Form C-101  
Revised 1-1-89

OIL CONSERVATION DIVISION

P.O. Box 2088  
Santa Fe, New Mexico 87504-2088

DISTRICT I  
P.O. Box 1980, Hobbs, NM 88240

DISTRICT II  
P.O. Drawer DD, Artesia, NM 88210

DISTRICT III  
1000 Rio Brazos Rd., Aztec, NM 87410

API NO. (assigned by OCD on New Wells)

30 025-31370

5. Indicate Type of Lease

STATE ☒

FEE ☐

6. State Oil & Gas Lease No.

B-1167

APPLICATION FOR PERMIT TO DRILL, DEEPEN, OR PLUG BACK

1a. Type of Work:

DRILL ☒

RE-ENTER ☐

DEEPEN ☐

PLUG BACK ☐

b. Type of Well:

OIL  
WELL ☐

GAS  
WELL ☒

OTHER ☐

SINGLE  
ZONE ☐

MULTIPLE  
ZONE ☐

2. Name of Operator

Meridian Oil Inc.

3. Address of Operator

P. O. Box 51810, Midland, Texas 79710

7. Lease Name or Unit Agreement Name

Shell State "A" Com.

8. Well No.

6

9. Pool name or Wildcat

Eumont-Yates-7 Rivers-Qn

4. Well Location

Unit Letter D : 660 Feet From The North Line and 660 Feet From The West Line

Section 2

Township 21-S

Range 36-E

NMPM

Lea

County

10. Proposed Depth

3650'

11. Formation

Queen Sand

12. Rotary or C.T.

Rotary

13. Elevations (Show whether DF, RT, GR, etc.)

3519' GR

14. Kind & Status Plug. Bond

Blanket

15. Drilling Contractor

NA

16. Approx. Date Work will start

Upon Approval

17. PROPOSED CASING AND CEMENT PROGRAM

SIZE OF HOLE	SIZE OF CASING	WEIGHT PER FOOT	SETTING DEPTH	SACKS OF CEMENT	EST. TOP
12-1/4"	8-5/8"	28#	400'	450 sxs	Surface
7-7/8"	4-1/2"	11.6#	3650'	1250 sxs	Surface

Simultaneous Dedication NSL-3032 (SD)

Non-Standard gas proration unit authorized  
by Division Order No. R-518, dated 8-12-54  
for well #5.

Estimated Tops:

Anhy.	1285'
T. Salt	1520'
B. Salt	2510'
Yates	2720'
7 Rivers	2983'
Queen	3500'

IN ABOVE SPACE DESCRIBE PROPOSED PROGRAM: IF PROPOSAL IS TO DEEPEN OR PLUG BACK, GIVE DATA ON PRESENT PRODUCTIVE ZONE AND PROPOSED NEW PRODUCTIVE ZONE. GIVE BLOWOUT PREVENTER PROGRAM, IF ANY.

I hereby certify that the information above is true and complete to the best of my knowledge and belief.

SIGNATURE

*Alvin J. Perry*

TITLE

Production Asst.

DATE 8-26-91

TYPE OR PRINT NAME

TELEPHONE NO.

(This space for State Use)

APPROVED BY

TITLE

DATE

CONDITIONS OF APPROVAL, IF ANY:

NSL-3032

Permit Expires 6 Months From Approval  
Date Unless Drilling Underway.

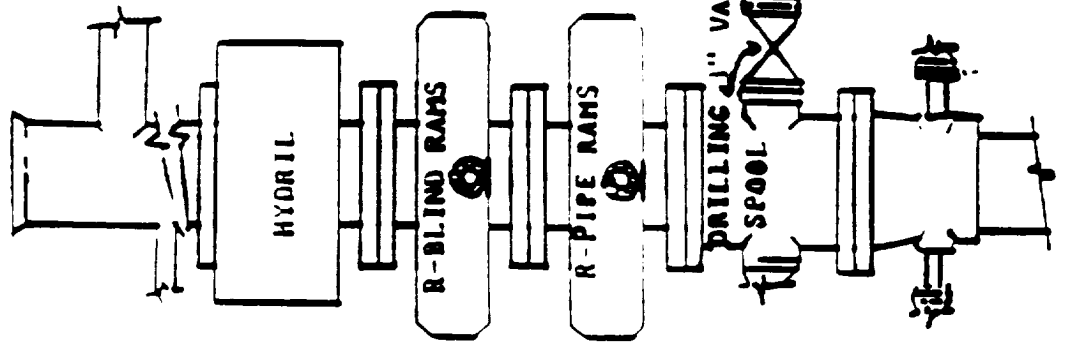

BLOW OUT PREVENTION EQUIPMENT  
 10" 900s ALL FLANGED CONNECTIONS  
 3000# WORKING PRESSURE \_ 6000# TEST

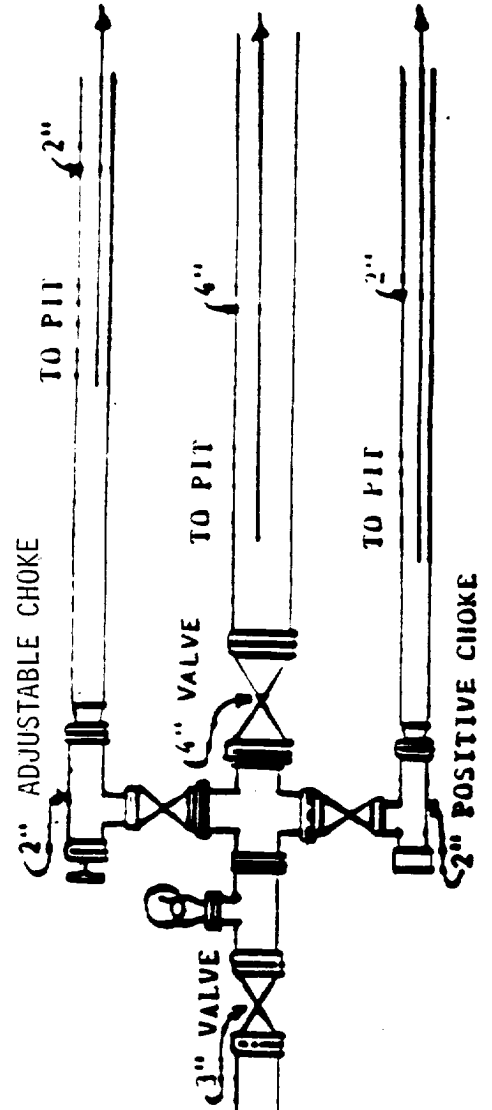

NEW MEXICO OIL CONSERVATION COMMISSION  
WELL LOCATION AND ACREAGE DEDICATION PLAT

Form C-102  
Superseded C-128  
Effective 1-1-65

All distances must be from the outer boundaries of the Section.

Operator <b>MERIDIAN OIL INC.</b>		Lease <b>SHELL STATE OIL CO.</b>		Well No. <b>6</b>
Unit Letter <b>D</b>	Section <b>2</b>	Township <b>21 SOUTH</b>	Range <b>36 EAST</b>	County <b>LEA</b>
Actual Footage Location of Wells <b>660</b> feet from the <b>NORTH</b> line and <b>660</b> feet from the <b>WEST</b> line				
Ground Level Elev. <b>3519.0</b>	Producing Formation <b>Queen Sand</b>	Pool <b>Eumont-Yates-7 Rivers-Queen</b>	Dedicated Acreage: <b>234.81</b> Acres	

1. Outline the acreage dedicated to the subject well by colored pencil or hatchure marks on the plat below.
2. If more than one lease is dedicated to the well, outline each and identify the ownership thereof (both as to working interest and royalty).
3. If more than one lease of different ownership is dedicated to the well, have the interests of all owners been consolidated by communitization, unitization, force-pooling, etc?

☐ Yes ☐ No If answer is "yes," type of consolidation \_\_\_\_\_

If answer is "no," list the owners and tract descriptions which have actually been consolidated. (Use reverse side of this form if necessary.) \_\_\_\_\_

No allowable will be assigned to the well until all interests have been consolidated (by communitization, unitization, forced-pooling, or otherwise) or until a non-standard unit, eliminating such interests, has been approved by the Commission.

Simultaneous Dedication

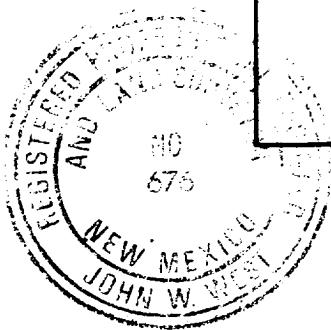
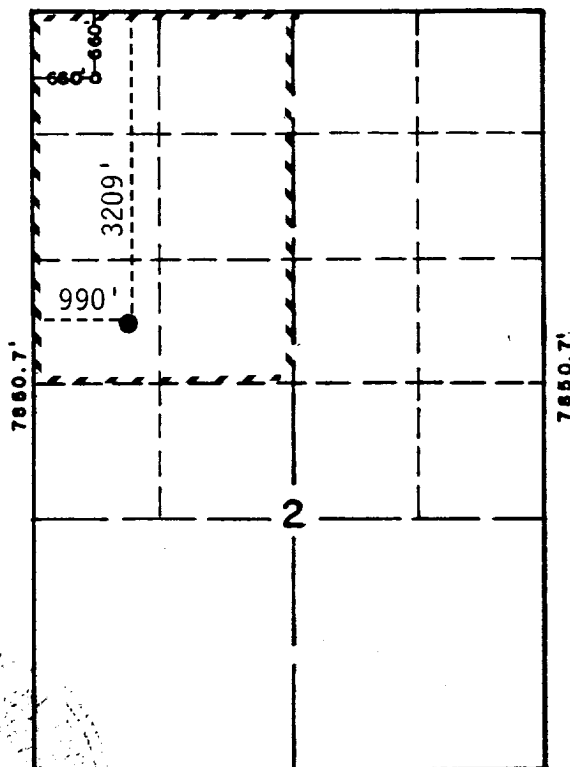

CERTIFICATION

I hereby certify that the information contained herein is true and complete to the best of my knowledge and belief.

Name  
**Maria L. Perez**  
Position  
**Production Asst.**  
Company  
**Meridian Oil Inc.**  
Date  
**8-26-91**

I hereby certify that the well location shown on this plat was plotted from field notes of actual surveys made by me or under my supervision, and that the same is true and correct to the best of my knowledge and belief.

Date Surveyed  
**7-24-91**  
Registered Professional Engineer and/or Land Surveyor  
  
Certificate No. **JOHN W. WEST 676**  
**Ronald J. Eldon 3239**