

Submit to Appropriate
District Office
State Lease - 4 copies
Fee Lease - 3 copies

State of New Mexico
Energy, Minerals and Natural Resources Department

Form C-102
Revised 1-1-89

OIL CONSERVATION DIVISION

P.O. Box 2088

Santa Fe, New Mexico 87504-2088

DISTRICT I

P.O. Box 1980, Hobbs, NM 88240

DISTRICT II

P.O. Drawer DD, Artesia, NM 88210

DISTRICT III

1000 Rio Brazos Rd., Aztec, NM 87410

WELL LOCATION AND ACREAGE DEDICATION PLAT

All Distances must be from the outer boundaries of the section

| | | | | | |
|--|-------------------------------|------------------|-----------------------------------|---------------------------------|----------------|
| Operator Mitchell Energy Corporation | | | Lease Comanche State (17) | | Well No. #1 |
| Unit Letter G | Section 17 | Township 21S. | Range 33E. | County NMPM | Lea |
| Actual Footage Location of Well: 1880 feet from the North line and 1980 feet from the East line | | | | | |
| Ground level Elev. 3792 | Producing Formation Morrow | | Pool Halmesa Berry (Morrow) | Dedicated Acreage: 320 Acres | |

1. Outline the acreage dedicated to the subject well by colored pencil or hachure marks on the plat below.
2. If more than one lease is dedicated to the well, outline each and identify the ownership thereof (both as to working interest and royalty).
3. If more than one lease of different ownership is dedicated to the well, have the interest of all owners been consolidated by communitization, unitization, force-pooling, etc.?
☐ Yes ☐ No If answer is "yes" type of consolidation _____
If answer is "no" list the owners and tract descriptions which have actually been consolidated. (Use reverse side of this form if necessary.) _____
No allowable will be assigned to the well until all interests have been consolidated (by communitization, unitization, forced-pooling, or otherwise) or until a non-standard unit, eliminating such interest, has been approved by the Division.

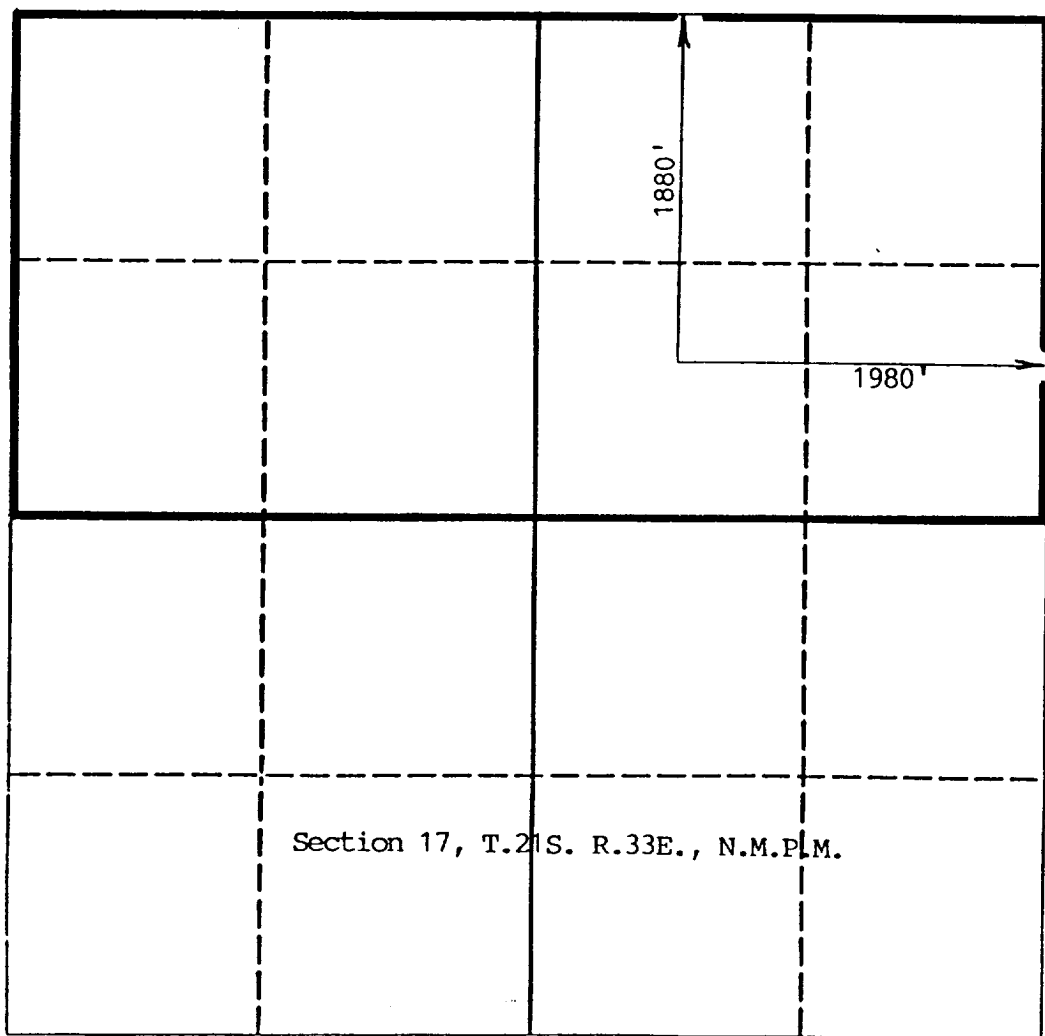

OPERATOR CERTIFICATION

I hereby certify that the information contained herein is true and complete to the best of my knowledge and belief.

Signature
George Mullen
Printed Name
George Mullen
Position
Reg. Affairs Specialist
Company
Mitchell Energy Corporation
Date
September 10, 1991

SURVEYOR CERTIFICATION

I hereby certify that the well location shown on this plat was plotted from field notes of actual surveys made by me or under my supervision, and that the same is true and correct to the best of my knowledge and belief.

Date Surveyed
7/16/90
Signature & Seal of Professional Surveyor
Jaques
Certificate No. 6290
Professional Engineer

0 500 1000 1500 2000 2500 3000 3500 4000 4500 5000

SEP 16 1991

SEP 16 1991

640
HONORS OFFICE