

# OIL CONSERVATION DIVISION

P.O. Box 2088  
Santa Fe, New Mexico 87504-2088

## DISTRICT I

P.O. Box 1980, Hobbs, NM 88240

## DISTRICT II

P.O. Drawer DD, Artesia, NM 88210

## DISTRICT III

1000 Rio Brazos Rd., Aztec, NM 87410

## WELL LOCATION AND ACREAGE DEDICATION PLAT

SIMULTANEOUS DEDICATED

All Distances must be from the outer boundaries of the section

Operator CHEVRON U.S.A. INC.			Lease R.R. BELL "A" COM.		Well No. 3
Unit Letter J	Section 8	Township 21 SOUTH	Range 36 EAST	County NMPM LEA	
Actual Footage Location of Well: 1880 feet from the SOUTH line and 1650 feet from the EAST line					
Ground Level Elev. 3597.6'	Producing Formation QUEEN		Pool EUMONT		Dedicated Acreage: 240 Acres

1. Outline the acreage dedicated to the subject well by colored pencil or hachure marks on the plat below.
2. If more than one lease is dedicated to the well, outline each and identify the ownership thereof (both as to working interest and royalty).
3. If more than one lease of different ownership is dedicated to the well, have the interest of all owners been consolidated by communitization, unitization, force-pooling, etc?  
☐ Yes ☐ No If answer is "yes" type of consolidation \_\_\_\_\_

If answer is "no" list of owners and tract descriptions which have actually been consolidated. (Use reverse side of this form necessary.)

No allowable will be assigned to the well unit all interests have been consolidated (by communitization, unitization, forced-pooling, otherwise) or until a non-standard unit, eliminating such interest, has been approved by the Division.

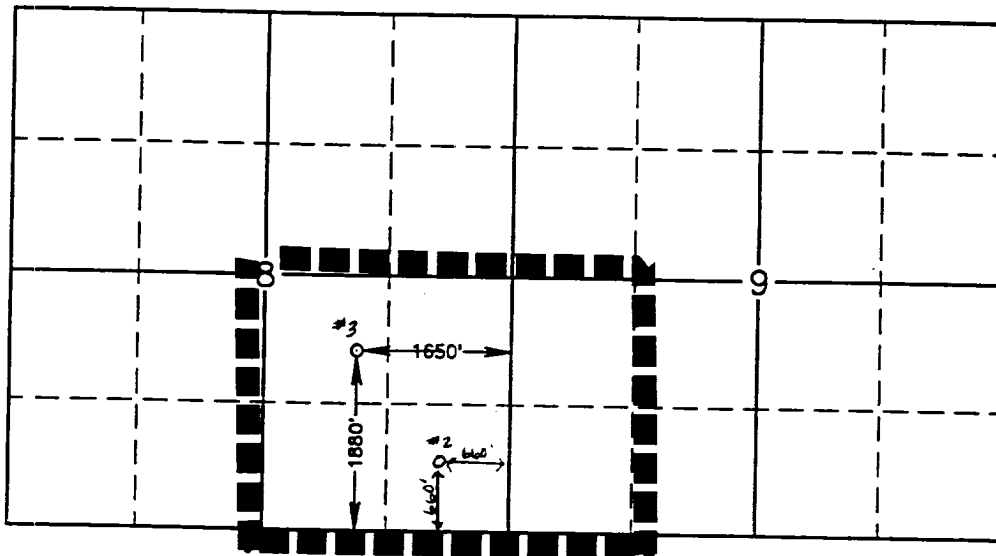

### OPERATOR CERTIFICATION

I hereby certify the the information contained herein is true and complete to the best of my knowledge and belief.

Signature  
*P.R. Matthews*

Printed Name  
P.R. MATTHEWS

Position  
TECHNICAL ASSISTANT

Company  
CHEVRON U.S.A. INC.

Date  
MARCH 31, 1992

### SURVEYOR CERTIFICATION

I hereby certify that the well location shown on this plat was plotted from field notes of actual surveys made by me or under my supervision, and that the same is true and correct to the best of my knowledge and belief.

Date Surveyed  
MARCH 27, 1992

Signature & Seal of  
Professional Surveyor

GARY L. JONES  
NEW MEXICO  
7977  
Professional Surveyor  
JOHN S. WEST, 876  
RONALD L. EDSON, 3239  
GARY L. JONES, 7977  
92-11-0445