

SENDER:

1. Complete items 1 and/or 2 for additional services.
 2. Complete items 3 and 4a & b.
 3. Print name and address on the reverse of this form so that we can return it to you.
 4. Attach this form to the front of the mailpiece, or on the back if space does not permit.
 5. Write Return Receipt Requested on the mailpiece below the article number.
 6. The Return Receipt Fee will provide you the signature of the person delivered to and the date of delivery.

I also wish to receive the following services (for an extra fee):
 1. ☐ Addressee's Address
 2. ☐ Restricted Delivery
 Consult postmaster for fee.

3. Article Addressed to:
 Mr. Robert Kruei
 Eddy Potash
 P.O. Box 31
 Carlsbad, NM 88220

4a. Article Number
 P 771 497 520

4b. Service Type
☐ Registered ☐ Insured
☒ Certified ☐ COD
☐ Express Mail ☐ Return Receipt for Merchandise

7. Date of Delivery
 6-16-92

5. Signature (Addressee)

8. Addressee's Address (Only if requested and fee is paid)

6. Signature (Agent)

PS Form 3811, November 1990 * U.S. GPO: 1991-287-068 DOMESTIC RETURN RECEIPT

P 771 497 520



Certified Mail Receipt
 No Insurance Coverage Provided
 Do not use for International Mail
 (See Reverse)

Sent to	
Mr. Robert Kruei	
Eddy Potash	
Street & No.	
P.O. Box 31	
Carlsbad, NM 88220	
P.O., State & ZIP Code	
Postage	\$
Certified Fee	
Special Delivery Fee	
Restricted Delivery Fee	
Return Receipt Showing to Whom & Date Delivered	
Return Receipt Showing to Whom, Date, & Address of Delivery	
TOTAL Postage & Fees	\$
Postmark or Date	
6/12/92	
COMANCHE 17 STATE #2	

PS Form 3800, June 1990

OK
 July 6
 70 days up

CERTIFIED MAIL

June 12, 1992

Mr. Robert Kruei
Eddy Potash
P.O.Box 31
Carlsbad, NM 88220

RE: **COMANCHE "17" STATE WELL NO. 2
LEA COUNTY, NEW MEXICO**

Dear Mr. Kruei:

By this letter, Mitchell Energy Corporation notifies you that it intends to make application with the New Mexico Oil Conservation Division for a permit to drill the above referenced well. The proposed location is 1980 feet from the north line and 660 feet from the east line of Section 17, Township 21 South, Range 33 East. According to the State Land Office's records, this location is within the boundaries of your potash lease.

Please indicate below whether or not you have any objections to drilling the subject well at the proposed location, and return two copies of this letter to the undersigned. The third copy is for your files.

If you need further information, please contact me at (713) 377-5855.

Very truly yours,

MITCHELL ENERGY CORPORATION

Original Signed By
GEORGE MULLEN

George Mullen
Regulatory Affairs Specialist

GM/lgb
Comanche.gm
Enclosure

_____ Eddy Potash has NO OBJECTION to this application

_____ Eddy Potash INTENDS TO PROTEST this application

By: _____

Title: _____

Date: _____

bcc: Larry Cunningham - Midland
Jack Stanley - Midland
George Tullos - Midland
Mark Whitley - MND-4N
Central Records - MND-2N

P 771 497 520



Certified Mail Receipt

No Insurance Coverage Provided
Do not use for International Mail
(See Reverse)

Sent to Mr. Robert Kruei	
Street & No. Eddy Potash	
P.O. Box 31	
Carlsbad, NM 88220	
P.O., State & ZIP Code	
Postage	\$
Certified Fee	
Special Delivery Fee	
Restricted Delivery Fee	
Return Receipt Showing to Whom & Date Delivered	
Return Receipt Showing to Whom, Date, & Address of Delivery	
TOTAL Postage & Fees	\$
Postmark or Date 6/12/92 COMANCHE "17" STATE #2	

PS Form 3800, June 1990

VIA FEDERAL EXPRESS

July 7, 1992

Mr. Allen Bridgeforth II
Mississippi Chemical Corporation
Highway 49
Yazoo City, Mississippi 39194

RE: **COMANCHE "17" STATE WELL NO. 2**
LEA COUNTY, NEW MEXICO

Dear Mr. Bridgeforth:

By this letter, Mitchell Energy Corporation notifies you that it has filed an application with the New Mexico Oil Conservation Division for a permit to drill the above referenced well. The proposed location is 1980 feet from the north line and 660 feet from the east line of Section 17, Township 21 South, Range 33 East. According to the State Land Office's records, this location is within the boundaries of your potash lease.



Please indicate below whether or not you have any objections to drilling the subject well at the proposed location, and return two copies of this letter to the undersigned. The third copy is for your files.

If you need further information, please contact me at (713) 377-5855.

Very truly yours,

MITCHELL ENERGY CORPORATION

George Mullen
Regulatory Affairs Specialist

GM/lgb
Comanche.gm
Enclosure

_____ Mississippi Chemical Corporation has NO OBJECTION to this application

_____ Mississippi Chemical Corporation INTENDS TO PROTEST this application

By: _____

Title: _____

Date: _____

cc: **Ms. Evelyn Downs - OOD, Hobbs, NM**

VIA FEDERAL EXPRESS

October 1, 1992

Mr. Randy Foote
Mississippi Chemical Corporation
1996 Potash Mine Road.
Carlsbad, New Mexico 88220

**RE: COMANCHE "17" STATE WELL NO. 2
LEA COUNTY, NEW MEXICO**

Dear Mr. Foote:

By this letter, Mitchell Energy Corporation notifies you that it has filed an application with the New Mexico Oil Conservation Division for a permit to drill the above referenced well. The proposed location is 1980 feet from the north line and 660 feet from the east line of Section 17, Township 21 South, Range 33 East. According to the State Land Office's records, this location is within the boundaries of your potash lease.



Please indicate below whether or not you have any objections to drilling the subject well at the proposed location, and return two copies of this letter to the undersigned. The third copy is for your files.

If you need further information, please contact me at (713) 377-5855.

Very truly yours,

MITCHELL ENERGY CORPORATION

George Mullen
Regulatory Affairs Specialist

GM/lgb
Comanche.gm
Enclosure

_____ Mississippi Chemical Corporation has NO OBJECTION to this application

_____ Mississippi Chemical Corporation INTENDS TO PROTEST this application

By: _____

Title: _____

Date: _____

cc: Ms. Evelyn Downs - OCD, Hobbs, NM

OIL CONSERVATION DIVISION

P.O. Box 2088
Santa Fe, New Mexico 87504-2088

DISTRICT I
P.O. Box 1980, Hobbs, NM 88240

DISTRICT II
P.O. Drawer DD, Artesia, NM 88210

DISTRICT III
1000 Rio Brazos Rd., Aztec, NM 87410

WELL LOCATION AND ACREAGE DEDICATION PLAT

All Distances must be from the outer boundaries of the section

Operator MITCHELL ENERGY Corporation			Lease COMANCHE STATE 17		Well No. #2
Unit Letter H	Section 17	Township 21S.	Range 33E.	County NMCM LEA	
Actual Footage Location of Well: 1980 feet from the NORTH line and 660 feet from the EAST line					
Ground level Elev. 3804	Producing Formation Delaware		Pool Wildcat	Dedicated Acreage: 40 Acres	

- Outline the acreage dedicated to the subject well by colored pencil or hatchure marks on the plat below.
- If more than one lease is dedicated to the well, outline each and identify the ownership thereof (both as to working interest and royalty).
- If more than one lease of different ownership is dedicated to the well, have the interest of all owners been consolidated by communitization, unitization, force-pooling, etc?
☐ Yes ☐ No If answer is "yes" type of consolidation _____
If answer is "no" list the owners and tract descriptions which have actually been consolidated. (Use reverse side of this form if necessary). _____
No allowable will be assigned to the well until all interests have been consolidated (by communitization, unitization, forced-pooling, or otherwise) or until a non-standard unit, eliminating such interest, has been approved by the Division.

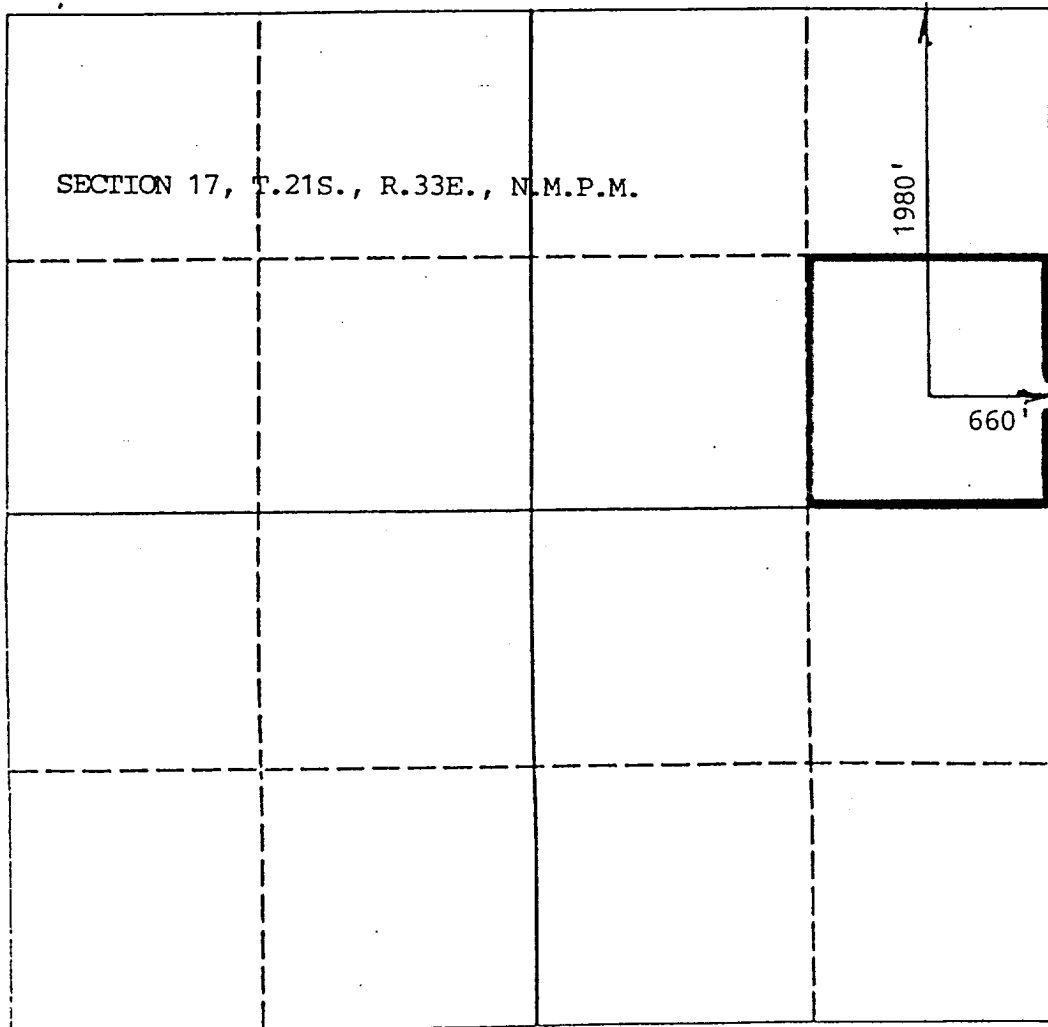

OPERATOR CERTIFICATION

I hereby certify that the information contained herein is true and complete to the best of my knowledge and belief.

Signature
George Mullen
Printed Name
George Mullen
Position
Reg. Affairs Specialist
Company
Mitchell Energy Corp.
Date
June 12, 1992

SURVEYOR CERTIFICATION

I hereby certify that the well location shown on this plat was plotted from field notes of actual surveys made by me or under my supervision, and that the same is true and correct to the best of my knowledge and belief.

Date Surveyed
6/1/92
Signature & Seal of
Professional Surveyor
D. JAQUES
Certificate No.
6290

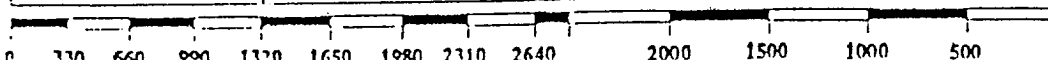

VIA FEDERAL EXPRESS

October 1, 1992

Mr. Marvin Watts
Eddy Potash
3071 Potash Mine Road.
Carlsbad, New Mexico 88220

**RE: COMANCHE "17" STATE WELL NO. 2
LEA COUNTY, NEW MEXICO**

Dear Mr. Watts:

By this letter, Mitchell Energy Corporation notifies you that it has filed an application with the New Mexico Oil Conservation Division for a permit to drill the above referenced well. The proposed location is 1980 feet from the north line and 660 feet from the east line of Section 17, Township 21 South, Range 33 East. According to the State Land Office's records, this location is within the boundaries of your potash lease.

Please indicate below whether or not you have any objections to drilling the subject well at the proposed location, and return two copies of this letter to the undersigned. The third copy is for your files.

If you need further information, please contact me at (713) 377-5855.

Very truly yours,

MITCHELL ENERGY CORPORATION

George Mullen
Regulatory Affairs Specialist

GM/lgb
Comanche.gm
Enclosure

_____ Eddy Potash has NO OBJECTION to this application

_____ Eddy Potash INTENDS TO PROTEST this application

By: _____

Title: _____

Date: _____

cc: Ms. Evelyn Downs - OCD, Hobbs, NM



RECEIVED

OCT 06 1992

ODD HOBBS C&P

Submit to Appropriate
District Office
State Lease - 4 copies
Fee Lease - 3 copies

State of New Mexico
Energy, Minerals and Natural Resources Department

Form C-102
Revised 1-1-89

OIL CONSERVATION DIVISION

P.O. Box 2088
Santa Fe, New Mexico 87504-2088

DISTRICT I
P.O. Box 1980, Hobbs, NM 88240

DISTRICT II
P.O. Drawer DD, Artesia, NM 88210

DISTRICT III
11(KK) Rio Brazos Rd., Aztec, NM 87410

WELL LOCATION AND ACREAGE DEDICATION PLAT

All Distances must be from the outer boundaries of the section

Operator MITCHELL ENERGY Corporation			Lease COMANCHE STATE 17		Well No. #2
Unit Letter H	Section 17	Township 21S.	Range 33E.	County NMM LEA	
Actual Footage Location of Well: 1980 feet from the NORTH line and 660 feet from the EAST line					
Ground level Elev. 3804	Producing Formation Delaware		Pool Wildcat		Dedicated Acreage: 40 Acres

1. Outline the acreage dedicated to the subject well by colored pencil or hachure marks on the plat below.
2. If more than one lease is dedicated to the well, outline each and identify the ownership thereof (both as to working interest and royalty).
3. If more than one lease of different ownership is dedicated to the well, have the interest of all owners been consolidated by communitization, unitization, force-pooling, etc?
☐ Yes ☐ No If answer is "yes" type of consolidation _____
If answer is "no" list the owners and tract descriptions which have actually been consolidated. (Use reverse side of this form if necessary).
No allowable will be assigned to the well until all interests have been consolidated (by communitization, unitization, forced-pooling, or otherwise) or until a non-standard unit, eliminating such interest, has been approved by the Division.

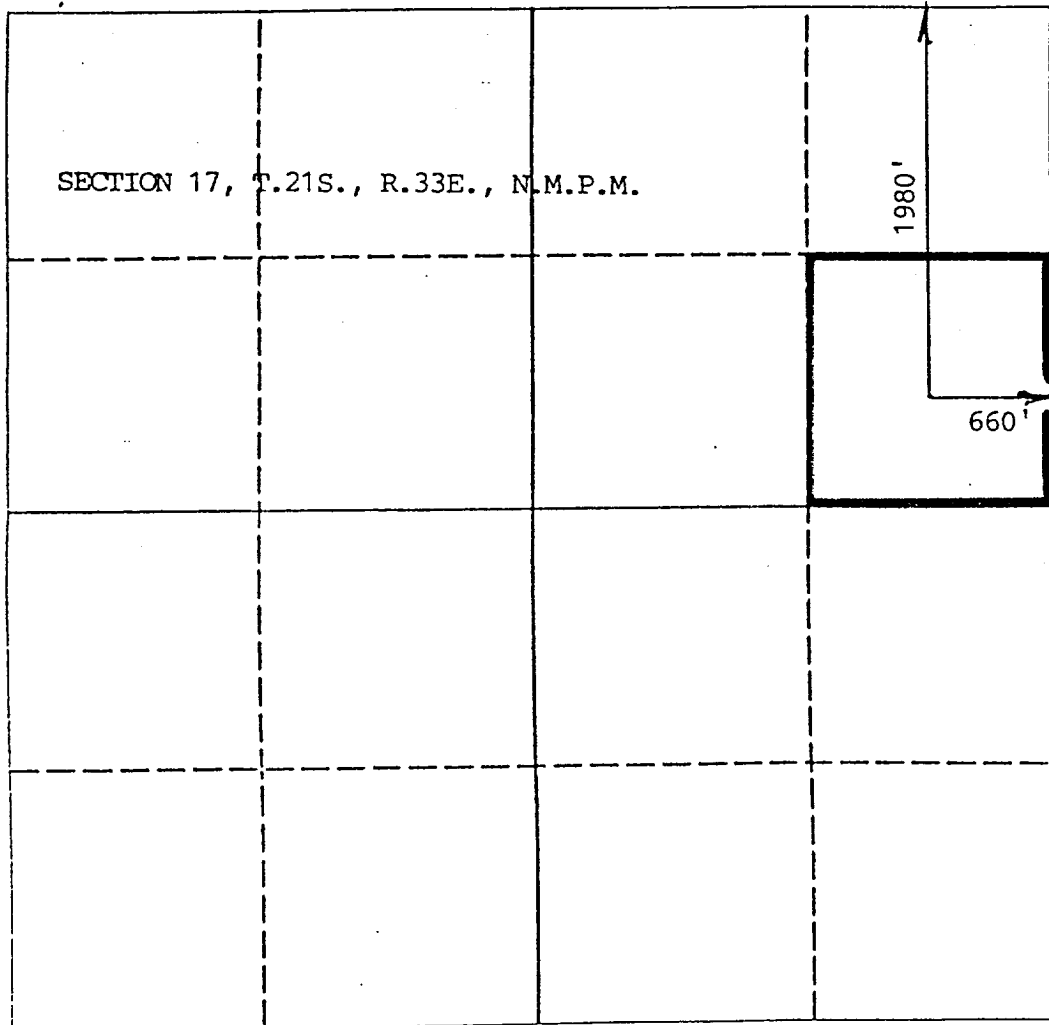

OPERATOR CERTIFICATION

I hereby certify that the information contained herein is true and complete to the best of my knowledge and belief.

Signature George Mullen
Printed Name **George Mullen**
Position **Reg. Affairs Specialist**
Company **Mitchell Energy Corp.**
Date **June 12, 1992**

SURVEYOR CERTIFICATION

I hereby certify that the well location shown on this plat was plotted from field notes of actual surveys made by me or under my supervision, and that the same is true and correct to the best of my knowledge and belief.

Date Surveyed **6/1/92**
Signature & Seal of Professional Surveyor **D. J. JACQUES**
Certificate No. **6290**

