

Submit to Appropriate  
District Office  
State Lease - 4 copies  
Fee Lease - 3 copies

State of New Mexico  
Energy, Minerals and Natural Resources Department

Form C-102  
Revised 1-1-85

DISTRICT I

P.O. Box 1980, Hobbs, NM 88240

DISTRICT II

P.O. Drawer DD, Artesia, NM 88210

DISTRICT III

1000 Rio Brazos Rd., Aztec, NM 87410

OIL CONSERVATION DIVISION

P.O. Box 2088  
Santa Fe, New Mexico 87504-2088

WELL LOCATION AND ACREAGE DEDICATION PLAT

All Distances must be from the outer boundaries of the section

Operator <b>BASS ENTERPRISES PRODUCTION Co.</b>			Lease <b>LITTLE EDDY UNIT</b>		Well No. <b>8</b>
Unit Letter <b>2 B</b>	Section <b>5</b>	Township <b>21 SOUTH</b>	Range <b>32 EAST</b>	County <b>NMPM LEA</b>	
Actual Footage Location of Well: <b>800</b> feet from the <b>NORTH</b> line and <b>1650</b> feet from the <b>EAST</b> line					
Ground Level Elev. <b>3637.0'</b>		Producing Formation <b>Delaware</b>		Pool <b>Hat Mesa Delaware Field</b>	Dedicated Acreage: <b>40</b> Acres

1. Outline the acreage dedicated to the subject well by colored pencil or hatchure marks on the plat below.
2. If more than one lease is dedicated to the well, outline each and identify the ownership thereof (both as to working interest and royalty).
3. If more than one lease of different ownership is dedicated to the well, have the interest of all owners been consolidated by communitization, unitization, force-pooling, etc.?  
☐ Yes ☐ No If answer is "yes" type of consolidation \_\_\_\_\_

If answer is "no" list of owners and tract descriptions which have actually been consolidated. (Use reverse side of this form necessary.)

No allowable will be assigned to the well unit all interests have been consolidated (by communitization, unitization, forced-pooling, otherwise) or until a non-standard unit, eliminating such interest, has been approved by the Division.

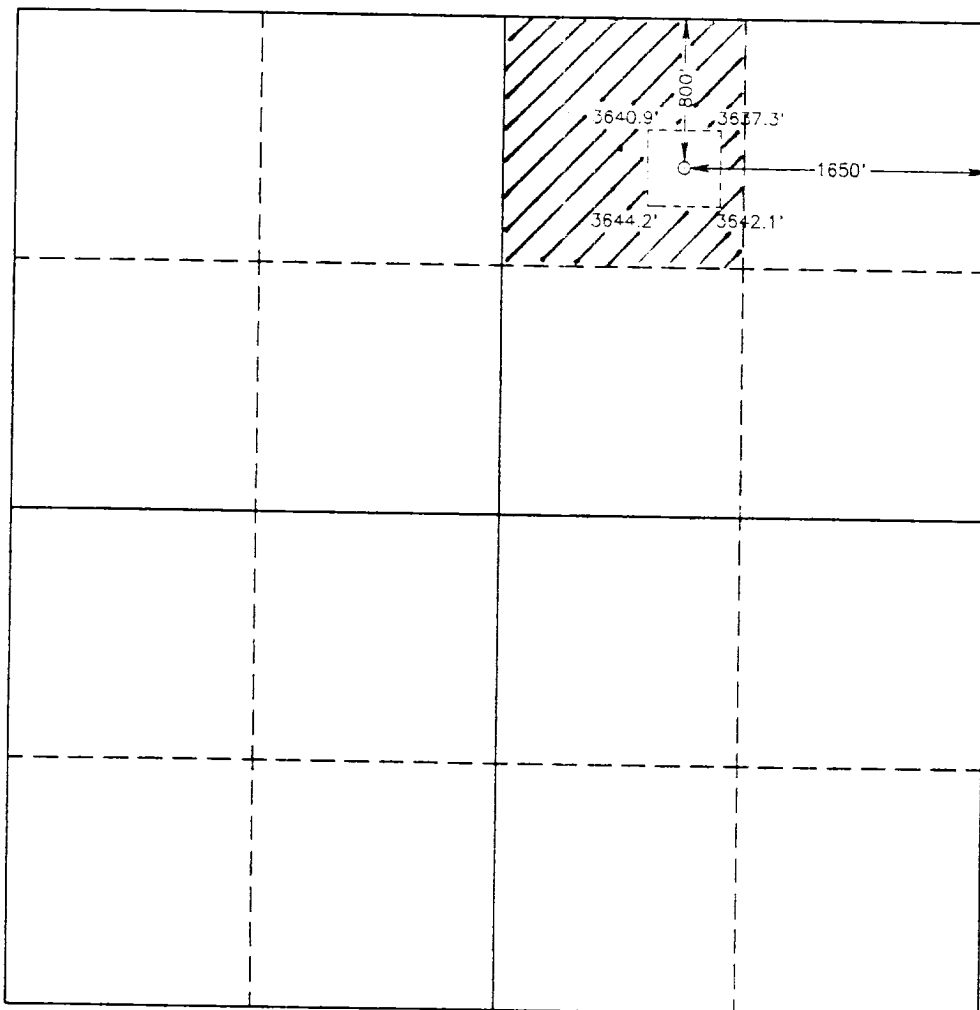

OPERATOR CERTIFICATION

I hereby certify the the information contained herein is true and complete to the best of my knowledge and belief.

Signature  
*Barry Allen*  
Printed Name  
**Barry Allen**  
Position  
**Engineering Assistant**  
Company  
**Bass Enterprises Prod. Co.**  
Date  
**03-31-94**

SURVEYOR CERTIFICATION

I hereby certify that the well location shown on this plat was plotted from field notes of actual surveys made by me or under my supervision, and that the same is true and correct to the best of my knowledge and belief.

Date Surveyed  
**JANUARY 7, 1994**  
Signature  
*Gary L. Jones*  
Professional Surveyor  
**7977**  
Certificate No.  
**JOHN W. WEST, 676**  
**RONALD J. EIDSON, 3239**  
**GARY L. JONES, 7977**

94-11-0041