

N.M. OIL & GAS COMMISSION
P.O. BOX 1050
NCSBS, NEW MEXICO
DEPARTMENT OF THE INTERIOR
BUREAU OF LAND MANAGEMENT

SUBMIT IN TRIPLICATE*
(Other instructions on
reverse side)

Form approved.
Budget Bureau No. 1004-0136
Expires: December 31, 1991

APPLICATION FOR PERMIT TO DRILL OR DEEPEN

1a. TYPE OF WORK DRILL <input checked="" type="checkbox"/> DEEPEN <input type="checkbox"/>		3. LEASE DESIGNATION AND SERIAL NO. NM 04229-A
b. TYPE OF WELL OIL WELL <input checked="" type="checkbox"/> GAS WELL <input type="checkbox"/> OTHER <input type="checkbox"/>		8. IF INDIAN, ALLOTTEE OR TRUST NAME <u>None</u>
2. NAME OF OPERATOR Bass Enterprises Production Company		7. UNIT AGREEMENT NAME Little Eddy Unit
3. ADDRESS AND TELEPHONE NO. P.O. Box 2760, Midland, TX 79702 (915) 683-2277		8. FARM OR LEASE NAME, WELL NO. Little Eddy Unit #6
4. LOCATION OF WELL (Report location clearly and in accordance with any State requirements.) At surface 2000' FNL & 800' FEL, Section 5, T-21-S, R-32-E At proposed prod. zone <u>SAS</u>		9. API WELL NO.
14. DISTANCE IN MILES AND DIRECTION FROM NEAREST TOWN OR POST OFFICE* 5 miles NE/Loving, NM		10. FIELD AND POOL, OR WILDCAT Hat Mesa (Delaware)
15. DISTANCE FROM PROPOSED* LOCATION TO NEAREST PROPERTY OR LEASE LINE, FT. (Also to nearest drilg. unit line, if any) 650' 380'		11. SEC., T., R., M., OR BLK. AND SURVEY OR AREA Section 5, T-21-S, R-32-E
16. NO. OF ACRES IN LEASE 165		12. COUNTY OR PARISH Lea
17. NO. OF ACRES ASSIGNED TO THIS WELL 40		13. STATE NM
18. DISTANCE FROM PROPOSED LOCATION* TO NEAREST WELL DRILLING COMPLETED, OR APPLIED FOR, ON THIS LEASE, FT. 1000'		19. PROPOSED DEPTH 8500'
20. ROTARY OR CABLE TOOLS Rotary		21. APPROX. DATE WORK WILL START* Upon Approval
22. ELEVATIONS (Show whether DF, RT, GR, etc.) 3651.3 GR		

23. PROPOSED CASING AND CEMENTING PROGRAM				
SIZE OF HOLE	GRADE, SIZE OF CASING	WEIGHT PER FOOT	SETTING DEPTH	QUANTITY OF CEMENT
*14-3/4"	11-3/4" WC-40	42#	1350'	760 SX (Circ. to Surface)
**11"	8-5/8" WC-50	32#	3200'	590 SX (Circ. to Surface)
*** 7-7/8"	5-1/2" K-55	15.5#	8500'	915 SX Tie Back to (3000')

*Surface casing to be set +100' above the salt in the Rustler Anhydrite.
**Intermediate casing to be set in the top of the Lamar Lime.
***DV Tool to be set at +6500', cement to tie back to 3000'.

Drilling procedure, BOP diagram, anticipated tops and surface use plans attached.

Note: This location is outside of R-111 Potash Areas.

OPER. OGRID NO. 1387
PROPERTY NO. 1757
POOL CODE 3027
EFF. DATE 5-5-84
API NO. 30-1-25-326.28

IN ABOVE SPACE DESCRIBE PROPOSED PROGRAM: If proposal is to deepen, give data on present productive zone and proposed new productive zone. If proposal is to drill or deepen directionally, give pertinent data on subsurface locations and measured and true vertical depths. Give blowout preventer program, if any.

24. SIGNED Barry Allen TITLE Engineering Assistant DATE 03-30-94

(This space for Federal or State office use)

PERMIT NO. _____ APPROVAL DATE _____
Approval approval does not warrant or certify that the applicant holds legal or equitable title to those rights in the subject lease which would entitle the applicant to a royalty thereon.
CONDITIONS OF APPROVAL, IF ANY: ATTACHED

APPROVED BY B. J. Splendoris TITLE Acting Associate State Engineer DATE 7-11-94
*See Instructions On Reverse Side

UNITED STATES
DEPARTMENT OF THE INTERIOR
BUREAU OF LAND MANAGEMENT

SUNDRY NOTICES AND REPORTS ON WELLS

Do not use this form for proposals to drill or to deepen or reentry to a different reservoir.
Use "APPLICATION FOR PERMIT—" for such proposals

SUBMIT IN TRIPLICATE

FORM APPROVED
Budget Bureau No. 1004-0135
Expires: March 31, 1993

5. Lease Designation and Serial No.
NM-04229-C

6. If Indian, Allottee or Tribe Name

7. If Unit or CA, Agreement Designation
LITTLE EDDY UNIT

8. Well Name and No.
LITTLE EDDY UNIT #6

9. API Well No.

10. Field and Pool, or Exploratory Area
HAT MESA (DELAWARE)

11. County or Parish, State

LEA CO, NEW MEXICO

1. Type of Well
☒ Oil Well ☐ Gas Well ☐ Other

2. Name of Operator
BASS ENTERPRISES PRODUCTION COMPANY

3. Address and Telephone No.
P. O. BOX 2760, MIDLAND, TX 79702 (915) 683-2277

4. Location of Well (Footage, Sec., T., R., M., or Survey Description)
2000' FNL & 800' FEL of SECTION 5, T-21-S, R-32-E

12. CHECK APPROPRIATE BOX(s) TO INDICATE NATURE OF NOTICE, REPORT, OR OTHER DATA

TYPE OF SUBMISSION

- ☐ Notice of Intent
☒ Subsequent Report
☐ Final Abandonment Notice

TYPE OF ACTION

- ☐ Abandonment
☐ Recompletion
☐ Plugging Back
☐ Casing Repair
☐ Altering Casing
☒ Other Location Move
☐ Change of Plans
☐ New Construction
☐ Non-Routine Fracturing
☐ Water Shut-Off
☐ Conversion to Injection
☐ Dispose Water

13. Describe Proposed or Completed Operations (Clearly state all pertinent details, and give pertinent dates, including estimated date of starting any proposed work. If well is directionally drilled, give subsurface locations and measured and true vertical depths for all markers and zones pertinent to this work.)*

(Note: Report results of multiple completion on Well Completion or Recompletion Report and Log form.)

OLD LOCATION: 1700' FNL & 650' FEL of SECTION 5, T-21-S, R-32-E

Moved original location 300' south and 150' west to avoid archaeological site.

14. I hereby certify that the foregoing is true and correct

Signed William R. Bunch

Title Division Dir. Supt.

Date 5-17-94

(This space for Federal or State office use)

Approved by

Conditions of approval, if any:

Title

Date

Title 18 U.S.C. Section 1001, makes it a crime for any person knowingly and willfully to make to any department or agency of the United States any false, fictitious or fraudulent statements or representations as to any matter within its jurisdiction.

*See Instruction on Reverse Side

DISTRICT I
P.O. Box 1980, Hobbs, NM 88240

DISTRICT II
P.O. Drawer DD, Artesia, NM 88210

DISTRICT III
1000 Rio Brazos Rd., Aztec, NM 87410

State of New Mexico
Energy, Minerals and Natural Resources Department

Form C-102
Revised February 10, 1994
Instruction on back
Submit to Appropriate District Office
State Lease - 4 Copies
Fee Lease - 3 Copies

OIL CONSERVATION DIVISION

P.O. Box 2088
Santa Fe, New Mexico 87504-2088

☐ AMENDED REPORT

WELL LOCATION AND ACREAGE DEDICATION PLAT

API Number	Pool Code	Pool Name
		HAT MESA (DELAWARE)
Property Code	Property Name	Well Number
	LITTLE EDDY UNIT	6
OGRID No. 001801	Operator Name	Elevation
	BASS ENTERPRISES PRODUCTION Co.	3652'

Surface Location

UL or lot No.	Section	Township	Range	Lot Idn	Feet from the	North/South line	Feet from the	East/West line	County
8	5	21 S	32 E		2000	NORTH	800	EAST	LEA

Bottom Hole Location If Different From Surface

UL or lot No.	Section	Township	Range	Lot Idn	Feet from the	North/South line	Feet from the	East/West line	County
Dedicated Acres	Joint or Infill	Consolidation Code	Order No.						
40									

NO ALLOWABLE WILL BE ASSIGNED TO THIS COMPLETION UNTIL ALL INTERESTS HAVE BEEN CONSOLIDATED
OR A NON-STANDARD UNIT HAS BEEN APPROVED BY THE DIVISION

LOT 4 41.42 AC.	LOT 3 41.30 AC.	LOT 2 41.16 AC.	LOT 1 41.06 AC.
			2000'
LOT 5 40.0 AC.	LOT 6 40.0 AC.	LOT 7 40.0 AC.	LOT 8 40.0 AC.
		3655.4'	3652.5'
		3652.2'	3653.3'
		40.0 AC.	
LOT 12 40.0 AC.	LOT 11 40.0 AC.	LOT 10 40.0 AC.	LOT 9 40.0 AC.
LOT 13 40.0 AC.	LOT 14 40.0 AC.	LOT 15 40.0 AC.	LOT 16 40.0 AC.



SCALE:
1" = 2000"

OPERATOR CERTIFICATION

I hereby certify the the information
contained herein is true and complete to the
best of my knowledge and belief.

William R. Dannels
Signature

William R. Dannels
Printed Name

Division Drlg. Supt.

Title

5-17-94

Date

SURVEYOR CERTIFICATION

I hereby certify that the well location shown
on this plat was plotted from field notes of
actual surveys made by me or under my
supervision, and that the same is true and
correct to the best of my belief.

MAY 12, 1994

Date Surveyed

Signature & Seal of
Professional Surveyor

W.O. Num. 94-11-0653

Certified by: GARY L. JONES, 7977

RONALD J. EIDSON, 3239

Submit to Appropriate
District Office
State Lease - 4 copies
Fee Lease - 3 copies

State of New Mexico
Energy, Minerals and Natural Resources Department

Form C-102
Revised 1-1-89

OIL CONSERVATION DIVISION

P.O. Box 2088

Santa Fe, New Mexico 87504-2088

DISTRICT I

P.O. Box 1980, Hobbs, NM 88240

DISTRICT II

P.O. Drawer DD, Artesia, NM 88210

DISTRICT III

1000 Rio Brazos Rd., Aztec, NM 87410

WELL LOCATION AND ACREAGE DEDICATION PLAT

All Distances must be from the outer boundaries of the section

Operator BASS ENTERPRISES PRODUCTION Co.			Lease LITTLE EDDY UNIT		Well No. 6
Unit Letter H	Section 5	Township 21 SOUTH	Range 32 EAST	NMPM	County LEA
Actual Footage Location of Well: 1700 feet from the NORTH line and 650 feet from the EAST line					
Ground Level Elev. 3651.3'	Producing Formation Delaware		Pool Hat Mesa Delaware Field		Dedicated Acreage: 40 Acres

1. Outline the acreage dedicated to the subject well by colored pencil or hachure marks on the plat below.
2. If more than one lease is dedicated to the well, outline each and identify the ownership thereof (both as to working interest and royalty).
3. If more than one lease of different ownership is dedicated to the well, have the interest of all owners been consolidated by communitization, unitization, force-pooling, etc.?
☐ Yes ☐ No If answer is "yes" type of consolidation _____

If answer is "no" list of owners and tract descriptions which have actually been consolidated. (Use reverse side of this form necessary.)

No allowable will be assigned to the well unit all interests have been consolidated (by communitization, unitization, forced-pooling, otherwise) or until a non-standard unit, eliminating such interest, has been approved by the Division.

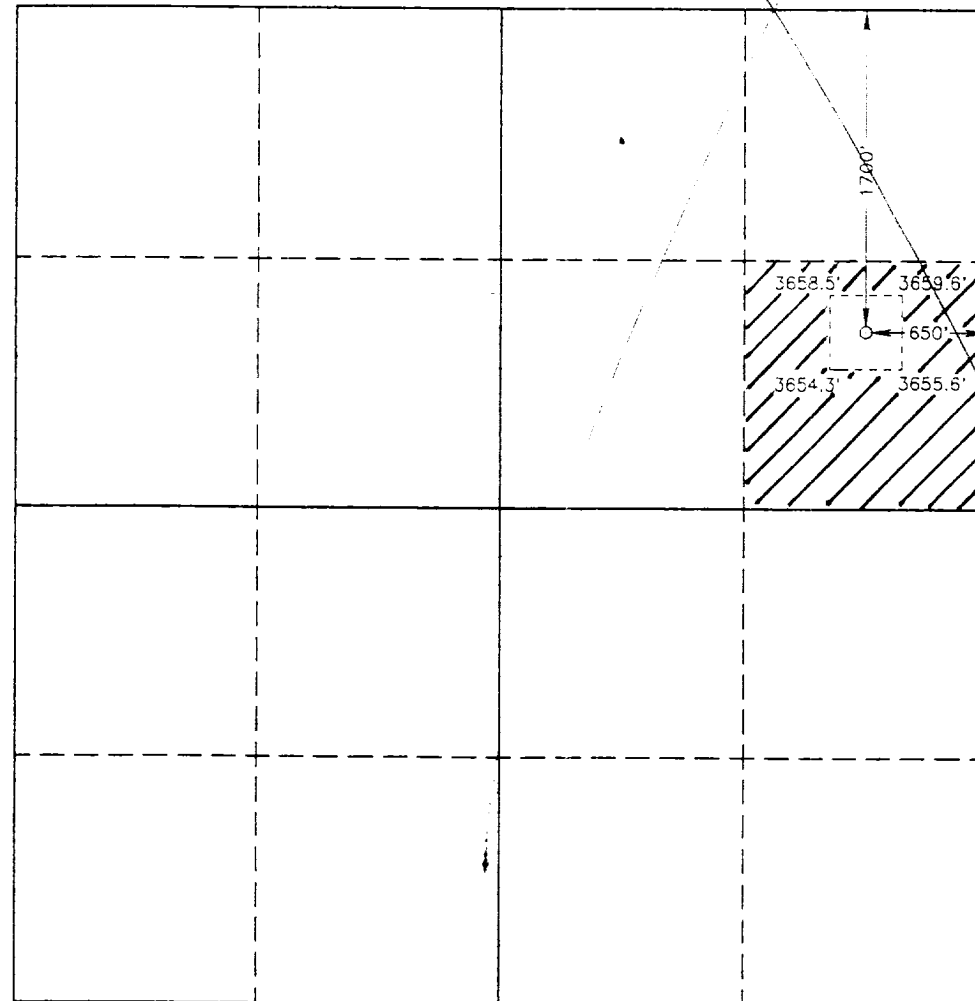

OPERATOR CERTIFICATION

I hereby certify the the information contained herein is true and complete to the best of my knowledge and belief.

Signature
Barry Allen
Printed Name
Barry Allen
Position
Engineering Assistant
Company
Bass Enterprises Prod. Co.
Date
03-30-94

SURVEYOR CERTIFICATION

I hereby certify that the well location shown on this plat was plotted from field notes of actual surveys made by me or under my supervision, and that the same is true and correct to the best of my knowledge and belief.

Date Surveyed
JANUARY 7 1994
Signature
GARY L. JONES
Professional Surveyor
7977
Certificate No.
JOHN W. WEST, 676
RONALD J. EIDSON, 3239
GARY L. JONES, 7977

94-11-0039

**EIGHT POINT DRILLING PROGRAM
BASS ENTERPRISES PRODUCTION CO.**

NAME OF WELL: LITTLE EDDY UNIT #6

LEGAL DESCRIPTION - SURFACE: 1700' FNL & 650' FEL, Section 5, T-21-S, R-32-E, Lea County, New Mexico.

POINT 1: ESTIMATED FORMATION TOPS

(See No. 2 Below)

POINT 2: WATER, OIL, GAS AND/OR MINERAL BEARING FORMATIONS

Anticipated Formation Tops: KB 3665' (est)
GL 3651'

<u>FORMATION</u>	<u>ESTIMATED TOP FROM KB</u>	<u>ESTIMATED SUBSEA TOP</u>	<u>BEARING</u>
T/Rustler	1380'	+2285'	Barren
T/Salt	1480'	+2185'	Barren
B/Salt	3130'	+ 535'	Barren
T/Capitan Red	3460'	+ 205'	Water
T/Delaware	5605'	-1940'	Oil/Gas
T/Brushy Canyon Sd	6525'	-2860'	Oil/Gas
TD	8500'	-4835'	

POINT 3: CASING PROGRAM

<u>TYPE</u>	<u>INTERVALS</u>	<u>PURPOSE</u>	<u>CONDITION</u>
20"	0' - 40'	Conductor	Contractor Discretion
11-3/4" 42# WC-40 ST&C	0' - 1350'	Surface	New
8-5/8" 32# WC-50 LT&C	0' - 3200'	Intermediate	New
5-1/2" 15.5# K-55 LT&C	0' - 8500'	Production	New

POINT 4: PRESSURE CONTROL EQUIPMENT (SEE ATTACHED DIAGRAMS)

A BOP equivalent to Diagram 1 will be nipped up on the surface casing head. The BOP stack, choke, kill lines, kelly cocks, inside BOP, etc. will be hydro-tested to the lowest rated working pressure of the equipment being tested. In addition to the rated working pressure test, a low pressure (200 psi) test will be required. These tests will be performed:

*

- a) Upon installation
- b) After any component changes
- c) Thirty days after a previous test
- d) As required by well conditions

A function test to insure that the preventers are operating correctly will be performed on each trip. See the attached Diagram for the minimum criteria for the choke manifold.

POINT 5: MUD PROGRAM

DEPTH	MUD TYPE	WEIGHT	FV	PV	YP	FL	Ph
0' - 1350'	FW Spud Mud	8.4-9.0	32-38	NC	NC	NC	10.0
1350' - 3200'	BW	10.0-10.2	28-30	NC	NC	NC	10.0-10.5
3200' - 8500'	FW Mud	8.6-8.8	32-34	4-6	6-8	15-25	9-9.5

POINT 6: TECHNICAL STAGES OF OPERATION

A) TESTING

None anticipated.

B) LOGGING

GR-CNL-DEN and GR-PIL from TD to 8-5/8" casing.
GR-CNL from intermediate casing to surface. Sidewall cores may be taken in zones of interest.

C) CONVENTIONAL CORING

None anticipated.

D) CEMENT

INTERVAL	AMOUNT SXS	FT OF FILL	TYPE	GALS/SX	PPG	FT ³ /SX
SURFACE						
Lead 0-1050'	525 (100% excess circ to surface)	1050'	Class "C" w/4% Gel + 2% CaCl ₂ + 1/4#/sk Cello-Seal	9.14	13.51	1.74
Tail 1050-1350'	235 (100% excess circ to surface)	300'	Class "C" w/2% CaCl ₂	6.32	14.82	1.34
INTERMEDIATE						
Lead 0-2700'	375 (75% excess circ to surface)	2700'	Class "C" w/3% Thrifty Lite + 5% Salt + 1/4#/sk Cello-Seal	16.92	11.70	2.80
Tail 2700-3200'	215 (100% excess circ to surface)	500'	Class "C"	6.32	14.80	1.32
PRODUCTION						
STAGE #1						
6500-8500'	440 (100% excess)	2000'	Class "H" w/8#/sx CSE + .75% CF-14 + .2% Thrifty Lite	7.90	14.04	1.61
STAGE #2						
Lead 3000-6000'	365 (100% excess tie back to int csg)	3000'	Class "C" w/3% Thrifty Lite + 5% Salt + .25#/sx Cello-Seal	16.92	11.70	2.80
Tail 6000-6500'	110 (100% excess)	500'	Class "H" w/8#/sx CSE + .75% CF-14 + 2% Thrifty Lite	7.90	14.04	1.61

E) DIRECTIONAL DRILLING

No directional services anticipated.

POINT 7: ANTICIPATED RESERVOIR CONDITIONS

Normal pressures are anticipated throughout the Delaware section. A BHP of 3700 psi (max) or MWE of 8.3 ppg at TD is expected. Lost circulation is not anticipated in this area. H₂S should be no higher than 100 ppm. Estimated BHT at TD is 134° F.

POINT 8: OTHER PERTINENT INFORMATION

A) Auxiliary Equipment

Upper and lower kelly cocks. Full opening stab in valve on the rig floor.

B) Anticipated Starting Date

Upon approval

14 days drilling operations

10 days completion operations

3000 PSI WP

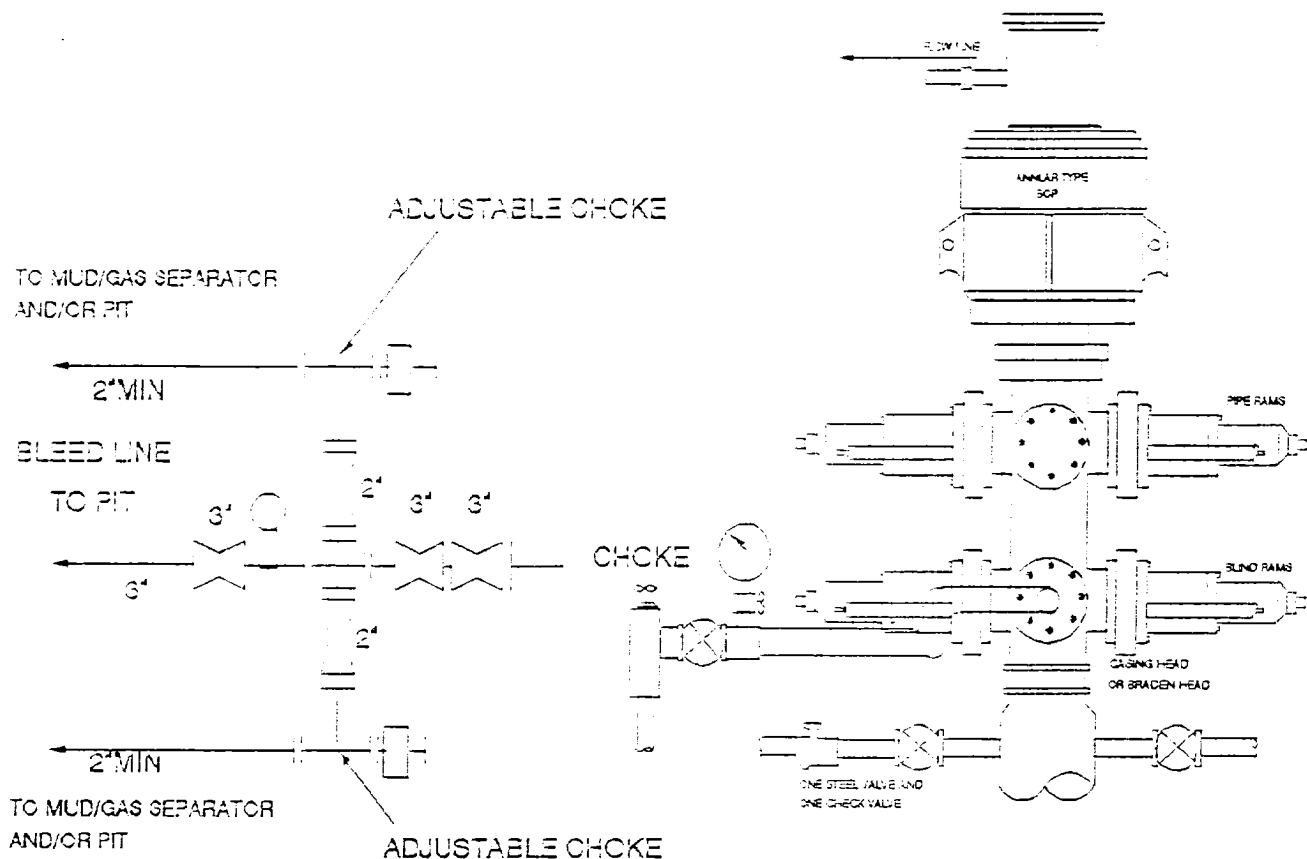

THE FOLLOWING CONSTITUTE MINIMUM BLOWOUT PREVENTER REQUIREMENTS

- One double gate blowout preventer with lower rams for pipe and upper rams blind, all hydraulically controlled.
- Opening on preventers between rams to be flanged, studded or clamped and at least two inches in diameter.
- All connections from operating manifold to preventers to be all steel hose or tube a minimum of one inch in diameter.
- The available closing pressure shall be at least 15% in excess of that required with sufficient volume to operate (close, open, and re-close) the preventers.
- All connections to and from preventers to have a pressure rating equivalent to that of the BOP's.
- Manual controls to be installed before drilling cement plug.
- Valve to control flow through drill pipe to be located on rig floor.
- Choke may be either ~~positive~~ or adjustable. Choke spool may be used between rams.

NOT
AUTHORIZED
DIAGRAM 1

SIS