

District I
PO Box 1960, Hobbs, NM 88241-1960
District II
PO Drawer DD, Artesia, NM 88211-0719
District III
1000 Rio Brazos Rd., Aztec, NM 87410
District IV
PO Box 2088, Santa Fe, NM 87504-2088

State of New Mexico
Energy, Minerals & Natural Resources Department

OIL CONSERVATION DIVISION
PO Box 2088
Santa Fe, NM 87504-2088

Form C-101
Revised February 10, 1994
Instructions on back
Submit to Appropriate District Office
State Lease - 6 Copies
Fee Lease - 5 Copies

☐ AMENDED REPORT

APPLICATION FOR PERMIT TO DRILL, RE-ENTER, DEEPEN, PLUGBACK, OR ADD A ZONE

¹ Operator Name and Address. Collins & Ware, Inc. 508 West Wall, Suite 1200 Midland, Texas 79701		¹ OGRID Number 004874
		¹ API Number 30-025-34245
¹ Property Code 19185	¹ Property Name State DA	¹ Well No. 6

² Surface Location

UL or lot no.	Section	Township	Range	Lot Ida	Feet from the	North/South line	Feet from the	East/West line	County
L	16	21S	37E		1980	South	810	West	Lea

³ Proposed Bottom Hole Location If Different From Surface

UL or lot no.	Section	Township	Range	Lot Ida	Feet from the	North/South line	Feet from the	East/West line	County

³ Proposed Pool 1 Penrose Skelly Grayburg (50350)	³ Proposed Pool 2
---	------------------------------

⁴ Work Type Code N	⁴ Well Type Code 0	⁴ Cable/Rotary R	⁴ Lease Type Code P	⁴ Ground Level Elevation 3461
⁴ Multiple No	⁴ Proposed Depth 4500	⁴ Formation Grayburg	⁴ Contractor	⁴ Spud Date January 1998

⁵ Proposed Casing and Cement Program

Bole Size	Casing Size	Casing weight/foot	Setting Depth	Sacks of Cement	Estimated TOC
12 1/4	8 5/8	24#	325'	300 sx	Circulate
7 7/8	5 1/2	15.5#	4500'	750 sx	Circulate

⁶ Describe the proposed program. If this application is to DEEPEN or PLUG BACK give the data on the present productive zone and proposed new productive zone. Describe the blowout prevention program, if any. Use additional sheets if necessary.

Permit Expires 1 Year From Approval
Date Unless Drilling Underway

1. Build location and reserve pits.
2. Move in and rig up rotary tools.
3. Spud 12 1/4" hole and drill to approx. 325', case and cement surface string.
4. Continue drilling to approx. 4500', test for commercial quantities of reserves.
5. Evaluate test results for (A. or B.)
 - A. Completion - case and cement long string and complete well.
 - B. Plug and abandon according to NMOCD rules and regulations.

⁷ I hereby certify that the information given above is true and complete to the best of my knowledge and belief.

Signature: 

Printed name: Dianne Sumrall

Title: Production Supervisor

Date: 12/17/97

Phone: (915) 687-3435

OIL CONSERVATION DIVISION

Approved by: 
DISTRICT I SUPERVISOR

Title:

Approval Date: DEC 23 1997

Expiration Date:

Conditions of Approval:

Attached ☐

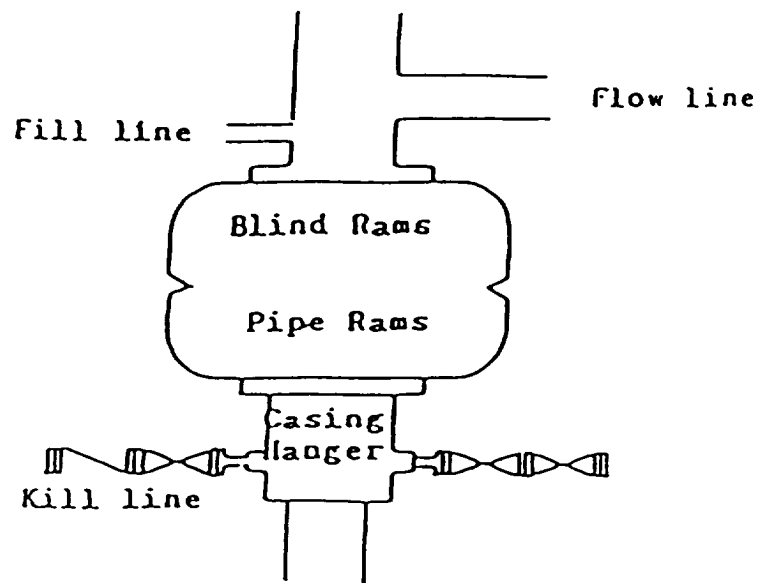

Blowout Preventer
3000 psi working pressure

District I
PO Box 1980, Hobbs, NM 88241-1980

District II
PO Drawer DD, Artesia, NM 88211-0719

District III
1000 Rio Brasos Rd., Aztec, NM 87410

District IV
PO Box 2088, Santa Fe, NM 87504-2088

State of New Mexico
Energy, Minerals & Natural Resources Department

Form C-102
Revised February 10, 1994
Submit to Appropriate District Office
State Lease - 4 Copies
Fee Lease - 3 Copies

OIL CONSERVATION DIVISION

PO Box 2088
Santa Fe, NM 87504-2088

☐ AMENDED REPORT

WELL LOCATION AND ACREAGE DEDICATION PLAT

1 API Number 30-025-34745	2 Pool Code 50350	3 Pool Name Penrose Skelly Grayburg
4 Property Code 19185	5 Property Name State DA	6 Well Number 6
7 DGRID No. 004874	8 Operator Name Collins & Ware, Inc.	9 Elevation 3461

¹⁰Surface Location

UL or lot no. L	Section 16	Township 21 S	Range 37 E	Lot Idn	Feet from the 1980	North/South line South	Feet from the 810	East/West line West	County Lea
---------------------------	----------------------	-------------------------	----------------------	---------	------------------------------	----------------------------------	-----------------------------	-------------------------------	----------------------

¹¹Bottom Hole Location If Different From Surface

UL or lot no.	Section	Township	Range	Lot Idn	Feet from the	North/South line	Feet from the	East/West line	County
¹² Dedicated Acres 40									
¹³ Joint or Infill									
¹⁴ Consolidation Code									
¹⁵ Order No.									

NO ALLOWABLE WILL BE ASSIGNED TO THIS COMPLETION UNITL ALL INTERESTS HAVE BEEN CONSOLIDATED
OR A NON-STANDARD UNIT HAS BEEN APPROVED BY THE DIVISION

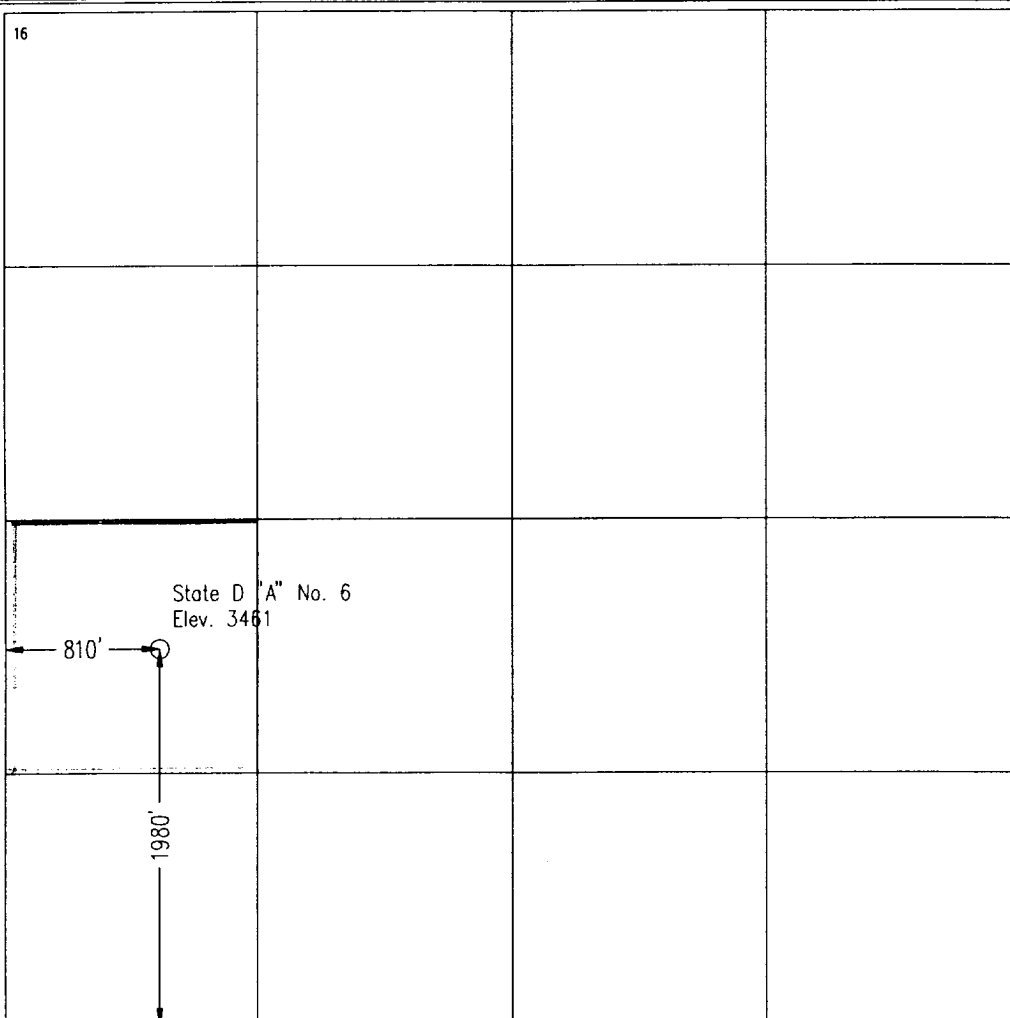
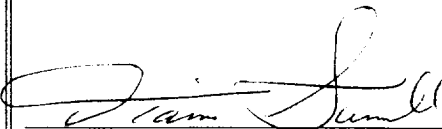
16 	17 OPERATOR CERTIFICATION <i>I hereby certify that the information contained herein is true and complete to the best of my knowledge and belief.</i>  Signature Dianne Sumrall Printed Name Production Supervisor Title December 17, 1997 Date