

District I  
PO Box 1930, Hobbs, NM 88241-1980  
District II  
811 S 1st Street, Artesia, NM 88210-2834  
District III  
1000 Rio Brazos Rd., Aztec, NM 87410  
District IV  
2040 South Pacheco, Santa Fe, NM 87505

State of New Mexico  
Geology, Minerals & Natural Resources Department

**OIL CONSERVATION DIVISION**  
2040 South Pacheco  
Santa Fe, NM 87505

Form C-101  
Revised October 18, 1994  
Instructions on back  
Submit to Appropriate District Office  
State Lease - 6 Copies  
Fee Lease - 5 Copies

☒ **AMENDED REPORT**

**APPLICATION FOR PERMIT TO DRILL, RE-ENTER, DEEPEN, PLUGBACK, OR ADD A ZONE**

<sup>1</sup> Operator name and Address Chevron U.S.A. Inc. P.O. Box 1150 Midland, TX 79702		<sup>2</sup> OGRID Number 4323
<sup>4</sup> Property Code 2571		<sup>5</sup> Property Name ARROWHEAD GRAYBURG UNIT
		<sup>3</sup> API Number 30-0 30-025-34636
		<sup>6</sup> Well No. 335

<sup>7</sup> Surface Location									
UL or lot no.	Section	Township	Range	Lot. Idn	Feet from the	North/South Line	Feet from the	East/West line	County
M	36	21S	36E		160	SOUTH	1258	WEST	LEA

<sup>8</sup> Proposed Bottom Hole Location If Different From Surface									
UL or lot no.	Section	Township	Range	Lot. Idn	Feet from the	North/South Line	Feet from the	East/West line	County
<sup>9</sup> Proposed Pool 1 ARROWHEAD; GRAYBURG 03040					<sup>10</sup> Proposed Pool 2				

<sup>11</sup> Work Type Code N	<sup>12</sup> Well Type Code O	<sup>13</sup> Cable/Rotary ROTARY	<sup>14</sup> Lease Type Code S	<sup>15</sup> Ground Level Elevation 3528'
<sup>16</sup> Multiple	<sup>17</sup> Proposed Depth 3872'	<sup>18</sup> Formation GRAYBURG	<sup>19</sup> Contractor UNKNOWN	<sup>20</sup> Spud Date 6/1/99

<sup>21</sup> Proposed Casing and Cement Program					
Hole Size	Casing Size	Casing weight/foot	Setting Depth	Sacks of Cement	Estimated TOC
11"	8-5/8"	24	500'	275	SURF
7-7/8"	5-1/2"	15.5	3872'	625	SURF

<sup>22</sup> Describe the proposed program. If this application is to DEEPEN or PLUG BACK give the data on the present productive zone and proposed new productive zone. Describe the blowout prevention program, if any. Use additional sheets if necessary

CHEVRON PROPOSES TO:  
DRILL 11" HOLE TO 500', RUN 8-5/8" CSG. CMT W/CLASS "C" TO SURF.  
DRILL 7-7/8" HOLE TO 3872', RUN 5-1/2" CSG. CMT W/CLASS "C" TO SURF.

MUD PROGRAM: 0' - 500' 8.4 PPG FRESH WATER  
500' - 3872' 10.0 PPG BRINE WATER

Permit Expires 1 Year From Approval  
Date Unless Drilling Underway

CHEVRON CLASS II BOPE

<sup>23</sup> I hereby certify that the information given above is true and complete to the best of my knowledge and belief.

Signature:

*J. K. Ripley*

Printed name: J. K. RIPLEY

Title: TECHNICAL ASSISTANT

**OIL CONSERVATION DIVISION**

Approved by: ORIGINAL SIGNED BY CHRIS WILLIAM  
DISTRICT I SUPERVISOR

Title:

Approval Date: JUL 19 1999

Expiration Date:

7/15/99

(915)687-7148

CT  
MP

DISTRICT I  
P.O. Box 1980, Hobbs, NM 88241-1980

State of New Mexico  
Energy, Minerals and Natural Resources Department

Form C-102  
Revised February 10, 1994  
Submit to Appropriate District Office  
State Lease - 4 Copies  
Fee Lease - 3 Copies

DISTRICT II  
P.O. Drawer DD, Artesia, NM 88211-0719

DISTRICT III  
1000 Rio Brazos Rd., Artec, NM 87410

OIL CONSERVATION DIVISION  
P.O. Box 2088  
Santa Fe, New Mexico 87504-2088

DISTRICT IV  
P.O. Box 2088, Santa Fe, NM 87504-2088

☐ AMENDED REPORT

WELL LOCATION AND ACREAGE DEDICATION PLAT

API Number 30-025-34636	Pool Code 03040	Pool Name ARROWHEAD; GRAYBURG
Property Code 2571	Property Name AGU	Well Number 335
OGRID No. 4323	Operator Name CHEVRON U.S.A. PRODUCTION COMPANY	Elevation 3527

Surface Location

UL or lot No. M	Section 36	Township 21 S	Range 36 E	Lot Idn	Feet from the 160	North/South line SOUTH	Feet from the 1258	East/West line WEST	County LEA
--------------------	---------------	------------------	---------------	---------	----------------------	---------------------------	-----------------------	------------------------	---------------

Bottom Hole Location If Different From Surface

UL or lot No.	Section	Township	Range	Lot Idn	Feet from the	North/South line	Feet from the	East/West line	County
Dedicated Acres 40	Joint or Infill	Consolidation Code	Order No.						

NO ALLOWABLE WILL BE ASSIGNED TO THIS COMPLETION UNTIL ALL INTERESTS HAVE BEEN CONSOLIDATED  
OR A NON-STANDARD UNIT HAS BEEN APPROVED BY THE DIVISION

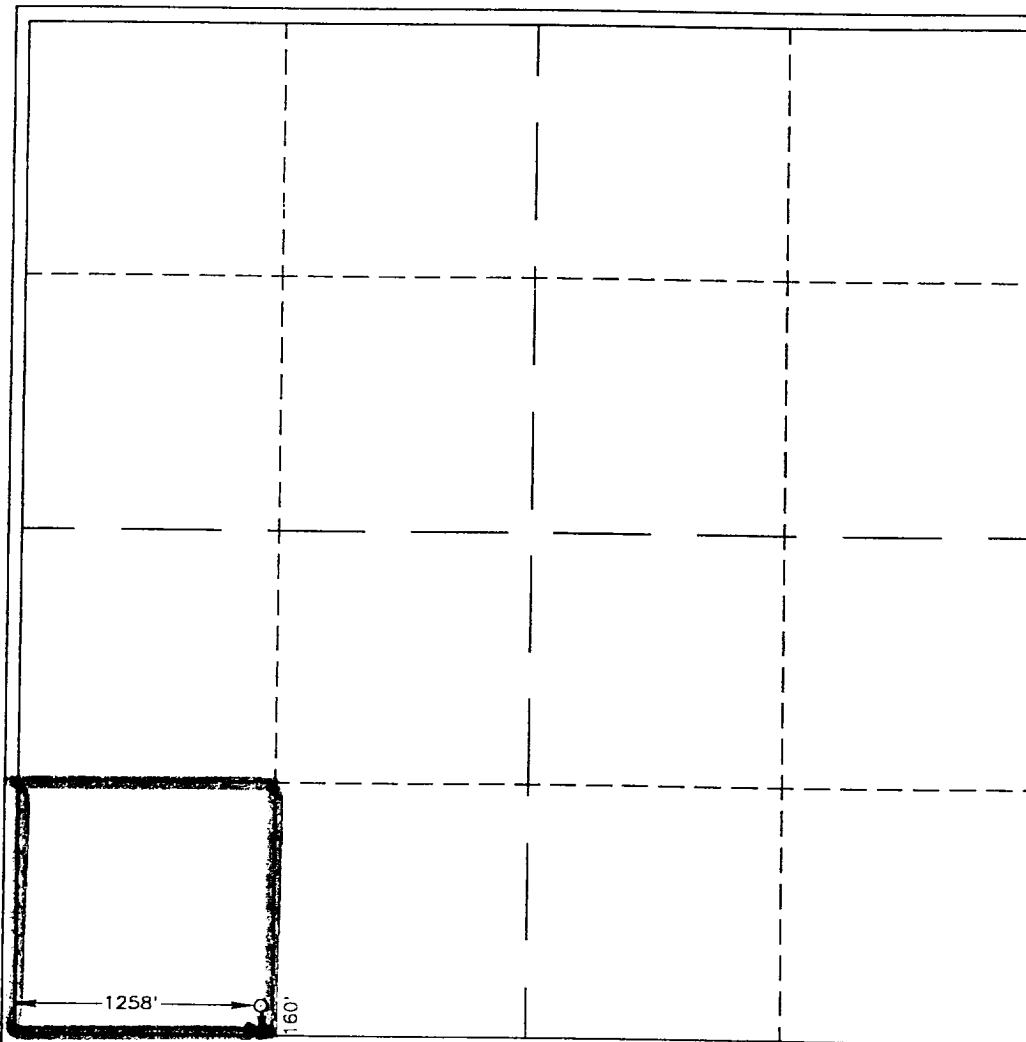
	<p>OPERATOR CERTIFICATION</p> <p>I hereby certify the the information contained herein is true and complete to the best of my knowledge and belief.</p> <p><i>J. K. Ripley</i> Signature J. K. RIPLEY Printed Name REGULATORY O.A. Title 7/15/99 Date</p>
	<p>SURVEYOR CERTIFICATION</p> <p>I hereby certify that the well location shown on this plat was plotted from field notes of actual surveys made by me or under my supervision, and that the same is true and correct to the best of my belief.</p> <p>JULY 7, 1999 Date Surveyed JLP Signature &amp; Seal of Professional Surveyor RONALD J. EDSON 7-12-99 P.O. No. 99-115573 Certified No. RONALD J. EDSON, 3239 EDSON, 12041 WAGON McDONALD, 12185</p>

Amended Plat

FIN

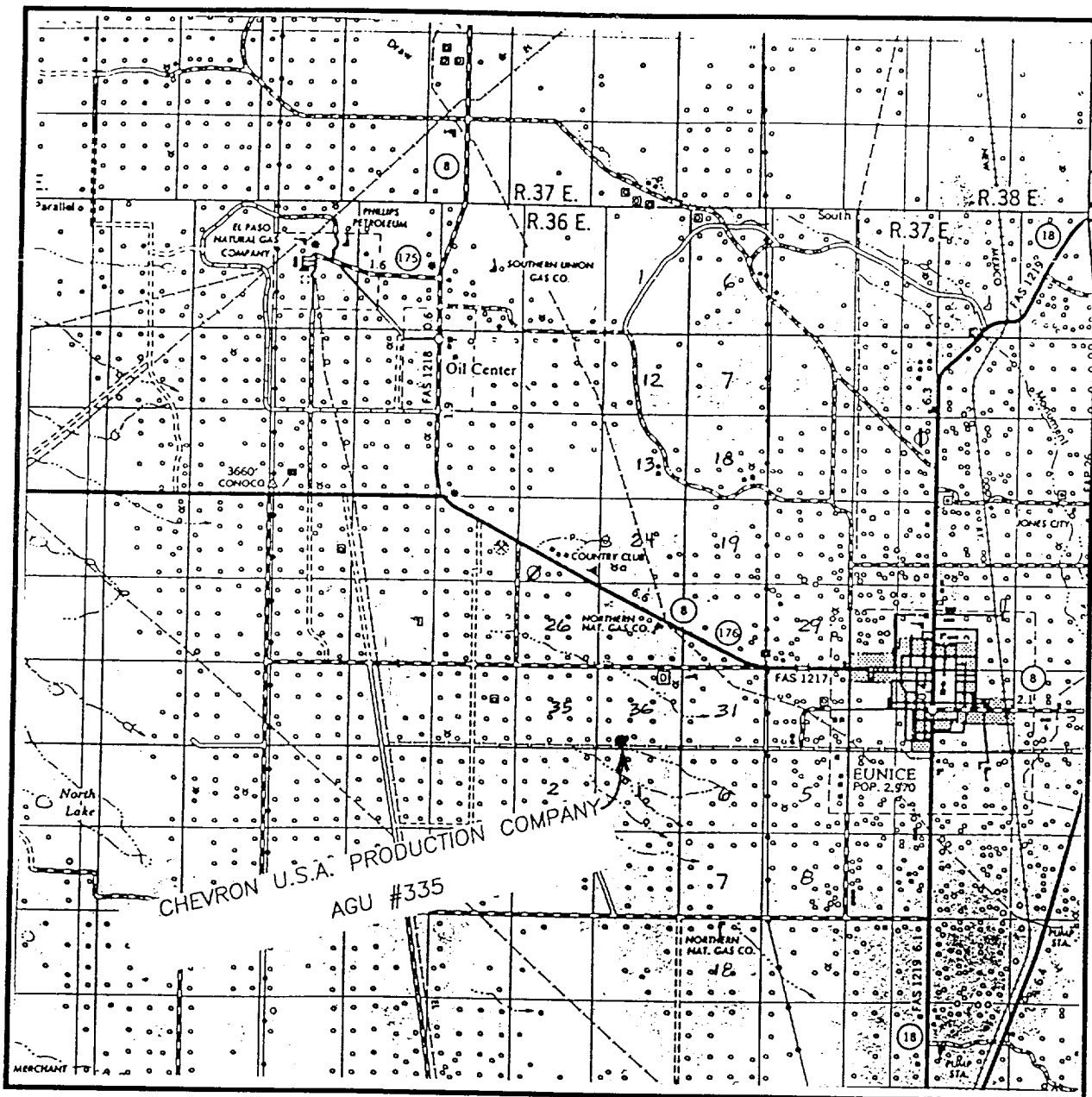

SEC. 36 TWP. 21-S RGE. 36-E

SURVEY \_\_\_\_\_ N.M.P.M.

COUNTY \_\_\_\_\_ LEA \_\_\_\_\_

DESCRIPTION 160' FSL & 1258' FWL

ELEVATION 3527'

OPERATOR CHEVRON U.S.A. PRODUCTION COMPANY

LEASE \_\_\_\_\_ AGU #335

JOHN WEST SURVEYING  
HOBBS, NEW MEXICO

(505) 393-3117

# LOCATION VERIFICATION MAP

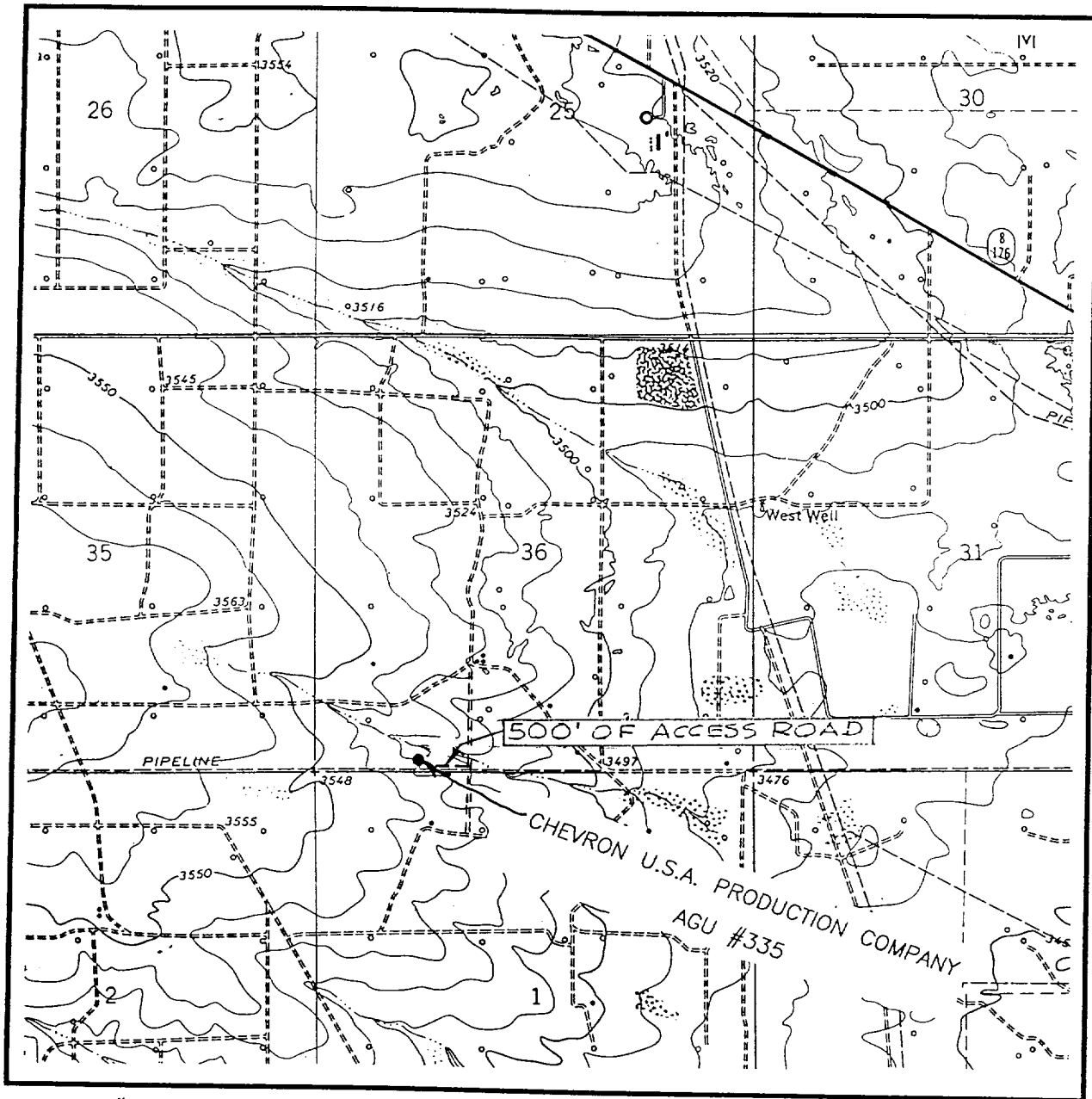

SCALE: 1" = 2000'

CONTOUR INTERVAL - 10'

SEC. 36 TWP. 21-S RGE. 36-E

SURVEY N.M.P.M.

COUNTY LEA

DESCRIPTION 160' FSL & 1258' FWL

ELEVATION 3527'

OPERATOR CHEVRON U.S.A. PRODUCTION COMPANY

LEASE AGU #335

U.S.G.S. TOPOGRAPHIC MAP

EUNICE, N.M.

**JOHN WEST SURVEYING  
HOBBS, NEW MEXICO**

**(505) 393-3117**