

District I
1625 N. French Dr., Hobbs, NM 88240

District II
811 South First, Artesia, NM 88210

District III
1000 Rio Brazos Rd., Aztec, NM 87410

District IV
2040 South Pacheco, Santa Fe, NM 87505

State of New Mexico
Energy, Minerals & Natural Resources Department

OIL CONSERVATION DIVISION
2040 South Pacheco
Santa Fe, NM 87505

Form C-101
Revised October 18, 1994
Instructions on Back
Submit to Appropriate District Office
State Lease - 6 Copies
Fee Lease - 5 Copies

☐ AMENDED REPORT

APPLICATION FOR PERMIT TO DRILL, RE-ENTER, DEEPEN, PLUGBACK, OR ADD A ZONE

1 Operator Name and Address Apache Corporation 2000 Post Oak Blvd. Ste. 100 Houston, Texas 77056-4400		2 OGRID Number 000873
4 Property Code 22503	5 Property Name Northeast Drinkard Unit	3 API Number 30-025- 34741
		6 Well No. 621

7 Surface Location

UL or lot no.	Section	Township	Range	Lot Idn	Feet from the	North/South Line	Feet from the	East/West Line	County
F	14	21S	37E		1500	North	1400	West	Lea

8 Proposed Bottom Hole Location if Different From Surface

UL or lot no.	Section	Township	Range	Lot Idn	Feet from the	North/South Line	Feet from the	East/West Line	County
9 Proposed Pool 1 Eunice; Blinebry-Tubb-Drinkard, North (22900)					10 Proposed Pool 2				

11 Work Type Code N	12 Well Type Code O	13 Cable/Rotary R	14 Lease Type Code P	15 Ground Level Elevation 3422
16 Multiple	17 Proposed Depth 7000	18 Formation Blinebry/Drinkard	19 Contractor	20 Spud Date ASAP

21 Proposed Casing and Cement Program

Hole Size	Casing Size	Casing weight/foot	Setting Depth	Sacks of Cement	Estimated TOC
12-1/4"	8-5/8"	24# K-55 ST&C	1365' or Anhydrite Form.	480 sx PBCZ	Circulate to Surface
7-7/8"	5-1/2"	17# K-55 LT&C	7000'	850 sx Interfill	
				"C" & 350 sx	Circulate to Surface
				50/50 POZ Mix	

22 Describe the proposed program. If this application is to DEEPEN or PLUG BACK give the data on the present productive zone and proposed new productive zone. Describe the blowout prevention program, if any. Use additional sheets if necessary.

Propose to drill 12-1/4" hole to 1365', run, set & cement 1365' of 8-5/8" casing. Circulate cement to surface

Drill 7-7/8" hole to 7000', run, set & cement 7000' of 5-1/2" casing. Circulate cement to surface.

Blow Out Prevention: See attached copy

23 I hereby certify that the information given above is true and complete to the best of my knowledge and belief.

Signature: *Everett Ouzts*
Printed Name: Everett Ouzts
Title: Engineering Technician
Date: 10-18-99 Phone: 915-631-3733

OIL CONSERVATION DIVISION

Approved By:

Title:

Approval Date:

Expiration Date:

Conditions of Approval:

MP

DISTRICT I
P.O. Box 1960, Hobbs, NM 88241-1960

DISTRICT II
P.O. Drawer DD, Artesia, NM 88211-0719

DISTRICT III
1000 Rio Brazos Rd., Artec, NM 87410

DISTRICT IV
P.O. BOX 2088, SANTA FE, N.M. 87504-2088

State of New Mexico
Energy, Minerals and Natural Resources Department

Form C-102
Revised February 10, 1984
Submit to Appropriate District Office
State Lease - 4 Copies
Fee Lease - 3 Copies

OIL CONSERVATION DIVISION

P.O. Box 2088
Santa Fe, New Mexico 87504-2088

☐ AMENDED REPORT

WELL LOCATION AND ACREAGE DEDICATION PLAT

API Number 30-025- 34741	Pool Code 22900	Pool Name Eunice; Blinebry-Tubb-Drinard, North
Property Code 22503	Property Name Northeast Drinkard Unit	Well Number 621
OGRID No. 000873	Operator Name APACHE CORPORATION	Elevation 3422'

Surface Location

UL or lot No. F	Section 14	Township 21 S	Range 37 E	Lot Idn	Feet from the 1500	North/South line NORTH	Feet from the 1400	East/West line WEST	County LEA
--------------------	---------------	------------------	---------------	---------	-----------------------	---------------------------	-----------------------	------------------------	---------------

Bottom Hole Location If Different From Surface

UL or lot No.	Section	Township	Range	Lot Idn	Feet from the	North/South line	Feet from the	East/West line	County
Dedicated Acres		Joint or Infill		Consolidation Code		Order No.			

NO ALLOWABLE WILL BE ASSIGNED TO THIS COMPLETION UNTIL ALL INTERESTS HAVE BEEN CONSOLIDATED
OR A NON-STANDARD UNIT HAS BEEN APPROVED BY THE DIVISION

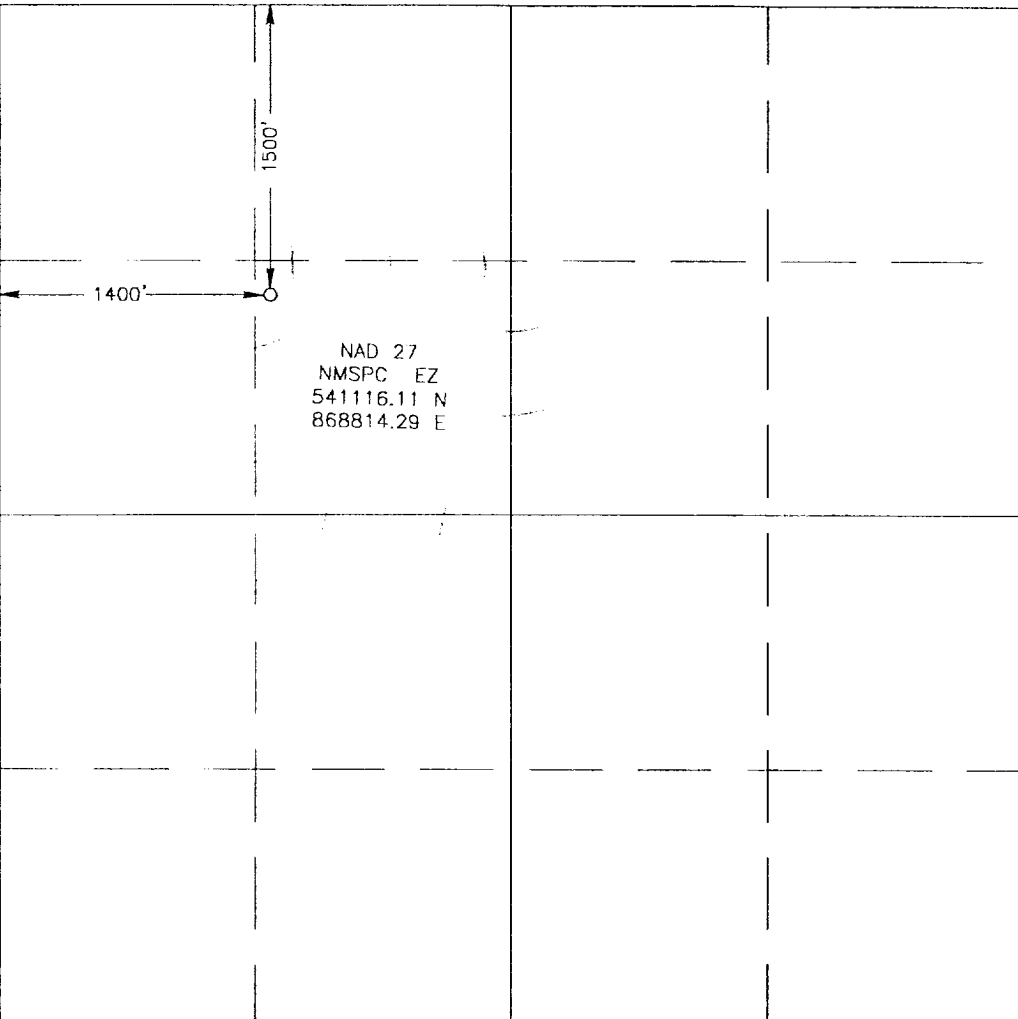
	<p>OPERATOR CERTIFICATION</p> <p>I hereby certify the the information contained herein is true and complete to the best of my knowledge and belief.</p> <p><u>Everett Ouzts</u> Signature Everett Ouzts Printed Name Engineering Technician Title 10-18-99 Date</p> <p>SURVEYOR CERTIFICATION</p> <p>I hereby certify that the well location shown on this plat was plotted from field notes of actual surveys made by me or under my supervision and that the same is true and correct to the best of my belief.</p> <p>OCT. 6, 1999 Date Surveyed CDG Signature & Seal of Professional Surveyor RONALD J. EIDSON 99-11-0843 Certificate No. JOHN W. WEST 676 RONALD J. EIDSON 3239 GARY EIDSON 12641</p>
--	--

VICINITY MAP

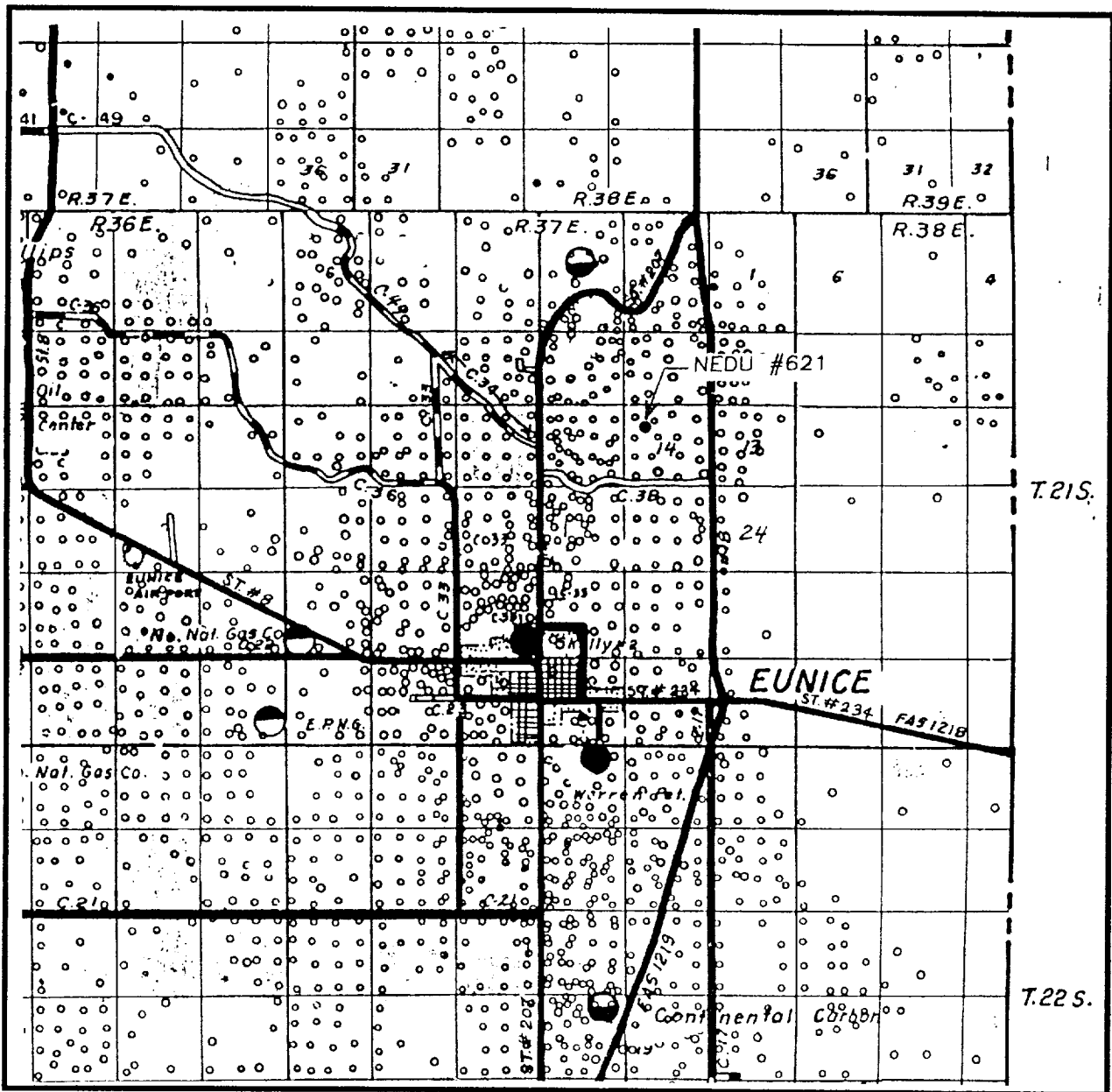

SCALE: 1" = 2 MILES

SEC. 14 TWP. 21-S RGE. 37-E

SURVEY N.M.P.M.

COUNTY LEA

DESCRIPTION 1500' FNL & 1400' FWL

ELEVATION 3422'

OPERATOR APACHE CORPORATION

LEASE NEDU

JOHN WEST SURVEYING
HOBBS, NEW MEXICO
(505) 393-3117

LOCATION VERIFICATION MAP

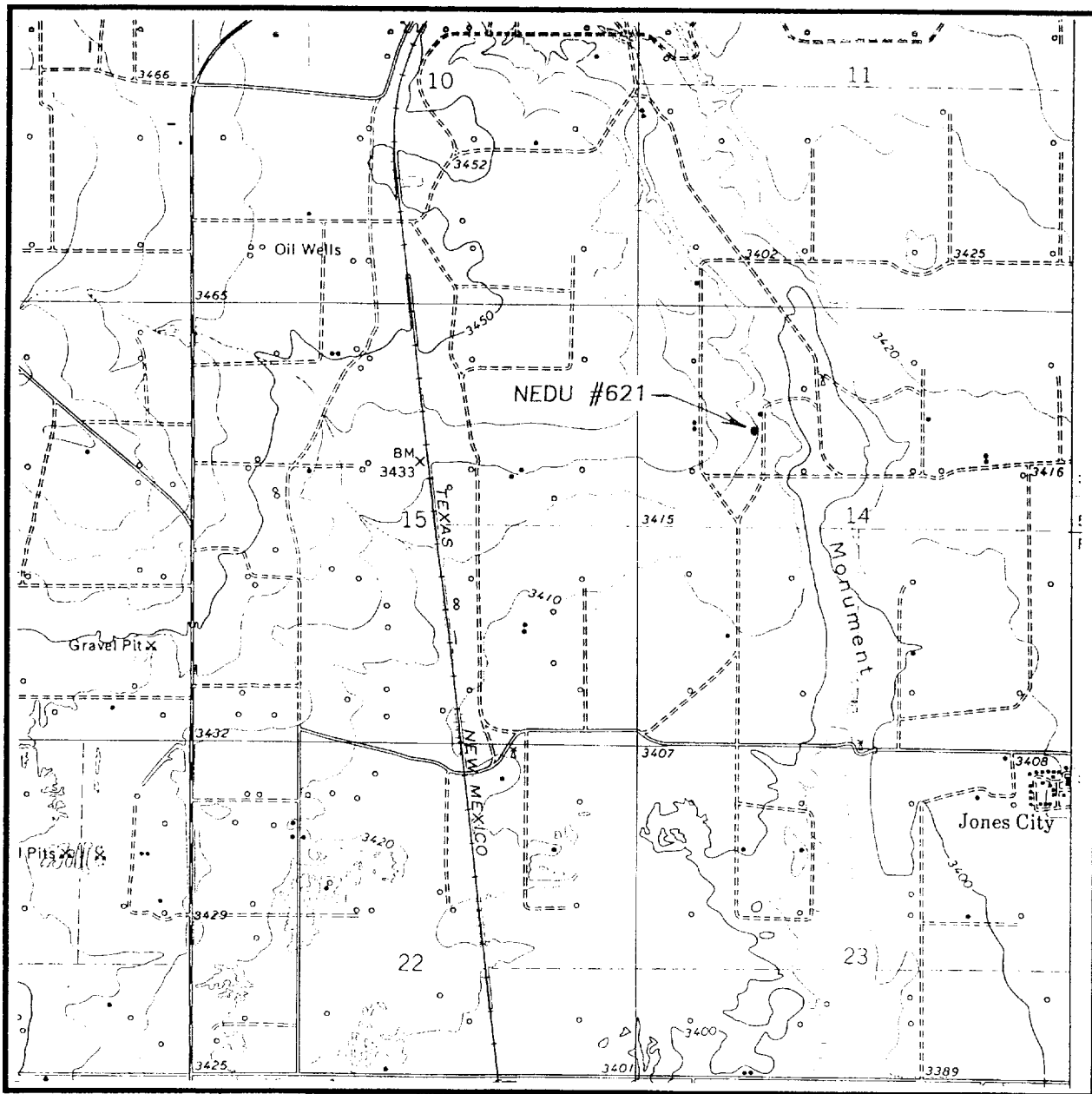

SCALE: 1" = 2000'

CONTOUR INTERVAL:
EUNICE - 10'

SEC. 14 TWP. 21-S RGE. 37-E

SURVEY N.M.P.M.

COUNTY LEA

DESCRIPTION 1500' FNL & 1400' FWL

ELEVATION 3422'

OPERATOR APACHE CORPORATION

LEASE NEDU

U.S.G.S. TOPOGRAPHIC MAP

HOBBS, SW

JOHN WEST SURVEYING
HOBBS, NEW MEXICO
(505) 393-3117

Apache Corporation

WESTERN REGION

NEDU

Eunice; Blinberry-Tubb-Drinkard, North
LEA COUNTY, NEW MEXICO

DATE:	DATE OF COMPLETION:	DATE
THIS PROJECT:	DATE OF	DATE

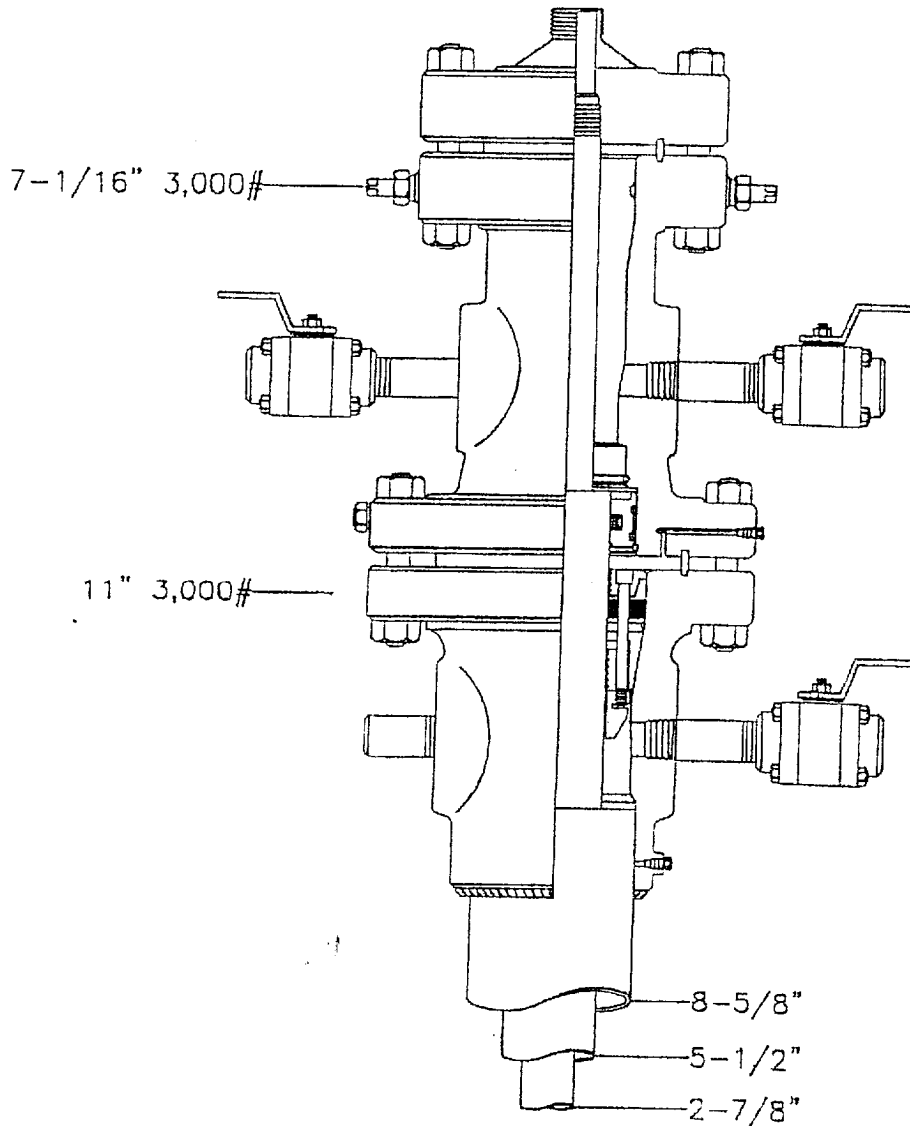

ELF

8/10/82
ABOVE DATE DOES NOT
INDICATE WHEN
CONFIDENTIAL LOGS
WILL BE RELEASED

CONFIDENTIAL