

0/2 USGS/3 plats - NMDC-2/2 plats  
WAM WAR/plat file

NEW MEXICO OIL CONSERVATION COMMISSION  
WELL LOCATION AND ACREAGE DEDICATION PLAT

FORM C-128  
Revised 5/1/57

SEE INSTRUCTIONS FOR COMPLETING THIS FORM ON THE REVERSE SIDE

SECTION A

|   |   |                              |                                       |                      |
|---|---|------------------------------|---------------------------------------|----------------------|
| Operator<br><b>Continental Oil Co.</b>  |   | Lease<br><b>Marshall</b>     |                                       | Well No.<br><b>3</b> |
| Unit Letter<br><b>N</b>   | Section<br><b>19</b>                        | Township<br><b>23 South</b>  | Range<br><b>33 East</b>               | County<br><b>Lea</b> |
| Actual Footage Location of Well:<br><b>660</b> feet from the <b>South</b> line and <b>1910</b> feet from the <b>West</b> line |   |                              |                                       |                      |
| Ground Level Elev.  | Producing Formation<br><b>Delaware Sand</b> | Pool<br><b>Crus Delaware</b> | Dedicated Acreage:<br><b>40</b> Acres |                      |

1. Is the Operator the only owner in the dedicated acreage outlined on the plat below? YES **XX** NO \_\_\_\_ . ("Owner" means the person who has the right to drill into and to produce from any pool and to appropriate the production either for himself or for himself and another. (65-3-29 (e) NMSA 1935 Comp.)
2. If the answer to question one is "no," have the interests of all the owners been consolidated by communization agreement or otherwise? YES \_\_\_\_ NO \_\_\_\_ . If answer is "yes," Type of Consolidation \_\_\_\_
3. If the answer to question two is "no," list all the owners and their respective interests below:

| Owner | Land Description |
|-------|------------------|
|       |                  |
|       |                  |

SECTION B

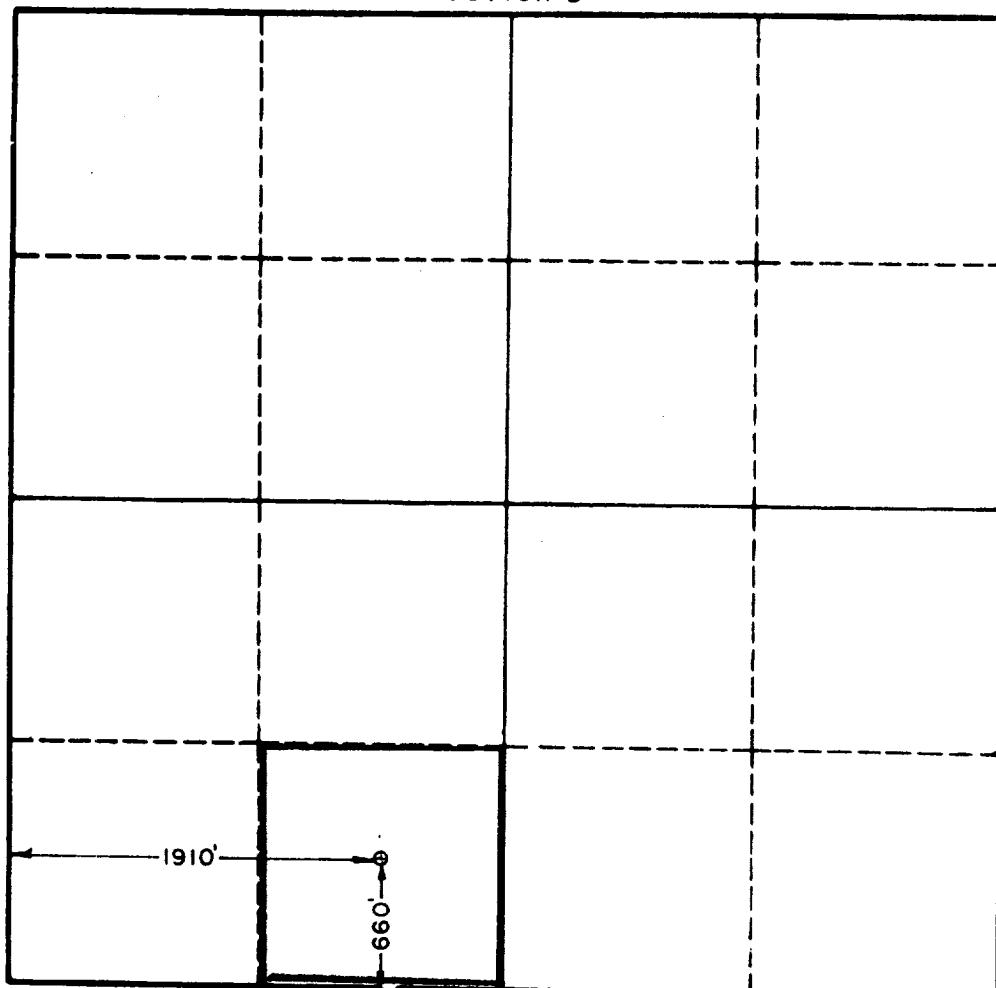

CERTIFICATION

I hereby certify that the information in SECTION A above is true and complete to the best of my knowledge and belief.

Name  
**J. R. Parker**  
Position  
**District Superintendent**  
Company  
**Continental Oil Company**  
Date  
**November 28, 1961**

I hereby certify that the well location shown on the plat in SECTION B was plotted from field notes of actual surveys made by **676** or under my supervision, and that the same is true and correct to the best of my knowledge and belief.

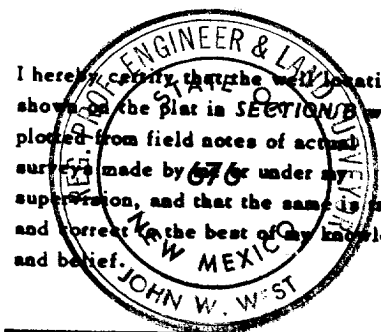

Date Surveyed  
**11-28-61**  
Registered Professional Engineer and/or Land Surveyor, **JOHN W. WEST**  
Certificate No.  
**W.M. - P.E. & L.S. NO. 676**

0 330 660 990 1320 1650 1980 2310 2640 2000 1500 1000 500 0