

(SUBMIT IN TRIPLICATE)

Land Office

Lease No. **LC 067158 (M&G)**

Unit

APPROVEDUNITED STATES
DEPARTMENT OF THE INTERIOR
GEOLOGICAL SURVEYSubject to the condition on back of
this pageH. A. DUPONT
DISTRICT SUPERVISOR**SUNDRY NOTICES AND REPORTS ON WELLS**

NOTICE OF INTENTION TO DRILL.....	<input checked="" type="checkbox"/>	SUBSEQUENT REPORT OF WATER SHUT-OFF.....	
NOTICE OF INTENTION TO CHANGE PLANS.....		SUBSEQUENT REPORT OF SHOOTING OR ACIDIZING.....	
NOTICE OF INTENTION TO TEST WATER SHUT-OFF.....		SUBSEQUENT REPORT OF ALTERING CASING.....	
NOTICE OF INTENTION TO RE-DRILL OR REPAIR WELL.....		SUBSEQUENT REPORT OF RE-DRILLING OR REPAIR.....	
NOTICE OF INTENTION TO SHOOT OR ACIDIZE.....		SUBSEQUENT REPORT OF ABANDONMENT.....	
NOTICE OF INTENTION TO PULL OR ALTER CASING.....		SUPPLEMENTARY WELL HISTORY.....	
NOTICE OF INTENTION TO ABANDON WELL.....			

(INDICATE ABOVE BY CHECK MARK NATURE OF REPORT, NOTICE, OR OTHER DATA)

May 29, 1958

Well No. **1-2** is located **1900** ft. from **N** line and **1900** ft. from **E** line of sec. **12**
SE 1/4 NW 1/4 12
(1/4 Sec. and Sec. No.) **T 23S R35E** (Twp.) (Range) (Meridian)
Midland **Lee County** **New Mexico**
(Field) (County or Subdivision) (State or Territory)

The elevation of the derrick floor above sea level is **?** ft.**DETAILS OF WORK**

(State names of and expected depths to objective sands; show sizes, weights, and lengths of proposed casings; indicate mudding jobs, cementing points, and all other important proposed work)

Propose to set 10 3/4" surface casing to red bed at approximately 300', drill to later and set 7 5/8" intermediate string to approximately 4000' and drill to Delaware Sand at approximately 6500'.

10 3/4" - 32# N-40 Suls. - Cement To Surface

7 5/8" - 26.40# J-55 Suls. - Cement Bottom 500' or More

5 1/2" - 15 1/2# J-55 Suls. - Cement Bottom 500' or More and Top Lings

2 3/8" - 4.7# J-55 Suls.

All figures approximate since depths in Midland not available until penetrated.
Will use Salt Mud to 4000' and probably low solid fresh water mud on to T.D.

I understand that this plan of work must receive approval in writing by the Geological Survey before operations may be commenced.

Company **Republic Natural Gas Company**Address **Box 195****Midland, Texas**By Title **District Superintendent**

The approval is subject to the following conditions:

1. If the well is completed as a producer, the Santa Rosa or any other fresh water formation above the salt section must be isolated from the Salt section by cement behind the 7 5/8" casing. In accordance with our discussion, such operations may be performed after the well is tested for production.

NE., MEXICO OIL CONSERVATION COMMISSION
Well Location and Acreage Dedication Plat

Section A.

Date May 20, 1958

Operator Republic Natural Gas Co. et al Lease National
Well No. 1 Unit Letter F Section 12 Township 23 S Range 34 E NMPM
Located 1980 Feet From North Line, 1980 Feet From West Line
County Leon G. L. Elevation 537. 340 Dedicated Acreage 40 Acres
Name of Producing Formation Willa Oak Pool Willa Oak

1. Is the Operator the only owner* in the dedicated acreage outlined on the plat below?
Yes Yes No .
2. If the answer to question one is "no," have the interests of all the owners been consolidated by communitization agreement or otherwise? Yes No . If answer is "yes," Type of Consolidation
3. If the answer to question two is "no," list all the owners and their respective interests below:

Owner

Land Description

Section B

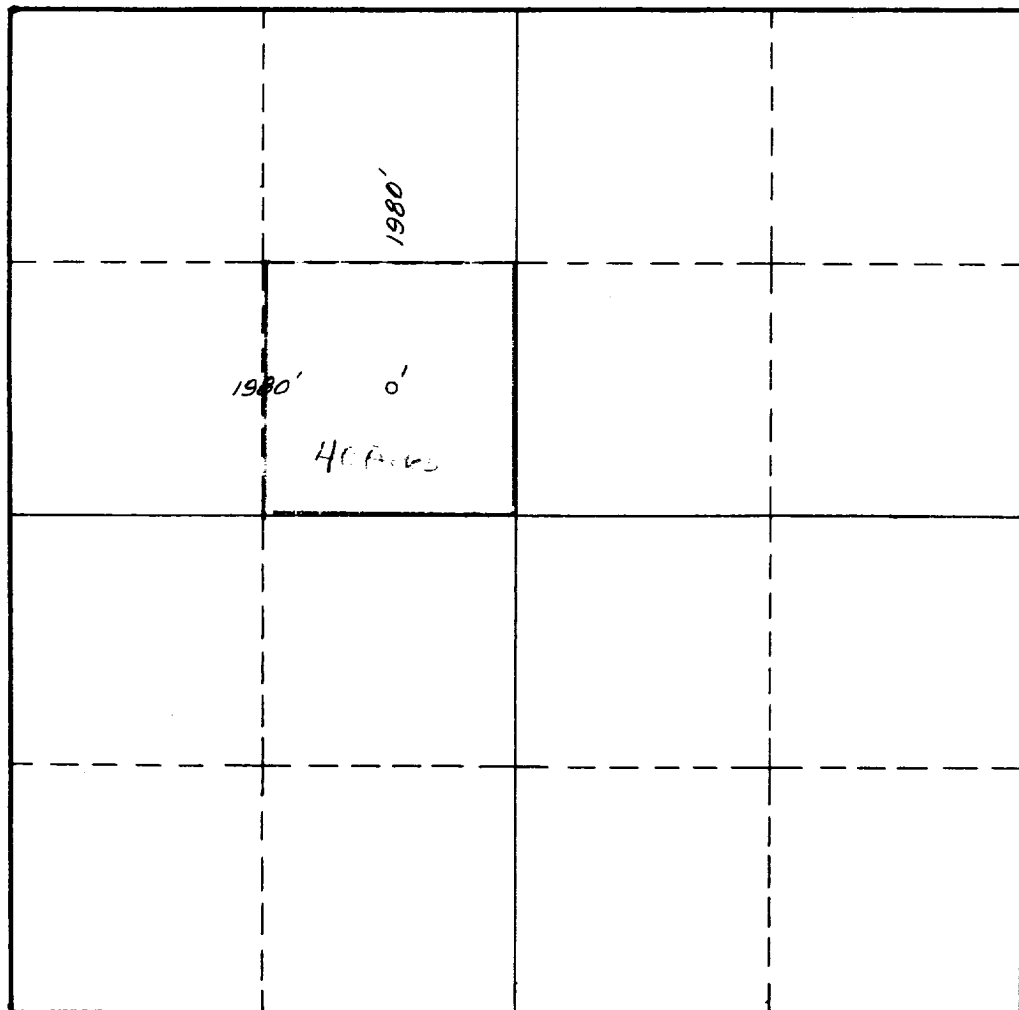

This is to certify that the information in Section A above is true and complete to the best of my knowledge and belief.

Republic Natural Gas Co
(Operator)

E. B. Ray E. B. Ray
(Representative)

Box 125, Midland, Texas
Address

This is to certify that the well location shown on the plat in Section B was plotted from field notes of actual surveys made by me or under my supervision and that the same is true and correct to the best of my knowledge and belief.

Date Surveyed May 29, 1958

J. F. Johnson
Registered Professional
Engineer and/or Land Surveyor.

Certificate No. 1390

INSTRUCTIONS FOR COMPLETION:

1. Operator shall furnish and certify to the information called for in Section A.
2. Operator shall outline the dedicated acreage for both oil and gas wells on the plat in Section B.
3. A registered professional engineer or land surveyor registered in the State of New Mexico or approved by the Commission shall show on the plat the location of the well and certify this information in the space provided.
4. All distances shown on the plat must be from the outer boundaries of Section.
5. If additional space is needed for listing owners and their respective interests as required in question 3, Section A, please use space below

* "Owner" means the person who has the right to drill into and to produce from any pool and to appropriate the production either for himself or for himself and another. (65-3-29 (e) NMSA 1953 Comp.)