

NEW MEXICO OIL CONSERVATION COMMISSION
Well Location and Acreage Dedication Plat

Section A.

Date 7-5-1957

Operator Ohio Oil Company Lease Ethel Shipley Owens
Well No. 4 Unit Letter K Section 26 Township 22 South Range 36 East NMPM
Located 1650 Feet From West Line, 1980 Feet From South Line
County Lea G. L. Elevation 3500.5 Dedicated Acreage 40 Acres
Name of Producing Formation Queen Pool South Eunice

1. Is the Operator the only owner* in the dedicated acreage outlined on the plat below?
Yes * No .
2. If the answer to question one is "no," have the interests of all the owners been consolidated by communitization agreement or otherwise? Yes No . If answer is "yes," Type of Consolidation
3. If the answer to question two is "no," list all the owners and their respective interests below:

Owner

Land Description

Section B

* Ohio Oil Company - 100% Working Interest
Western Natural Gas Company - Gas Well Rights Only

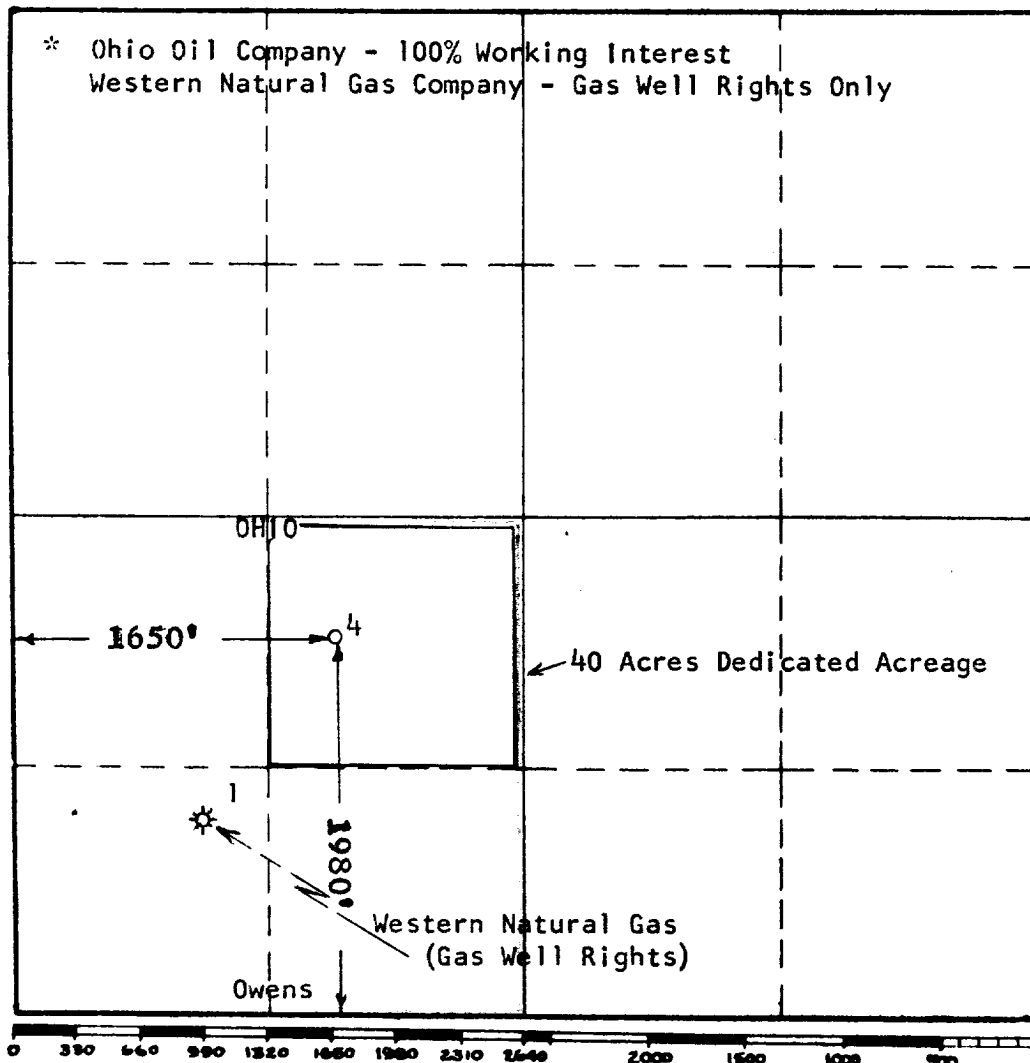

This is to certify that the information in Section A above is true and complete to the best of my knowledge and belief.

The Ohio Oil Company

(Operator)
Thomas O. Webb
Thomas O. Webb

(Representative)

Box 2107, Hobbs, New Mexico

Address

This is to certify that the well location shown on the plat in Section B was plotted from field notes of actual surveys made by me or under my supervision and that the same is true and correct to the best of my knowledge and belief.

Date Surveyed 7-3-1957

John W. West
Registered Professional
Engineer and/or Land Surveyor.

Certificate No. 676

(See instructions for completing this form on the reverse side)