

NEW MEXICO OIL CONSERVATION COMMISSION

Santa Fe, New Mexico

NOTICE OF INTENTION TO DRILL OR RECOMPLETE

Notice must be given to the District Office of the Oil Conservation Commission and approval obtained before drilling or recompletion begins. If changes in the proposed plan are considered advisable, a copy of this notice showing such changes will be returned to the sender. Submit this notice in **QUINTUPLICATE**. One copy will be returned following approval. See additional instructions in Rules and Regulations of the Commission.

Hobbs, New Mexico

(Place)

August 15, 1957

(Date)

OIL CONSERVATION COMMISSION
SANTA FE, NEW MEXICO

Gentlemen:

You are hereby notified that it is our intention to commence the (Drilling) (~~Recompletion~~) of a well to be known as

Shell Oil Company

(Company or Operator)

Christians

(Lease)

2

in

0

(Unit)

1650

The well is

located 650 feet from the north line and 1650 feet from the

west

line of Section 26, T. -2 -3, R. -16 -1, NMPM.

(GIVE LOCATION FROM SECTION LINE)

South Eunice

Pool, Lea County

R-16-1

D	2C	B	A
E	F	G	H
L	K	J	I
M	N	O	P

If State Land the Oil and Gas Lease is No.

If patented land the owner is A. L. ChristiansAddress Rotary Tools

We propose to drill well with drilling equipment as follows:

1 The status of plugging bond is Blanket

2 Drilling Contractor Undetermined

We intend to complete this well in the Seven Rivers-Queen formation at an approximate depth of 3810 feet.

CASING PROGRAM

We propose to use the following strings of Casing and to cement them as indicated:

Size of Hole	Size of Casing	Weight per Foot	New or Second Hand	Depth	Sacks Cement
11"	8 5/8"	32	new	350	400
7 7/8"	5 1/2"	15.5	new	3810	800

If changes in the above plans become advisable we will notify you immediately.

ADDITIONAL INFORMATION (If recompletion give full details of proposed plan of work.)

Approved _____, 19_____
Except as follows:

OIL CONSERVATION COMMISSION

By

Title

Sincerely yours,

Shell Oil Company

(Company or Operator)

By B. Nevill **Original signed by**
B. Nevill
Position Division Exploitation Engineer
Send Communications regarding well to
Name Shell Oil Company
Address Box 1957
Hobbs, New Mexico

NEW MEXICO OIL CONSERVATION COMMISSION
Well Location and Acreage Dedication Plat

Section A.

Date August 15, 1957

Operator Shell Oil Company Lease Christmas C
Well No. 2 Unit Letter 0 Section 26 Township 22-S Range -36-E NMPM
Located 560 Feet From north Line, 1650 Feet From west Line
County Lee G. L. Elevation not available Dedicated Acreage 40 Acres
Name of Producing Formation Seven Rivers-Jucon Pool South Dunbar

1. Is the Operator the only owner* in the dedicated acreage outlined on the plat below?
Yes _____ No X.
2. If the answer to question one is "no," have the interests of all the owners been consolidated by communitization agreement or otherwise? Yes _____ No X. If answer is "yes," Type of Consolidation _____
3. If the answer to question two is "no," list all the owners and their respective interests below:

<u>Owner</u>	<u>Land Description</u>
<u>El Paso Natural Gas (Gas rights)</u>	<u>NE/4 NW/4, Sec. 26-22S-36E</u>
<u>Midwater Oil Company (Operator Gas Well)</u>	<u>NE/4 NW/4, Sec. 26-22S-36E</u>
<u>Shell Oil Company (Oil Rights)</u>	<u>NE/4 NW/4, Sec. 26-22S-36E</u>

Section B

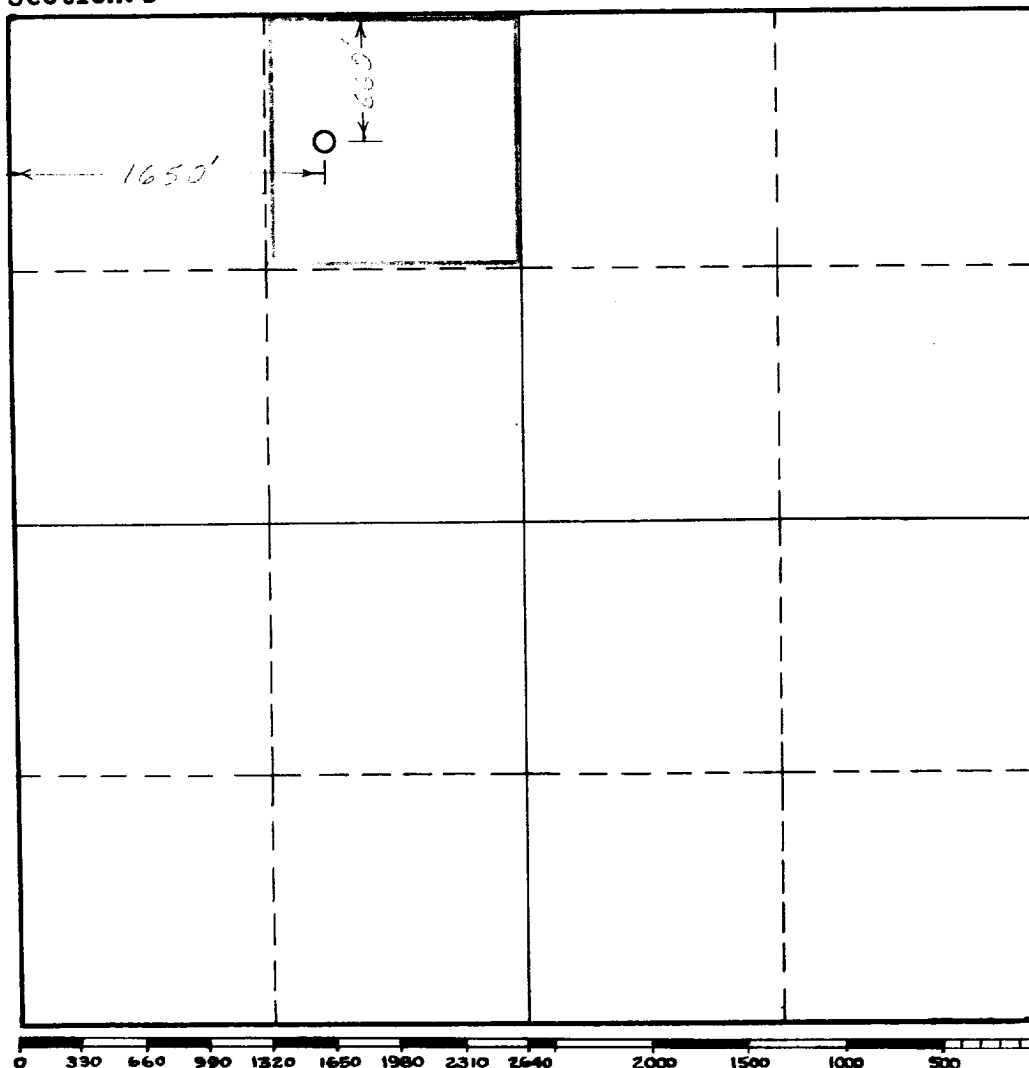

This is to certify that the information in Section A above is true and complete to the best of my knowledge and belief.

Shell Oil Company
(Operator)

E. Devill
(Representative)

Box 1957, Hobbs, New Mexico
Address

This is to certify that the well location shown on the plat in Section B was plotted from field notes of actual surveys made by me or under my supervision and that the same is true and correct to the best of my knowledge and belief.

Date Surveyed 8-15-57

Dwight Shepard
Registered Professional
Engineer and/or Land Surveyor.

Certificate No. 1467

INSTRUCTIONS FOR COMPLETION:

1. Operator shall furnish and certify to the information called for in Section A.
2. Operator shall outline the dedicated acreage for both oil and gas wells on the plat in Section B.
3. A registered professional engineer or land surveyor registered in the State of New Mexico or approved by the Commission shall show on the plat the location of the well and certify this information in the space provided.
4. All distances shown on the plat must be from the outer boundaries of Section.
5. If additional space is needed for listing owners and their respective interests as required in question 3, Section A, please use space below

* "Owner" means the person who has the right to drill into and to produce from any pool and to appropriate the production either for himself or for himself and another. (65-3-29 (e) NMSA 1953 Comp.)