

(SUBMIT IN TRIPLICATE)

UNITED STATES
DEPARTMENT OF THE INTERIOR
GEOLOGICAL SURVEY

Land Office Las Cruces
Lease No. LC 030133 b
Unit NMPU

SUNDRY NOTICES AND REPORTS ON WELLS

NOTICE OF INTENTION TO DRILL.....	<input checked="" type="checkbox"/>	SUBSEQUENT REPORT OF WATER SHUT-OFF.....	
NOTICE OF INTENTION TO CHANGE PLANS.....		SUBSEQUENT REPORT OF SHOOTING OR ACIDIZING.....	
NOTICE OF INTENTION TO TEST WATER SHUT-OFF.....		SUBSEQUENT REPORT OF ALTERING CASING.....	
NOTICE OF INTENTION TO RE-DRILL OR REPAIR WELL.....		SUBSEQUENT REPORT OF RE-DRILLING OR REPAIR.....	
NOTICE OF INTENTION TO SHOOT OR ACIDIZE.....		SUBSEQUENT REPORT OF ABANDONMENT.....	
NOTICE OF INTENTION TO PULL OR ALTER CASING.....		SUPPLEMENTARY WELL HISTORY.....	
NOTICE OF INTENTION TO ABANDON WELL.....			

(INDICATE ABOVE BY CHECK MARK NATURE OF REPORT, NOTICE, OR OTHER DATA)

Meyer D-33

January 8, 1958

Well No. 7 is located 1980 ft. from NEX line and 1980 ft. from WEX line of sec. 33
SW 1/4 Sec. 33 22S 36E NMPM
(1/4 Sec. and Sec. No.) (Twp.) (Range) (Meridian)
South Eunice Lea New Mexico
(Field) (County or Subdivision) (State or Territory)

The elevation of the derrick floor above sea level is _____ ft.

DETAILS OF WORK

(State names of and expected depths to objective sands; show sizes, weights, and lengths of proposed casings; indicate mudlogging jobs, cementing points, and all other important proposed work)

It is intended to drill this well with rotary tools at the above location to an estimated TD of 3700'. Casing will be cemented in accordance with U.S.G.S. standards and other special requirements will be complied with.

The following casing pattern is planned: 8 5/8" OD set at 350' with 350 sacks, cement to circulate; 5 1/2" OD set at 3700' with 1150 sacks, cement to return to 1275'.

Permission is requested to produce this well upon completion.

I understand that this plan of work must receive approval in writing by the Geological Survey before operations may be commenced.

Company Continental Oil Company

Address P. O. Box 68

Eunice, New Mexico

By R. C. Plabarsch

Title District Superintendent

NEW MEXICO OIL CONSERVATION COMMISSION
Well Location and Acreage Dedication Plat

Section A.

Date Jan 9, 1958

Operator Continental Oil Company Lease Meyer B-33
Well No. 7 Unit Letter K Section 33 Township 22 South Range 36 East NMPM
located 1980 Feet From South Line, 1980 Feet From West Line
County Lea G. L. Elevation 3477.5' Dedicated Acreage 40 Acres
Name of Producing Formation Permian Rivers and Ruess Pool South Eunice

1. Is the Operator the only owner* in the dedicated acreage outlined on the plat below?
Yes X No .
2. If the answer to question one is "no," have the interests of all the owners been consolidated by communitization agreement or otherwise? Yes No . If answer is "yes," Type of Consolidation
3. If the answer to question two is "no," list all the owners and their respective interests below:

Owner

Land Description

RECEIVED
JAN 16 1958
U. S. GEOLOGICAL SURVEY
HOBBS, NEW MEXICO

Section B

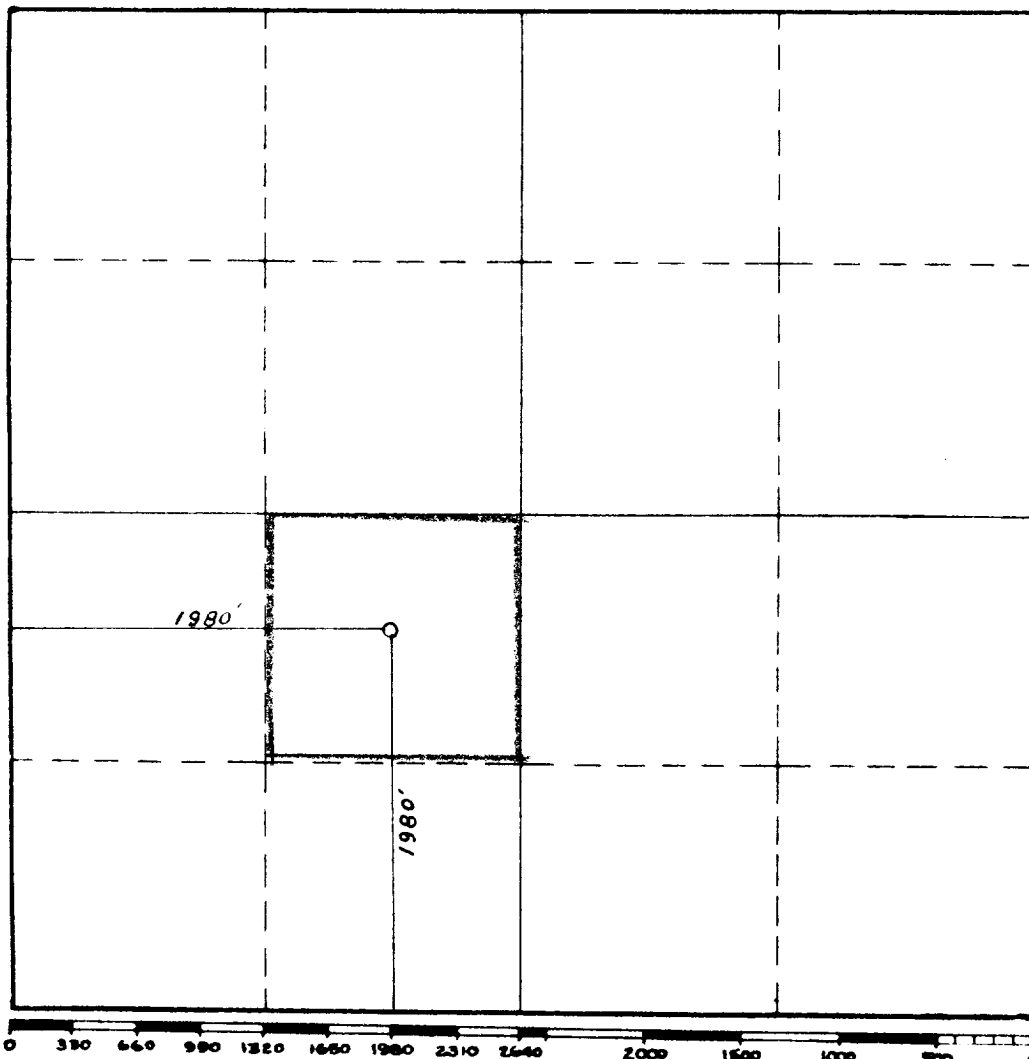

This is to certify that the information in Section A above is true and complete to the best of my knowledge and belief.

Continental Oil Company
(Operator)

H. P. Haharsh
(Representative)

Box 68, Eunice, New Mexico
Address

This is to certify that the well location shown on the plat in Section B was plotted from field notes of actual surveys made by me or under my supervision and that the same is true and correct to the best of my knowledge and belief.

Date Surveyed 1-9-58

John W. West
Registered Professional
Engineer and/or Land Surveyor.

Certificate No. 676

(See instructions for completing this form on the reverse side)