

NEW MEXICO OIL CONSERVATION COMMISSION  
Santa Fe, New Mexico

Form G-101  
Revised (12/1/55)

NOTICE OF INTENTION TO DRILL <sup>HOBBS OFFICE OCC</sup>

Notice must be given to the District Office of the Oil Conservation Commission and approval obtained before drilling or recompletion begins. If changes in the proposed plan are considered advisable, a copy of this notice showing changes will be returned to the sender. Submit this notice in QUINTUPPLICATE. One copy will be returned following approval. See additional instructions in Rules and Regulations of the Commission. If State Land submit 6 Copies Attach Form G-128 in triplicate to first 3 copies of form G-101

Hobbs, New Mexico

(Place)

August 20, 1959

(Date)

OIL CONSERVATION COMMISSION  
SANTA FE, NEW MEXICO

Gentlemen:

You are hereby notified that it is our intention to commence the Drilling of a well to be known as

Albert Gackle, Operator

(Company or Operator)

Rodman-Jones

(Lease)

Well No. 5, in N The well is

located 1980 feet from the West line and 660 feet from the

South line of Section 35, T. 22 S., R. 36 E., NMPM.

(GIVE LOCATION FROM SECTION LINE) South Eunice Pool, Lea County

If State Land the Oil and Gas Lease is No.

If patented land the owner is Rodman Jones et al

Address San Angelo, Texas

We propose to drill well with drilling equipment as follows: Rotary O - T. D.

The status of plugging bond is on file

Drilling Contractor Gackle Drilling Company, Inc.

We intend to complete this well in the Queen formation at an approximate depth of 3900 feet.

CASING PROGRAM

We propose to use the following strings of Casing and to cement them as indicated:

Size of Hole	Size of Casing	Weight per Foot	New or Second Hand	Depth	Sacks Cement
12 1/4"	8 5/8"	24#	New	300'	Circ.
6 3/4"	4 1/2"	9.6#	New	T. D.	circ.

If changes in the above plans become advisable we will notify you immediately.

ADDITIONAL INFORMATION (If recompletion give full details of proposed plan of work.)

Approved....., 19.....  
Except as follows:

OIL CONSERVATION COMMISSION

By.....

Sincerely yours,

ALBERT GACKLE, OPERATOR

(Company or Operator)

By Paul L. Johnston

Position Superintendent of Production

Send Communications regarding well to

Name Albert Gackle, Operator

Address Box 2076, Hobbs, New Mexico

**NEW MEXICO OIL CONSERVATION COMMISSION**  
**WELL LOCATION AND ACREAGE DEDICATION PLAT**

FORM C-128  
 Revised 5/1/57

**SEE INSTRUCTIONS FOR COMPLETING THIS FORM ON THE REVERSE SIDE**

**SECTION A**

Operator <b>Albert Gackle</b>		Lease <b>Refman Jones</b>		Well No. <b>5</b>
Unit Letter <b>N</b>	Section <b>35</b>	Township <b>22 S</b>	Range <b>35 E</b>	County <b>1959 AUG 21 AM 10 10</b>
Actual Footage Location of Well: <b>1980</b> feet from the <b>West</b> line and <b>660</b> feet from the <b>South</b> line				
Ground Level Elev. <b>3473.6</b>	Producing Formation <b>Queen</b>	Pool <b>South Eunice</b>	Dedicated Acreage: <b>40</b> Acres	

1. Is the Operator the only owner in the dedicated acreage outlined on the plat below? YES \_\_\_\_\_ NO X . ("Owner" means the person who has the right to drill into and to produce from any pool and to appropriate the production either for himself or for himself and another. (65-3-29 (e) NMSA 1935 Comp.)
2. If the answer to question one is "no," have the interests of all the owners been consolidated by communitization agreement or otherwise? YES X NO \_\_\_\_\_. If answer is "yes," Type of Consolidation \_\_\_\_\_ **Operating Agreement**
3. If the answer to question two is "no," list all the owners and their respective interests below:

Owner	Land Description
<b>Albert Gackle, Operator</b>	<b>Patented</b>

**SECTION B**

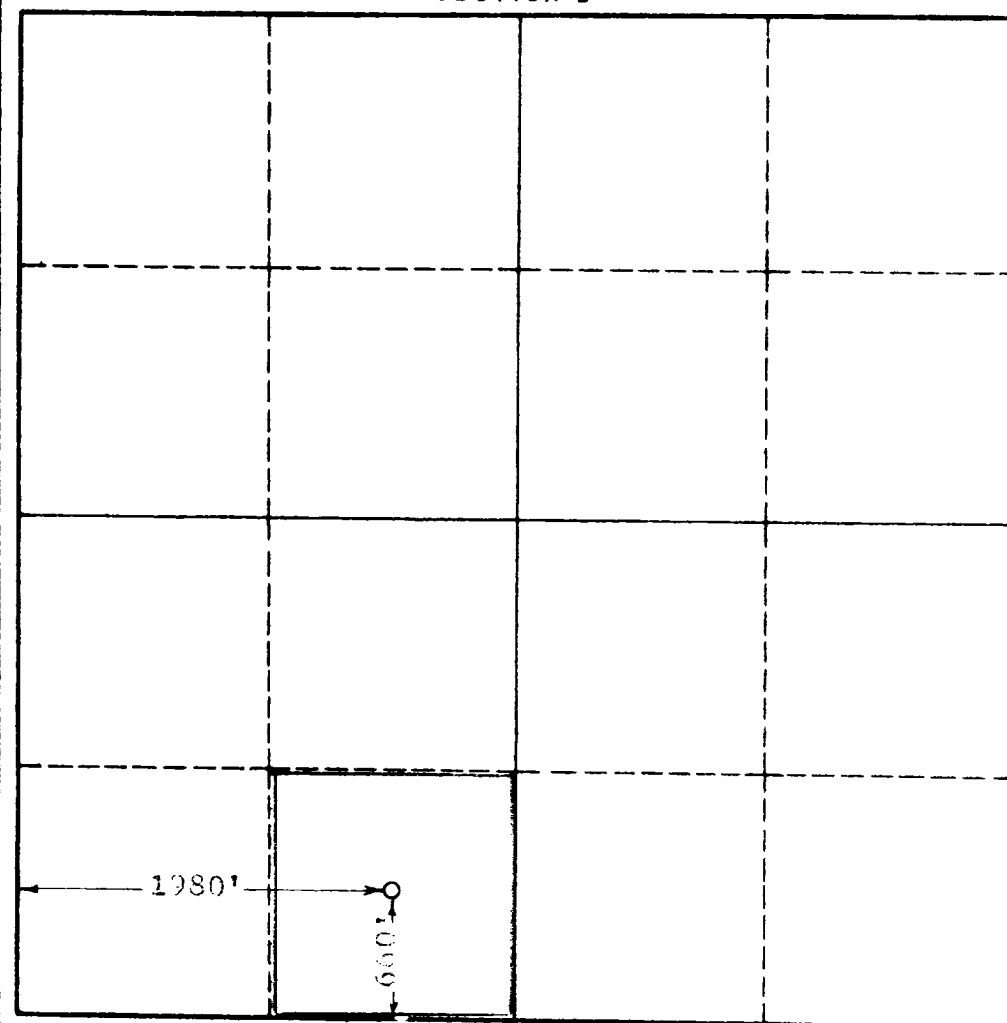

**CERTIFICATION**

I hereby certify that the information in SECTION A above is true and complete to the best of my knowledge and belief.

Name <b>Paul S. Johnston</b>
Position <b>Superintendent of Prod.</b>
Company <b>Albert Gackle, Operator</b>
Date <b>August 20, 1959</b>

I hereby certify that the well location shown on the plat in SECTION B was plotted from field notes of actual surveys made by me or under my supervision, and that the same is true and correct to the best of my knowledge and belief.

Date Surveyed <b>8-19-59</b>
Registered Professional Engineer and/or Land Surveyor, <b>JOHN W. WEST</b>
Certificate No. <b>N.M. - P.E. &amp; L.S. NO. 676</b>