

District I
PO Box 1980, Hobbs, NM 88241-1980
District II
811 South First, Artesia, NM 88210
District III
1000 Rio Brazos Rd., Aztec, NM 87410
District IV
2040 South Pacheco, Santa Fe, NM 87505

State of New Mexico
Energy, Minerals & Natural Resources Department
OIL CONSERVATION DIVISION
2040 South Pacheco
Santa Fe, NM 87505

Form C-102
Revised October 18, 1994
Instructions on back
Submit to Appropriate District Office
State Lease - 4 Copies
Fee Lease - 3 Copies

☐ AMENDED REPORT

WELL LOCATION AND ACREAGE DEDICATION PLAT

¹ API Number 30-025-09184		² Pool Code 79240		³ Pool Name Jalmat Tan Yates SRQ Gas	
⁴ Property Code 01509		⁵ Property Name McDonald WN State			⁶ Well Number 5
⁷ OGRID No. 000990		⁸ Operator Name ARCO Permian			⁹ Elevation 3464' (DF)

¹⁰ Surface Location

UL or lot no.	Section	Township	Range	Lot Idn	Feet from the	North/South line	Feet from the	East/West line	County
D	36	22S	36E		990	North	990	West	Lea

¹¹ Bottom Hole Location If Different From Surface

UL or lot no.	Section	Township	Range	Lot Idn	Feet from the	North/South line	Feet from the	East/West line	County
¹² Dedicated Acres 640		¹³ Joint or Infill		¹⁴ Consolidation Code		¹⁵ Order No.			

NO ALLOWABLE WILL BE ASSIGNED TO THIS COMPLETION UNTIL ALL INTERESTS HAVE BEEN CONSOLIDATED OR A NON-STANDARD UNIT HAS BEEN APPROVED BY THE DIVISION

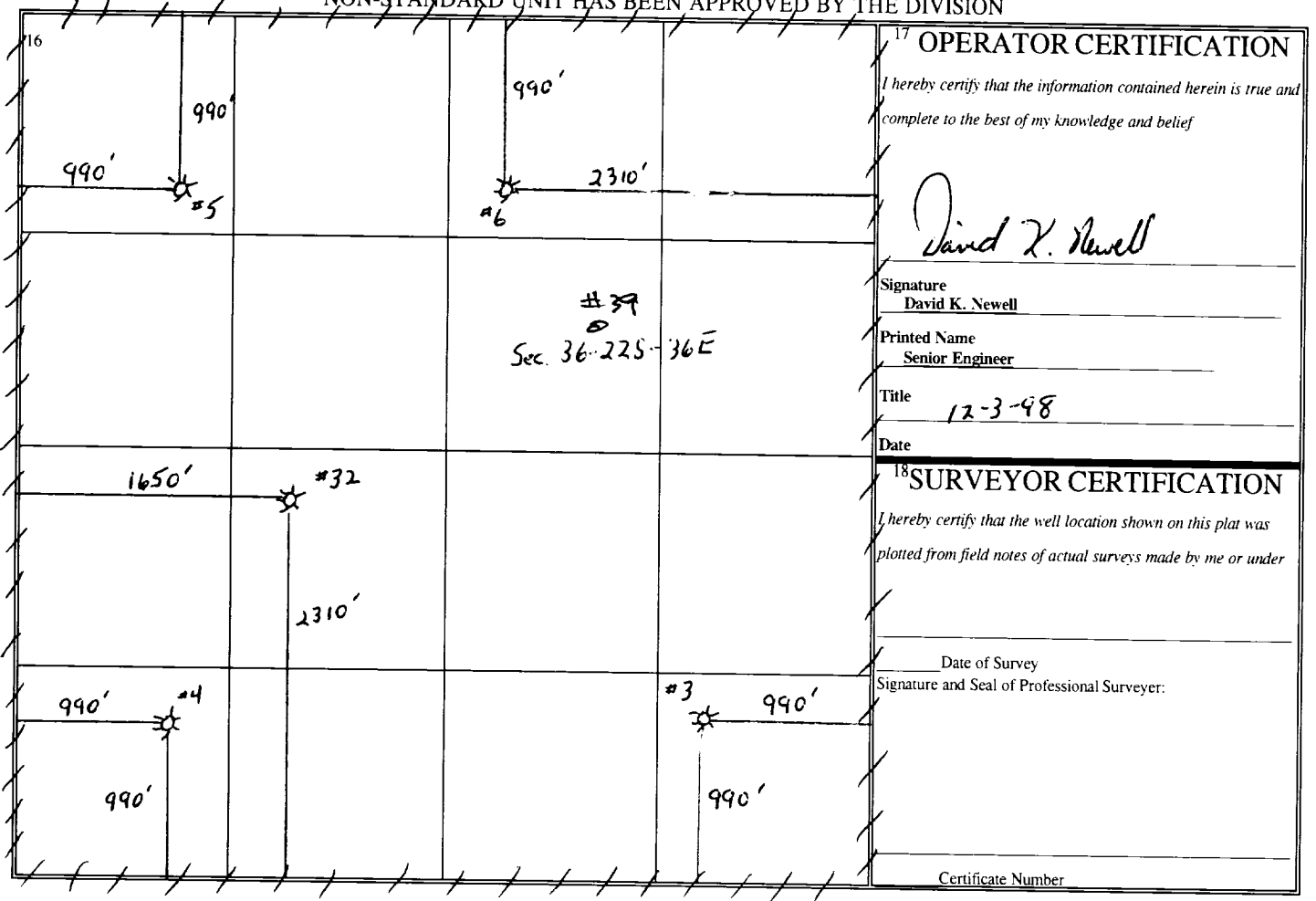

/ MEXICO OIL CONSERVATION COMMISSION N
WELL LOCATION AND ACREAGE DEDICATION PLAT AMENDED

Form C-102
Supersedes C-128
Effective 1-1-65

All distances must be from the outer boundaries of the Section.

Operator Atlantic Richfield Company			Lease McDonald State WN		Well No. 5
Unit Letter D	Section 36	Township 22-S	Range 36-E	County Lea	
Actual Footage Location of Well: 990 feet from the North line and 990 feet from the West line					
Ground Level Elev. 3452'	Producing Formation Yates		Pool Jalmat		Dedicated Acreage: 640 Acres

1. Outline the acreage dedicated to the subject well by colored pencil or hachure marks on the plat below.
2. If more than one lease is dedicated to the well, outline each and identify the ownership thereof (both as to working interest and royalty).
3. If more than one lease of different ownership is dedicated to the well, have the interests of all owners been consolidated by communitization, unitization, force-pooling, etc?

☐ Yes ☐ No If answer is "yes," type of consolidation _____

If answer is "no," list the owners and tract descriptions which have actually been consolidated. (Use reverse side of this form if necessary.) _____

No allowable will be assigned to the well until all interests have been consolidated (by communitization, unitization, forced-pooling, or otherwise) or until a non-standard unit, eliminating such interests, has been approved by the Commission.

R-36-E

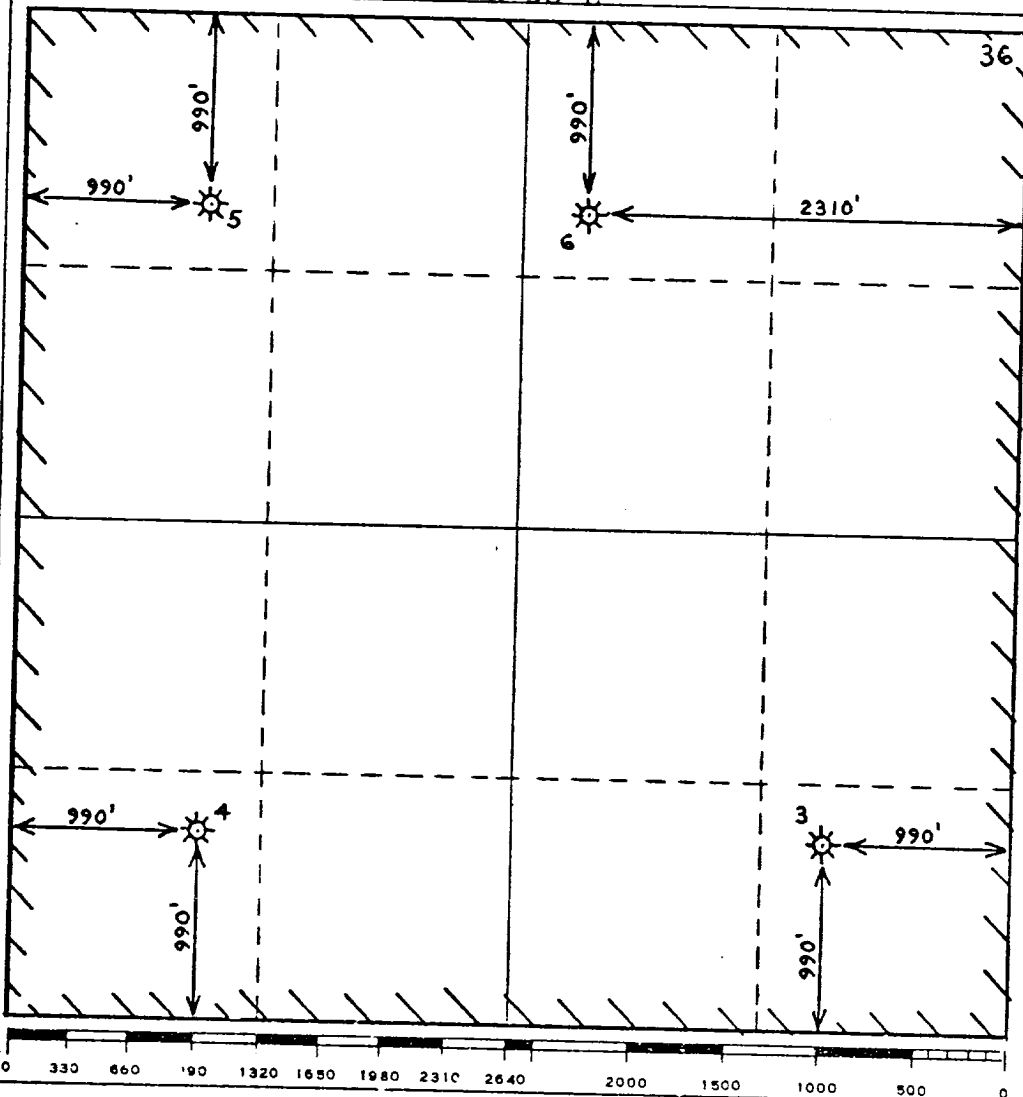

CERTIFICATION

I hereby certify that the information contained herein is true and complete to the best of my knowledge and belief.

O. D. Bretches

Name

O. D. Bretches

Position

Dist. Drlg. Supvr.

Company

Atlantic Richfield Co.

Date

February 14, 1973

I hereby certify that the well location shown on this plat was plotted from field notes of actual surveys made by me or under my supervision, and that the same is true and correct to the best of my knowledge and belief.

Date Surveyed

Registered Professional Engineer
and/or Land Surveyor

Certificate No.

NEW MEXICO
OIL CONSERVATION COMMISSION

Gas Well Plat

Date November 27, 1953
Western Natural Gas Co. McDonald-State 5
 Operator Lease Well No.
 Name of Producing Formation Yates-Lower Rivera Pool Langmat
 No. Acres Dedicated to the Well 160

SECTION 35 36 TOWNSHIP 22S RANGE 36E

☀ ⁵			

I hereby certify that the information given above is true and complete to the best of my knowledge.

Name R. H. McKay
 Position Division Superintendent
 Representing Western Natural Gas Company
 Address 223 Midland Tower, Midland, Texas

INSTRUCTIONS

1. Is this gas well a dual completion? Yes No **x**
2. If the answer to Question 1 is Yes, are there any
other dually completed wells within the dedicated
acreage? Yes No **x**

A separate plat must be filed for each gas well, outlining the area dedicated to such well and showing the location of all other wells (oil and gas) within the outlined area.

Mail in duplicate to the district office for the district in which the well is located.

