

Submit to Appropriate  
District Office  
State Lease - 4 copies  
Fee Lease - 3 copies

State of New Mexico  
Energy, Minerals and Natural Resources Department

Form C-102  
Revised 1-1-89

# OIL CONSERVATION DIVISION

P.O. Box 2088  
Santa Fe, New Mexico 87504-2088

**DISTRICT I**  
P.O. Box 1980, Hobbs, NM 88240

**DISTRICT II**  
P.O. Drawer DD, Artesia, NM 88210

**DISTRICT III**  
1000 Rio Brazos Rd., Aztec, NM 87410

## WELL LOCATION AND ACREAGE DEDICATION PLAT

All Distances must be from the outer boundaries of the section

|   |                                       |                                       |                                 |               |
|---|---------------------------------------|---------------------------------------|---------------------------------|---------------|
| Operator<br>Meridian Oil Inc.   |                                       | Lease<br>Emery King NW                |                                 | Well No.<br>1 |
| Unit Letter<br>E  | Section<br>1                          | Township<br>23-South                  | Range<br>36-East                | County<br>Lea |
| Actual Footage Location of Well:<br>1980 feet from the North line and 660 feet from the West line |                                       |                                       |                                 |               |
| Ground level Elev.<br>3410'   | Producing Formation<br>Yates-7 Rivers | Pool<br>Jalmat-Tansill-Yates-7 Rivers | Dedicated Acreage:<br>160 Acres |               |

- Outline the acreage dedicated to the subject well by colored pencil or hatchure marks on the plat below.
- If more than one lease is dedicated to the well, outline each and identify the ownership thereof (both as to working interest and royalty).
- If more than one lease of different ownership is dedicated to the well, have the interest of all owners been consolidated by communitization, unitization, force-pooling, etc.?  
☐ Yes ☐ No If answer is "yes" type of consolidation \_\_\_\_\_  
If answer is "no" list the owners and tract descriptions which have actually been consolidated. (Use reverse side of this form if necessary).  
No allowable will be assigned to the well until all interests have been consolidated (by communitization, unitization, forced-pooling, or otherwise) or until a non-standard unit, eliminating such interest, has been approved by the Division.

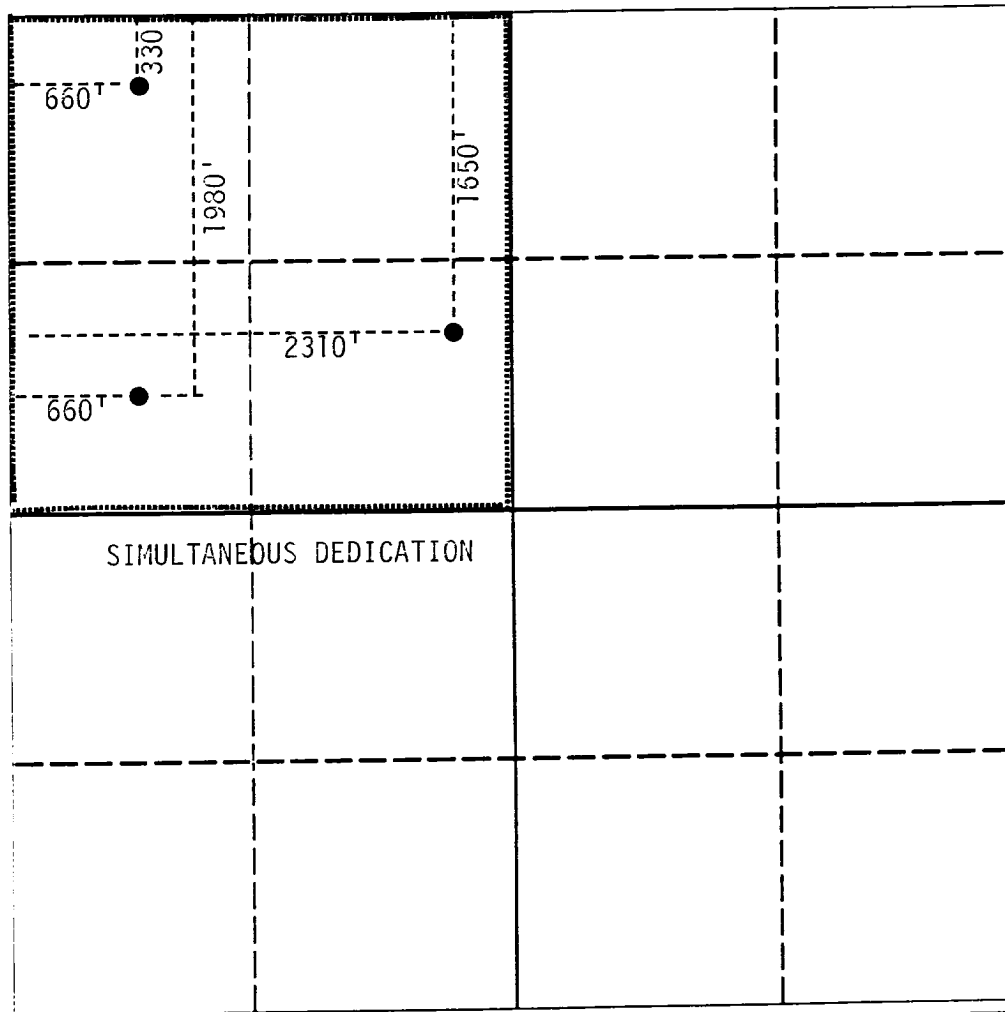

### OPERATOR CERTIFICATION

I hereby certify that the information contained herein is true and complete to the best of my knowledge and belief.

Signature

Printed Name

Maria L. Perez

Position

Production Asst.

Company

Meridian Oil Inc.

Date

8-17-91

### SURVEYOR CERTIFICATION

I hereby certify that the well location shown on this plat was plotted from field notes of actual surveys made by me or under my supervision, and that the same is true and correct to the best of my knowledge and belief.

Date Surveyed

Signature & Seal of  
Professional Surveyor

Certificate No.

0 330 660 990 1320 1650 1980 2310 2640 2000 1500 1000 500 0

Submit to Appropriate  
District Office  
State Lease - 4 copies  
Fee Lease - 3 copies

State of New Mexico  
Energy, Minerals and Natural Resources Department

Form C-102  
Revised 1-1-89

OIL CONSERVATION DIVISION

P.O. Box 2088  
Santa Fe, New Mexico 87504-2088

DISTRICT I

P.O. Box 1980, Hobbs, NM 88240

DISTRICT II

P.O. Drawer DD, Artesia, NM 88210

DISTRICT III

1000 Rio Brazos Rd., Aztec, NM 87410

WELL LOCATION AND ACREAGE DEDICATION PLAT

All Distances must be from the outer boundaries of the section

|                                  |         |                     |               |                               |                    |
|----------------------------------|---------|---------------------|---------------|-------------------------------|--------------------|
| Operator                         |         |                     | Lease         |                               | Well No.           |
| Meridian Oil Inc.                |         |                     | Emery King NW |                               | 1                  |
| Unit Letter                      | Section | Township            | Range         | County                        |                    |
| E                                | 1       | 23-South            | 36-East       | SMPM                          | Lea                |
| Actual Footage Location of Well: |         |                     |               |                               |                    |
| 1980 feet from the               |         | North               | line and      | 660 feet from the             | West line          |
| Ground level Elev.               |         | Producing Formation |               | Pool                          | Dedicated Acreage: |
| 3410'                            |         | Yates-7 Rivers      |               | Jalmat-Tansill-Yates-7 Rivers | 160 Acres          |

- Outline the acreage dedicated to the subject well by colored pencil or hatchure marks on the plat below.
- If more than one lease is dedicated to the well, outline each and identify the ownership thereof (both as to working interest and royalty).
- If more than one lease of different ownership is dedicated to the well, have the interest of all owners been consolidated by communization, unitization, force-pooling, etc.?  
☐ Yes ☐ No If answer is "yes" type of consolidation \_\_\_\_\_  
If answer is "no" list the owners and tract descriptions which have actually been consolidated. (Use reverse side of this form if necessary.)  
No allowable will be assigned to the well until all interests have been consolidated (by communization, unitization, forced-pooling, or otherwise) or until a non-standard unit, eliminating such interest, has been approved by the Division.

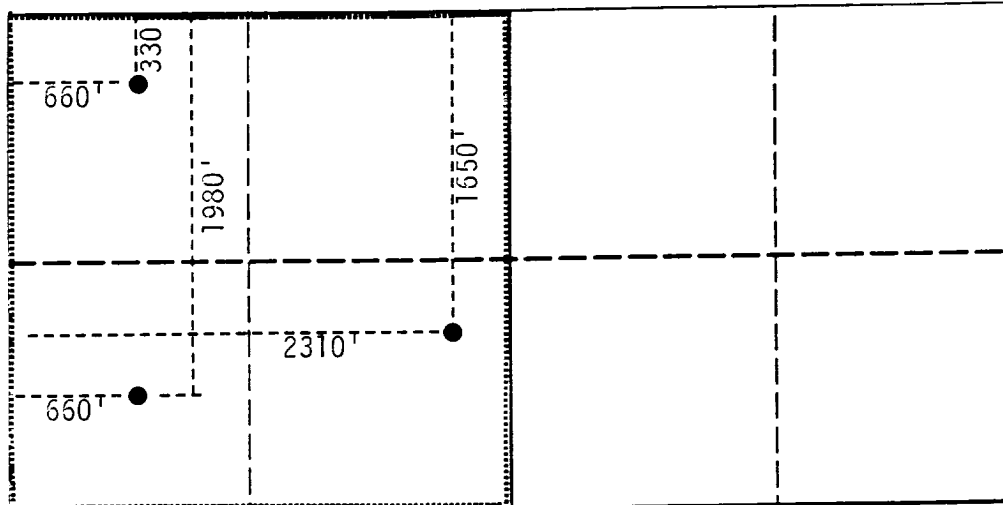

OPERATOR CERTIFICATION

I hereby certify that the information contained herein is true and complete to the best of my knowledge and belief.

|              |
|--------------|
| Signature    |
| Printed Name |
| Position     |
| Company      |
| Date         |

SURVEYOR CERTIFICATION

I hereby certify that the well location shown on this plat was plotted from field notes of actual surveys made by me or under my supervision, and that the same is true and correct to the best of my knowledge and belief.

|   |
|---|
| Date Surveyed                             |
| Signature & Seal of Professional Surveyor |
| Certificate No.                           |

0 330 660 990 1320 1650 1980 2310 2640 2000 1500 1000 500 0

# OIL CONSERVATION DIVISION

DISTRICT I  
P.O. Box 1980, Hobbs, NM 88240

P.O. Box 2088

Santa Fe, New Mexico 87504-2088

DISTRICT II  
P.O. Drawer DD, Artesia, NM 88210

DISTRICT III  
1000 Rio Brazos Rd., Aztec, NM 87410

## WELL LOCATION AND ACREAGE DEDICATION PLAT

All Distances must be from the outer boundaries of the section

|                                  |                     |                               |                    |          |                         |
|----------------------------------|---------------------|-------------------------------|--------------------|----------|-------------------------|
| Operator                         |                     | Lease                         |                    | Well No. |                         |
| Meridian Oil Inc.                |                     | Emery King NW                 |                    | 1        |                         |
| Unit Letter                      | Section             | Township                      | Range              | County   |                         |
| E                                | 1                   | 23-South                      | 36-East            | NMPM     | Lea                     |
| Actual Footage Location of Well: |                     |                               |                    |          |                         |
| 1980 feet from the               |                     | North                         | line and           | 660      | feet from the West line |
| Ground level Elev.               | Producing Formation | Pool                          | Dedicated Acreage: |          |                         |
| 3410'                            | Yates-7 Rivers      | Jalmat-Tansill-Yates-7 Rivers | 160                |          | Acres                   |

- Outline the acreage dedicated to the subject well by colored pencil or hatchure marks on the plat below.
- If more than one lease is dedicated to the well, outline each and identify the ownership thereof (both as to working interest and royalty).
- If more than one lease of different ownership is dedicated to the well, have the interest of all owners been consolidated by communitization, unitization, force-pooling, etc.?  
☐ Yes ☐ No If answer is "yes" type of consolidation \_\_\_\_\_  
If answer is "no" list the owners and tract descriptions which have actually been consolidated. (Use reverse side of this form if necessary). \_\_\_\_\_  
No allowable will be assigned to the well until all interests have been consolidated (by communitization, unitization, forced-pooling, or otherwise) or until a non-standard unit, eliminating such interest, has been approved by the Division.

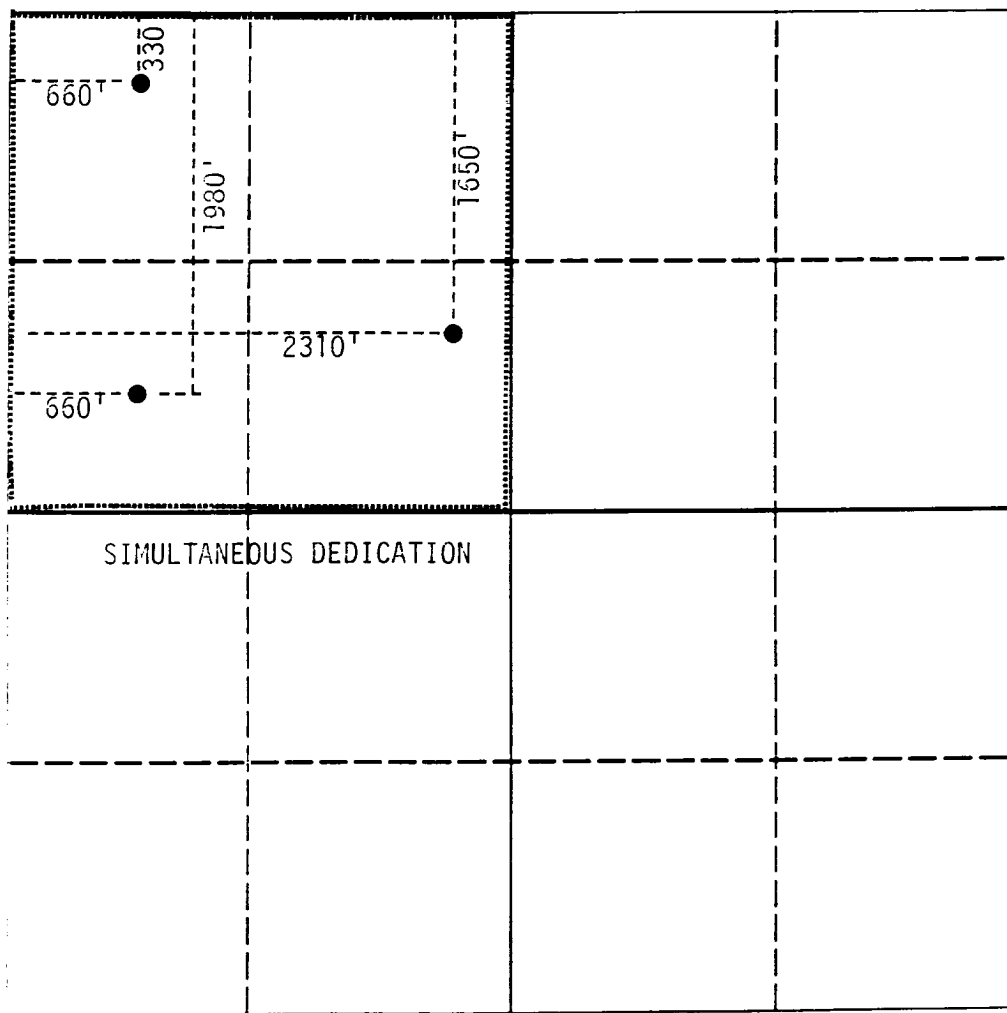

### OPERATOR CERTIFICATION

I hereby certify that the information contained herein is true and complete to the best of my knowledge and belief.

Signature  
*Maria L. Perez*  
Printed Name  
Maria L. Perez  
Position  
Production Asst.  
Company  
Meridian Oil Inc.  
Date  
3-17-91

### SURVEYOR CERTIFICATION

I hereby certify that the well location shown on this plat was plotted from field notes of actual surveys made by me or under my supervision, and that the same is true and correct to the best of my knowledge and belief.

Date Surveyed  
Signature & Seal of Professional Surveyor  
Certificate No.

Submit to Appropriate  
District Office  
State Lease - 4 copies  
Fee Lease - 3 copies

State of New Mexico  
Energy, Minerals and Natural Resources Department

Form C-102  
Revised 1-1-89

# OIL CONSERVATION DIVISION

P.O. Box 2088

Santa Fe, New Mexico 87504-2088

## DISTRICT I

P.O. Box 1980, Hobbs, NM 88240

## DISTRICT II

P.O. Drawer DD, Artesia, NM 88210

## DISTRICT III

1000 Rio Brazos Rd., Aztec, NM 87410

### WELL LOCATION AND ACREAGE DEDICATION PLAT

All Distances must be from the outer boundaries of the section

|   |              |                                       |                                       |                                 |               |
|---|--------------|---------------------------------------|---------------------------------------|---------------------------------|---------------|
| Operator<br>Meridian Oil Inc.   |              |                                       | Lease<br>Emery King NW                |                                 | Well No.<br>1 |
| Unit Letter<br>E  | Section<br>1 | Township<br>23-South                  | Range<br>36-East                      | County<br>NMPM                  | Lea           |
| Actual Footage Location of Well:<br>1980 feet from the North line and 660 feet from the West line |              |                                       |                                       |                                 |               |
| Ground level Elev.<br>3410'   |              | Producing Formation<br>Yates-7 Rivers | Pool<br>Jalmat-Tansill-Yates-7 Rivers | Dedicated Acreage:<br>160 Acres |               |

- Outline the acreage dedicated to the subject well by colored pencil or hatchure marks on the plat below.
- If more than one lease is dedicated to the well, outline each and identify the ownership thereof (both as to working interest and royalty).
- If more than one lease of different ownership is dedicated to the well, have the interest of all owners been consolidated by communitization, unitization, force-pooling, etc.?  
☐ Yes ☐ No If answer is "yes" type of consolidation \_\_\_\_\_  
If answer is "no" list the owners and tract descriptions which have actually been consolidated. (Use reverse side of this form if necessary.)  
No allowable will be assigned to the well until all interests have been consolidated (by communitization, unitization, forced-pooling, or otherwise) or until a non-standard unit, eliminating such interest, has been approved by the Division.

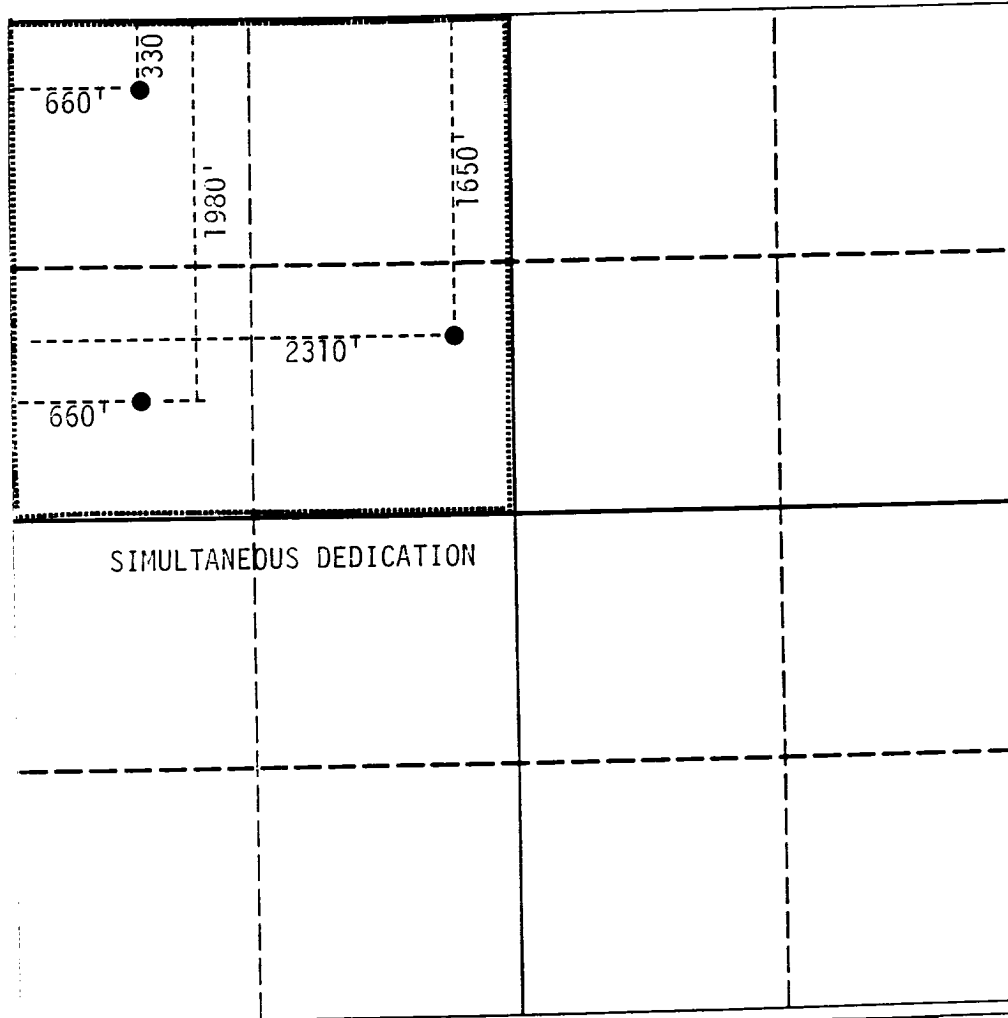

### OPERATOR CERTIFICATION

I hereby certify that the information contained herein is true and complete to the best of my knowledge and belief.

|                                    |
|------------------------------------|
| Signature<br><i>Maria L. Perez</i> |
| Printed Name<br>Maria L. Perez     |
| Position<br>Production Asst.       |
| Company<br>Meridian Oil Inc.       |
| Date<br>8-17-91                    |

### SURVEYOR CERTIFICATION

I hereby certify that the well location shown on this plat was plotted from field notes of actual surveys made by me or under my supervision, and that the same is true and correct to the best of my knowledge and belief.

|   |
|---|
| Date Surveyed                             |
| Signature & Seal of Professional Surveyor |
| Certificate No.                           |

0 330 660 990 1320 1650 1980 2310 2640 2000 1500 1000 500 0