

NEW MICO OIL CONSERVATION COMMISSION
Santa Fe, New Mexico

NOTICE OF INTENTION TO DRILL OR RECOMPLETECC

Notice must be given to the District Office of the Oil Conservation Commission and approval obtained before drilling or recompletion begins. If changes in the proposed plan are considered advisable, a copy of this notice showing such changes will be returned to the sender. Submit this notice in QUINTUPLICATE. One copy will be returned following approval. See 1959 OIL CONSERVATION INSTRUCTIONS in Rules and Regulations of the Commission. If State Land submit 6 Copies

Hobbs, New Mexico

(Place)

January 21, 1959

(Date)

OIL CONSERVATION COMMISSION
SANTA FE, NEW MEXICO

Gentlemen:

You are hereby notified that it is our intention to commence the (Drilling) (~~Recompletion~~) of a well to be known as

Skelly Oil Company

(Company or Operator)

King "C"

(Lease)

Well No. 4, in H The well is

(Unit)

located 2114.5 feet from the North line and 660 feet from the

East

Line of Section 1, T. 23 S, R. 36 E, NMPM.

(GIVE LOCATION FROM SECTION LINE) Langlie-Mattix Pool, Lea County

If State Land the Oil and Gas Lease is No.

If patented land the owner is Bertha L. King

Address Eunice, New Mexico

We propose to drill well with drilling equipment as follows: Rotary tools from surface to total depth.

The status of plugging bond is Blanket Bond #1253648 for \$10,000.00 with Federal Insurance Company

Drilling Contractor Moran Oil Prod. & Drilling Corp.

Hobbs, New Mexico

We intend to complete this well in the Queen formation at an approximate depth of 3750' feet.

CASING PROGRAM

We propose to use the following strings of Casing and to cement them as indicated:

Size of Hole	Size of Casing	Weight per Foot	New or Second Hand	Depth	Sacks Cement
11"	8-5/8"OD	32#	New	375'	230
7-7/8"	5-1/2"OD	16#	New	3750'	250

If changes in the above plans become advisable we will notify you immediately.

ADDITIONAL INFORMATION (If recompletion give full details of proposed plan of work.)

The Halliburton Pump & Plug Process will be used in cementing both strings of casing and cement will be circulated to surface behind the 8-5/8"OD Casing.

Approved....., 19.....
Except as follows:

Sincerely yours,

Skelly Oil Company

(Company or Operator)

By

Position

District Superintendent

Send Communications regarding well to

Name

Skelly Oil Company

Address

Box 38 - Hobbs, New Mexico

OIL CONSERVATION COMMISSION

By

NEW MEXICO OIL CONSERVATION COMMISSION
WELL LOCATION AND ACREAGE DEDICATION PLAT

FORM C-128
Revised 5-1-57

SEE INSTRUCTIONS FOR COMPLETING THIS FORM ON THE REVERSE SIDE

SECTION A					HOBBBS OFFICE 000	
Operator SKELLY OIL CO.			Lease KING "C"		Well No.	
Unit Letter H	Section I	Township 23 SOUTH	Range 36 EAST	County LEA	1959 JAN 21 PM 2:38	
Actual Footage Location of Well: 2114.5 feet from the NORTH line and 660 feet from the EAST line						
Ground Level Elev.		Producing Formation QUEEN		Pool LANGLIE-MATTIX		Dedicated Acreage: 40 Acres

1. Is the Operator the only owner in the dedicated acreage outlined on the plat below? YES ☒ NO ☐ ("Owner" means the person who has the right to drill into and to produce from any pool and to appropriate the production either for himself or for himself and another. (65-3-29 (v) NMSA 1935 Comp.)
2. If the answer to question one is "no," have the interests of all the owners been consolidated by communitization agreement or otherwise? YES ☐ NO ☐ If answer is "yes," Type of Consolidation _____
3. If the answer to question two is "no," list all the owners and their respective interests below:

Owner	Land Description

SECTION B

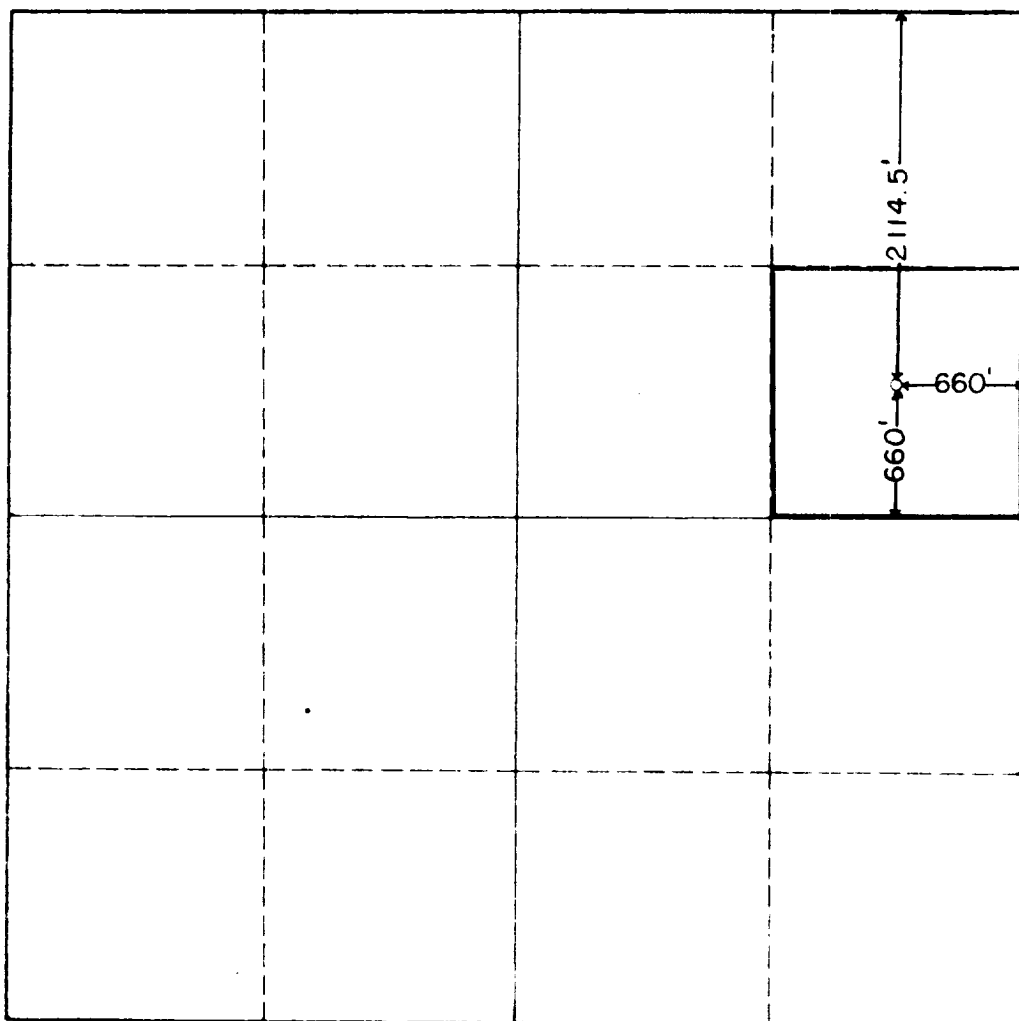

CERTIFICATION

I hereby certify that the information in SECTION A above is true and complete to the best of my knowledge and belief.

Name *J. N. [Signature]*

Position
District Superintendent
Company
Skelly Oil Company

Date
January 21, 1959

I hereby certify that the well location shown on the plat in SECTION B was plotted from field notes of actual surveys made by me or under my supervision, and that the same is true and correct to the best of my knowledge and belief.

Date Surveyed
JAN. 20, 1959
Registered Professional Engineer
and/or Land Surveyor, **JOHN W. WEST**
John W. West
Certificate No.
N.M. - P.E. & L.S. NO. 676

0 330 660 990 1320 1650 1980 2310 2640 2000 1500 1000 500 0