

NEW MEXICO OIL CONSERVATION COMMISSION
Santa Fe, New Mexico

Form C-101
Revised (12/1/55)

NOTICE OF INTENTION TO DRILL

Notice must be given to the District Office of the Oil Conservation Commission and approval obtained before drilling or recompletion begins. If changes in the proposed plan are considered advisable, a copy of this notice showing such changes will be returned to the sender. Submit this notice in QUINTUPLICATE. One copy will be returned following approval. See additional instructions in Rules and Regulations of the Commission.

If State Land submit 6 Copies Attach Form C- 128 in triplicate to first 3 copies of form C-101

Hobbs, New Mexico

December 30, 1959

(Place)

(Date)

OIL CONSERVATION COMMISSION
SANTA FE, NEW MEXICO

Gentlemen:

You are hereby notified that it is our intention to commence the Drilling of a well to be known as

Tidewater Oil Company

(Company or Operator)

E. F. King

(Lease)

Well No. 5

N

(Unit)

The well is

located 660

feet from the

South

line and 1980

feet from the

West

line of Section 1

T. 23S

R. 36E

, NMPM.

(GIVE LOCATION FROM SECTION LINE)

Langlie Mattix Pool,

Lea

County

If State Land the Oil and Gas Lease is No.

If patented land the owner is Emery F. King

Address Eunice, New Mexico

We propose to drill well with drilling equipment as follows: Rotary.

The status of plugging bond is Blanket Bond dated Nov. 30, 1937 with
Saint Paul Indemnity.

Drilling Contractor Contract not let.

We intend to complete this well in the Queen

formation at an approximate depth of 3800' feet.

CASING PROGRAM

We propose to use the following strings of Casing and to cement them as indicated:

Size of Hole	Size of Casing	Weight per Foot	New or Second Hand	Depth	Sacks Cement
12-1/4"	8-5/8"	22.7#	New	350	300 sks. Reg. w/ 1/4# flocele/sk.
7-7/8"	5-1/2"	15.5#	New	3800	600 sk. Reg. w/ 4% gel, 1/4# flocele per sk.

If changes in the above plans become advisable we will notify you immediately.

ADDITIONAL INFORMATION (If recompletion give full details of proposed plan of work.)

Approved....., 19.....
Except as follows:

OIL CONSERVATION COMMISSION

By.....

Sincerely yours,

Tidewater Oil Company

(Company or Operator)

By.....

Position Area Superintendent

Send Communications regarding well to

Name H. P. Shackelford

Address Box 547 Hobbs, New Mexico

NEW MEXICO OIL CONSERVATION COMMISSION
WELL LOCATION AND ACREAGE DEDICATION PLAT

FORM CU-128
Revised 5-1-57

SEE INSTRUCTIONS FOR COMPLETING THIS FORM ON THE REVERSE SIDE

SECTION A

Operator Tidewater Oil Co.		Lease E.F. King		Well No. 5
Unit Letter N	Section 1	Township 23 South	Range 36 East	County Lea County
Actual Footage Location of Well: 660 feet from the South line and 1980 feet from the West line				
Ground Level Elev. Queen	Producing Formation Langlie Mattix		Dedicated Acreage: 40 Acres	

1. Is the Operator the only owner in the dedicated acreage outlined on the plat below? YES _____ NO **X** "Owner" means the person who has the right to drill into and to produce from any pool and to appropriate the production either for himself or for himself and another. (65-3-29 (e) NMSA 1935 (Comp.))
2. If the answer to question one is "no," have the interests of all the owners been consolidated by communization agreement or otherwise? YES **X** NO ____ If answer is "yes," Type of Consolidation **Operating Agreement**
3. If the answer to question two is "no," list all the owners and their respective interests below:

Owner	Land Description

SECTION B

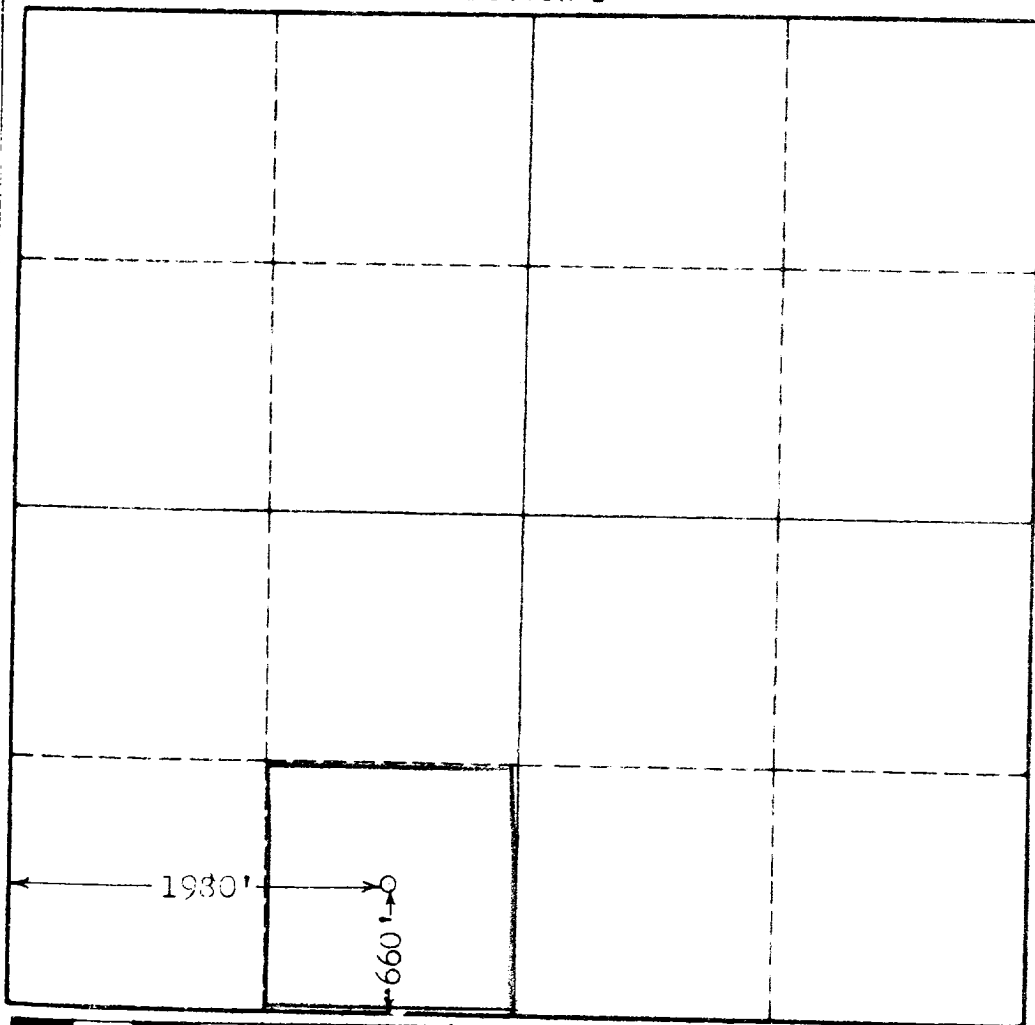

CERTIFICATION

I hereby certify that the information in SECTION A above is true and complete to the best of my knowledge and belief.

Name <i>[Signature]</i>
Position Area Supt.
Company Tidewater Oil Company
Date 12-30-59

I hereby certify that the well location shown on the plat in SECTION B was plotted from field notes of actual surveys made by me or under my supervision, and that the same is true and correct to the best of my knowledge and belief.

Date Surveyed 12-30-59
Registered Professional Engineer and/or Land Surveyor, JOHN W. WEST
<i>[Signature]</i>
Certificate No. N.M. - P.E. & L.S. NO. 676