

# DUPLICATE

Form C-128  
Revised 5/1/57

## NEW MEXICO OIL CONSERVATION COMMISSION

### Well Location and Acreage Dedication Plat

#### Section A.

Date 12-2-58  
Operator Gulf Oil Corp. Lease J. F. Janda NCT-J 09  
Well No. 3 Unit Letter O Section 4 Township 23 S Range 36 E NMFM  
Located 660 Feet From South Line, 1750 Feet From East Line  
County Lea G. L. Elevation 3499.99 Dedicated Acreage 40 Acres  
Name of Producing Formation Permian Pool Langella Matrix

1. Is the Operator the only owner\* in the dedicated acreage outlined in the plat below?  
Yes X No       .
2. If the answer to question one is "no," have the interests of all the owners been consolidated by communitization agreement or otherwise? Yes        No       . If answer is "yes," Type of Consolidation
3. If the answer to question two is "no," list all the owners and their respective interests below:

Owner

Land Description

#### Section B

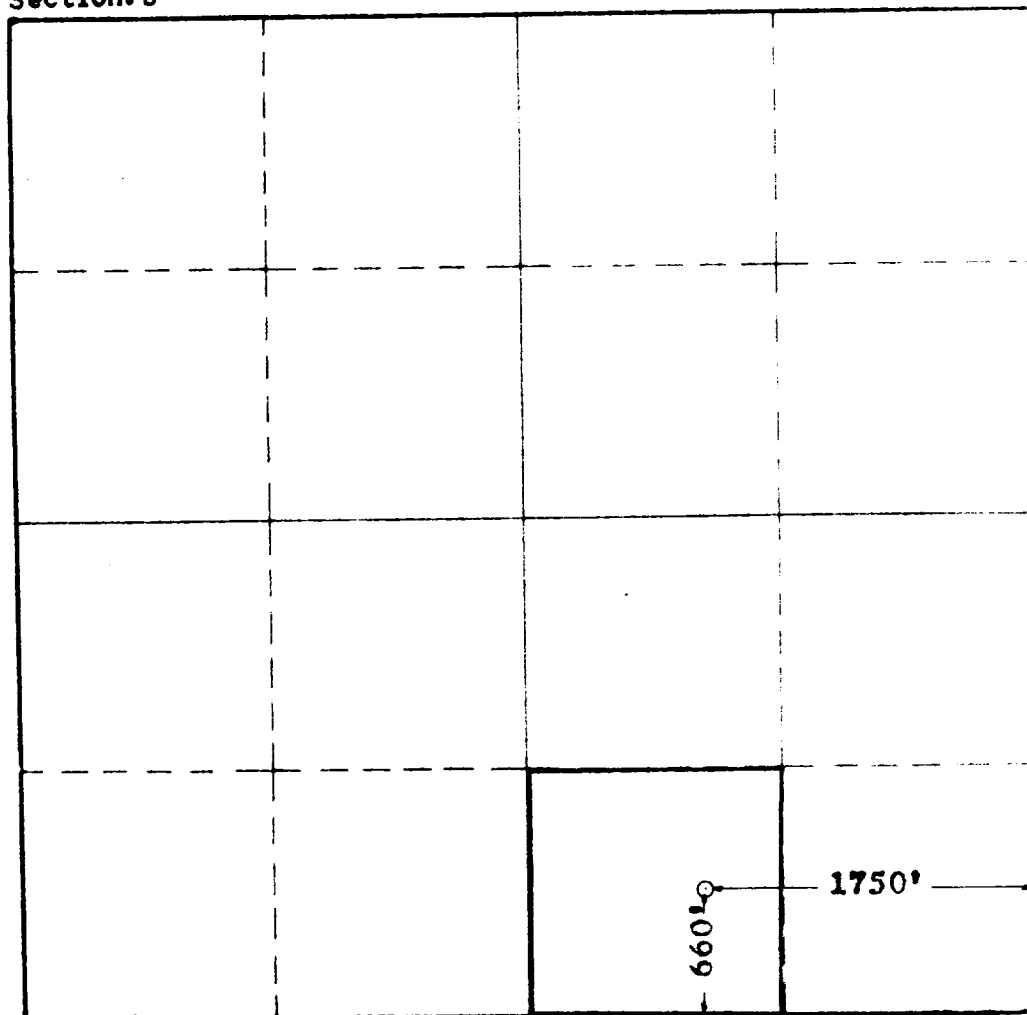

This is to certify that the information in Section A above is true and complete to the best of my knowledge and belief.

Gulf Oil Corporation  
(Operator)

J. H. Russell  
(Representative)

Box 2167, Hobbs, N. M.  
Address

This is to certify that the well location shown on the plat in Section B was plotted from field notes of actual surveys made by me or under my supervision and that the same is true and correct to the best of my knowledge and belief.

Date Surveyed 12-2-58

John W. West  
Registered Professional  
Engineer and/or Land Surveyor.

Certificate No. 676