

NEW MEXICO
OIL CONSERVATION COMMISSION

Form C-128

Well Location and/or Gas Proration Plat

Date 4-16-1957

Operator T. F. Hodge

Lease 15 Minnie L. Christmas "D"

Well No. 1 Section 6 Township 23 South Range 36 East NMPM

Located 660 Feet From North Line, 1890.2 Feet From West Line,

Lea County, New Mexico. G. L. Elevation 3494.4

Name of Producing Formation _____ Pool _____ Dedicated Acreage _____

(Note: All distances must be from outer boundaries of Section)

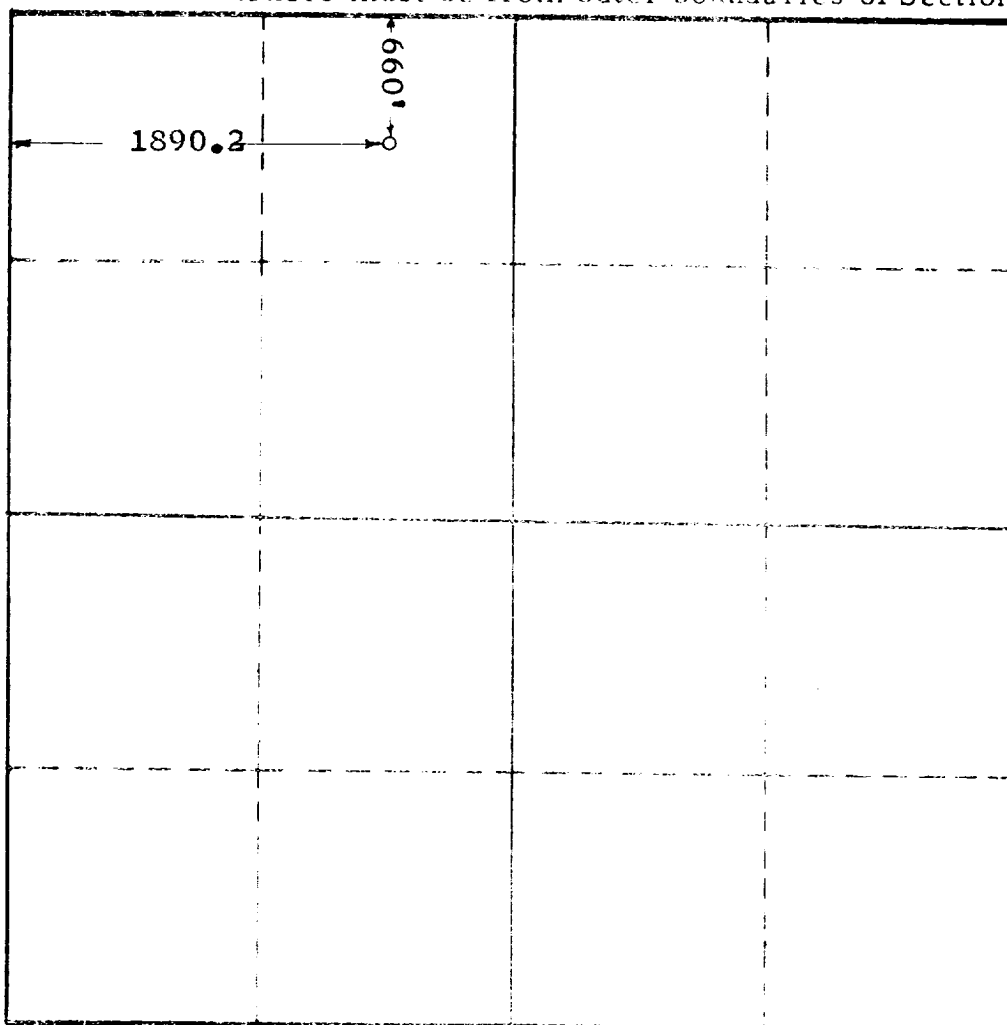

SCALE: 1"=1000'

1. Is this Well a Dual Comp.? Yes No
2. If the answer to Question 1 is yes, are there any other dually completed wells within the dedicated acreage? Yes No

This is to certify that the above plat was prepared from field notes of actual surveys made by me or under my supervision and that the same are true and correct to the best of my knowledge and belief.

Name _____
Position _____
Representing _____
Address _____

Date Surveyed 4-11-1957
John W. West
Registered Professional Engineer and/or
Land Surveyor