



STATE OF NEW MEXICO
ENERGY AND MINERALS DEPARTMENT
OIL CONSERVATION DIVISION
HOBBS DISTRICT OFFICE

GARREY CARRUTHERS
GOVERNOR

8-10-90

POST OFFICE BOX 1980
HOBBS, NEW MEXICO 89241-1980
(505) 393-6161

OIL CONSERVATION DIVISION
P. O. BOX 2088
SANTA FE, NEW MEXICO 87501

RE: Proposed:

MC _____
DHC _____
NSL X _____
NSP _____
SWD _____
WFX _____
PMX _____

Gentlemen:

I have examined the application for the:

Hal J. Rasmussen Oper. Inc. State A A/c-1 #85-7 11-23-36
Operator Lease & Well No. Unit S-T-R

and my recommendations are as follows:

OK

Yours very truly,

Jerry Sexton
Jerry Sexton
Supervisor, District 1

/ed

HAL J. RASMUSSEN OPERATING, INC.

SIX DESTA DRIVE, SUITE 5850

MIDLAND, TEXAS 79705

(915) 687-1664

July 25, 1990

~~Mr. William J. LeMay, Director
New Mexico Oil Conservation Division
P. O. Box 2088
Sante Fe, New Mexico 87501~~

RE: Administrative Approval of an Unorthodox Well Location
State "A" a/c 1 # 85
Jalmat Gas Pool
Lea County, New Mexico

Dear Mr. LeMay,

Hal J. Rasmussen Operating Inc. respectfully requests administrative approval to recomplete the State A a/c 1 # 85 at an unorthodox well location, located 2310 ft FNL and 2310 ft FWL of Section 11, T23S R36E, Lea County, New Mexico. The State "A" a/c 1 # 85 is currently TA'd in the Langlie Mattix Pool.

The offset operators have been notified of this application by certified mail. Copies of the return receipts will be forwarded when received. Attached is a plat showing the location of the State "A" a/c 1 # 85, and the proration unit the well will be included in. A list of offset operators has also been attached.

If you need any further information regarding this request, please call me at (915) 687-1664.

Thank-you for your consideration.

Sincerely,

Jay Cherski
nh

Jay Cherski

CC: New Mexico Oil Conservation Division District 1 Office
P.O. Box 1980
Hobbs, New Mexico 88240

Submit to Appropriate
District Office
State Lease - 4 copies
Fee Lease - 3 copies

State of New Mexico
Energy, Minerals and Natural Resources Department

Form C-102
Revised 1-1-89

OIL CONSERVATION DIVISION

P.O. Box 2088

Santa Fe, New Mexico 87504-2088

DISTRICT I

P.O. Box 1980, Hobbs, NM 88240

DISTRICT II

P.O. Drawer DD, Artesia, NM 88210

DISTRICT III

1000 Rio Brazos Rd., Aztec, NM 87410

WELL LOCATION AND ACREAGE DEDICATION PLAT

All Distances must be from the outer boundaries of the section

Operator Hal J. Rasmussen Operating, Inc.			Lease STATE "A" ALC 1		Well No. 85
Unit Letter F	Section 11	Township 23S	Range 36E	County Lea	
Actual Footage Location of Well: 2310 feet from the NORTH line and 2310 feet from the WEST line					
Ground level Elev.	Producing Formation YATES	Pool Jalmat-TNSL-YTS-7R			Dedicated Acreage: 480 Acres

- Outline the acreage dedicated to the subject well by colored pencil or hatchure marks on the plat below.
- If more than one lease is dedicated to the well, outline each and identify the ownership thereof (both as to working interest and royalty).
- If more than one lease of different ownership is dedicated to the well, have the interest of all owners been consolidated by communitization, unitization, force-pooling, etc.?
☐ Yes ☐ No If answer is "yes" type of consolidation _____
If answer is "no" list the owners and tract descriptions which have actually been consolidated. (Use reverse side of this form if necessary).
No allowable will be assigned to the well until all interests have been consolidated (by communitization, unitization, forced-pooling, or otherwise) or until a non-standard unit, eliminating such interest, has been approved by the Division.

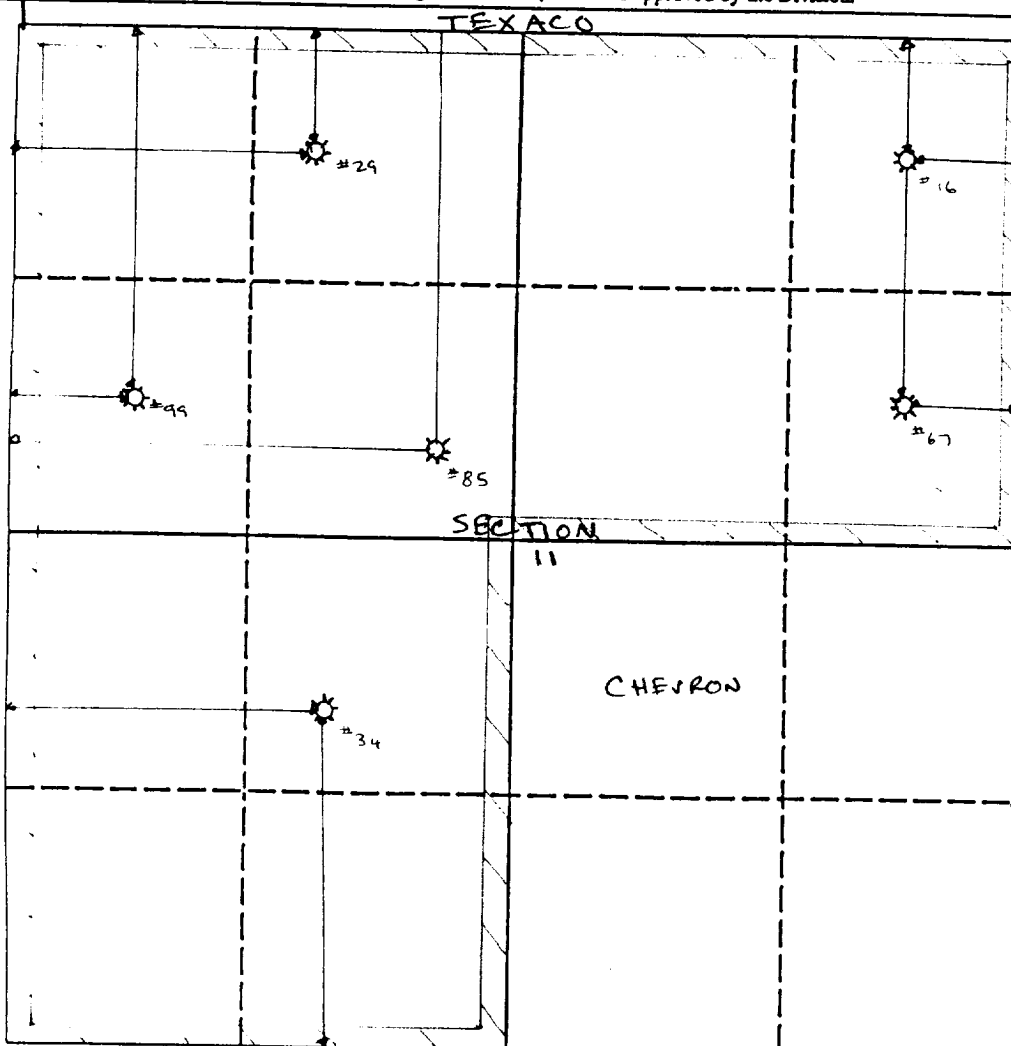

OPERATOR CERTIFICATION
I hereby certify that the information contained herein is true and complete to the best of my knowledge and belief.

Signature
Printed Name
Jay D. Cherski
Position
Agent
Company
Hal J. Rasmussen Operating, Inc.
Date
7/26/90

SURVEYOR CERTIFICATION
I hereby certify that the well location shown on this plat was plotted from field notes of actual surveys made by me or under my supervision, and that the same is true and correct to the best of my knowledge and belief.

Date Surveyed
Signature & Seal of Professional Surveyor
Certificate No.

State "A" a/c 1 well # 85
Offset Operators

Chevron
Mr. Al Bohling
P.O. Box 670
Hobbs, New Mexico 88240

Tahoe Energy
Mr. K. A. Freeman
4402 W. Industrial
Midland , Texas 79703

Conoco, Inc.
Mr. Hugh Ingram
P.O. Box 460
Hobbs, New Mexico 88240

Texaco Producing, Inc.
Mr. James Head
P.O. Box 728
Hobbs, New Mexico 88240