

NEW MEXICO OIL CONSERVATION COMMISSION
WELL LOCATION AND ACREAGE DEDICATION PLAT
Plug Back

Form O-112
Supersedes O-128
Effective 1-1-65

All distances must be from the outer boundaries of the Section

Operator Grace Petroleum Corporation			Lease New Mexico State "AA"		Well No. 4
Unit Letter B	Section 22	Township 23-S	Range 36-E	County Lea	
Actual Well Location of Well:					
660		North		1855	
feet from the		line and		feet from the East line	
Ground Level Elev. 3383	Producing Formation Seven Rivers		Pool Langlie-Mattix to Jalmat		Delivered Acreage 160

1. Outline the acreage dedicated to the subject well by colored pencil or hachure marks on the plat below **No. 1 & No. 4**
2. If more than one lease is dedicated to the well, outline each and identify the ownership thereof (both as to working interest and royalty).
3. If more than one lease of different ownership is dedicated to the well, have the interests of all owners been consolidated by communitization, unitization, force-pooling, etc?

☐ Yes ☐ No If answer is "yes," type of consolidation _____

If answer is "no," list the owners and tract descriptions which have actually been consolidated. (Use reverse side of this form if necessary.) _____

No allowable will be assigned to the well until all interests have been consolidated (by communitization, unitization, forced-pooling, or otherwise) or until a non-standard unit, eliminating such interests, has been approved by the Commission.

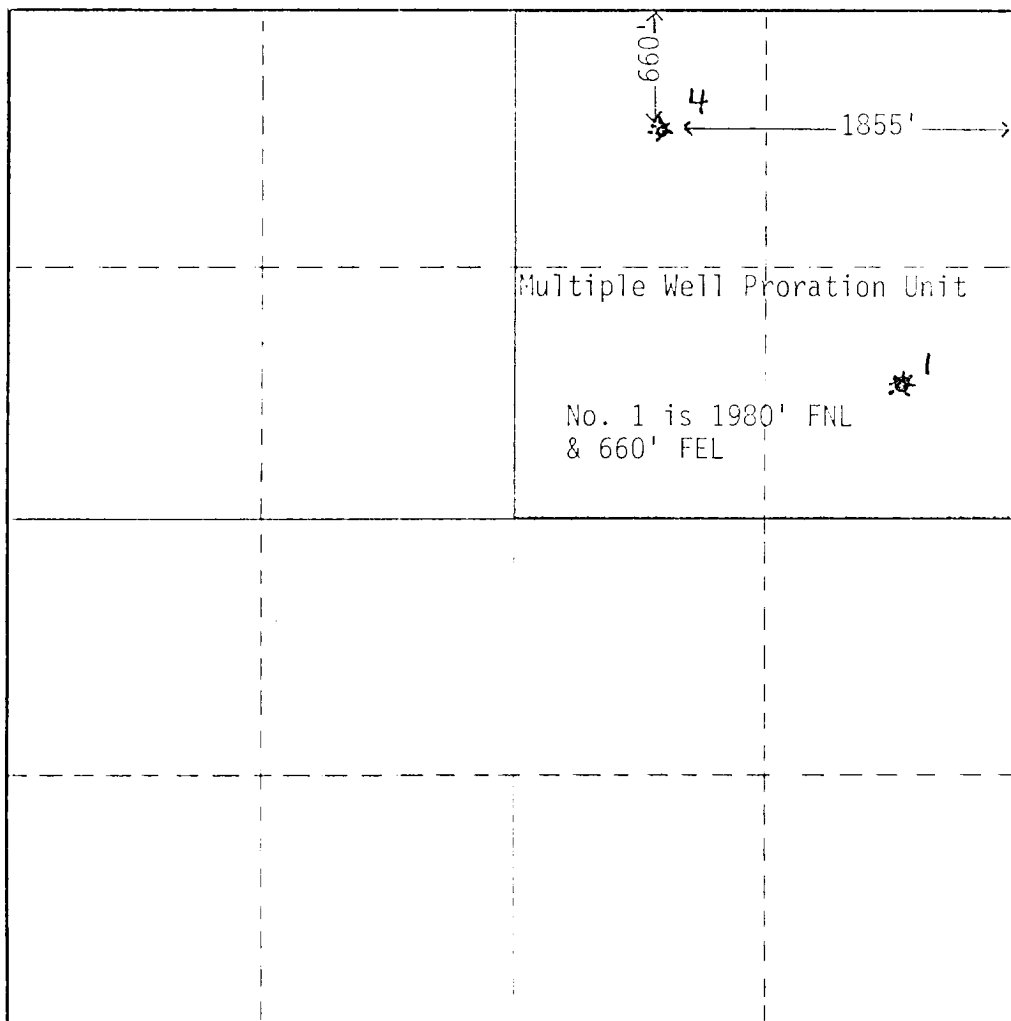

CERTIFICATION

I hereby certify that the information contained herein is true and complete to the best of my knowledge and belief.

Douglas W. Rice
Name

Douglas W. Rice
Position

Asst. Dist. Prod. Manager
Company

Grace Petroleum Corp.
Date

9-2-80

I hereby certify that the well location shown on this plat was plotted from field notes of actual surveys made by me or under my supervision, and that the same is true and correct to the best of my knowledge and belief.

Date Surveyed

Registered Professional Engineer
and/or Licensed Surveyor

Certification No.