

NEW MEXICO OIL CONSERVATION COMMISSION
WELL LOCATION AND ACREAGE DEDICATION PLAT

Form C-102
Supersedes C-128
Effective 1-1-65

All distances must be from the outer boundaries of the Section.

Operator Texas Pacific Oil Company			Lease State "A" A/C-1 1167		Well No. 94 & 97
94 Let Cr 97 - F	Section 22	Township 23-S	Range 36-E	County Lea	
Actual Foot Location of Well: 97 - 1980		feet from the N		line and 1980	
Ground Level Elev. 94 - 3382 97 - 3384		Producing Formation Yates		Pool Jalmat Gas	Dedicated Acreage: 4.00 Acres

- Outline the acreage dedicated to the subject well by colored pencil or hachure marks on the plat below.
- If more than one lease is dedicated to the well, outline each and identify the ownership thereof (both as to working interest and royalty).
- If more than one lease of different ownership is dedicated to the well, have the interests of all owners been consolidated by communitization, unitization, force-pooling, etc?

☐ Yes ☐ No If answer is "yes," type of consolidation _____

If answer is "no," list the owners and tract descriptions which have actually been consolidated. (Use reverse side of this form if necessary.) _____

No allowable will be assigned to the well until all interests have been consolidated (by communitization, unitization, forced-pooling, or otherwise) or until a non-standard unit, eliminating such interests, has been approved by the Commission.

Approved March 30, 1967

R-3209

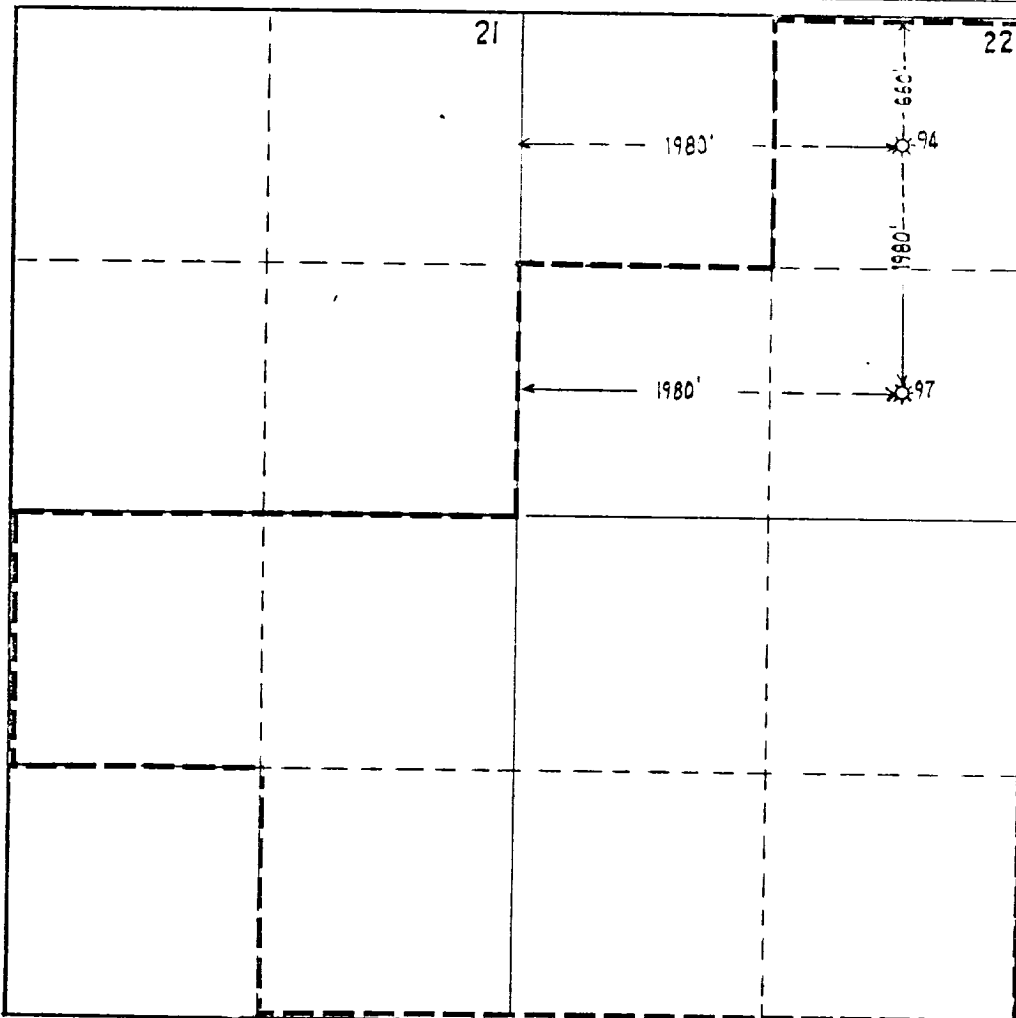

CERTIFICATION

I hereby certify that the information contained herein is true and complete to the best of my knowledge and belief.

[Signature]

Name _____
Dist. Adm. Supv.
Position _____
Texas Pacific Oil Company
Company
May 5, 1967
Date

I hereby certify that the well location shown on this plat was plotted from field notes of actual surveys made by me or under my supervision, and that the same is true and correct to the best of my knowledge and belief.

Date Surveyed _____
Registered Professional Engineer
and/or Land Surveyor

Certificate No. _____

