

NEW MEXICO OIL CONSERVATION COMMISSION
Well Location and Acreage Dedication Plat

Section A.

Date January 30, 1961

Operator Albert Gackle, Operator Lease Sinclair State "A"
Well No. 2 Unit Letter K Section 23 Township 23 S Range 36 E NMPM
Located 1650 Feet From South Line, 2310 Feet From West Line
County Lea G. L. Elevation _____ Dedicated Acreage 40 Acres
Name of Producing Formation Queen Pool Langlife-Mattix

1. Is the Operator the only owner* in the dedicated acreage outlined on the plat below?
Yes X No _____.
2. If the answer to question one is "no," have the interests of all the owners been consolidated by communitization agreement or otherwise? Yes _____ No _____. If answer is "yes," Type of Consolidation _____
3. If the answer to question two is "no," list all the owners and their respective interests below:

Owner

Land Description

*This is an old well drilled deeper.

Section B

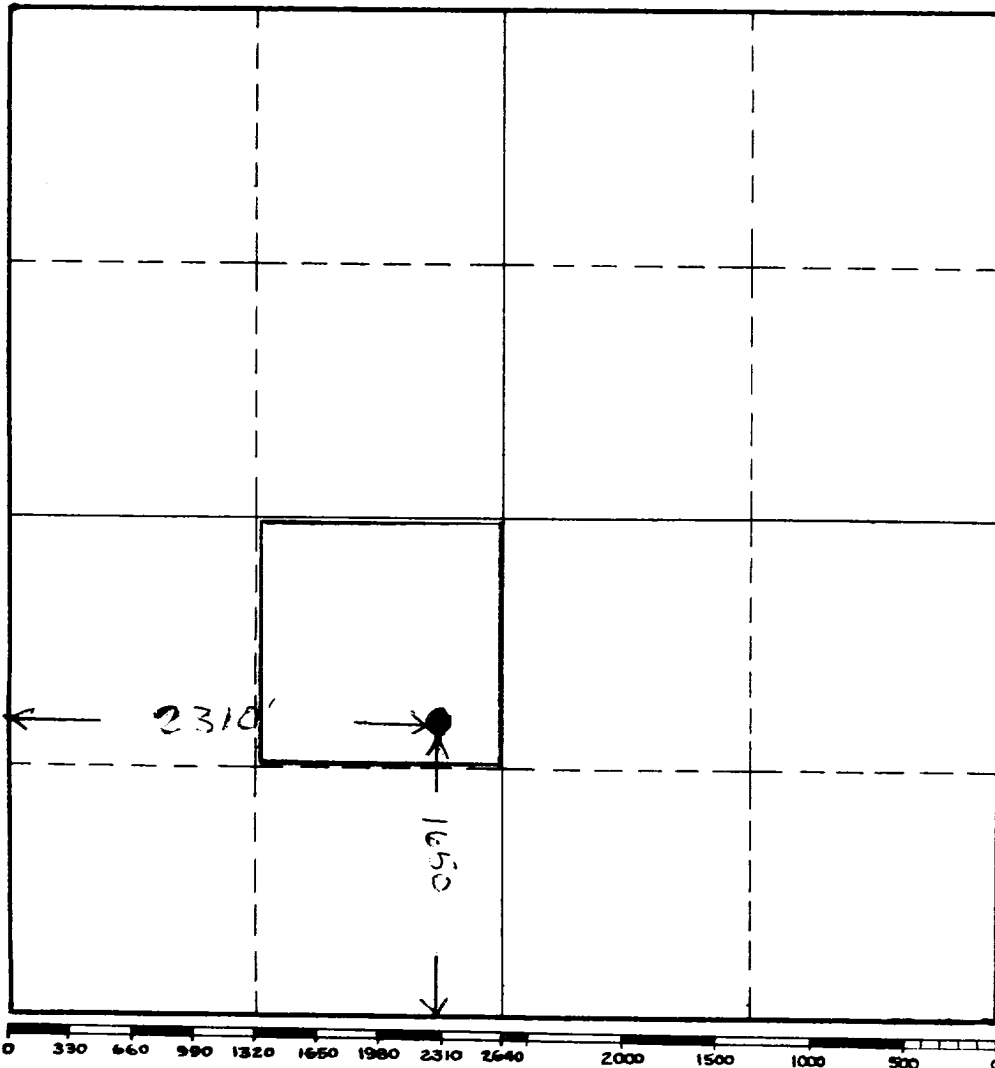

This is to certify that the information in Section A above is true and complete to the best of my knowledge and belief.

Albert Gackle, Operator

(Operator)

R. F. Matig
(Representative)

Box 2076, Hobbs, New Mexico
Address

This is to certify that the well location shown on the plat in Section B was plotted from field notes of actual surveys made by me or under my supervision and that the same is true and correct to the best of my knowledge and belief.

Date Surveyed _____

Registered Professional
Engineer and/or Land Surveyor.

Certificate No. _____

INSTRUCTIONS FOR COMPLETION:

1. Operator shall furnish and certify to the information called for in Section A.
2. Operator shall outline the dedicated acreage for both oil and gas wells on the plat in Section B.
3. A registered professional engineer or land surveyor registered in the State of New Mexico or approved by the Commission shall show on the plat the location of the well and certify this information in the space provided.
4. All distances shown on the plat must be from the outer boundaries of Section.
5. If additional space is needed for listing owners and their respective interests as required in question 3, Section A, please use space below

* "Owner" means the person who has the right to drill into and to produce from any pool and to appropriate the production either for himself or for himself and another. (65-3-29 (e) NMSA 1953 Comp.)

NEW MEXICO
OIL CONSERVATION COMMISSION

Gas Well Plat

Date 1-1-1953
1000 1000 2
Operator Lease Well No.
Name of Producing Formation Wagon Wheel Pool Wagon Wheel
No. Acres Dedicated to the Well 100

SECTION 23 TOWNSHIP 33 RANGE 36

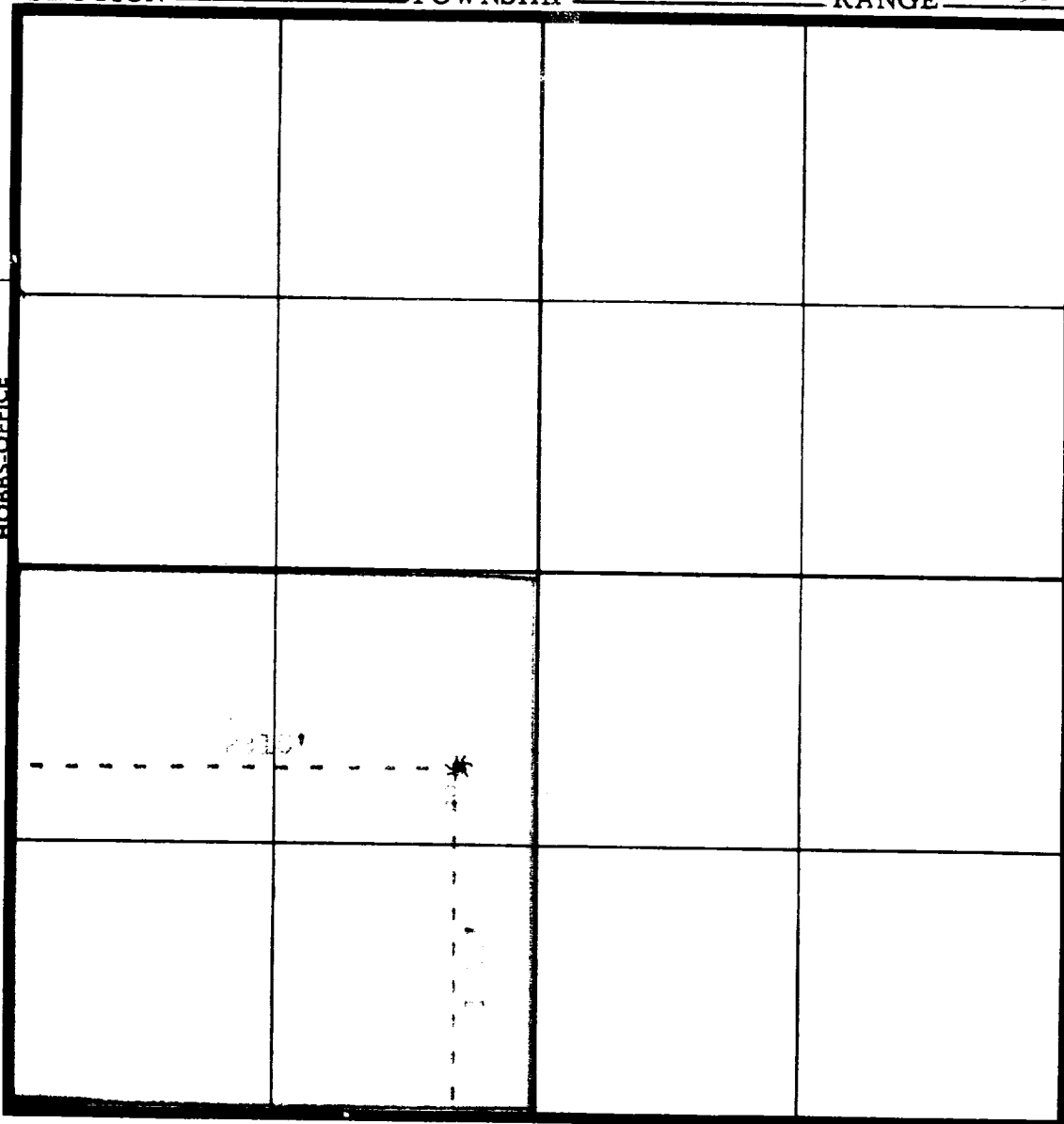

I hereby certify that the information given above is true and complete to the best of my knowledge.

Name Albert Hachler
Position Director
Representing New Mexico Oil Conservation Commission
Address 1111 N. 1st St. Santa Fe, N.M.

(over)

RECEIVED
DEC 14 1953
OIL CONSERVATION COMMISSION
HOBBS OFFICE

INSTRUCTIONS

1. Is this gas well a dual completion? ~~Yes~~ No x
2. If the answer to Question 1 is Yes, are there any
other dually completed wells within the dedicated
acreage? Yes No

A separate plat must be filed for each gas well, outlining the area dedicated to such well and showing the location of all other wells (oil and gas) within the outlined area.

Mail in duplicate to the district office for the district in which the well is located.