

NEW MEXICO OIL CONSERVATION COMMISSION
WELL LOCATION AND ACREAGE DEDICATION PLAT

FORM C-128
Revised 5/1/57

SEE INSTRUCTIONS FOR COMPLETING THIS FORM ON THE REVERSE SIDE

SECTION A

Operator Texas Pacific Coal & Oil Co.		Lease 1960 FEB 28 PM 01:45		Well No. 84	
Unit Letter G	Section 23	Township 23 South	Range 36 East	County Lea	
Apparatus Location of Well: 1980 feet from the North line and 2310 feet from the East line					
Ground Level Elev.	Producing Formation 7-Rivers		Pool Langlie-Mattix		Dedicated Acreage: 40 Acres

1. Is the Operator the only owner in the dedicated acreage outlined on the plat below? YES ☒ NO ☐ ("Owner" means the person who has the right to drill into and to produce from any pool and to appropriate the production either for himself or for himself and another. (65-3-29 (e) NMSA 1935 Comp.)
2. If the answer to question one is "no," have the interests of all the owners been consolidated by communization agreement or otherwise? YES ☐ NO ☐ If answer is "yes," Type of Consolidation _____
3. If the answer to question two is "no," list all the owners and their respective interests below:

Owner	Land Description

SECTION B

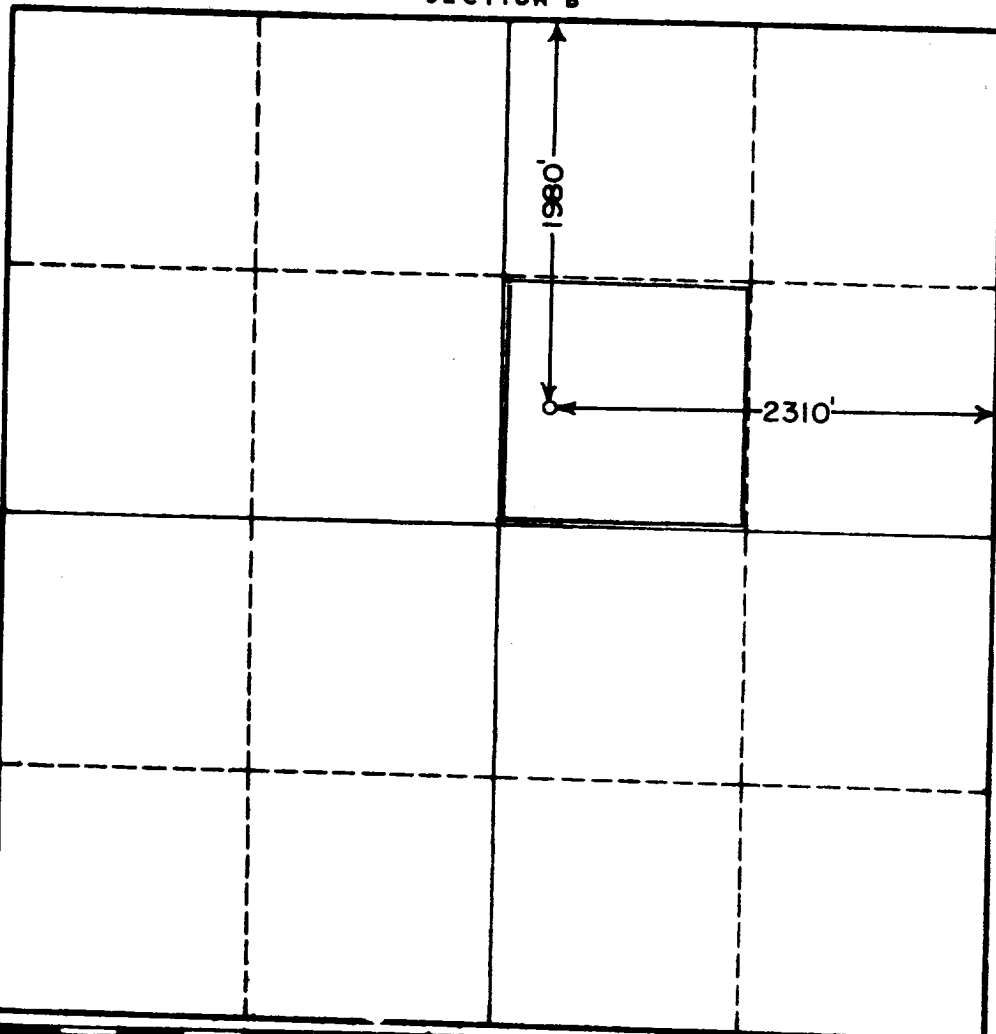

CERTIFICATION

I hereby certify that the information in SECTION A above is true and complete to the best of my knowledge and belief.

Name	[Signature]
Position	Manager of Production
Company	TEXAS PACIFIC COAL AND OIL CO
Date	February 26, 1960

I hereby certify that the well location shown on the plat in SECTION B was plotted from field notes of actual surveys made by me or under my supervision, and that the same is true and correct to the best of my knowledge and belief.

Date Surveyed	2-25-60
Registered Professional Engineer and/or Land Surveyor, JOHN W. WEST	
Certificate No.	[Signature]
N.M. - P.E. & L.S. NO. 678	

0 350 660 990 1320 1660 1980 2310 2640 2000 1500 1000 500 0