

District I
PO Box 1988, Hobbs, NM 88241-1988
District II
PO Drawer DD, Aramis, NM 88211-0719
District III
1000 Rio Brazos Rd., Aramis, NM 87410
District IV
PO Box 2088, Santa Fe, NM 87504-2088

State of New Mexico
Energy, Minerals & Natural Resources Department

OIL CONSERVATION DIVISION
PO Box 2088
Santa Fe, NM 87504-2088

Form C-102
Revised February 10, 1994
Instructions on back
Submit to Appropriate District Office
State Lease - 4 Copies
Fee Lease - 3 Copies

☐ AMENDED REPORT

WELL LOCATION AND ACREAGE DEDICATION PLAT

| | | | |
|----------------------------|--------------------------------------|--------------------|-----------------------|
| API Number 30-025-09938 | | Post Code 72480 | Pool Name Blinebry |
| Property Code 002703 | Property Name Alice Paddock | | Well Number 1 |
| OGRID No. 004323 | Operator Name Chevron U.S.A. Inc. | | Elevation |

10 Surface Location

| UL or lot no. | Section | Township | Range | Lot Idn | Feet from the | North/South line | Feet from the | East/West line | County |
|---------------|---------|----------|-------|---------|---------------|------------------|---------------|----------------|--------|
| 0 | 1 | 22S | 37E | | 660' | S | 1980' | E | Lea |

11 Bottom Hole Location If Different From Surface

| UL or lot no. | Section | Township | Range | Lot Idn | Feet from the | North/South line | Feet from the | East/West line | County |
|---------------|---------|----------|-------|---------|---------------|------------------|---------------|----------------|--------|
| | | | | | | | | | |

| | | | |
|-----------------------|--------------------------|-----------------------|--------------|
| 12 Deline Acres 80 | 13 Joint or Infill No | 14 Consolidation Code | 15 Order No. |
|-----------------------|--------------------------|-----------------------|--------------|

NO ALLOWABLE WILL BE ASSIGNED TO THIS COMPLETION UNTIL ALL INTERESTS HAVE BEEN CONSOLIDATED
OR A NON-STANDARD UNIT HAS BEEN APPROVED BY THE DIVISION

| | | | | |
|----|--|--|--|---|
| 16 | | | | <p>17 OPERATOR CERTIFICATION</p> <p>I hereby certify that the information contained herein is true and complete to the best of my knowledge and belief.</p> <p><u>Janija Kerley</u> Signature <u>Janija Kerley</u> Printed Name <u>Office Assistant</u> Title <u>1-18-96</u> Date</p> |
| | | | | |
| | | | | |
| | | | | |
| | | | | <p>18 SURVEYOR CERTIFICATION</p> <p>I hereby certify that the well location shown on this plat was plotted from field notes of actual surveys made by me or under my supervision, and that the same is true and correct to the best of my belief.</p> <p>Date of Survey Signature and Seal of Professional Surveyor: Certificate Number</p> |
| | | | | |
| | | | | |
| | | | | |

#2

#1 660' 1980'

Submit to Appropriate
District Office
State Lease - 4 copies
Fee Lease - 3 copies

State of New Mexico
Energy, Minerals and Natural Resources Department

Form C-102
Revised 1-1-89

OIL CONSERVATION DIVISION

P.O. Box 2088
Santa Fe, New Mexico 87504-2088

DISTRICT I
P.O. Box 1980, Hobbs, NM 88240

DISTRICT II
P.O. Drawer DD, Artesia, NM 88210

DISTRICT III
1000 Rio Brazos Rd., Aztec, NM 87410

WELL LOCATION AND ACREAGE DEDICATION PLAT

All Distances must be from the outer boundaries of the section

| | | | | | |
|---|---------------------------------|-----------------|------------------------|----------------|-------------------------------|
| Operator Chevron U. S. A., Inc. | | | Lease Alice Paddock | | Well No. 1 |
| Unit Letter O | Section 1 | Township 22S | Range 37E | County NMPM | LEA |
| Actual Footage Location of Well: 660 feet from the South line and 1980 feet from the East line | | | | | |
| Ground level Elev. 3356' | Producing Formation Blinebry | | Pool Blinebry Oil | | Dedicated Acreage 40 Acres |

1. Outline the acreage dedicated to the subject well by colored pencil or hatchure marks on the plat below.

2. If more than one lease is dedicated to the well, outline each and identify the ownership thereof (both as to working interest and royalty).

3. If more than one lease of different ownership is dedicated to the well, have the interest of all owners been consolidated by communitization, unitization, force-pooling, etc.?

☐ Yes ☐ No If answer is "yes" type of consolidation

If answer is "no" list the owners and tract descriptions which have actually been consolidated. (Use reverse side of this form if necessary.)

No allowable will be assigned to the well until all interests have been consolidated (by communitization, unitization, forced-pooling, or otherwise) or until a non-standard unit, eliminating such interest, has been approved by the Division.

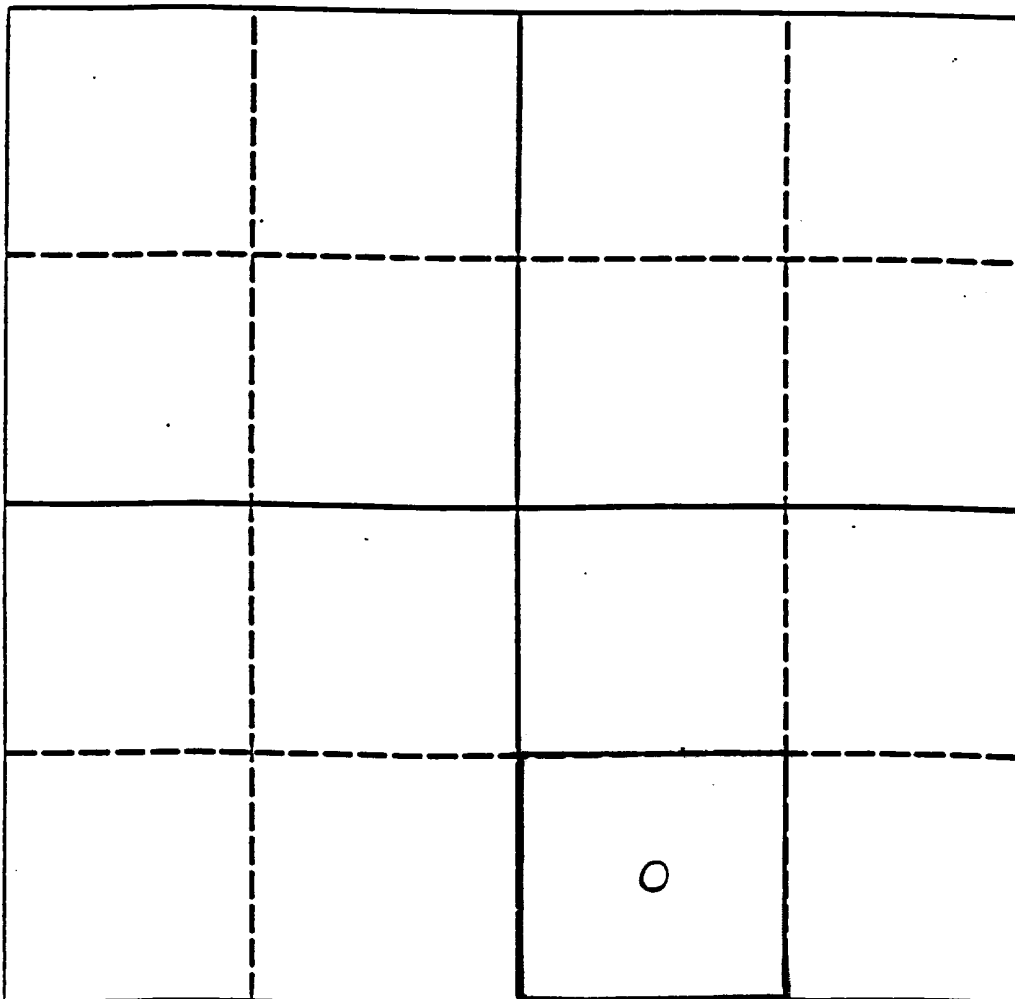

OPERATOR CERTIFICATION

I hereby certify that the information contained herein is true and complete to the best of my knowledge and belief.

Signature
J. K. Ripley
Printed Name
J. K. Ripley

Position
Technical Assistant

Company
Chevron U. S. A., Inc.

Date
7/29/92

SURVEYOR CERTIFICATION

I hereby certify that the well location shown on this plat was plotted from field notes of actual surveys made by me or under my supervision, and that the same is true and correct to the best of my knowledge and belief.

Date Surveyed

Signature & Seal of Professional Surveyor

Certificate No.

0 330 660 990 1320 1650 1980 2310 2640 2000 1500 1000 500 0

Reclaim land 7-1-92

RECEIVED

JUL 24 1992

COO MORRIS 007



STATE OF NEW MEXICO
ENERGY, MINERALS AND NATURAL RESOURCES DEPARTMENT
OIL CONSERVATION DIVISION
HOBBS DISTRICT OFFICE

BRUCE KING
GOVERNOR

February 4, 1992

POST OFFICE BOX 1980
HOBBS, NEW MEXICO 88241-1980
(505) 393-6161

Chevron USA Inc.
ATT: Rory Matthews
P.O. Box 1150
Midland, TX 79702

RE: Packer Leakage Test
Alice Paddock
#1-0, 1-22-37

Gentlemen:

We are returning the Packer Leakage Test you sent on the above listed well, because this is not acceptable. According to your C-103 we see you have a problem and will give you 30 days to initiate a workover. After this workover, please let us know so that we may witness the packer leakage test you run.

If you have any questions, please call the District I office, (505) 393-6161.

Yours very truly,

OIL CONSERVATION DIVISION

Jerry Sexton
District I, Supervisor

JS:dp
cc: C-103



DISTRICT I
P.O. Box 1980, Hobbs, NM 88240

OIL CONSERVATION DIVISION

DISTRICT II
P.O. Drawer DD, Artesia, NM 88210

P.O. Box 2088
Santa Fe, New Mexico 87504-2088

This form is not to be used for
reporting packer leakage tests in
Northwest New Mexico

SOUTHEAST NEW MEXICO PACKER LEAKAGE TEST

| | | | | | | | | |
|-----------------------------------|------------------|---------------|----------------------------|--------------------------------|----------------------------|-------------------|------------|--|
| Operator <u>Chevron USA, Inc.</u> | | | Lease <u>ALICE PADDOCK</u> | | | Well No. <u>1</u> | | |
| Location of Well | Unit <u>0</u> | Sec. <u>1</u> | Twp <u>22</u> | Rge <u>37</u> | County <u>Lea</u> | | | |
| Name of Reservoir or Pool | | | Type of Prod. (Oil or Gas) | Method of Prod. Flow, Art Lift | Prod. Medium (Tbg. or Csg) | | Choke Size | |
| Upper Compl | <u>PADDOCK</u> | | | | | | | |
| Lower Compl | <u>BLINE BRV</u> | | | | | | | |

FLOW TEST NO. 1

Both zones shut-in at (hour, date): _____

Well opened at (hour, date): _____

| | Upper Completion | Lower Completion |
|--|---|------------------|
| Indicate by (X) the zone producing..... | _____ | _____ |
| Pressure at beginning of test..... | _____ | _____ |
| Stabilized? (Yes or No)..... | _____ | _____ |
| Maximum pressure during test..... | _____ | _____ |
| Minimum pressure during test..... | _____ | _____ |
| Pressure at conclusion of test..... | _____ | _____ |
| Pressure change during test (Maximum minus Minimum)..... | _____ | _____ |
| Was pressure change an increase or a decrease?..... | _____ | _____ |
| Well closed at (hour, date): _____ | Total Time On Production _____ | |
| Oil Production During Test: _____ bbls; Grav. _____ | Gas Production During Test _____ MCF; GOR _____ | |
| Remarks _____ | | |

FLOW TEST NO. 2

Well opened at (hour, date): _____

| | Upper Completion | Lower Completion |
|--|---|------------------|
| Indicate by (X) the zone producing..... | _____ | _____ |
| Pressure at beginning of test..... | _____ | _____ |
| Stabilized? (Yes or No)..... | _____ | _____ |
| Maximum pressure during test..... | _____ | _____ |
| Minimum pressure during test..... | _____ | _____ |
| Pressure at conclusion of test..... | _____ | _____ |
| Pressure change during test (Maximum minus Minimum)..... | _____ | _____ |
| Was pressure change an increase or a decrease?..... | _____ | _____ |
| Well closed at (hour, date): _____ | Total time on Production _____ | |
| Oil production During Test: _____ bbls; Grav. _____ | Gas Production During Test _____ MCF; GOR _____ | |
| Remarks <u>WELL C I</u> | <u>Thg parted. 4/28/91</u> | |

OPERATOR CERTIFICATE OF COMPLIANCE

I hereby certify that the information contained herein is true and completed to the best of my knowledge

Chevron Usa, Inc.

Operator

Signature

G.N. GARCIA Production Specialist

Printed Name

Title

394-3133

OIL CONSERVATION DIVISION

Date Approved FEB 04 '92

By _____

Title _____

NEW MEXICO OIL CONSERVATION COMMISSION
WELL LOCATION AND ACREAGE DEDICATION PLAT

Form C-102
Supersedes C-128
Effective 1-1-65

All distances must be from the outer boundaries of the Section.

| | | | | | |
|---|---------------------------------|-----------------|----------------------------|--------------------------------|---------------|
| Operator Chevron U.S.A. Inc. | | | Lease Alice Paddock | | Well No. 1 |
| Unit Letter 0 | Section 1 | Township 22S | Range 37E | County Lea | |
| Actual Footage Location of Well: 660 feet from the South line and 1980 feet from the East line | | | | | |
| Ground Level Elev. 3356 | Producing Formation Blinebry | | Pool Blinebry Oil & Gas | Dedicated Acreage: 80 Acres | |

1. Outline the acreage dedicated to the subject well by colored pencil or hachure marks on the plat below.
2. If more than one lease is dedicated to the well, outline each and identify the ownership thereof (both as to working interest and royalty).
3. If more than one lease of different ownership is dedicated to the well, have the interests of all owners been consolidated by communitization, unitization, force-pooling, etc?

☐ Yes ☐ No If answer is "yes," type of consolidation _____

If answer is "no," list the owners and tract descriptions which have actually been consolidated. (Use reverse side of this form if necessary.) _____

No allowable will be assigned to the well until all interests have been consolidated (by communitization, unitization, forced-pooling, or otherwise) or until a non-standard unit, eliminating such interests, has been approved by the Commission.

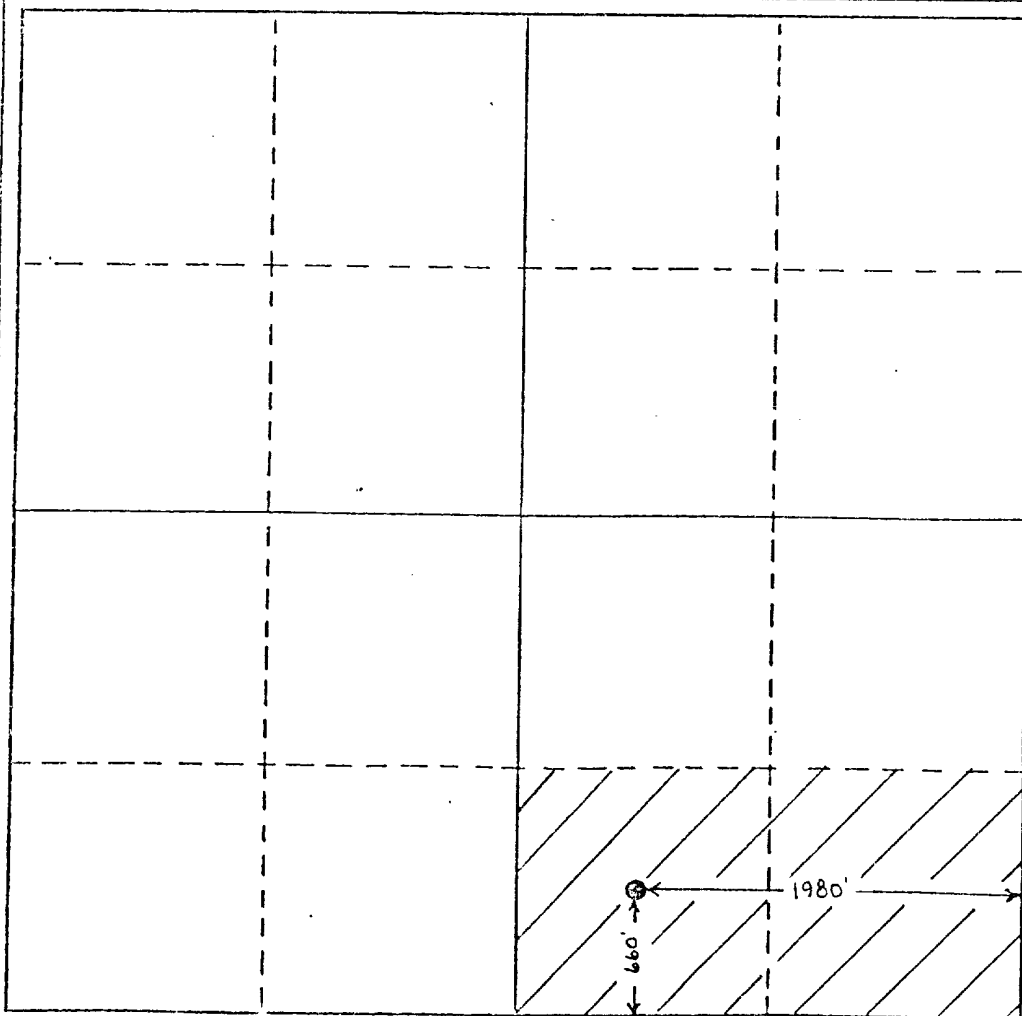

CERTIFICATION

I hereby certify that the information contained herein is true and complete to the best of my knowledge and belief.

M. W. Casey
Name

M. W. Casey

Position

Division Proration Engineer

Company

Chevron U.S.A. Inc.

Date

11-4-85

I hereby certify that the well location shown on this plat was plotted from field notes of actual surveys made by me or under my supervision, and that the same is true and correct to the best of my knowledge and belief.

Date Surveyed

Registered Professional Engineer
and/or Land Surveyor

Certificate No.

NEW MEXICO OIL CONSERVATION COMMISSION
WELL LOCATION AND ACREAGE DEDICATION PLAT
SEE INSTRUCTIONS FOR COMPLETING THIS FORM ON THE REVERSE SIDE

FORM C-128
Revised 5/1/57

| | |
|------------------|-----|
| FILE | |
| U.S.G.S. | |
| LAND OFFICE | |
| TRANSPORTER | OIL |
| | GAS |
| PRORATION OFFICE | |
| OPERATOR | |

SECTION A

| | | | | | |
|---|--|------------------------|-------------------------------|----------------------|--|
| Operator Gulf Oil Corporation | | | Lease Alice Paddeok | | Well No. 1 |
| Unit Letter 0 | Section 1 | Township 22S | Range 37E | County Lea | |
| Actual Footage Location of Well: 660 feet from the south line and 1980 feet from the east line | | | | | |
| Ground Level Elev. 3356 | Producing Formation Hlinebry | | Pool Hlinebry Gas | | Dedicated Acreage: 120 Acres |

1. Is the Operator the only owner in the dedicated acreage outlined on the plat below? YES ☒ NO ☐ . ("Owner" means the person who has the right to drill into and to produce from any pool and to appropriate the production either for himself or for himself and another. (65-3-29 (e) NMSA 1935 Comp.)
2. If the answer to question one is "no," have the interests of all the owners been consolidated by communitization agreement or otherwise? YES ☐ NO ☐ . If answer is "yes," Type of Consolidation _____
3. If the answer to question two is "no," list all the owners and their respective interests below:

| Owner | Land Description |
|-------|------------------|
| | |
| | |

SECTION B

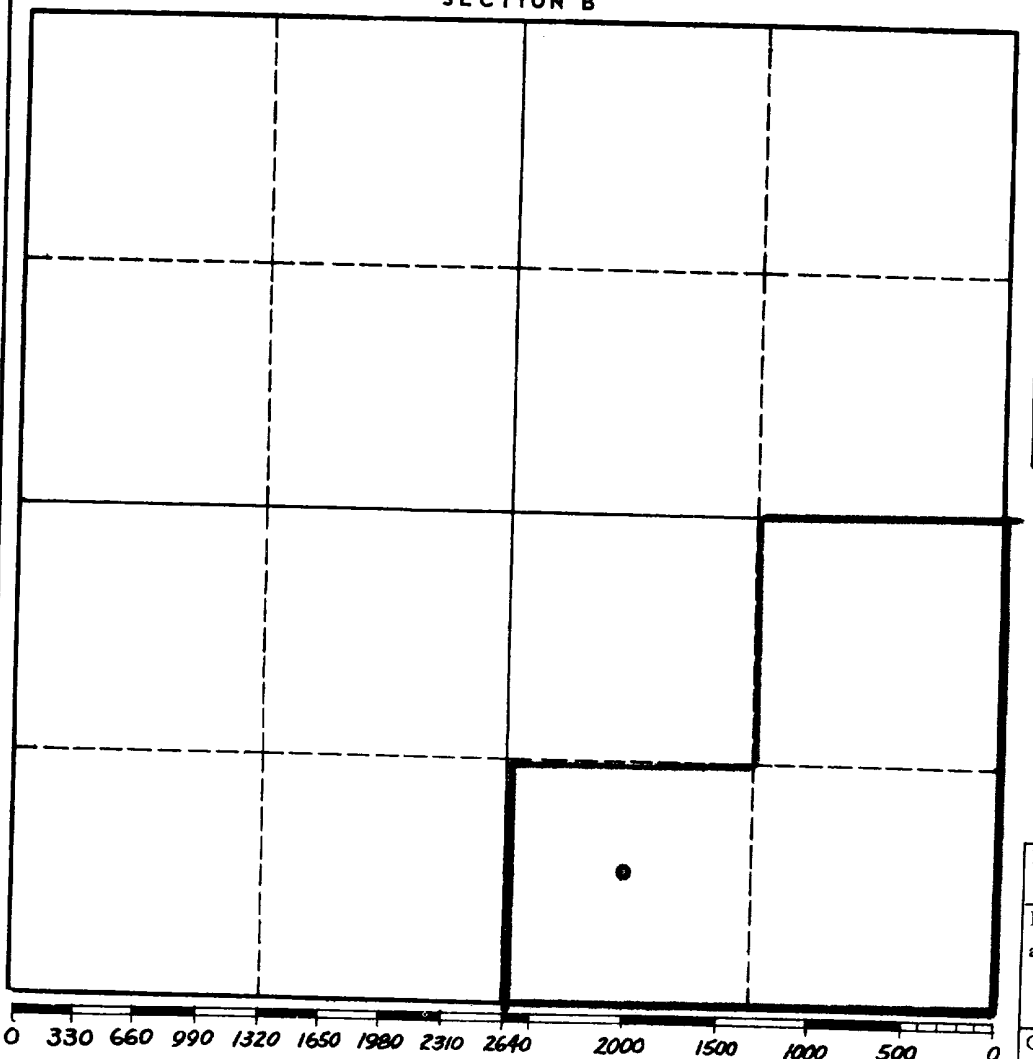

CERTIFICATION

I hereby certify that the information in SECTION A above is true and complete to the best of my knowledge and belief.

| |
|--|
| Name |
| Position Area Production Manager |
| Company Gulf Oil Corporation |
| Date August 28, 1964 |

I hereby certify that the well location shown on the plat in SECTION B was plotted from field notes of actual surveys made by me or under my supervision, and that the same is true and correct to the best of my knowledge and belief.

| |
|---|
| Date Surveyed |
| Registered Professional Engineer and/or Land Surveyor |
| Certificate No. |

INSTRUCTIONS FOR COMPLETION OF FORM C-128

1. Operator shall furnish and certify to the information called for in Section A.
2. Operator shall outline the dedicated acreage for *both* oil and gas wells on the plat in Section B.
3. A registered professional engineer or land surveyor registered in the State of New Mexico or approved by the Commission shall show on the plat the location of the well and certify this information in the space provided.
4. All distances shown on the plat must be from the outer boundaries of the Section.
5. If additional space is needed for listing owners and their respective interests as required in question 3 of Section A, please use space below.