

NEW MEXICO OIL CONSERVATION COMMISSION

Santa Fe, New Mexico

NOTICE OF INTENTION TO DRILL

Notice must be given to the Oil Conservation Commission or its proper agent and approval obtained before drilling begins. If changes in the proposed plan are considered advisable, a copy of this notice showing such changes will be returned to the sender. Submit this notice in triplicate. One copy will be returned following approval. See additional instructions in Rules and Regulations of the Commission.

Midland, Texas,

August 28, 1946

Place

Date

OIL CONSERVATION COMMISSION,
Santa Fe, New Mexico,

Gentlemen:

You are hereby notified that it is our intention to commence the drilling of a well to be known as Lease #37721
Humble Oil & Refining Company **N. M. State "S"** Well No. 10 in SW/4 of SW/4

Company or Operator Lease
of Sec. 2, T. 22-S, R. 37-E, N. M., P. M., Paddock Field, Lea County.

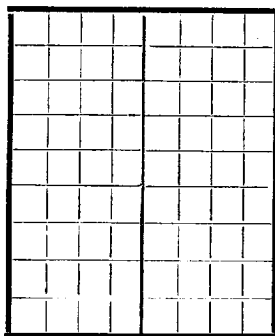

AREA 640 ACRES

LOCATE WELL CORRECTLY

The well is 660 feet (N.) (~~S~~) of the South line and 660 feet (E.) (~~W~~) of the West line of SW/4 of SW/4 of Section 2

(Give location from section or other legal subdivision lines. Cross out wrong directions.)

If state land the oil and gas lease is No. _____ Assignment No. _____

If patented land the owner is _____

Address _____

If government land the permittee is _____

Address _____

The lessee is Humble Oil & Refining Company

Address Box 1600, Midland, Texas

We propose to drill well with drilling equipment as follows: _____

Rotary Rig

The status of a bond for this well in conformance with Rule 39 of the General Rules and Regulations of the Commission is as follows: Now on file in Commission Office

We propose to use the following strings of casing and to land or cement them as indicated:

Size of Hole	Size of Casing	Weight Per Foot	New or Second Hand	Depth	Landed or Cemented	Sacks Cement
13-1/4"	10-3/4"	40.5#	New	300'	Cemented	300 sx.
9-7/8"	7-5/8"	26.4#	"	2800'	"	1800 sx.
6-3/4"	5-1/2"	14#	"	5500'	"	500 sx.

If changes in the above plan become advisable we will notify you before cementing or landing casing. We estimate that the first productive oil or gas sand should occur at a depth of about 5500 feet.

Additional information:

Approved AUG 29 1946, 19____
except as follows:

Sincerely yours,

Humble Oil & Refining Company

Company or Operator

By J. P. H. H. H.Position Asst. Division Superintendent

Send communications regarding well to

Name J. W. HouseAddress Box 1600, Midland, Texas

OIL CONSERVATION COMMISSION,

By Roy YashouryTitle Oil & Gas Inspector

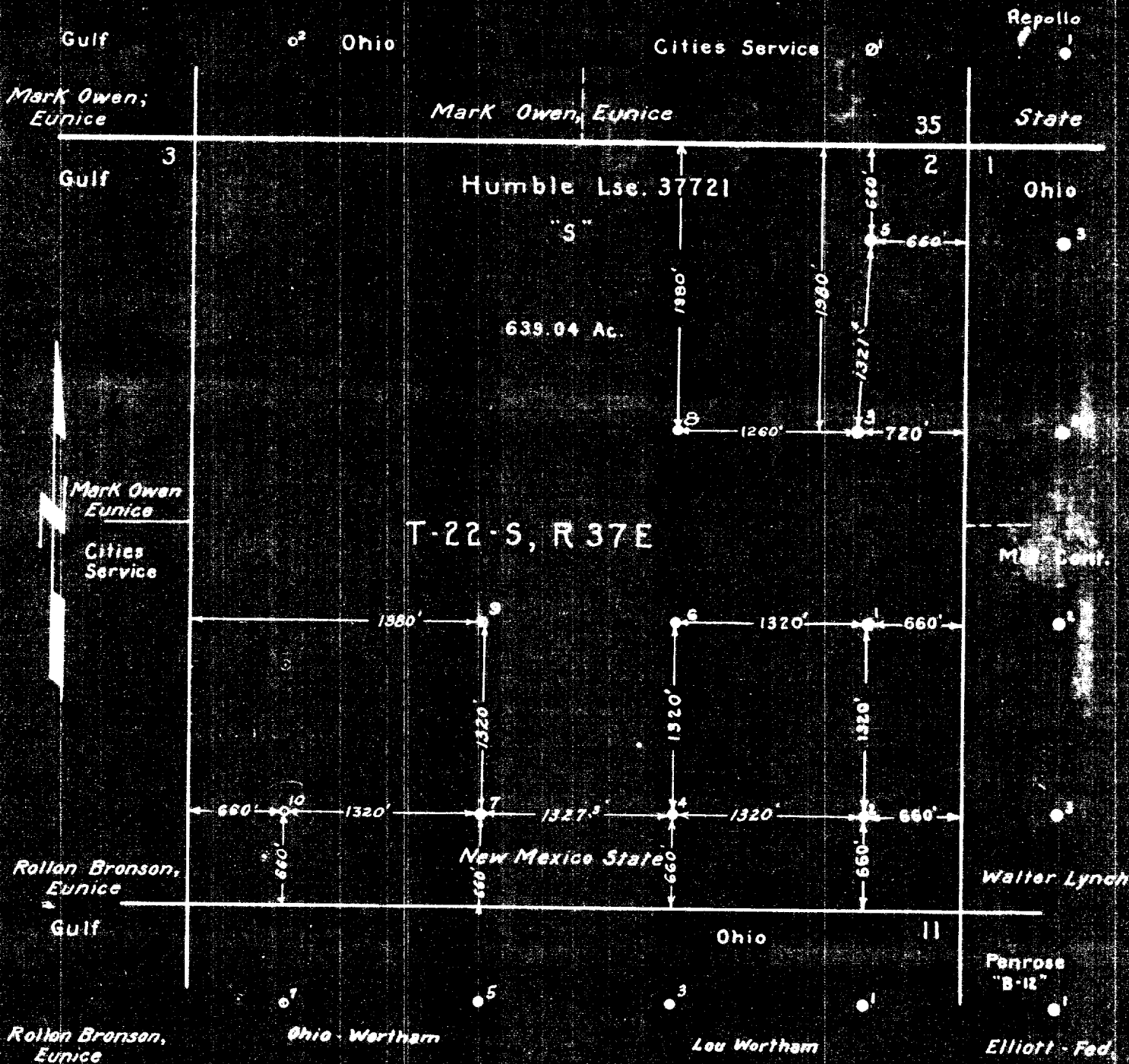

Note: The area shown hereon is a portion of Lease No. 37721 which covers 6023.83 acres, except Parker Drilling Co. owning rights to 4250' depth on SW/4 of SW/4 of Sec. 2, T22S, R37E, Lea Co., NM

Humble New Mexico State "S" Lease No. 37721
Sec. 2, T-22-S, R-37-E
Lea Co., N.M.

HUMBLE OIL & REFINING COMPANY
CIVIL ENGINEERING DEPARTMENT
MIDLAND, TEXAS

DRAWN G. Watson
CHECKED _____
APP. _____

SCALE 1" = 1000'
DATE 10-8-45
REVISED 5-28-46

FILE NO.
WT-A-417